

6

5

4

3

2

1

APPROVED: \_\_\_\_\_

DATE: \_\_\_\_\_ TITLE: \_\_\_\_\_

Rev	AWO #	Description	Date	Appr
-		RELEASED	6/23/06	
A		REVISED	01/18/07	
B		REVISED	05/11/07	

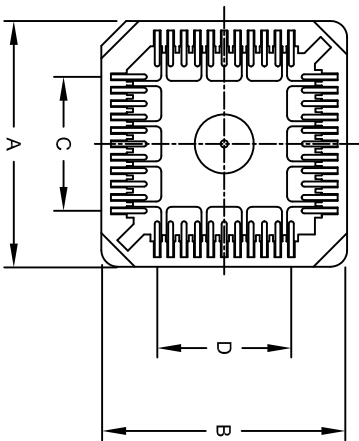
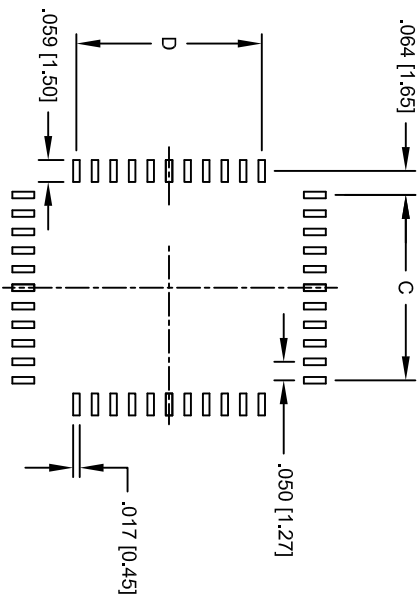
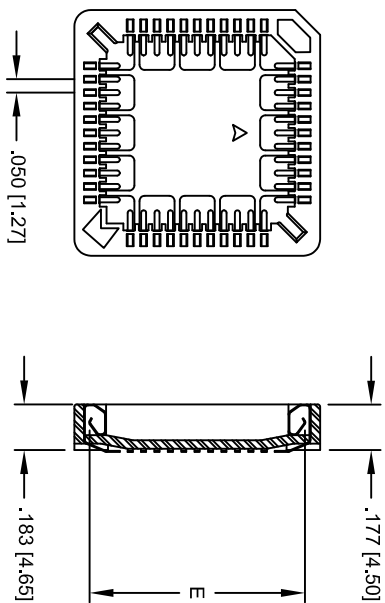

POSITIONS	A	B	C	D	D
20	.616 [15.65]	.616 [15.65]	.200 [5.08]	.200 [5.08]	.500 [12.70]
28	.715 [18.16]	.715 [18.16]	.300 [7.62]	.300 [7.62]	.600 [15.24]
32	.715 [18.16]	.817 [20.75]	.300 [7.62]	.400 [10.16]	.700 [17.78]
44	.917 [23.28]	.917 [23.28]	.500 [12.70]	.500 [12.70]	.800 [20.32]
52	1.017 [25.84]	1.017 [25.84]	.600 [15.24]	.600 [15.24]	.900 [22.86]
68	1.219 [30.95]	1.219 [30.95]	.800 [20.32]	.800 [20.32]	1.100 [27.94]
84	1.417 [36.00]	1.417 [36.00]	1.000 [25.40]	1.000 [25.40]	1.300 [33.02]

Note: Packaged on Tape and Reel

### SPECIFICATIONS:

#### Material:

Insulator: Hi-Temp thermoplastic, Glass reinforced, rated UL 94V-0

Insulator color: Brown

Contacts: Phosphor Bronze

#### Plating:

Tin over Copper underplate overall

#### Electrical:

Operating voltage: 250 VAC max

Current rating: 1 Amp max

Contact resistance: 30 mohms max initial

Insulation resistance: 1000 Mohms min

Dielectric withstanding voltage: 500 VAC for 1 minute

#### Temperature Rating:

Operating temperature: -55°C to +105°C

#### Environmental:

Lead free, RoHS compliant.



**ADAM TECH**

909 Railway Avenue, Union, NJ 07083  
Phone: 908-687-5000 Fax: 908-687-5710

TITLE: PLCC SOCKET, SURFACE MOUNT,  
TIN PLATED

UNLESS OTHERWISE SPECIFIED ALL DIMENSIONS ARE INCHES [MM] TOLERANCES: EXCEPT AS NOTED		INCHES		HOLES	
.X	± .10	ØX	± .10	.X	± .10
.XX	± .020	ØXX	± .015	.XX	± .015
.XXX	± .015	ØXXX	± .010	.XXX	± .010
APPROVALS		DATE			
DRAWN	SS	6/23/06			
CHECKED					
APPROVED					
SIZE		PART NO.		REV.	
X		PLCC-XX-AT-SMT-T/R		B	
REF:		SCALE: NTS		SHEET 1 OF 1	

A

B

C

D

A

B

C

D

6

5

4

3

2

1