

# WATCH CRYSTAL

Part Number: 830062558 | IQXC-25

AKA Number: LFX TAL062558



## General Information

2.0 x 1.2 mm SMD crystal in a hermetically sealed ceramic package with an electro-beam sealed metal lid. Suitable for real time clock applications.

## Dimensions [mm]

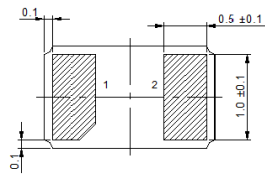

Pad No	Pad Connection
1	Crystal
2	Crystal

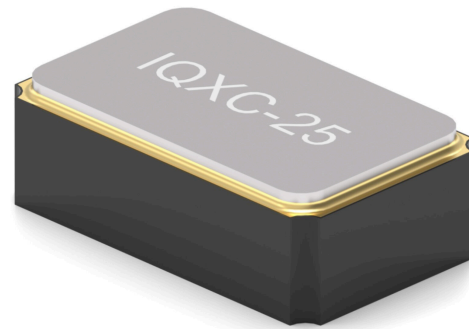
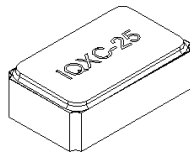
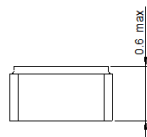
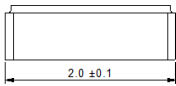

## Recommended Land Pattern [mm]

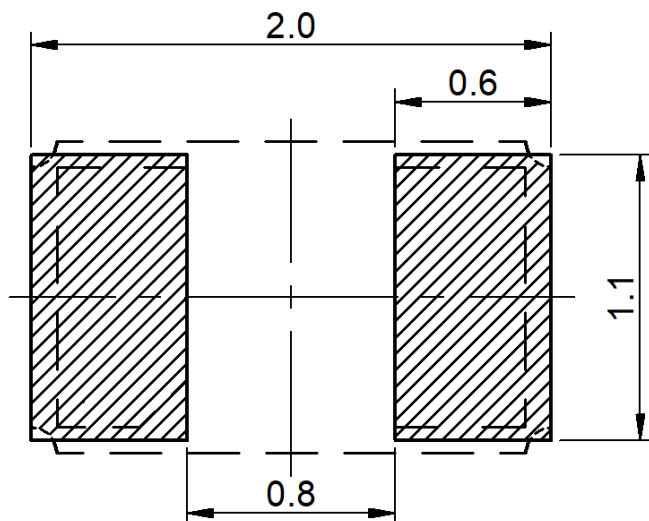

Part Number: **830062558** | IQXC-25

AKA Number: LFX TAL062558

## Frequency Parameters

Frequency	32.7680 kHz
Frequency Tolerance	± 10 ppm @25 °C ±5 °C
Operating Temperature	-40 °C to 85 °C
Overtone Order	Fundamental
Ageing	± 3 ppm max per year @ 25 ° C
Frequency Stability Coefficient:	-0.03 ±0.01ppm/°C <sup>2</sup>

## Material Parameters

Termination Finish	W Ni Au
Moisture Sensitivity Level (MSL)	Not Applicable

## Manufacturing Details

Reflow: 260 °C max for 5 seconds max.

## Electrical Parameters

Load Capacitance <b>CL</b>	9 pF
Shunt Capacitance <b>CO</b>	1.3 pF typ. 1.7 pF max.
Drive Level	0.1 µW recommended 0.5 µW max.
ESR	70000 Ω max.
Motional Capacitance (C1):	6.5 fF typ

## Environmental Parameters

Storage Temperature Range:	-55 °C to 125 °C
Shock:	IEC 60068-2-27: 1000 g, 1 ms, 3 times in each of the 3 mutually perpendicular planes.
Vibration:	IEC 60068-2-6: 1.5 mm amplitude, 10 Hz ~ 55 Hz, 1 minute in 3 mutually perpendicular planes for the total of 6 hours (2 hours in each plane).

## Technical Standards

RoHS Status	2015/863/EU - Compliant
REACH Status	Compliant

## Packaging Details

Packaging SPQ	Tape & Reel 3000 pcs
Tape & reel in accordance with EIA-481	
Quantities below the standard reel size to be supplied on cut tape.	

## Stability vs. Temperature

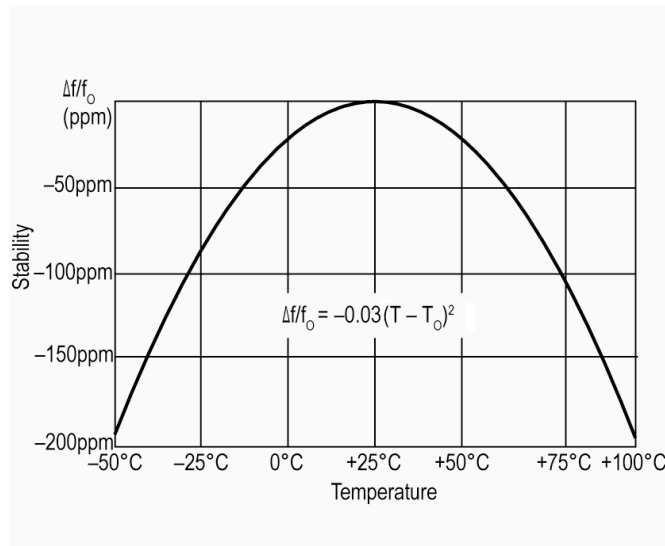

# WATCH CRYSTAL

**Part Number: 830062558** | IQXC-25

AKA Number: LFXTAL062558

---



## **Company Address**

IQD Frequency Products Ltd.

Station Road

Crewkerne

Somerset

TA18 8AR, United Kingdom