

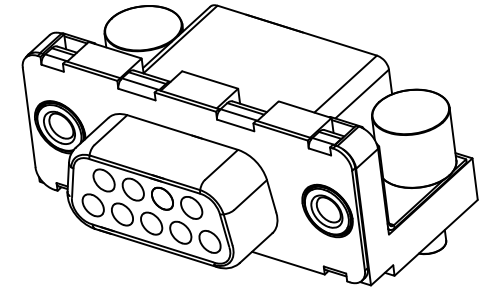

FCIconnect.com

Copyright FCI

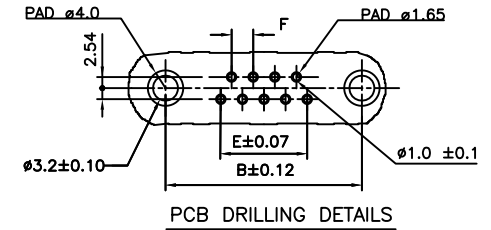
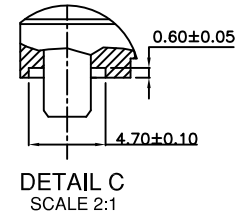
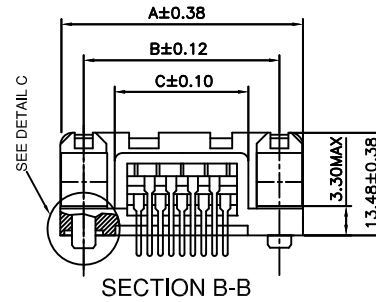
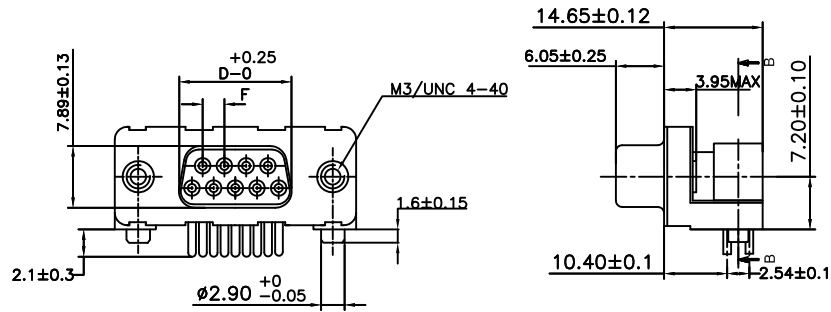
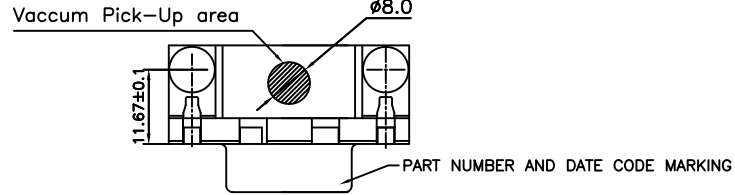

ORDERING INFORMATION

D	09	S	13	A	6	R	L	1	0	8	L	F	
SERIES	NO.OF CONTACTS	TYPE OF CONTACTS	TYPE OF TERMINATION	PLATING	REVERSE SHELL ORIENTATION	TAPE&REEL PACKING	TAPE&REEL PACKING	TAPE&REEL PACKING	TAPE&REEL PACKING	TAPE&REEL PACKING	TAPE&REEL PACKING	TAPE&REEL PACKING	TAPE&REEL PACKING
09	13	S- SOCKET	13-ANGLED SPILL PITCH 2.54 FOOT PRINT-10.4 HEIGHT OF TERMINATION A-2.10mm	4- Gold Flash, 200 Mating/Un-mating performance 6- 0.76µ Gold, 500 Mating/Un-mating performance	RL->LIF HARPOON+INSERTM3+METAL BRACKET RX->LIF HARPOON+INSERT UNC 4.40+METAL BRACKET	LF- LEAD FREE	REVERSE SHELL ORIENTATION	TAPE&REEL PACKING	TAPE&REEL PACKING	TAPE&REEL PACKING	TAPE&REEL PACKING	TAPE&REEL PACKING	TAPE&REEL PACKING

"This product meets European Union Directives and other country regulations as described in GS-47-0004"

The housing will withstand exposure to 260°C peak temperature for 30 seconds in a convection, infra-red or vapor reflow oven solder application.

Packaging as per GS-14-920

TRUE POSITION : $\varnothing \varnothing 0.36$

PRODUCT SPECIFICATION

See :- GS-12-433

PACKAGING SPECIFICATION

See :- GS-14-1139

mat'l. code SEE TECH.SPEC				surface ISO 1302	tolerance ISO 406 ISO 1101	projection	product family
ltr	ecn no	dr	date	tolerances unless otherwise specified	tolerances unless otherwise specified	MM	DELTA-D
A	110-0088	NG	2010/04/08	angles	linear	MM	title
B	110-0249	NG	2010/12/29				REVERSE DELTA-D A/S FEMALE PIP CONNECTOR
C	ELX-I-19023	AB	2014/10/11	0°±1°	.000±.00X	scale	EUROPE VERSION
D	ELX-I-21007	AB	2015/06/03	dr	GEORGE.V.JOSEPH	2005/12/19	dwg no
				enr	ALIAS.BABU	2014/10/11	sheet 1 of 1
				chr	MITHUN.PAUL	2014/10/11	size
				appd	BIJU.K.PAUL	2014/10/11	A3
sheet index	revision	D					type
	sheet	1					Product Customer Drawing