

PRODUCT NUMBER

PITCH

VLxx32x100J0G

3.81 mm

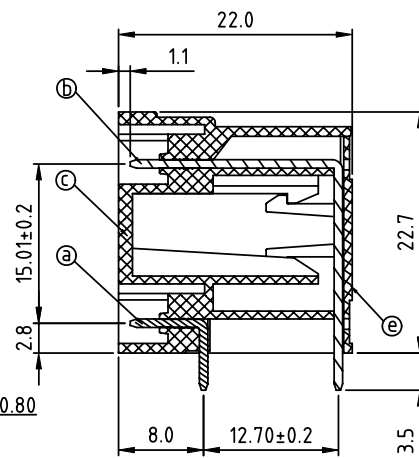
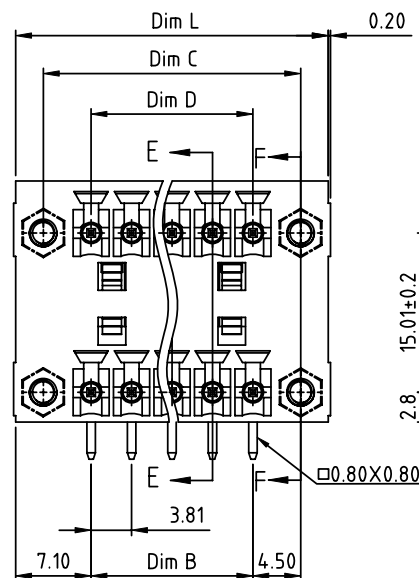

SECTION E-E

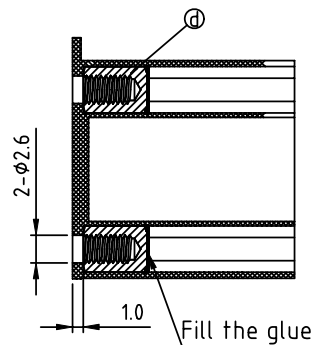

SECTION F-F

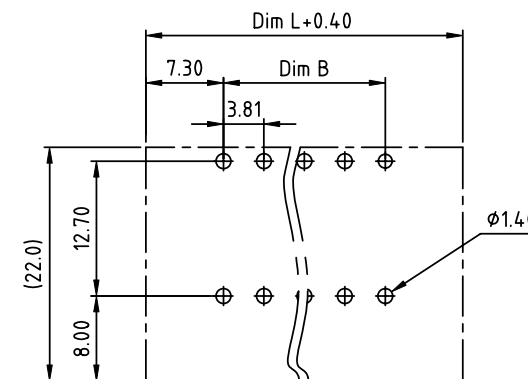
RECOMMENDED P.C.B LAYOUT
TOP VIEW

Material:

- Item① Short pin: Copper Tin plated
- Item② Long pin: Copper Tin plated
- Item③ Terminal(housing): Thermoplastic (UL94V-0)
- Item④ With flange nut: Brass,M2.5
- Item⑤ Terminal(cover): Thermoplastic (UL94V-0)

Electrical:

- cULus
- Voltage rating: 300V
- Current rating: 10A
- Withstanding Voltage: 1.6 KV
- Operating temperature: -40°C to +115°C
- Soldering temperature: 260°C±5°C/5 Sec
- Safety Approval: cULus

N=Number of poles
 Dim L=(N/2-1)×3.81+14.2
 Dim B=(N/2-1)×3.81
 Dim C=(N/2-1)×3.81+9.0
 Dim D=(N/2-1)×3.81

Poles	Tolerance
2x2-2x6p	±0.15
2x7-2x12p	±0.25
2x13-2x18p	±0.35
2x19-2x24p	±0.40

PART NO.: VL xx 3 2 x 1 00J0 G

Solid block	No. of poles	Color	RoHS compliant (lead<4%) In copper Alloy
0	2	Black (RAL9005)	
04	2x2poles	Red (RAL3001/D)	
06	2x3poles	Orange(RAL2011/P)	
...	...	4 Yellow(RAL1018/A)	
48	2x24poles	5 Green(RAL6018/T)	
		6 Blue (RAL5015/A)	
		8 Grey(RAL7035/D)	
		9 White(RAL1102)	
		C Green(RAL6018/U)	

mat'l. code				surface	tolerance	projection	product family	
ltr ecn no dr date				ASME Y14.5	ASME Y14.5	MM	TERMINAL BLOCK	
				tolerances unless otherwise specified			title	
				angles	X.±0.5		TERMINAL BLOCK	
				flat	X.X±0.3		PLUGGABLE SOCKET, WITH FLANGE, RIGHT ANGLE	
				X'±1"	X.XX±0.1	scale	dwg no	
				dr	EVIN ZHONG 042814		sheet 1 of 1 size	
				enrg	EVIN ZHONG 042814		VLxx32x100J0G	
				chr	HANKE FENG 042814		A4	
				appd	SHI JUN 042814		type	
							CUSTOMER Drawing	
sheet index	revision	A						
	sheet	1						