

NOTES:

1. MATERIALS AND FINISHES:
REAR BODY AND BAYONET SLEEVE - BRASS, NICKEL PLATING
OUTER CONTACT - BeCu, NICKEL PLATING
CONTACT - PHOSPHOR BRONZE, GOLD PLATING
FERRULE - BRASS, NICKEL PLATING
INSULATOR - PTFE
INSULATOR-REAR - PTFE
CAP - BRASS, NICKEL PLATING
2. ELECTRICAL:
A. IMPEDANCE: 75 OHM
B. FREQUENCY RANGE : DC - 12 GHz
C. RETURN LOSS:-20dB DC-6 GHz
-15dB 6-12 GHz
3. MECHANICAL:
A. DURABILITY: 500 CYCLES MIN.
B. TEMPERATURE : -65°C TO +165°C
4. ENVIRONMENTAL:
A. THERMAL SHOCK PER MIL-STD-202 METHOD 107
TEST CONDITION B (EXCEPT HIGH TEMP @200°C)
B. VIBRATION: MIL-STD-202 METHOD 204 TEST CONDITION B
C. SHOCK: MIL-STD-202 METHOD 213 TEST CONDITION B
D. CORROSION: MIL-STD-202 METHOD 101
TEST CONDITION B 5% SALT SOLUTION
5. PACKAGING:
A. QUANTITY: SINGLE PACK
B. MARKING: BAG TO BE MARKED:
"AMPHENOL RF, 34-1119-12G DATE CODE"
6. HIGH DENSITY INSTALLATION/REMOVAL TOOL: 227-T2000
7. CABLE ASSEMBLY INSTRUCTIONS:
A. TRIM CABLE AS SHOWN.
B. SLIDE FERRULE ONTO CABLE.
C. INSERT INSULATOR-REAR ONTO CENTER CONDUCTOR IN ORIENTATION SHOWN.
D. INSERT CABLE WITH INSULATOR-REAR INTO CONNECTOR WITH FOIL ENTERING
CONNECTOR AND BRAID OVER KNURL
E. SOLDER CONTACT TO CABLE CENTER CONDUCTOR.
F. CRIMP FERRULE WITH .324" HEX.
G. PRESS CAP INT BODY UNTIL FLUSH.

8 SHOWS CABLE ENTRY DIMENSIONS.

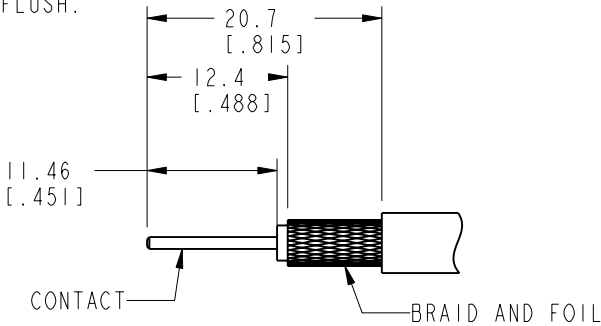

RECOMMENDED CABLE
STRIPPING DIMENSIONS

THIRD ANGLE PROJ.

REVISIONS

REV	DESCRIPTION	DATE	ECO	APPR
A	RELEASE TO MFG.	15-Mar-18	07342	KCE

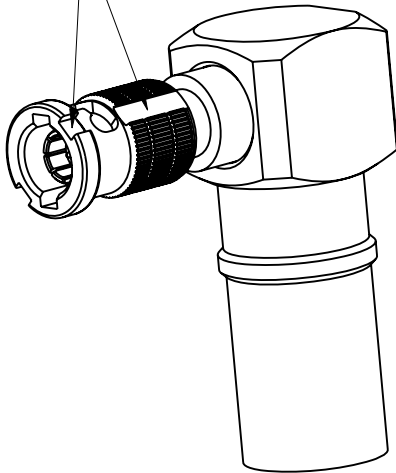
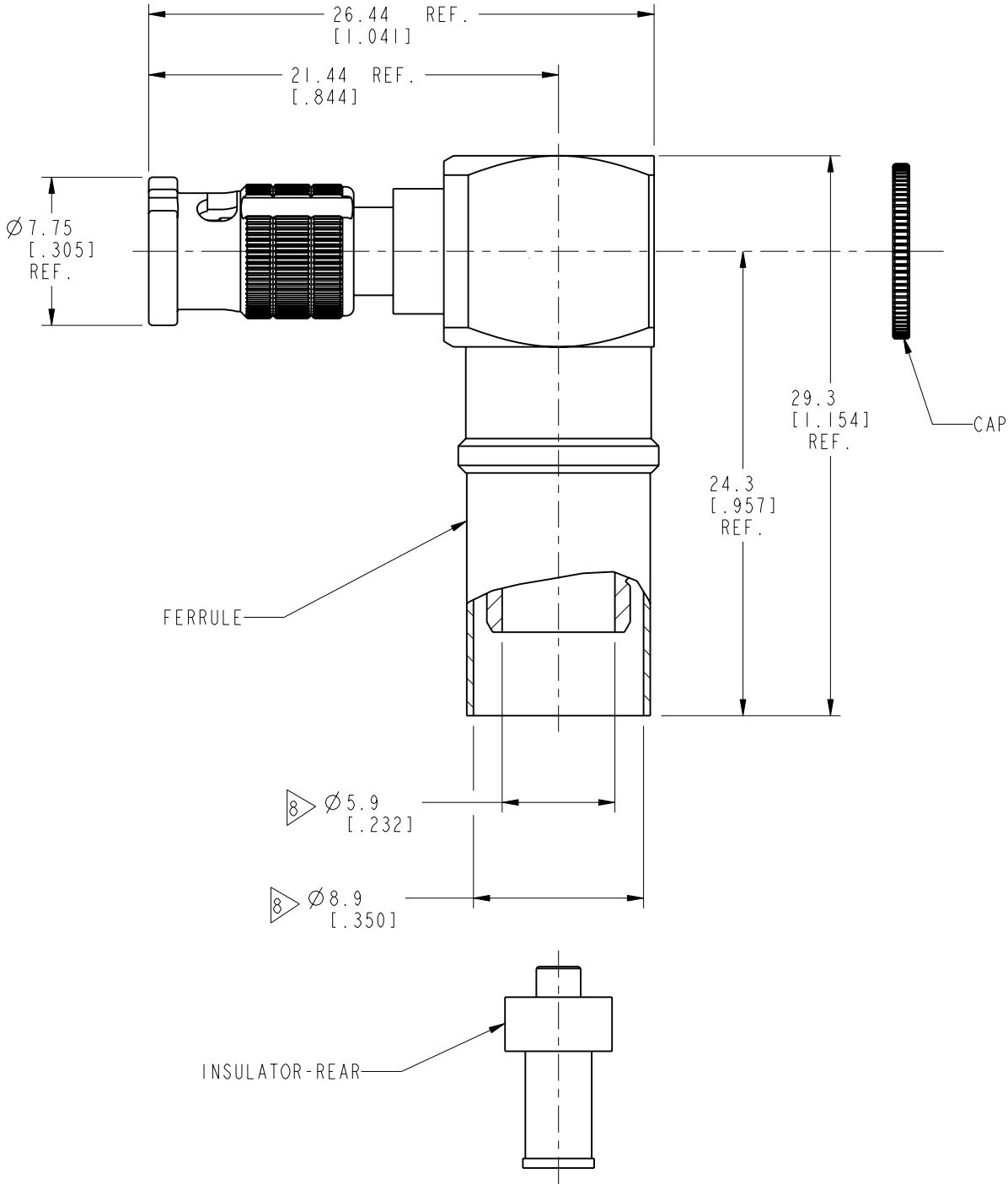

CUSTOMER OUTLINE DRAWING

ALL OTHER SHEETS ARE FOR INTERNAL USE ONLY

UNLESS OTHERWISE SPECIFIED, DIMENSIONS ARE IN METRIC AND TOLERANCES ARE:
<0.5mm ± 0.05mm 0.5 - 6mm ±0.1mm 6 - 30mm ±0.2mm 30 - 120mm ± 0.3mm ANGLES ±1°

NOTICE - These drawings, specifications, or other data (1) are, and remain the property of Amphenol corp. (2) must be returned upon request; and (3) are confidential and not to be disclosed to any person other than those to whom they are given by Amphenol Corp. the furnishing of these drawings, specifications, or other data by Amphenol Corp., or to any other person to anyone for any purpose is not to be regarded by implication or otherwise in any manner licensing, granting rights to permitting such holder or any other person to manufacture, use or sell any product, process or design, patented or otherwise, that may in any way be related to or disclosed by said drawings, specifications, or other data.

MATERIAL	SEE NOTES
REFERENCE	EAR # 8067
CONFIGURATION LEVEL:	
FINISH	

DRAWN	DATE
K. SONG	24-Mar-18
ENGINEER	DATE
K. ELMES	01-Dec-17
APPROVED	DATE
CAD FILE	

TITLE	75 OHM HD BNC RA PLUG FOR BELDEN 4794R
SCALE: 5.0:1.0	SHEET 2 OF 2
DWG SIZE	REV
B	A

Amphenol RF	www.omphenolrf.com
DRAWING NO.	34-1119-12G
ITEM NO.	34-1119-12G
PART NO.	34-1119-12G