

THIS DRAWING IS UNPUBLISHED.

RELEASED FOR PUBLICATION

20

© COPYRIGHT 20 BY -

ALL RIGHTS RESERVED.

REVISIONS

P	LTR	DESCRIPTION	DATE	DWN	APVD
	AI	REVISED PER ECR-22-143897	01 JUL 2022	SC	D. Z



KEYING TYPE (CROSS HATCH: CORNIG ZONE)

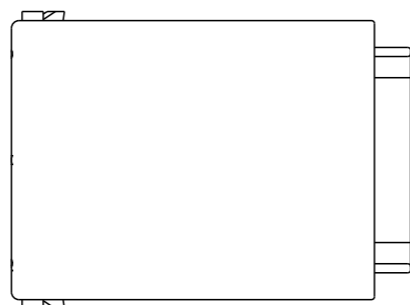
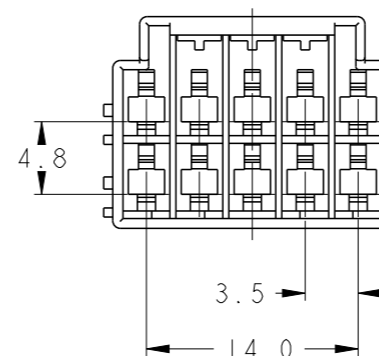
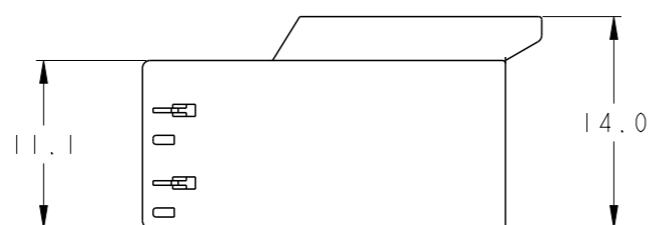
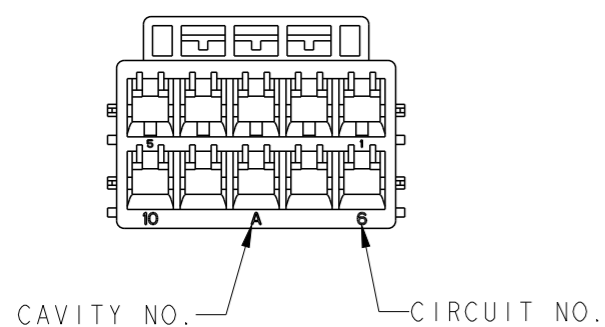
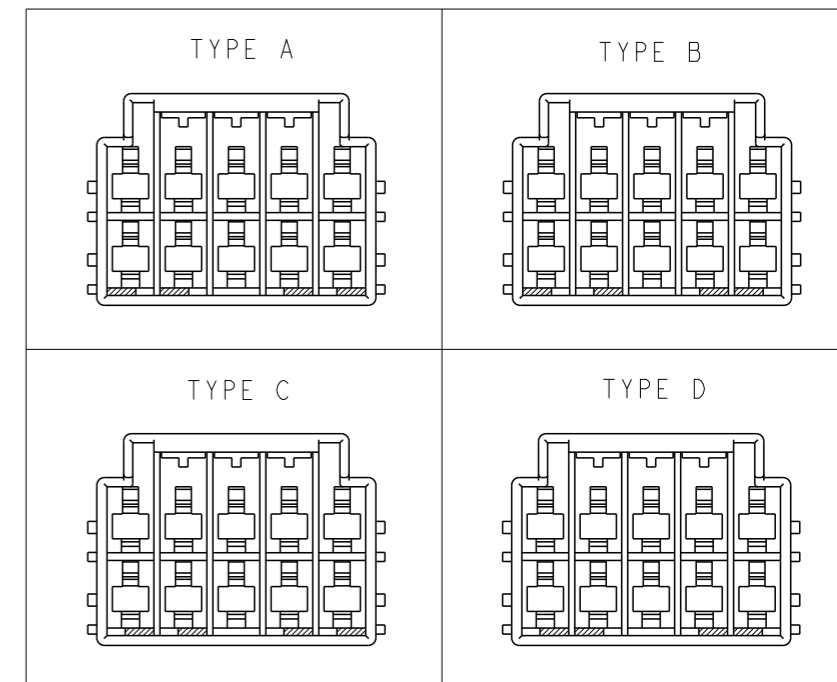

- NOTES:
 1. APPLICABLE REC CONTACT: 1565080-1, 1612335-1
 2. APPLICABLE TPA P/N: 2357094-1

3-2357092-4	D	YELLOW	3-2357093-4
2-2357092-3	C	BLUE	2-2357093-3
1-2357092-2	B	RED	1-2357093-2
2357092-1	A	NATURAL	2357093-1
MATING HSG P/N	KEYING TYPE	COLOR	P/N

THIS DRAWING IS A CONTROLLED DOCUMENT.

DWN SC KIM 20APR2021

CHK -

APVD DANIEL ZHANG 20APR2021

PRODUCT SPEC 108-5810

APPLICATION SPEC 114-5306

WEIGHT -

CUSTOMER DRAWING



NAME GRACE INERTIA 3.5W CAP 10P

SIZE CAGE CODE DRAWING NO RESTRICTED TO

A300779 C-2357093

SCALE 2:1 SHEET 1 OF 1 REV AI

DIMENSIONS: mm

TOLERANCES UNLESS OTHERWISE SPECIFIED:

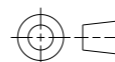

0 PLC	±-	
1 PLC	±-	
2 PLC	±-	±0.3
3 PLC	±-	
4 PLC	±-	
ANGLES	±-	
FINISH	-	

MATERIAL PA66, UL94 V-0