

PRODUCT NUMBER	PITCH
EWxx62x100J0G	10.16 mm

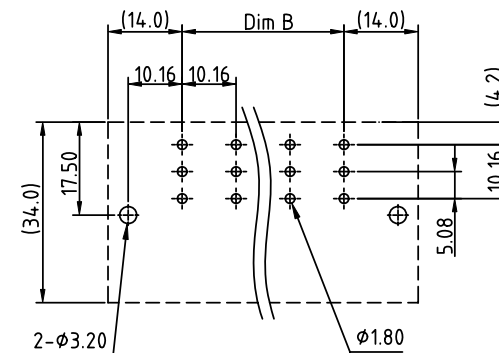

RECOMMENDED P.C.B LAYOUT  
TOP VIEW

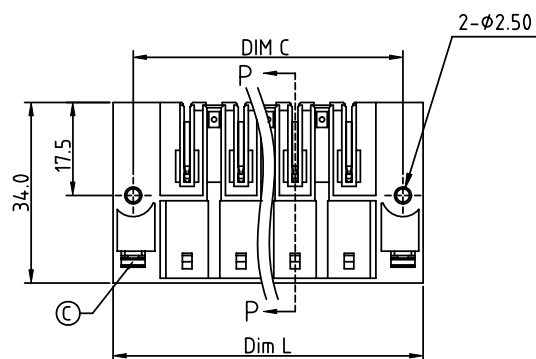
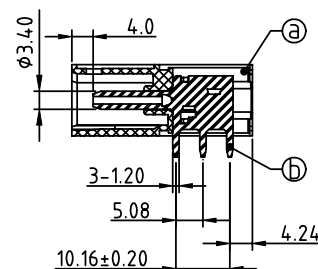
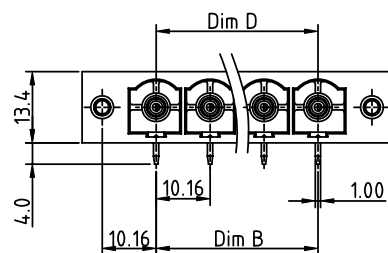

SECTION P-P

#### Material:

- Item (a) Terminal(housing): Thermoplastic(UL 94 - V0)
- Item (b) Male contact pin: Copper Gold plated
- Item (c) With flange nut : Steel zinc plated M3

#### Electrical:

- Voltage rating: 300V
- Current rating: 55A
- Withstanding Voltage: 1.6 KV
- Operating temperature: -40°C to +115°C
- Soldering temperature: 260°C±5°C/5 Sec
- Safety Approval: cULus

#### Dimension

Dim L	(N+1)×10.16+7.6
Dim B	(N-1)×10.16
Dim C	(N+1)×10.16
Dim D	(N-1)×10.16

N=Number of poles

POLES	Tolerance
2p-5p	±0.25
6p-8p	±0.35
9p-12p	±0.45

PART NO.: EW xx 62 x 1 00J0 G

Solid block	No. of poles	Color	RoHS compliant (lead<4%) In copper Alloy
0	2	Black (RAL9005)	
2	3	Red (RAL3001/D)	
3	4	Orange(RAL2011/P)	
4	5	Yellow(RAL1018/A)	
5	6	Green(RAL6018/T)	
6	8	Blue (RAL5015/A)	
8	9	Grey(RAL7035/D)	
9	12	White(RAL1102)	
C	12	Green(RAL6018/U)	

mat'l. code				surface	tolerance	projection	product family	
ltr ecn no dr date				ASME Y14.5✓	ASME Y14.5		TERMINAL BLOCK	
				tolerances unless otherwise specified		MM	title	
				angles	X.±0.5		TERMINAL BLOCK	
				Ø	X.X±0.3		PLUGGABLE SOCKET, PCB DOWN, RIGHT ANGLE, WITH FLANGE	
				X*±1°	X.XX±0.1	scale	dwg no sheet 1 of 1 size	
				dr	EVIN ZHONG 042314		EWxx62x100J0G A4	
				enr	EVIN ZHONG 042314		type	
				chr	HANKE FENG 042314		CUSTOMER Drawing	
				appd	SHI JUN 042314			
sheet index	revision	A						
	sheet	1						