

4

3

2

1

THIS DRAWING IS UNPUBLISHED.

RELEASED FOR PUBLICATION

20

© COPYRIGHT 20 BY TE Connectivity

ALL RIGHTS RESERVED.

REVISIONS

| P | LTR | DESCRIPTION | DATE | DWN | APVD |
|---|-----|------------------------|-----------|-----|------|
| | A3 | REVISED(ECR-21-114989) | 07.OCT.21 | SJ | YJ |

NOTE

1. APPLICABLE FEMALE CONNECTOR P/NO
 - 1-2005582-2 : 5-1419168-8 (CODE A)
 - 1-2005582-3 : 5-1419168-9 (CODE B)
 2. GENERAL TOLERANCE : ± 0.3
 3. APPLICABLE CONTACT P/NO :

| NO | P/NO | DESCRIPTION | WIRE SIZE |
|----|--------|-----------------|-------------------------|
| 1 | 928918 | .025 SEALED TAB | 0.2-0.5mm ² |
| 2 | 963716 | .025 SEALED TAB | 0.5-0.75mm ² |

4. APPLIED BOLT TORQUE : MAX 0.25 ~ 0.3kgf m, M4*12 SCREW WITH WASHER
 5. REFER TO FIGURE OF VARIANCE
 6. APPLIED BOLT TORQUE : MAX 0.6kgf m, M4*12 SCREW

| NO | DESCRIPTION | MATERIAL | COLOR | Q'TY |
|----|--------------------------|----------|--------|------|
| 5 | COMPRESSION LIMITER | SPCC | - | 2 |
| 4 | SEAL FOR 025 16P CAP HSG | SILICONE | ORANGE | 1 |
| 3 | 025 16P CAP HSG CODE B | PBT-GF15 | BLACK | 1 |
| 2 | 025 16P CAP HSG CODE A | PBT-GF15 | BLACK | 1 |
| 1 | 025 16P CAP HSG CODE A | PBT-GF15 | BLACK | 1 |

THIS DRAWING IS A CONTROLLED DOCUMENT.

| | |
|-----------------------|---|
| DIMENSIONS: mm | TOLERANCES UNLESS OTHERWISE SPECIFIED: 0 PLC 1 PLC ± 0.5 2 PLC ± 0.13 3 PLC ± 0.013 4 PLC ± 0.0001 ANGLES \pm |
| MATERIAL SEE TABLE | FINISH N/A |

| | |
|------------------|---|
| DWN JH CHU | - |
| CHK YH MA | - |
| APVD YJ YOUN | - |
| PRODUCT SPEC | - |
| APPLICATION SPEC | - |
| WEIGHT | - |
| CUSTOMER DRAWING | - |

025 16P SEALED CAP ASSEMBLY

| | | | |
|--------------|----------------|-------------------------|---------------|
| SIZE A3 | CAGE CODE - | DRAWING NO C-2005582 | RESTRICTED TO |
| SCALE 1:1 | SHEET 1 | OF 2 | REV A3 |

1470-19 (3/13)

Downloaded from Arrow.com

REVISIONS

| P | LTR | DESCRIPTION | DATE | DWN | APVD |
|---|-----|-------------|------|-----|------|
| - | - | SEE SHEET 1 | - | - | - |
| | | | | | |
| | | | | | |

5 VARIANCE

| PART NO. | 2005582-2 | 1-2005582-2 | 1-2005582-3 |
|---------------------|---|-------------|-------------|
| | CODE A | CODE A | CODE B |
| PLUG CODE INTERFACE | | | |
| INTERFACE DRAWING | <p>This surface must be clean (water proof area), Roughness ; Ra1.6</p> | | |

THIS DRAWING IS A CONTROLLED DOCUMENT.

DWN SM LEE

CHK KT LIM

APVD HG CHO

PRODUCT SPEC

APPLICATION SPEC

WEIGHT

CUSTOMER DRAWING



025 16P SEALED CAP ASSEMBLY

| SIZE | CAGE CODE | DRAWING NO | RESTRICTED TO |
|------|-----------|------------|---------------|
|------|-----------|------------|---------------|

| | | | |
|----|---|---------|--|
| A3 | - | 2005582 | |
|----|---|---------|--|

| | | |
|-----------|--------------|--------|
| SCALE 1:1 | SHEET 2 OF 2 | REV A3 |
|-----------|--------------|--------|

DIMENSIONS: mm

TOLERANCES UNLESS OTHERWISE SPECIFIED:

- 0 PLC ±0.5
- 1 PLC ±0.13
- 2 PLC ±0.013
- 3 PLC ±0.0001
- 4 PLC ±
- ANGLES ±
- FINISH

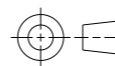

MATERIAL SEE TABLE

N/A