

DISCRIPTION: DIP SOLDER MALE/STAMPED

SPECIFICATIONS:

MATERIALS:

SHELL: STEEL, NICKEL PLATED
 INSULATOR: UL 94V-0 RATED PA6T
 CONTACT: BRASS WITH GOLD PLATING
 RoHS COMPLIANT

ELECTRICALS:

CURRENT RATING: 5 AMPS
 CONTACT RESISTANCE: 15 mOHMS MAX
 INSULTOR RESISTANCE: 1000 MOHMS MIN
 VOLTAGE: 500V AC FOR 1 MINUTE
 TEMPERATURE: -55°C TO +125°C

| DIMENSIONS (in/mm) | | | | | | |
|--------------------|-------|-------|-------|-------|-------|-------|
| POS. | A | B | C | D | E | F |
| 9 | 1.213 | 0.984 | 0.666 | 0.756 | 0.329 | 0.496 |
| | 30.80 | 24.99 | 16.92 | 19.20 | 8.36 | 12.60 |
| 15 | 1.541 | 1.312 | 0.994 | 1.091 | 0.329 | 0.496 |
| | 39.15 | 33.32 | 25.25 | 27.70 | 8.36 | 12.60 |
| 25 | 2.087 | 1.853 | 1.534 | 1.618 | 0.329 | 0.496 |
| | 53.00 | 47.04 | 38.96 | 41.10 | 8.36 | 12.60 |
| 37 | 2.728 | 2.500 | 2.181 | 2.256 | 0.329 | 0.496 |
| | 69.30 | 63.50 | 55.42 | 57.30 | 8.36 | 12.60 |
| 50 | 2.638 | 2.406 | 2.079 | 2.169 | 0.436 | 0.602 |
| | 67.00 | 61.00 | 52.80 | 55.10 | 11.07 | 15.30 |

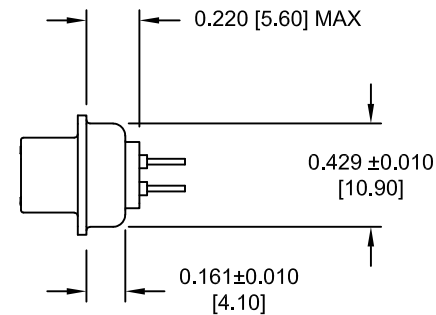
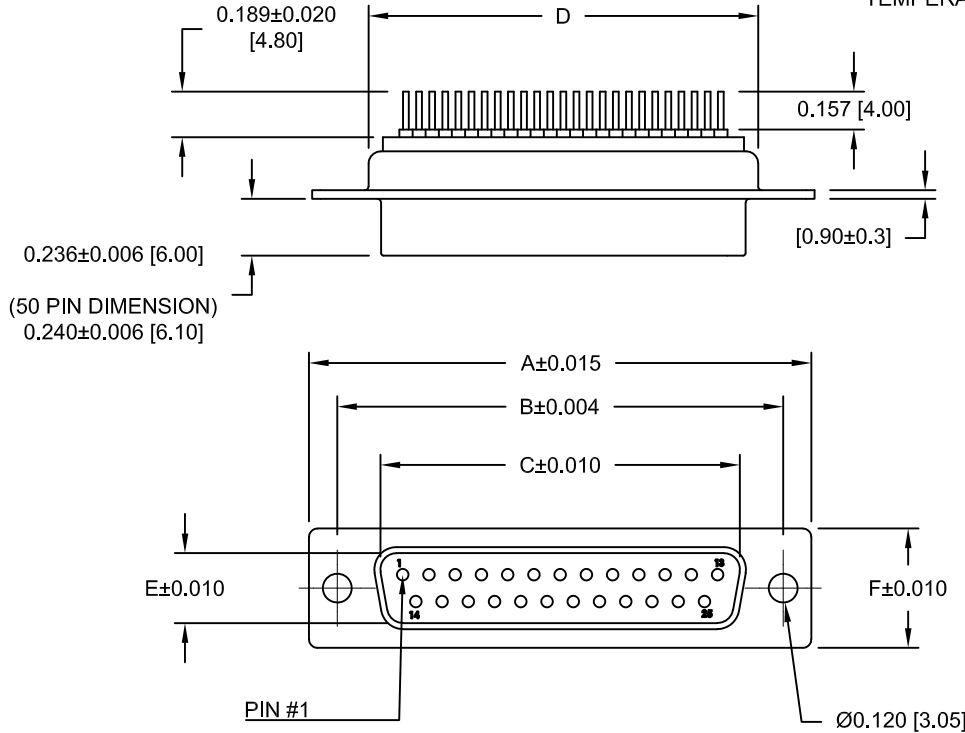

171-YYY-113RYY1

SERIES _____
 POSITIONS _____
 009
 015
 025
 037
 050
 GENDER _____
 1 = MALE
 2 = FEMALE
 TERMINATION _____
 1 = DIP SOLDER
 SHELL PLATING _____
 3 = NICKEL
 HARDWARE OPTIONS _____
 00 = NO HARDWARE
 01 = .098" 4-40 CLINCH NUT BOARD SIDE
 02 = .236" 4-40 CLINCH NUT BOARD SIDE
 03 = .236" 4-40 CLINCH NUT MATING SIDE
 05 = .237" 4-40 BOARD LOCK
 08 = .228" 4-40 BOARD LOCK
 90 = .237" 4-40 BOARD LOCK
 FOR 0.093" BOARD
 91 = .237" 4-40 SPACER/BOARD LOCK
 92 = .237" 4-40 SPACER/BOARD LOCK
 FOR 0.093" BOARD
 PLATING OPTIONS _____
 1 = GOLD FLASH
 2 = 30 MICRO-INCH GOLD

UNITS = inch [mm]

DO NOT SCALE FROM DRAWING

| | | | | |
|--|---|--|-----------------------|------------------|
|  | THESE DRAWINGS AND SPECIFICATIONS ARE THE PROPERTY OF NorComp AND SHALL NOT BE REPRODUCED, COPIED OR USED AS THE BASIS FOR THE MANUFACTURE OF SALE OF APPARATUS WITHOUT WRITTEN PERMISSION. | | DRAWN: PAM JENKINS | DATE: 9-12-05 |
| | <h1>NorComp</h1> | | SCALE: NTS | SHEET 1 OF 3 |
| DWG NO. 171-YYY-113RYY1 | | | | |

RoHS COMPLIANT

DESCRIPTION: PCB LAYOUT - STANDARD "D" - MALE & FEMALE

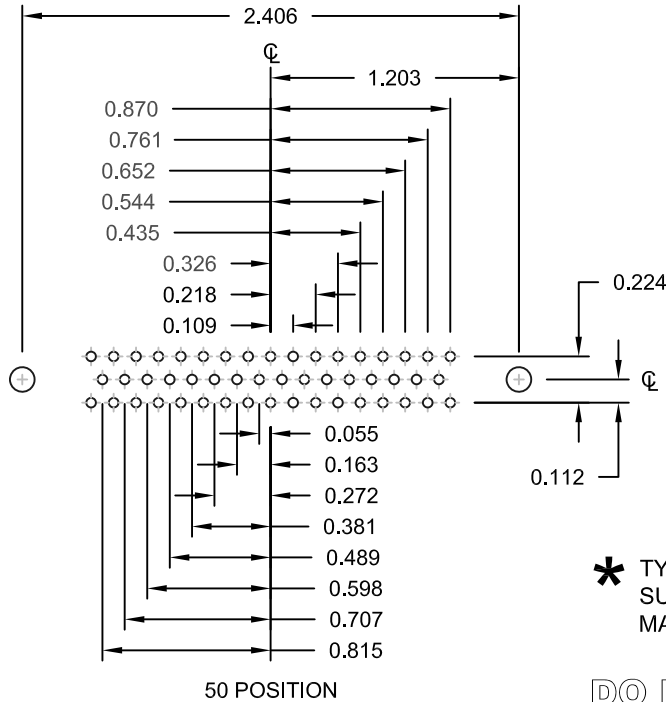
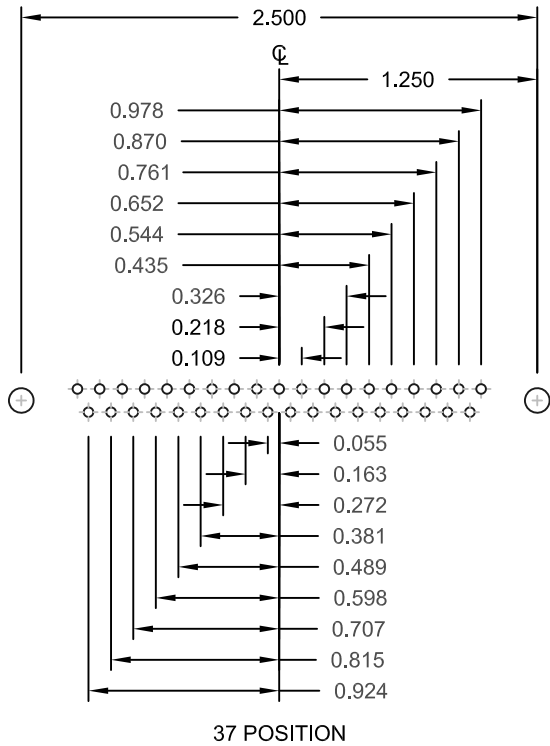
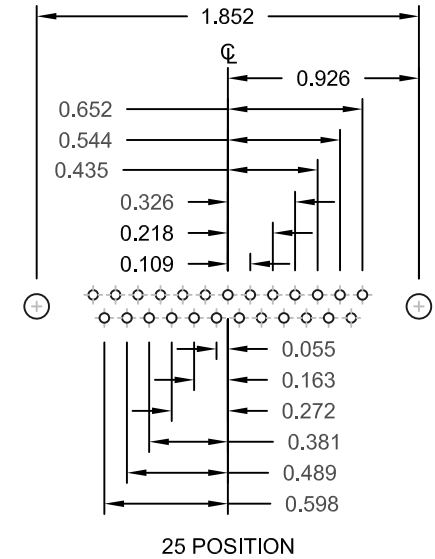
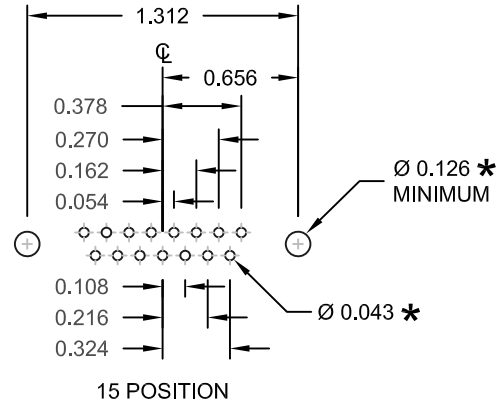
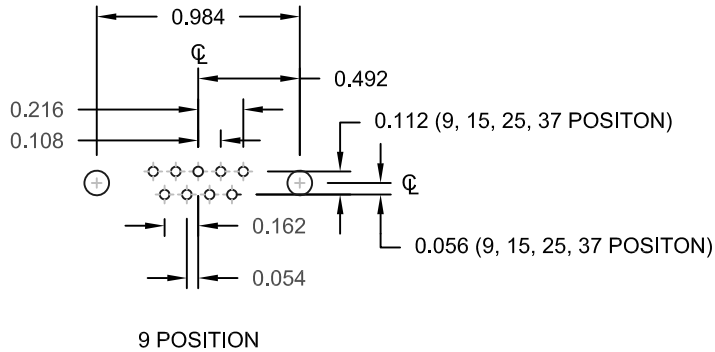

UNITS = inch

* TYP.
SUGGESTED SIZE
MAY NOT BE SUITABLE FOR ALL APPLICATIONS

DO NOT SCALE FROM DRAWING



THESE DRAWINGS AND SPECIFICATIONS ARE THE PROPERTY OF NorComp AND SHALL NOT BE REPRODUCED, COPIED OR USED AS THE BASIS FOR THE MANUFACTURE OF SALE OF APPARATUS WITHOUT WRITTEN PERMISSION.

DRAWN:
PAM JENKINS

DATE:
9-12-05

NorComp

SCALE:
NTS

SHEET 2 OF 3

REV 16

DWG NO. 171-YYY-113RYY1

ALL CLINCH-NUTS ARE 4-40 INTERNAL THREADS

TOLERANCE:
ALL DIMENSIONS ARE ±0.010

01X 0.098" (BOARD SIDE)

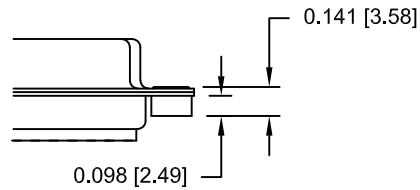

02X 0.236" (BOARD SIDE)

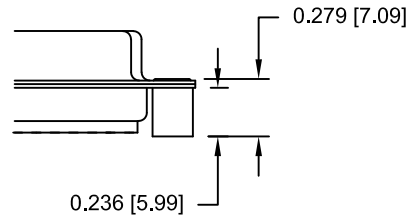

03X..... 0.236" (MATING SIDE)

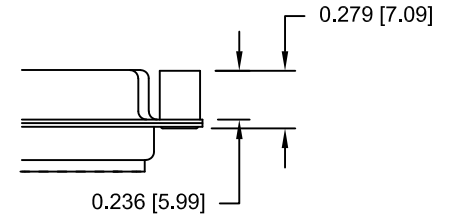

05X 0.237" (BOARD SIDE)

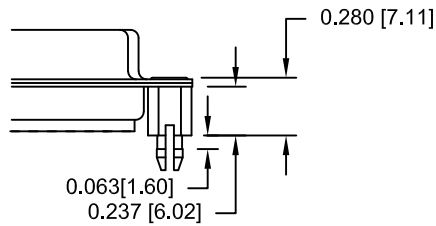

08X 0.228" (BOARD SIDE)

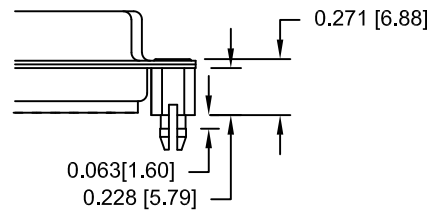

91X 0.237" BOARD SIDE

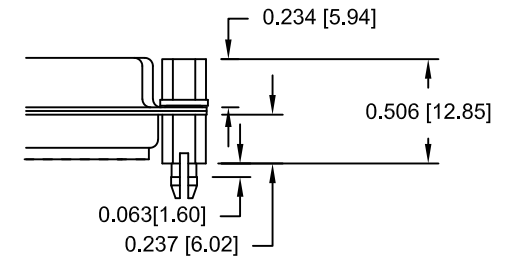

90X 0.237" (BOARD SIDE)

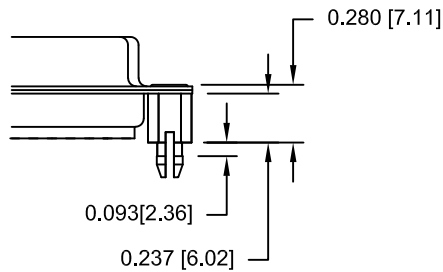

92X 0.237" BOARD SIDE

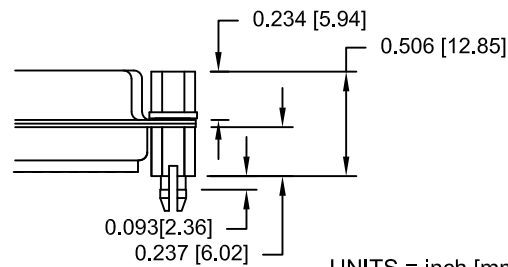

NOTE: 4-40 FEMALE SCREW LOCK IS REMOVABLE

UNITS = inch [mm] DO NOT SCALE FROM DRAWING



THESE DRAWINGS AND SPECIFICATIONS ARE THE PROPERTY OF NorComp AND SHALL NOT BE REPRODUCED, COPIED OR USED AS THE BASIS FOR THE MANUFACTURE OF SALE OF APPARATUS WITHOUT WRITTEN PERMISSION.

DRAWN:
PAM JENKINS

DATE:
9-12-05

NorComp

SCALE: NTS SHEET 3 OF 3 REV 16

DWG NO. 171-YYY-113RYY1

RoHS COMPLIANT