

DIALIGHT PART NO.	LED COLOR
598-2K00-107F	WHITE
598-2K00-102F	(X=0.30,Y=0.30)

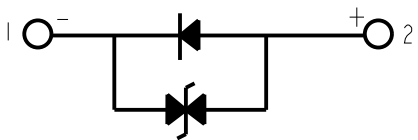

LED SCHEMATIC

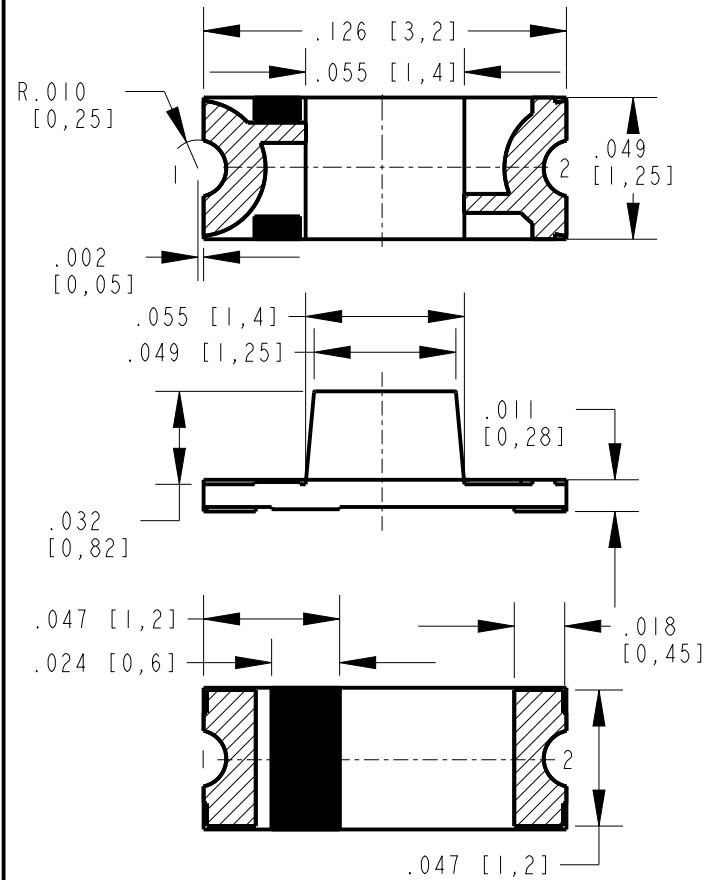
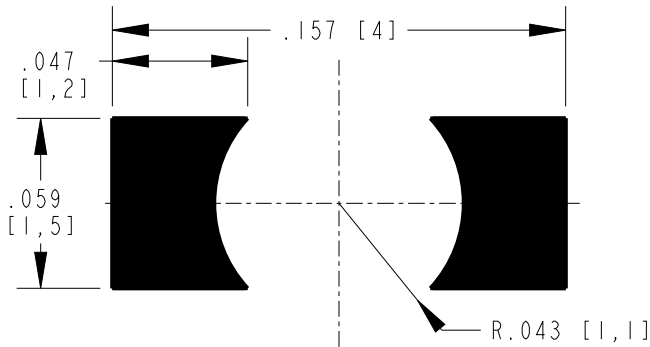

RECOMMENDED SOLDER PAD LAYOUT

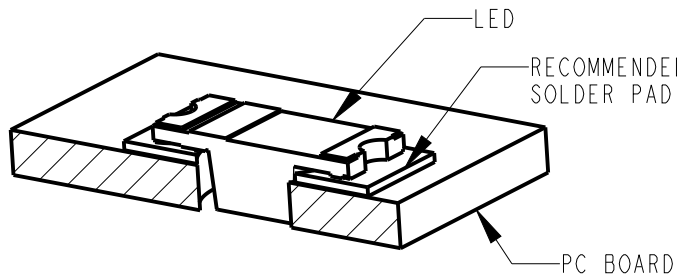

NOTES:

- PIN NUMBERS ARE FOR REFERENCE ONLY, DESIGNATION NON-EXISTENT ON PART.
- LABELING FOR REEL AND OUTSIDE OF ALUMINUM BAG, DIALIGHT P/N, QUANTITY PER REEL, DATE CODE, INTENSITY BIN CODE, LOT NUMBER AND COUNTRY OF ORIGIN.
- THIS PRODUCT IS RoHS COMPLIANT. EACH BAG IS TO BE MARKED WITH RoHS COMPLIANT LABEL OR EQUIVALENT MARKINGS. LED MUST BE Pb FREE.
- MOISTURE SENSITIVITY LEVEL 3.
- QUANTITY : PART NUMBERS END WITH 107F REFER AS 3000 PCS/ REEL
PART NUMBERS END WITH 102F REFER AS 20 PCS/ STRIP

Carrier Tape Dimension

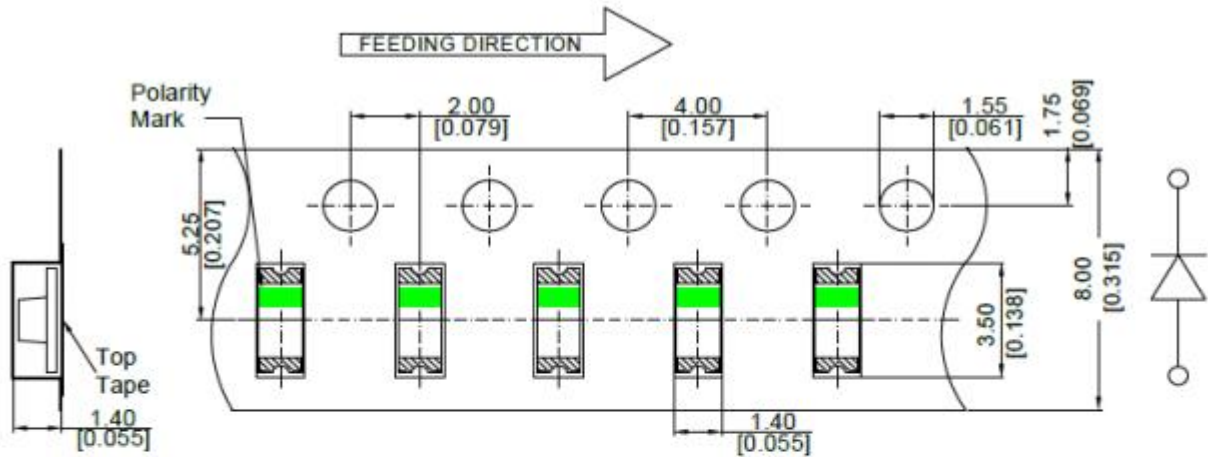

TAPING SPECIFICATIONS

Reel Dimension

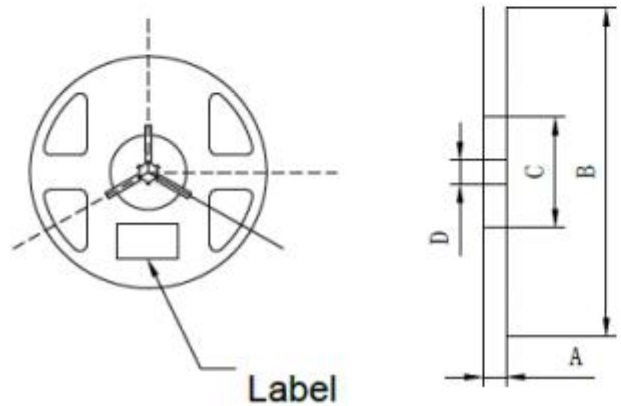

TOLERANCE (UNLESS OTHERWISE SPECIFIED): $\pm 0.003 (\pm 0.1 \text{ mm})$

A	8.0±0.1mm
B	178±1mm
C	60±1mm
D	13.0±0.5mm

ABSOLUTE MAXIMUM RATINGS AT 25°C							
LED COLOR	POWER DISSIPATON (mW)	FORWARD CURRENT (mA)	PEAK FORWARD CURRENT (mA)	OPERATING TEMPERATURE (°C)	STORAGE TEMPRATURE (°C)	DERATING CURVE FROM 25°C (mA/°C)	ELECTROSTATIC DISCHARGE (V)
WHITE	68	20	60	-40°C TO +85°C	-40°C TO +85°C	0.250	5000

OPERATING CHARACTERISTICS AT 25°C AMBIENT									
LED COLOR	TEST CONDITION (mA)	LUMINOUS INTENSITY (mcd)		FORWARD VOLTAGE (V)		CHROMATICITY COORDINATES (CALCULATED)	REVERSE CURRENT (uA)	VIEWING ANGLE (DEGREES)	THERMAL RESISTANCE °C/W
	TYP	MIN	MAX	MIN	MAX	TYP	MAX	TYP	MAX
WHITE	5mA	100	350	2.6	3.4	X=0.300 Y=0.302	10µA @ VR=5V	140	450

REV	ECN NO	REVISIONS	DRN	CKD	APP	DATE
A	106343	NEW RELEASE	JSG	CS	NO	02JUN23

RECOMMENDED RoHS SOLDER PROFILE

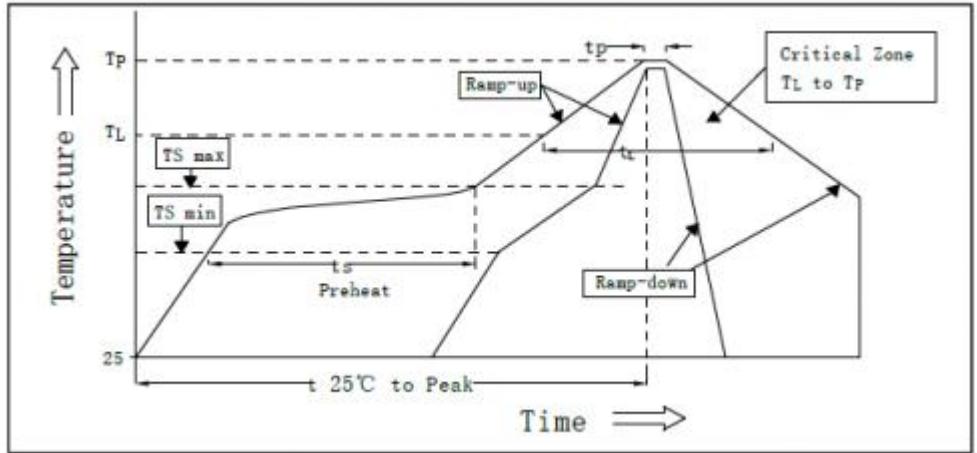

MARK	DEFINITION	CONDITION
TS _{max}	MAXIMUM OF PRE-HEATING TEMPERATURE	200°C
TS _{min}	MINIMUM OF PRE-HEATING TEMPERATURE	150°C
T _s	TIME FORM T _{smin} To T _{smax}	60s-120s
T _L	REFERENCE TEMPERATURE	217°C
t _L	RETENTION TIME FOR T _L	60s-150s
T _P	PEAK TEMPERATURE	260°C
t _p	TIME FOR PEAK TEMPERATURE	WITHIN 10s
DTr/Dt	TEMPERATURE RISING RATE	WITHIN 3°C/sec
DTd/Dt	TEMPERATURE DECREASING RATE	WITHIN 6°C/sec



ATTENTION:
OBSERVE PRECAUTIONS FOR
HANDLING ELECTROSTATIC
SENSITIVE DEVICES

THIS DRAWING AND THE CONTENTS HEREIN ARE CONFIDENTIAL AND THE SOLE PROPERTY OF DIALIGHT CORP. REPRODUCTION OF THIS DRAWING OR CONSTRUCTION OF ANY PARTS WITHIN THIS DRAWING ARE FORBIDDEN WITHOUT THE WRITTEN CONSENT OF DIALIGHT CORP.			
DIALIGHT CORP INTERNAL REFERENCE ONLY = 3D MODEL : 4500521862823- .2			
SCALE: 15.00		DRAWING NUMBER	
ALL DIM's: INCH (mm)		REV	
TOLERANCES: UNLESS OTHERWISE SPECIFIED		A	
FRACTIONS: ±1/64 DECIMALS (.XX): ±.01 DECIMALS (.XXX): ±.005 DECIMALS (.XXXX): ±.0005 ANGLES: ±1°		C-18668	
FINISH		TITLE	
-		1206 REVERSE MOUNT WHITE LED	
		MATERIAL	
		-	
FSCM 83330		Dialight	
		1501 ROUTE 34 SOUTH FARMINGDALE, NJ 07727 (732) 919-3119 www.dialight.com	
		SHEET 1 OF 1 FAMILY TABLE:	