

[Find by Feature](#)
[Browse by Category](#)
[Share](#)
 [Search →](#)

Enter part number or keyword

[Search Results \(0\)](#)
[Search Options](#)

Select a product type to narrow your search:

[Terminal](#)

Results with your selections: --

Blade size [mm] ▼

Terminal family ▼

Material ▼

Plating ▼

Gender ▼

Sealed ▼

Inside Ring Diameter [mm] ▼

Outside Ring Diameter [mm] ▼

Minimum Cable Core Cross Section [mm²] ▼

Maximum Cable Core Cross Section [mm²] ▼

Minimum Cable Diameter [mm] ▼

Maximum Cable Diameter [mm] ▼

[Clear](#)
[Search →](#)

Spade Tin Plated Terminal, Cable Insulation Range 4.67 - 4.52 mm

Part #12004436

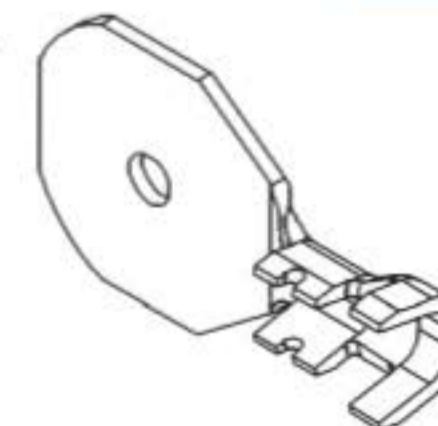

[Question about this product?](#)

[Attributes](#)
[Documents \(2\)](#)

| | |
|---|--|
| Part #: | 12004436 |
| Description: | Spade Tin Plated Terminal, Cable Insulation Range 4.67 - 4.52 mm |
| Product Type: | Terminal |
| Status: | Active |
| Terminal family: | Spade |
| Sealed: | Unsealed |
| Plating: | Tin |
| Minimum Cable Core Cross Section [mm²]: | 3.00 |
| Maximum Cable Core Cross Section [mm²]: | 3.00 |
| Minimum Cable Diameter [mm]: | 4.67 |
| Maximum Cable Diameter [mm]: | 4.67 |
| Inside Ring Diameter [mm]: | 3.20 |
| Outside Ring Diameter [mm]: | 10.40 |
| Weight [g]: | 3.21 |
| ELV compliant: | Yes |
| RoHs compliant: | Yes |

Certain products listed on this website may be subject to restricted usage or distribution or may not be available. For additional information, please contact your local sales office.