

section A  
Ech:15

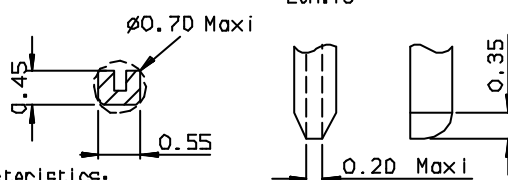

# REQUIREMENTS

## Technical characteristics:

Shell: steel tin plated  
Insulators: self-extinguishing black polyester, UL Class 94V0  
Contacts size 20: phosphor bronze, 0.4μ min. gold on mating end, bright tin on termination end over nickel on entire contact  
Cycles > 500  
Nuts: brass, tin plated

## Electrical characteristics:

max. current rating: 5A  
Test voltage: 1000V  
Rated voltage: 300V  
Contact resistance: <15mΩ  
Shell resistance: <5mΩ  
Insulation resistance: >5000MΩ

## Climatic characteristics:

Operating temperature range: -55°C +125°C

## Dimensions:

In accordance with MIL-C-24308  
inches are in parenthesis

Cotes Bt	A ±0.38	B ±0.12	C ±0.10	D +0.25 0	E	F	G +0.15 0	PART NUMBER	PART NUMBER SIEMENS
09	<1.213> 30.81	<.983> 24.99	<.667> 16.95	<.661> 16.79	<.108> 2.74	<.0539> 1.37	<.232> 5.90	D09P43F5PL00**	
15	<1.541> 39.14	<1.312> 33.32	<.991> 25.18	<.989> 25.12	<.108> 2.74	<.0539> 1.37	<.232> 5.90	D15P43F5PL00**	295 998
25	<2.088> 53.03	<1.852> 47.04	<1.540> 39.12	<1.529> 38.84	<.109> 2.76	<.0545> 1.38	<.224> 5.70	D25P43F5PL00**	296 004
37	<2.750> 69.32	<2.500> 63.50	<2.192> 55.68	<2.177> 55.30	<.109> 2.76	<.0545> 1.38	<.224> 5.70	D37P43F5PL00**	296 012

LF FOR LEAD FREE

FOR ROHS DETAILS REFER DNG.NO: C01-8646-0000

Utr	Eon no	Dr	date
F	105-0124	J5	27/7/05

Dr JOHN SLEIBA		8/9/02	Product Family	D-SUB	Tolerance LINEAR ±0.1 ANGULAR ±1°	Projection A3	MM
Eng GEORGE VJ		8/9/02	Spec ref				
Chr GEORGE VJ		27/7/05	Material				
Appr K Somasundaram		27/7/05					
Title		PIN CONNECT.SUB right angled split with nut, plastic bracket		Dng no		C01-8646-0093	
Catalog no		DELTA-D		CUSTOMER COPY		Sheet 1 of 1	

f	27/7/05	LEAD FREE DETAILS ADDED
INDEX	DATE	REVISION DESCRIPTION