

PRODUCT NO.

SEE TABLE

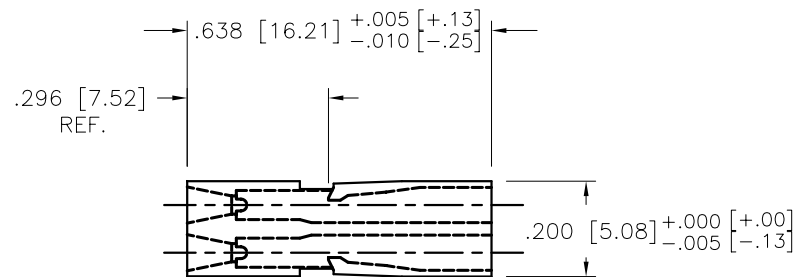
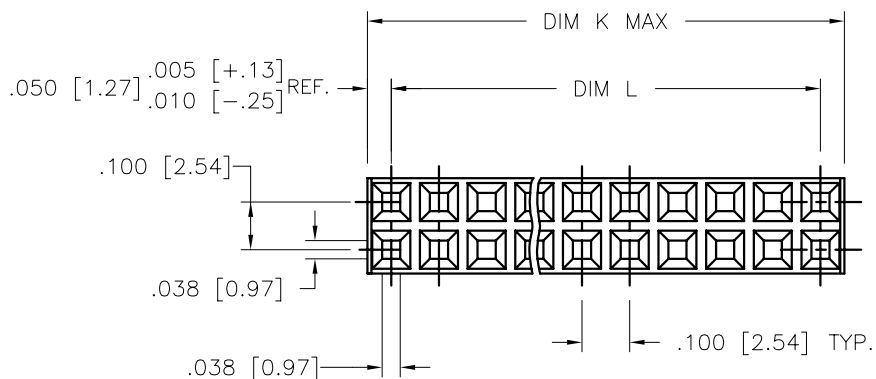
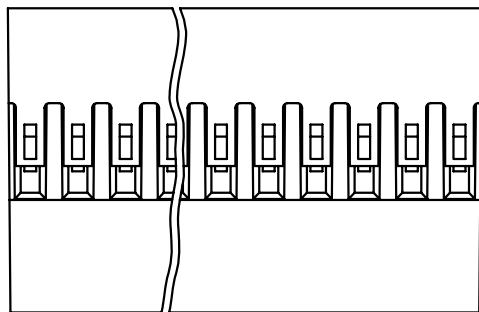

mat'l. code SEE NOTE 1				surface	tolerance	projection	product family PV HOUSINGS	
ltr	ec'n no	dr	date	tolerances unless otherwise specified		 INCH/MM scale 2:1	title	
F	v03-1289	TAB	2003-12-08	angles	linear		MINI LATCH HOUSING DR	
G	v03-1359	VS	2004-03-10				.100[2.54]CC FOR .318[8.08] PIN	
H	v05-0715	HTB	2005-07-29	0°±2'			dwg no	
J	v06-0421	HTB	2006-05-09	dr	L. SANDERS	1995-03-28	sheet 1 of 4	
K	v07-0532	HTB	2007-08-16	engr	L. FYE	1995-03-28	size	
				chr	T. BREWBAKER	1995-03-28	A3	
				appd	L. FYE	1995-03-28	type	
sheet		revision	K	K	K	K	Product Customer Drawing	
index		sheet	1	2	3	4		

PRODUCT NO.  
SEE TABLE

PUSH TO  
INSTALL

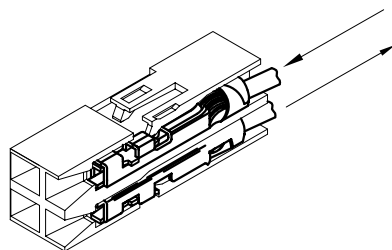

FIGURE 1

HAND TOOL HT-80

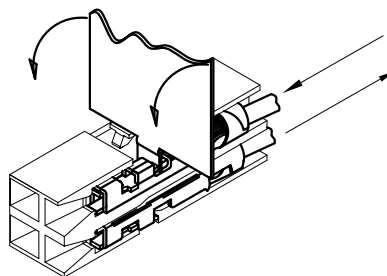
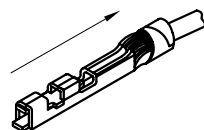

FIGURE 2

NOTES:

1. MOLDING MATERIAL MODIFIED POLYPHENYLENE ETHER, FLAME RETARDANT PER UL 94V-0, COLOR: BLACK.
2. PIN LENGTH TO BE .303/7.70. RECOMMENDED PIN LENGTH IS  $.318 \pm .015$  [8.08  $\pm$  0.38]
3. THIS HOUSING IS INTENDED FOR USE WITH MINI PV™ TERMINAL WITH 22-36 GAUGE WIRE.
4. TO LATCH TERMINAL PUSH AS SHOWN IN FIGURE 1, BE SURE THAT LATCH SNAPS DOWN.
5. TO REMOVE TERMINAL; PUSH TERMINAL FORWARD, LIFT LATCH WITH HAND TOOL AS SHOWN IN FIGURES 2 & 3. DAMAGE TO LATCH MAY OCCURE IF LIFTED MORE THAN A 25° ANGLE TO THE TOP OF HOUSING.
6. TERMINAL MUST BE CRIMPED PROPERLY FOR SATISFACTORY LATCHING. SEE TA-75 FOR CRIMPING INSTRUCTIONS. PRODUCT SPECIFICATION: BUS-12-067.
7. ALL MARKINGS USE 6 POINT TYPE (APPROX. .06/1.52 HIGH) AND WHITE INK (MARKEM #8829 OR EQUIV.) WHEN MARKING CAVITIES, NUMERALS OR LETTERS ARE TO BE CENTERED ON RESPECTIVE CAVITIES UNLESS OTHER-WISE NOTED.
8. PRODUCT MEETS EUROPEAN UNION DIRECTIVES AND OTHER COUNTRY REGULATIONS AS DESCRIBED IN GS-22-008.
9. THE PRODUCT IS NOT INTENDED TO BE EXPOSED TO A MANUFACTURING SOLDER PROCESS.



TO REMOVE TERMINAL  
SEE NOTE 5

FIGURE 3

mat'l. code SEE NOTE 1				surface	tolerance	projection	product family
ltr	ec'n no	dr	date				PV HOUSINGS
K				tolerances unless otherwise specified			title
				angles	linear	INCH/MM	MINI LATCH HOUSING DR
				0°±2°		scale 2:1	.100[2.54]CC FOR .318[8.08] PIN
				dr	L. SANDERS	1995-03-28	dwg no
				engr	L. FYE	1995-03-28	sheet 2 of 4
				chr	T. BREWBAKER	1995-03-28	size
				appd	L. FYE	1995-03-28	A3
sheet	revision						type
index	sheet						Product Customer Drawing



FCIconnected.com

Copyright FCI

PRODUCT NO.	NO OF POS	DIM K MAX	DIM L	STYLE NOTES 7
66415-001LF	72	3.600/91.44	3.500/88.90	
66415-002LF	70	3.500/88.90	3.400/86.36	
66415-003LF	68	3.400/86.36	3.300/83.82	
66415-004LF	66	3.300/83.82	3.200/81.26	
66415-005LF	64	3.200/81.26	3.100/78.74	
66415-006LF	62	3.100/78.74	3.000/76.20	
66415-007LF	60	3.000/76.20	2.900/73.66	
66415-008LF	58	2.900/73.66	2.800/71.12	
66415-009LF	56	2.800/71.12	2.700/68.58	
66415-010LF	54	2.700/68.58	2.600/66.04	
66415-011LF	52	2.600/66.04	2.500/63.50	
66415-012LF	50	2.500/63.50	2.400/60.96	
66415-013LF	48	2.400/60.96	2.300/58.42	
66415-014LF	46	2.300/58.42	2.200/55.88	
66415-015LF	44	2.200/55.88	2.100/53.34	
66415-016LF	42	2.100/53.34	2.000/50.80	
66415-017LF	40	2.000/50.80	1.900/48.26	
66415-018LF	38	1.900/48.26	1.800/45.72	
66415-019LF	36	1.800/45.72	1.700/43.18	
66415-020LF	34	1.700/43.18	1.600/40.64	
66415-021LF	32	1.600/40.64	1.500/38.10	
66415-022LF	30	1.500/38.10	1.400/35.56	
66415-023LF	28	1.400/35.56	1.300/33.02	
66415-024LF	26	1.300/33.02	1.200/30.48	
66415-025LF	24	1.200/30.48	1.100/27.94	
66415-026LF	22	1.100/27.94	1.000/25.40	
66415-027LF	20	1.000/25.40	.900/22.86	
66415-028LF	18	.900/22.86	.800/20.32	
66415-029LF	16	.800/20.32	.700/17.78	
66415-030LF	14	.700/17.78	.600/15.24	
66415-031LF	12	.600/15.24	.500/12.70	
66415-032LF	10	.500/12.70	.400/10.16	
66415-033LF	8	.400/10.16	.300/7.62	
66415-034LF	6	.300/7.62	.200/5.08	
66415-035LF	4	.200/5.08	.100/2.54	
66415-036LF	30	1.500/38.10	1.400/35.56	A
66415-037LF	14	.700/17.78	.600/15.24	A
66415-038LF	72	3.600/91.44	3.500/88.90	D
66415-039LF	70	3.500/88.90	3.400/86.36	D
66415-040LF	68	3.400/86.36	3.300/83.82	D
66415-041LF	66	3.300/83.82	3.200/81.26	D
66415-042LF	64	3.200/81.26	3.100/78.74	D

PRODUCT NO.	NO OF POS	DIM K MAX	DIM L	STYLE NOTES 7
66415-043LF	62	3.100/78.74	3.000/76.20	D
66415-044LF	60	3.000/76.20	2.900/73.66	D
66415-045LF	58	2.900/73.66	2.800/71.12	D
66415-046LF	56	2.800/71.12	2.700/68.58	D
66415-047LF	54	2.700/68.58	2.600/66.04	D
66415-048LF	52	2.600/66.04	2.500/63.50	D
66415-049LF	50	2.500/63.50	2.400/60.96	D
66415-050LF	48	2.400/60.96	2.300/58.42	D
66415-051LF	46	2.300/58.42	2.200/55.88	D
66415-052LF	44	2.200/55.88	2.100/53.34	D
66415-053LF	42	2.100/53.34	2.000/50.80	D
66415-054LF	40	2.000/50.80	1.900/48.26	D
66415-055LF	38	1.900/48.26	1.800/45.72	D
66415-056LF	36	1.800/45.72	1.700/43.18	D
66415-057LF	34	1.700/43.18	1.600/40.64	D
66415-058LF	32	1.600/40.64	1.500/38.10	D
66415-059LF	30	1.500/38.10	1.400/35.56	D
66415-060LF	28	1.400/35.56	1.300/33.02	D
66415-061LF	26	1.300/33.02	1.200/30.48	D
66415-062LF	24	1.200/30.48	1.100/27.94	D
66415-063LF	22	1.100/27.94	1.000/25.40	D
66415-064LF	20	1.000/25.40	.900/22.86	D
66415-065LF	18	.900/22.86	.800/20.32	D
66415-066LF	16	.800/20.32	.700/17.78	D
66415-067LF	14	.700/17.78	.600/15.24	D
66415-068LF	12	.600/15.24	.500/12.70	C
66415-069LF	10	.500/12.70	.400/10.16	C
66415-070LF	8	.400/10.16	.300/7.62	C
66415-071LF	6	.300/7.62	.200/5.08	B
66415-072LF	4	.200/5.08	.100/2.54	B
66415-073LF	28	1.400/35.56	1.300/33.02	E

mat'l. code		surface		tolerance		projection		product family	
SEE NOTE 1		✓				⊕		PV HOUSINGS	
ltr	ec'n no	dr	date	tolerances unless otherwise specified		INCH/MM		title	
K				angles	linear			MINI LATCH HOUSING DR	
								.100[2.54]CC FOR .318[8.08] PIN	
				0'±2'		scale 1:1		dwg no	
				dr	L. SANDERS	1995-03-28	sheet 3 of 4		size
				enrg	L. FYE	1995-03-28	66415		A3
				chr	T. BREWBAKER	1995-03-28	type		Product Customer Drawing
				appd	L. FYE	1995-03-28			
sheet index	revision sheet								

PRODUCT NO.  
SEE TABLE

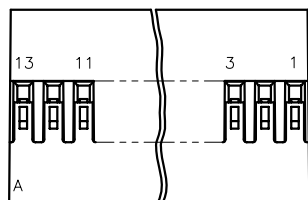
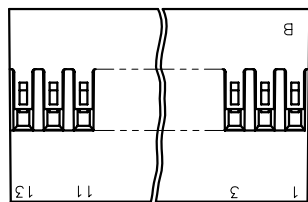

STYLE A

MARK NUMBER EVERY OTHER POSITION AND SIDE "A" AND "B" AS SHOWN



STYLE B

MARK THE NUMBER 1 CENTERED ON FIRST CAVITY, ONE SIDE ONLY.

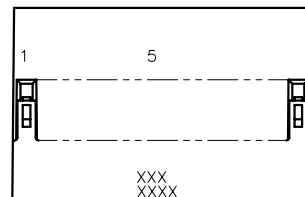
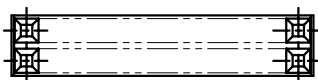

STYLE C

MARK CAVITY NUMBER ON POS. 1, AND IF APPLICABLE, 5 CENTER NUMBER ON RESPECTIVE CAVITY. MARK CO. LOGO AND YEAR WEEK- DATE CODE OF INKING AT THE APPROX. CENTER OF PART AS SHOWN. MARK ONE SIDE ONLY.

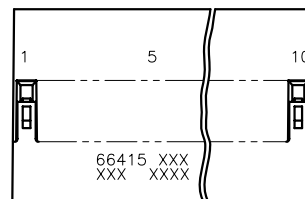
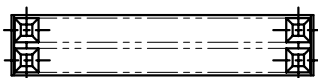

STYLE D

MARK CAVITY NUMBER EVERY 5 TH CAVITY. MARK CAVITY 1 ALSO. CENTER NUMBER ON RESPECTIVE CAVITY. MARK CO. LOGO YEAR WEEK- DATE CODE OF INKING AN COMPANY PART NUMBER AT THE APPROX. CENTER OF PART AS SHOWN MARK ONE SIDE ONLY.

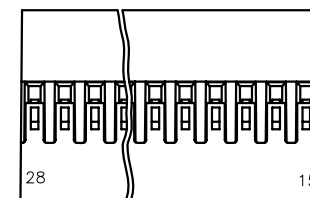
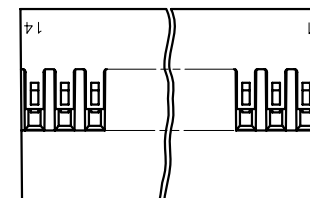

MARK AS SHOWN  
STYLE E

mat'l. code SEE NOTE 1				surface	tolerance	projection	product family
ltr	ecr no	dr	date	tolerances unless otherwise specified			PV HOUSINGS
K				angles	linear	INCH/MM	title
				0°±2°		scale 2:1	MINI LATCH HOUSING DR
							.100[2.54]CC FOR .318[8.08] PIN
				dr L. SANDERS	1995-03-28	FCJ	dwg no
				engr L. FYE	1995-03-28		sheet 4 of 4
				chr T. BREWBAKER	1995-03-28		size
				appd L. FYE	1995-03-28		A3
sheet	revision						type
index	sheet						Product Customer Drawing