

PRODUCT NO.
SEE TABLE

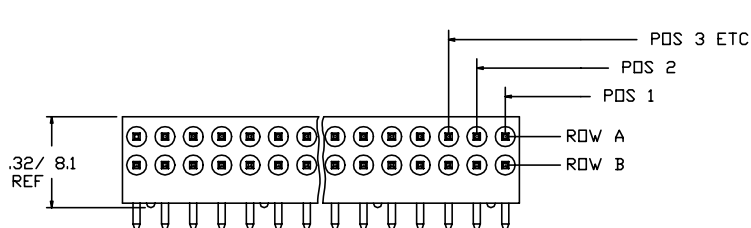

RECOMMENDED HOLE PATTERN

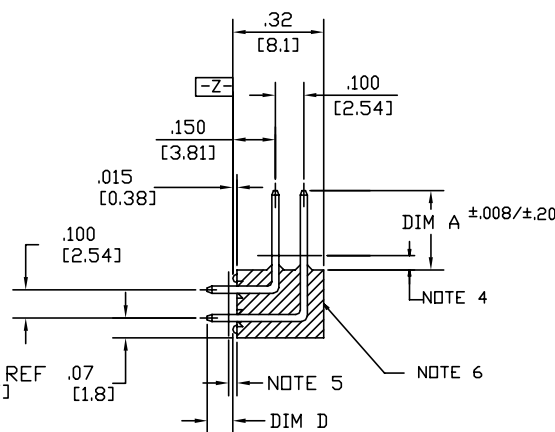
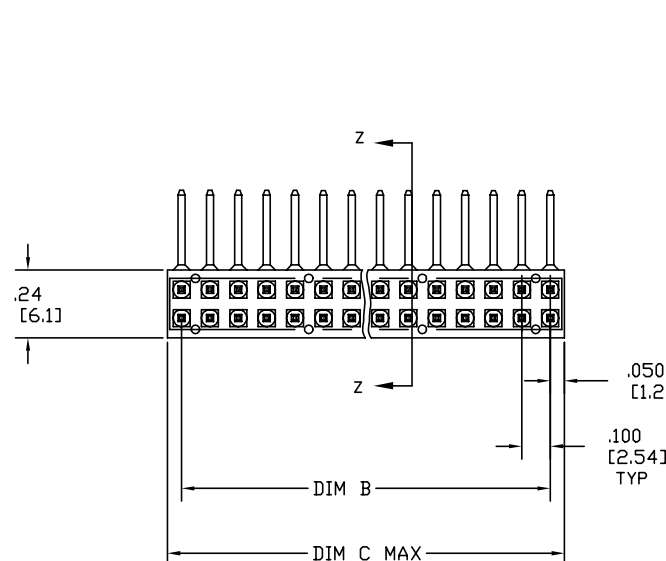

SECTION Z-Z

NOTES:

1. TERMINAL MAT'L: 3/4 HARD PHOS BRONZE ALLOY, UNS-C51000.
2. TERMINAL PLATING: SEE CHART OPTIONS ARE, .15u"/.38u, .30u"/.076u OR 50u"/1.27u"Au OVER 30u"Ni: OR 150u"/.381u 93/7 SnPb.
3. MOLDING MAT'L OPTIONS (SEE CHART FOR DISTINCTIONS); 20% MIN GLASS FILLED POLYESTER, FLAME RETARDANT PER UL-94 V-0, COLOR-BLACK OR 20% MIN GLASS FILLED NYLON, FLAME RETARDANT PER UL94V-0, COLOR BLACK. THIS PRODUCT WILL WITHSTAND EXPOSURE TO 260°C TEMPERATURE FOR 15 SECONDS IN A WAVE SOLDER APPLICATION WITH A .06 [1.5mm] THICK PCB.
4. .05/1.27 MAX HIGH FLASH.
5. .03/.76 MAX FLASH
6. FCI LOGO AND PART NO ON THIS SURFACE WHEN POSSIBLE.
7. FOR POLARIZATION, TERMINAL MAY BE REMOVED BEFORE MOLDING OR CUT OFF AFTERWARDS. MAX PROTRUSTION .010/.25 MAX BEYOND PLASTIC.
8. TWO SIDES OF LEAD-IN ON PINS NOT PLATED. TYP BOTH ENDS.
9. "GXT" Pd/Ni PLATED PRODUCT HAS GOLD FLASH.
10. POLARIZED SPECIAL MUST HAVE PINS CUT OFF AFTER MOLDING. FLUSH TO PLASTIC ON "A" DIM SIDE OF HEADER.
11. ADD SUFFIX LF AT THE END OF PART NUMBER FOR LEAD FREE OPTION.
12. THIS PRODUCT MEETS EUROPEAN UNION DIRECTIVES AND OTHER COUNTRY REGULATIONS AS DESCRIBED IN GS-22-008.
13. THIS PRODUCT MAY HAVE 100% TIN PLATING IN THE INTERFACE AND HAS NOT BEEN TESTED FOR WHISKER GROWTH IN INTERCONNECT ENVIRONMENTS.

mat'l. code				surface	tolerance	projection	product family	
				ISO 1302 ✓	ISO 406 ISO 1101	ISO 1101	BERGSTIK	
ltr	ecn no	dr	date	tolerances unless otherwise specified		INCH/MM	title	
K	-	LWP	6-29-89	angles	linear		BERGSTIK II HDR. D/R	
L	-	MDF	7-7-89	0±2°			.100/2.54cc STRAIGHT	
M	V03-0413	GJP	4-14-03			scale 1:1	dwg no	
N	V05-0891	DAI	10/10/05	dr	M CLOUSER	8-17-87	sheet 1 of 3	
P	ELX-N-16334	ZK	11/20/13	enrg	R FROST	8-17-87	size	
				chr	R FROST	8-17-87	65820	
				appd	R FROST	8-17-87	A3	
							type Product Customer Drawing	
sheet index	revision sheet	P	P	P				
		1	2	3				

PRODUCT NO.	SIZE	DIM A	DIM B	DIM C	DIM D	MOLD MAT'L NOTE 3	POLARIZED NOTE 7	TERMINAL PLATING NOTE 2	POLARIZED SPECIAL NOTE 10	LF OPTION
65820-034	2x9	.330/8.38	.800/20.32	.915/23.24	.14/3.56	NYLON	B-2	50u"/1.27u Au	NO	↑
65820-035	2x17	.280/7.11	1.600/40.64	1.715/43.56	.15/3.81	POLYESTER	NO	30u"/.76u Au	NO	NOTE 11
65820-036	2x25	.230/5.84	2.400/60.96	2.515/63.88	.09/2.3	POLYESTER		30u"/.76u Au	A-1,2,3 B-1,2,3	↓
65820-037	2x4	.230/5.84	.300/7.62	.415/10.54	.09/2.3	POLYESTER	NO	150u"/3.81u 93/7 Sn/Pb	NO	↓



FCIconnect.com

Copyright FCI

mat'l. code				surface ISO 1302 ✓	tolerance ISO 406 ISO 1101	projection 	product family BERGSTIK			
ltr	ecn	no	dr	date	tolerances unless otherwise specified		INCH/MM scale 1:1	title BERGSTIK II HDR. D/R .100/2.54cc STRAIGHT		
P					angles	linear				
					0±2"					
					dr	M CLOUSER	8-17-87	dwg no		sheet 3 of 3
					enr	R FROST	8-17-87	65820		A3
					chr	R FROST	8-17-87	type		Product Customer Drawing
					appd	R FROST	8-17-87			
sheet index	revision		sheet							