

## Precision Thin Film Leaded Resistors

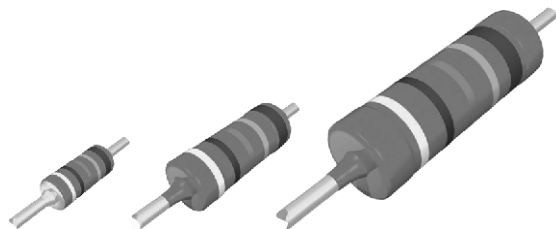

### DESCRIPTION

MBA/SMA 0204, MBB/SMA 0207 and MBE/SMA 0414 precision leaded thin film resistors combine the proven reliability of the professional products with an advanced level of precision and stability. Therefore they are perfectly suited for applications in the fields of test and measuring equipment along with industrial and medical electronics.

### FEATURES

- Available in standard version or CECC version (approved according to CECC 40101-806)
- Advanced thin film technology
- Low TCR:  $\pm 15$  ppm/K to  $\pm 25$  ppm/K
- Precision tolerance of value:  $\pm 0.1$  % and  $\pm 0.25$  %
- Superior overall stability: Class 0.05
- Wide precision range:  $10 \Omega$  to  $1.5 \text{ M}\Omega$
- Lead (Pb)-free solder contacts
- Pure tin plating provides compatibility with lead (Pb)-free and lead containing soldering processes
- Compliant to RoHS directive 2002/95/EC

**RoHS**  
COMPLIANT

### APPLICATIONS

- Test and measuring equipment
- Industrial electronics
- Medical electronics

### METRIC SIZE

| DIN  | 0204 | 0207 | 0414 |
|------|------|------|------|
| CECC | A    | B    | D    |

### TECHNICAL SPECIFICATIONS

| DESCRIPTION  | MBA/SMA 0204                |                      | MBB/SMA 0207         |                      | MBE/SMA 0414         |           |
|--|-----------------------------|----------------------|----------------------|----------------------|----------------------|-----------|
| CECC Size  | A                           |                      | B                    |                      | D                    |           |
| Resistance Range   | 22 Ω to 332 kΩ              |                      | 10 Ω to 1 MΩ         |                      | 22 Ω to 1.5 MΩ       |           |
| Resistance Tolerance   | ± 0.25 %; ± 0.1 %           |                      |                      |                      |                      |           |
| Temperature Coefficient  | ± 25 ppm/K; ± 15 ppm/K      |                      |                      |                      |                      |           |
| Operation Mode   | Precision                   | Standard             | Precision            | Standard             | Precision            | Standard  |
| Climatic Category (LCT/UCT/Days)   | 10/85/56                    | 55/125/56            | 10/85/56             | 55/125/56            | 10/85/56             | 55/125/56 |
| Rated Dissipation, $P_{70}$  | 0.07 W                      | 0.25 W               | 0.11 W               | 0.40 W               | 0.17 W               | 0.65 W    |
| Operating Voltage, $U_{\text{max}}$ AC/DC  | 200 V                       |                      | 350 V                |                      | 500 V                |           |
| Film Temperature   | 85 °C                       | 125 °C               | 85 °C                | 125 °C               | 85 °C                | 125 °C    |
| Max. Resistance Change at $P_{70}$ for Resistance Range, $\Delta R/R$ max., After: | 100 Ω to 100 kΩ             |                      | 100 Ω to 270 kΩ      |                      | 100 Ω to 470 kΩ      |           |
|  | 1000 h                      | ≤ 0.05 %<br>≤ 0.25 % | ≤ 0.05 %<br>≤ 0.25 % | ≤ 0.05 %<br>≤ 0.25 % | ≤ 0.05 %<br>≤ 0.25 % | ≤ 0.25 %  |
|  | 8000 h                      | ≤ 0.1 %<br>≤ 0.5 %   | ≤ 0.1 %<br>≤ 0.5 %   | ≤ 0.1 %<br>≤ 0.5 %   | ≤ 0.1 %<br>≤ 0.5 %   | ≤ 0.5 %   |
|  | 225 000 h                   | ≤ 0.3 %<br>≤ 1.5 %   | ≤ 0.3 %<br>≤ 1.5 %   | ≤ 0.3 %<br>≤ 1.5 %   | ≤ 0.3 %<br>≤ 1.5 %   | ≤ 1.5 %   |
| Permissible Voltage Against Ambient (Insulation):                                  |                             |                      |                      |                      |                      |           |
|  | 1 Minute; $U_{\text{ins}}$  | 300 V                | 500 V                |                      | 800 V                |           |
|  | Continuous                  | 75 V                 | 75 V                 |                      | 75 V                 |           |
| Failure Rate: FIT <sub>observed</sub>  | ≤ 0.1 x 10 <sup>-9</sup> /h |                      |                      |                      |                      |           |

### Notes

- MB\_ series has been merged with the related SMA series to form one series "MB\_/SMA\_"
- These resistors do not feature a limited lifetime when operated within the permissible limits. However, resistance value drift increasing over operating time may result in exceeding a limit acceptable to the specific application, thereby establishing a functional lifetime.

### PART NUMBER AND PRODUCT DESCRIPTION

PART NUMBER: MBB02070D1001BCT00

| MODEL/SIZE   | VARIANT  | TCR/MATERIAL   | VALUE  | TOLERANCE   | PACKAGING <sup>(1)</sup>  | SPECIAL              |
|--|--|--|--|---|---|----------------------|
| <b>MBA0204</b> =<br>MBA/SMA 0204<br><b>MBB0207</b> =<br>MBB/SMA 0207<br><b>MBE0414</b> =<br>MBE/SMA 0414 | <b>0</b> = Neutral<br><b>V</b> = CECC 06<br><b>N</b> = RB Radial 5 mm<br>for MBB/SMA0207<br><b>S</b> = UB Radial 2.5 mm<br>for MBB/SMA0207<br><b>I</b> = L0 (without lacquer<br>on termination for<br>MBB/SMA0207) | <b>E</b> = $\pm 15$ ppm/K<br><b>D</b> = $\pm 25$ ppm/K | <b>3 digit value</b><br><b>1 digit multiplier</b><br><b>MULTIPLIER</b><br><b>8</b> = $\cdot 10^{-2}$ <b>2</b> = $\cdot 10^2$<br><b>9</b> = $\cdot 10^{-1}$ <b>3</b> = $\cdot 10^3$<br><b>0</b> = $\cdot 10^0$ <b>4</b> = $\cdot 10^4$<br><b>1</b> = $\cdot 10^1$ <b>5</b> = $\cdot 10^5$ | <b>B</b> = $\pm 0.1$ %<br><b>C</b> = $\pm 0.25$ % | <b>CT</b><br><b>C1</b><br><b>RP</b><br><b>R1</b><br><b>R2</b><br><b>R4</b><br><b>N4</b> | <b>00</b> = Standard |

PRODUCT DESCRIPTION: MBB/SMA 0207-25 0.1 % CT 1K0

|   |   |                                  |                             |   |   |  |
|---|---|----------------------------------|-----------------------------|---|---|--|
| MBB/SMA 0207  | - | 25                               | 0.1 %                       |   | CT  | 1K0  |
| MODEL/SIZE  |   | TCR                              | TOLERANCE                   | VARIANT   | PACKAGING <sup>(1)</sup>  | RESISTANCE   |
| <b>MBA/SMA 0204</b><br><b>MBB/SMA 0207</b><br><b>MBE/SMA 0414</b> |   | $\pm 15$ ppm/K<br>$\pm 25$ ppm/K | $\pm 0.1$ %<br>$\pm 0.25$ % | <b>CECC 06</b><br><b>RB</b><br><b>UB</b><br><b>L0</b> | <b>CT</b><br><b>C1</b><br><b>RP</b><br><b>R1</b><br><b>R2</b><br><b>R4</b><br><b>N4</b> | <b>1K0</b> = 1 k $\Omega$<br><b>51R1</b> = 51.1 $\Omega$ |

#### Notes

<sup>(1)</sup> Please refer to table PACKAGING for complete information

- The PART NUMBER shown above is to facilitate the unified part numbering system for ordering products

### PACKAGING

| MODEL  | REEL         |          | BOX          |          |
|--|--------------|----------|--------------|----------|
|  | PIECES       | CODE     | PIECES       | CODE     |
| MBA/SMA 0204   | 1000<br>5000 | R1<br>RP | 1000<br>5000 | C1<br>CT |
| MBB/SMA 0207   | 1000<br>5000 | R1<br>RP | 1000<br>5000 | C1<br>CT |
| MBE/SMA 0207<br>Radial version (variant N = RB, variant S = UB)) | 4000         | R4       | 4000         | N4       |
| MBE/SMA 0414   | 2500         | R2       | 1000         | C1       |

### DIMENSIONS

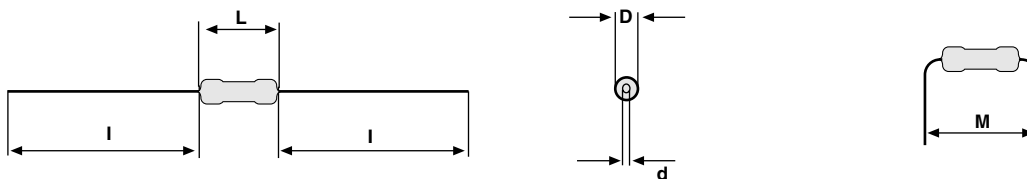

### DIMENSIONS - Leaded resistor types, mass and relevant physical dimensions

| TYPE         | D <sub>max.</sub><br>(mm) | L <sub>max.</sub><br>(mm) | d <sub>nom.</sub><br>(mm) | I <sub>min.</sub><br>(mm) | M <sub>min.</sub><br>(mm) | MASS<br>(mg) |
|--------------|---------------------------|---------------------------|---------------------------|---------------------------|---------------------------|--------------|
| MBA/SMA 0204 | 1.6                       | 3.6                       | 0.5                       | 29.0                      | 5.0                       | 125          |
| MBB/SMA 0207 | 2.5                       | 6.3                       | 0.6                       | 28.0                      | 10.0 <sup>(2)</sup>       | 220          |
| MBE/SMA 0414 | 4.0                       | 11.9                      | 0.8                       | 31.0                      | 15.0                      | 700          |

#### Note

<sup>(2)</sup> For 7.5 ≤ M < 10.0 mm, use version MBB/SMA 0207 ... L0 without lacquer on the leads

**MBB/SMA 0207 WITH RADIAL TAPING**

LEAD SPACING (Variant S = UB) 2.5 mm, SIZE 0207

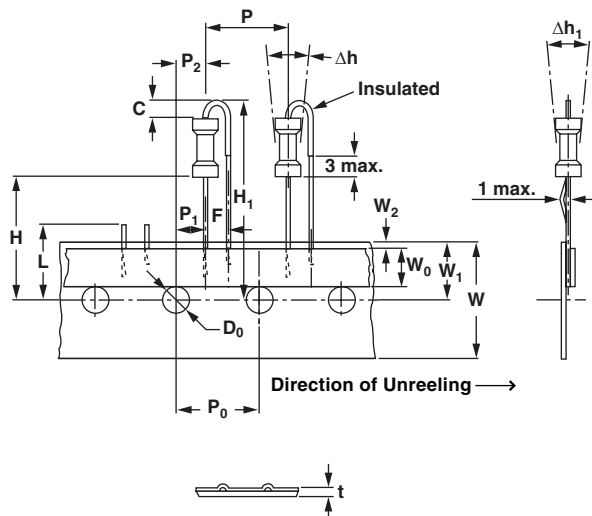

| DIMENSIONS in millimeters                        |                 |          | TOL.          |
|--|-----------------|----------|---------------|
| Lead Ø   | d               | 0.6      | -             |
| Pitch of components                              | P               | 12.7     | ± 1.0         |
| Pitch of sprocket holes <sup>(1)</sup>           | P <sub>0</sub>  | 12.7     | ± 0.3         |
| Distance between hole center and lead center     | P <sub>1</sub>  | 5.1      | ± 0.7         |
| Distance between hole center and resistor center | P <sub>2</sub>  | 5.1      | ± 0.7         |
| Lead Spacing                                     | F               | 2.5      | + 0.6, - 0.1  |
| Angle of insertion                               | Δh              | 1.3 max. | -             |
| Angle of insertion                               | Δh <sub>1</sub> | 2 max.   | -             |
| Width of carrier tape                            | W               | 18.0     | + 1, - 0.5    |
| Width of adhesive tape                           | W <sub>0</sub>  | 6.0      | ± 0.5         |
| Position of holes                                | W <sub>1</sub>  | 9.0      | + 0.75, - 0.5 |
| Position of adhesive tape                        | W <sub>2</sub>  | 0.5      | + 0.5, - 0    |
| Body to hole center <sup>(2)</sup>               | H               | 18.0     | ± 2, - 0      |
| Hole Ø   | D <sub>0</sub>  | 4.0      | + 0.2         |
| Thickness of tape <sup>(3)</sup>                 | t               | 0.9 max. | -             |
| Height for cutting                               | L               | 11 max.  | -             |
| Height for bending                               | C               | 2.5      | + 0, - 0.5    |
| Height for insertion                             | H <sub>1</sub>  | 32 max.  | -             |

LEAD SPACING (Variant N = RB) 5.0 mm, SIZE 0207

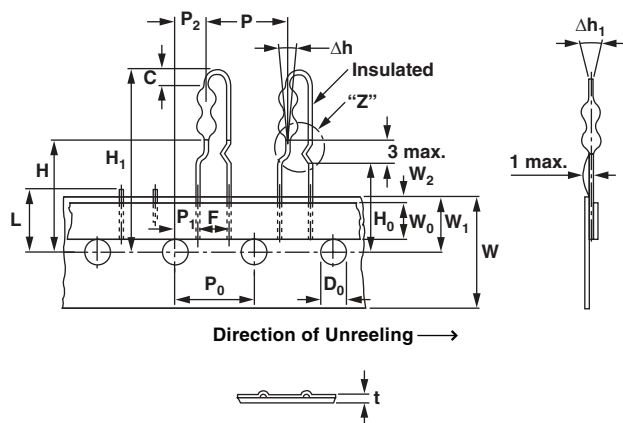

Area "Z"

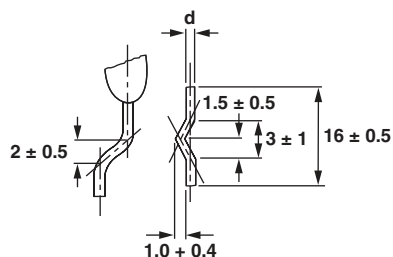

| DIMENSIONS in millimeters                        |                 |          | TOL.          |
|--|-----------------|----------|---------------|
| Lead Ø   | d               | 0.6      | -             |
| Pitch of components                              | P               | 12.7     | ± 1.0         |
| Tape pitch                                       | P <sub>0</sub>  | 12.7     | ± 0.3         |
| Distance between hole center and lead center     | P <sub>1</sub>  | 3.85     | ± 0.7         |
| Distance between hole center and resistor center | P <sub>2</sub>  | 6.35     | ± 0.7         |
| Lead spacing                                     | F               | 5.0      | + 0.6, - 0.1  |
| Angle of insertion                               | Δh              | 1.3 max. | -             |
| Angle of insertion                               | Δh <sub>1</sub> | 2 max.   | -             |
| Width of carrier tape                            | W               | 18.0     | + 1, - 0.5    |
| Width of adhesive tape                           | W <sub>0</sub>  | 6.0      | ± 0.5         |
| Position of holes                                | W <sub>1</sub>  | 9.0      | + 0.75, - 0.5 |
| Position of adhesive tape                        | W <sub>2</sub>  | 0.5      | + 0.5, - 0    |
| Body to hole center <sup>(2)</sup>               | H               | 18.0     | + 2, - 0      |
| Lead crimp to hole center <sup>(2)</sup>         | H <sub>0</sub>  | 16.0     | ± 0.5         |
| Hole Ø   | D <sub>0</sub>  | 4.0      | ± 0.2         |
| Thickness of tape <sup>(3)</sup>                 | t               | 0.9 max. | -             |
| Height for cutting                               | L               | 11 max.  | -             |
| Height for bending                               | C               | 2.5      | + 0, - 0.5    |
| Height for insertion                             | H <sub>1</sub>  | 32 max.  | -             |

**Notes**(1) Test over 10 holes - 9 intervals P<sub>0</sub> 12 x 9 = 114.3 ± 0.5

(2) Parallelism, &lt; 0.5 mm

(3) Thickness of carrier tape: 0.55 mm ± 0.1



# MBA/SMA 0204, MBB/SMA 0207, MBE/SMA 0414 - Precision

Precision Thin Film Leaded Resistors

Vishay Beyschlag

## TEMPERATURE COEFFICIENT AND RESISTANCE RANGE

| DESCRIPTION |           | RESISTANCE VALUE <sup>(1)</sup> |                     |                       |
|-------------|-----------|---------------------------------|---------------------|-----------------------|
| TCR         | TOLERANCE | MBA/SMA 0204                    | MBB/SMA 0207        | MBE/SMA 0414          |
| ± 25 ppm/K  | ± 0.25 %  | <b>22 Ω to 332 kΩ</b>           | <b>10 Ω to 1 MΩ</b> | <b>22 Ω to 1.5 MΩ</b> |
|             | ± 0.1 %   | <b>43 Ω to 332 kΩ</b>           | <b>10 Ω to 1 MΩ</b> | <b>43 Ω to 1 MΩ</b>   |
| ± 15 ppm/K  | ± 0.25 %  | 22 Ω to 221 kΩ                  | 10 Ω to 1 MΩ        | 22 Ω to 1 MΩ          |
|             | ± 0.1 %   | <b>43 Ω to 221 kΩ</b>           | <b>10 Ω to 1 MΩ</b> | <b>43 Ω to 1 MΩ</b>   |

### Notes

<sup>(1)</sup> Resistance values to be selected from E96 and E192 series, for other values please contact factory

- Resistance ranges printed in bold are preferred TCR/tolerance combinations with optimized availability

## DESCRIPTION

Production is strictly controlled and follows an extensive set of instructions established for reproducibility. A homogeneous film of metal alloy is deposited on a high grade ceramic body and conditioned to achieve the desired temperature coefficient. Plated steel termination caps are firmly pressed on the metallized rods. A special laser is used to achieve the target value by smoothly cutting a helical groove in the resistive layer without damaging the ceramics. A further conditioning is applied in order to stabilise the trimming result. Connecting wires of electrolytic copper plated with 100 pure tin are welded to the termination caps. The resistors are covered by protective coating designed for electrical, mechanical and climatic protection. The terminations receive a final pure tin on nickel plating. Four or five color code rings designate the resistance value and tolerance in accordance with **IEC 60062**.

The result of the determined production is verified by an extensive testing procedure performed on 100 of the individual resistors. Only accepted products are stuck directly on the adhesive tapes in accordance with **IEC 60286-1**; **IEC 60286-2**.

## ASSEMBLY

The resistors are suitable for processing on automatic insertion equipment and cutting and bending machines. Excellent solderability is proven, even after extended storage. They are suitable for automatic soldering using wave or dipping. The encapsulation is resistant to all cleaning solvents commonly used in the electronics industry, including alcohols, esters and aqueous solutions. The suitability of conformal coatings, if applied, shall be qualified by appropriate means to ensure the long-term stability of the whole system. The resistors are completely lead (Pb)-free, the pure tin plating provides compatibility with lead (Pb)-free and lead-containing soldering processes. The immunity of the plating against tin whisker growth has been proven under extensive testing. All products comply with **GADSL** <sup>(2)</sup> and the **CECIC-EECA-EICTA** <sup>(3)</sup> list of legal restrictions on hazardous substances. This includes full compliance with the following directives:

### Notes

<sup>(2)</sup> Global Automotive Declarable Substance List, see [www.gadsl.org](http://www.gadsl.org)

<sup>(3)</sup> CECIC (European Chemical Industry Council), EECA (European Electronic Component Manufacturers Association), EICTA (European trade organisation representing the information and communications technology and consumer electronics), see [www.eicta.org/index.php?id=1053&id\\_article=340](http://www.eicta.org/index.php?id=1053&id_article=340)

- 2000/53/EC End of Vehicle Life Directive (ELV) and Annex II (ELVII)
- 2002/95/EC Restriction of the use of Hazardous Substances Directive (RoHS)
- 2002/96/EC Waste Electrical and Electrical Equipment Directive (WEEE)

## APPROVALS

The resistors (CECC version) are approved within the IECQ-CECC Quality Assessment System for Electronic Components to the detail specification **CECC 40101-806** which refers to **EN 60115-1** and **EN 140100** and the variety of environmental test procedures of the **IEC 60068** series. Conformity is attested by the use of the **CECC** logo (E) as the Mark of Conformity on the package label for CECC version.

Vishay BEYSCHLAG has achieved “**Approval of Manufacturer**” in accordance with **IEC QC 001002-3, clause 2**. The release certificate for “**Technology Approval Schedule**” in accordance with **CECC 240001** based on **IEC QC 001002-3, clause 6** is granted for the Vishay BEYSCHLAG manufacturing process.

## RELATED PRODUCTS

This product family of leaded thin film resistors for professional applications is complemented by **Zero Ohm Jumpers**.

For a correlated range of precision TCR and tolerance specifications see the datasheet:

- “Professional Thin Film Leaded Resistors”, document no. 28766

For products approved to CECC 40101-806, version E, with established reliability and failure rate level E7 (Quality factor  $\pi_Q = 0.1$ ), see the datasheet:

- “Established Reliability Thin Film Leaded Resistors”, document no. 28768

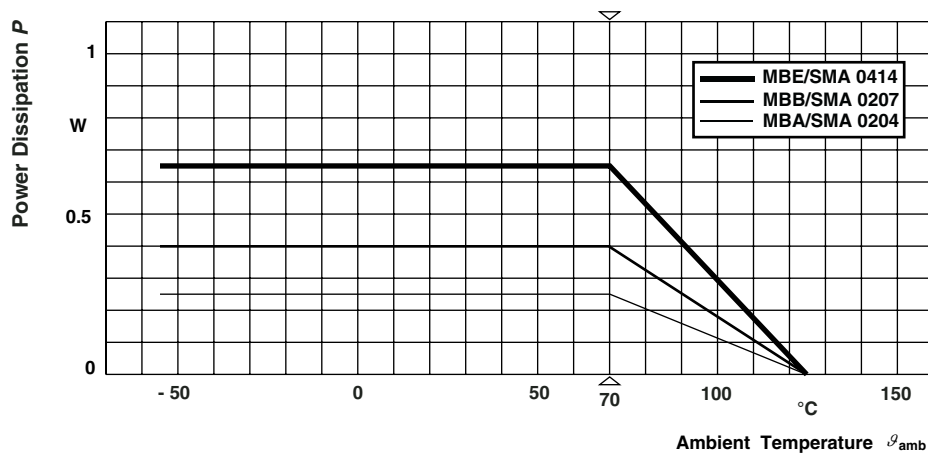
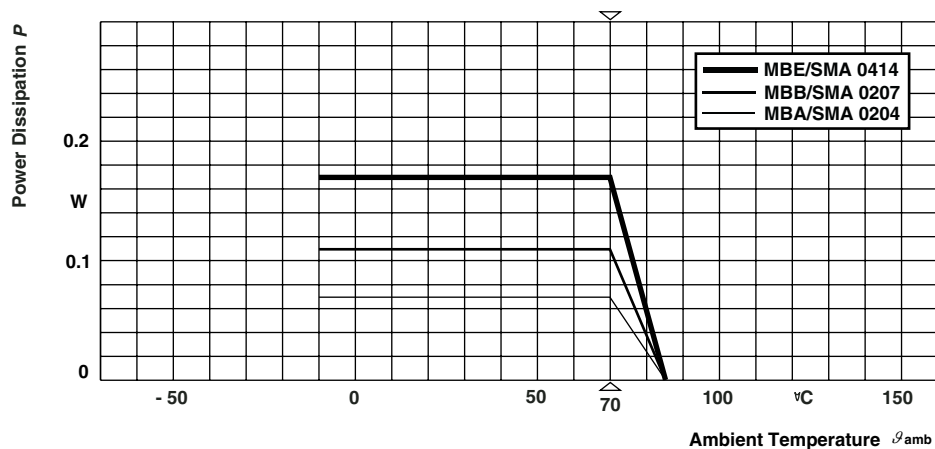
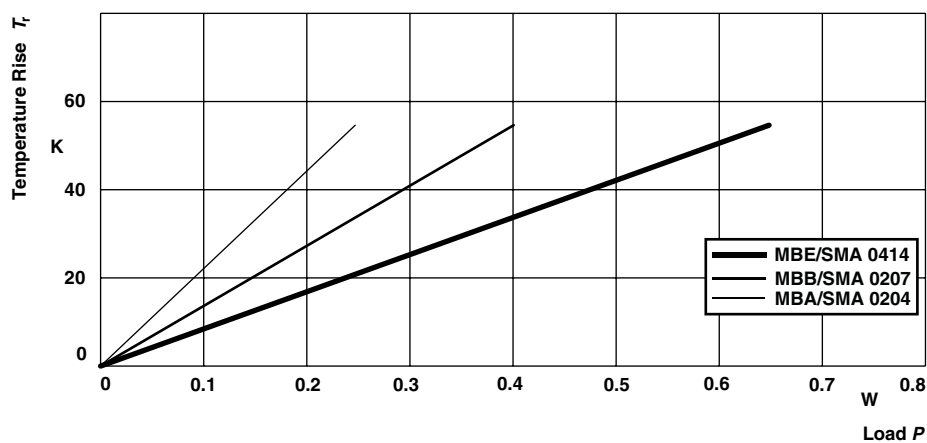
**FUNCTIONAL PERFORMANCE****Derating - Long Term Operation****Derating - Precision Operation****Temperature Rise**

Rise of the surface temperature.



# MBA/SMA 0204, MBB/SMA 0207, MBE/SMA 0414 - Precision

Precision Thin Film Leaded Resistors

Vishay Beyschlag

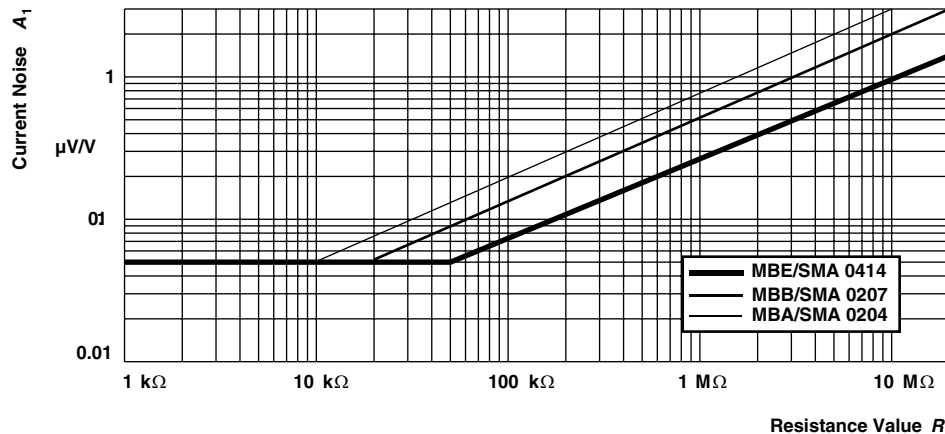

Current Noise  $A_1$  in accordance with IEC 60195

## TESTS AND REQUIREMENTS

Essentially all tests are carried out in accordance with the following specifications:

EN 60115-1, Generic specification (includes tests)

EN 140100, Sectional specification (includes schedule for qualification approval)

CECC 40101-806, Detail specification (includes schedule for conformance inspection)

Most of the components are approved in accordance with the European CECC-system, where applicable. The Test Procedures and Requirements table contains only the most important tests. For the full test schedule refer to the documents listed above. The testing also covers most of the requirements specified by EIA/IS-703 and JIS-C-5202.

The tests are carried out in accordance with IEC 60068-2-xx test method and under standard atmospheric conditions in accordance with IEC 60068-1, 5.3. Climatic category LCT/UCT/56 (rated temperature range: Lower Category

Temperature, Upper Category Temperature; damp heat, long term, 56 days) is valid.

Unless otherwise specified the following values apply:

Temperature: 15 °C to 35 °C

Relative humidity: 45 % to 75 %

Air pressure: 86 kPa to 106 kPa (860 mbar to 1060 mbar).

For testing the components are mounted on a test board in accordance with IEC 60115-1, 4.31 unless otherwise specified.

In the Test Procedures and Requirements table, only the tests and requirements are listed with reference to the relevant clauses of IEC 60115-1 and IEC 60068-2-xx test methods. A short description of the test procedure is also given.

## TEST PROCEDURES AND REQUIREMENTS

| IEC 60115-1<br>CLAUSE | IEC 60068-2-<br>TEST<br>METHOD | TEST       | PROCEDURE                    | REQUIREMENTS<br>PERMISSIBLE CHANGE ( $\Delta R$ max.) |   |                               |
|-----------------------|--------------------------------|------------|------------------------------|---|---|-------------------------------|
|                       |                                |            |                              | STABILITY<br>CLASS 0.05                               | STABILITY<br>CLASS 0.1  | STABILITY<br>CLASS 0.25       |
|                       |                                |            | Stability for product types: |   |   |                               |
|                       |                                |            | MBA/SMA 0204                 | 100 $\Omega$ to 100 k $\Omega$                        | 43 $\Omega$ to < 100 $\Omega$ ;<br>> 100 $\Omega$ to 221 k $\Omega$   | 22 $\Omega$ to 332 k $\Omega$ |
|                       |                                |            | MBB/SMA 0207                 | 100 $\Omega$ to 270 k $\Omega$                        | 43 $\Omega$ to < 100 $\Omega$ ;<br>> 270 k $\Omega$ to 510 k $\Omega$ | 22 $\Omega$ to 1 M $\Omega$   |
|                       |                                |            | MBE/SMA 0414                 | 100 $\Omega$ to 470 k $\Omega$                        | 43 $\Omega$ to < 100 $\Omega$ ;<br>> 470 k $\Omega$ to 1 M $\Omega$   | 22 $\Omega$ to 1.5 M $\Omega$ |
| 4.5                   | -                              | Resistance | -                            | $\pm 0.25\%$ ; $\pm 0.1\%$                            |   |                               |

**TEST PROCEDURES AND REQUIREMENTS**

| IEC<br>60115-1<br>CLAUSE | IEC<br>60068-2-<br>TEST<br>METHOD | TEST   | PROCEDURE   | REQUIREMENTS<br>PERMISSIBLE CHANGE ( $\Delta R$ max.)                   |   |   |
|--------------------------|-----------------------------------|--|---|---|---|---|
|                          |                                   |  |   | STABILITY<br>CLASS 0.05   | STABILITY<br>CLASS 0.1  | STABILITY<br>CLASS 0.25   |
|                          |                                   |  | Stability for product types:  |   |   |   |
|                          |                                   |  | <b>MBA/SMA 0204</b>   | 100 $\Omega$ to 100 k $\Omega$  | 43 $\Omega$ to < 100 $\Omega$ ;<br>> 100 $\Omega$ to 221 k $\Omega$   | 22 $\Omega$ to 332 k $\Omega$   |
|                          |                                   |  | <b>MBB/SMA 0207</b>   | 100 $\Omega$ to 270 k $\Omega$  | 43 $\Omega$ to < 100 $\Omega$ ;<br>> 270 k $\Omega$ to 510 k $\Omega$ | 22 $\Omega$ to 1 M $\Omega$   |
|                          |                                   |  | <b>MBE/SMA 0414</b>   | 100 $\Omega$ to 470 k $\Omega$  | 43 $\Omega$ to < 100 $\Omega$ ;<br>> 470 k $\Omega$ to 1 M $\Omega$   | 22 $\Omega$ to 1.5 M $\Omega$   |
| 4.8                      | -                                 | Temperature coefficient                      | At 20/LCT/20 °C and 20/UCT/20 °C  | $\pm 25$ ppm/K; $\pm 15$ ppm/K  |   |   |
| 4.25.1                   | -                                 | Endurance at 70 °C: Precision operation mode | $U = \sqrt{P_{70} \times R}$ or<br>$U = U_{\max.}$ ;<br>1.5 h ON; 0.5 h OFF<br><br>70 °C; 1000 h<br>70 °C; 8000 h | $\pm (0.05 \% R + 0.01 \Omega)^{(1)}$<br>$\pm (0.1 \% R + 0.01 \Omega)$ | $\pm (0.1 \% R + 0.01 \Omega)$<br>$\pm (0.2 \% R + 0.01 \Omega)$      | $\pm (0.25 \% R + 0.05 \Omega)^{(2)}$<br>$\pm (0.5 \% R + 0.05 \Omega)$ |
|                          | -                                 | Endurance at 70 °C: Standard operation mode  | $U = \sqrt{P_{70} \times R}$ or<br>$U = U_{\max.}$ ;<br>1.5 h ON; 0.5 h OFF                                       |   |   |   |
| 4.24                     | 78 (Cab)                          | Damp heat, steady state                      | (40 $\pm$ 2) °C;<br>56 days;<br>(93 $\pm$ 3) % RH   | $\pm (0.05 \% R + 0.01 \Omega)$   | $\pm (0.1 \% R + 0.01 \Omega)$  | $\pm (0.25 \% R + 0.05 \Omega)$   |
| 4.23                     |                                   | Climatic sequence:                           |   |   |   |   |
| 4.23.2                   | 2 (Ba)                            | Dry heat                                     | 125 °C; 16 h  |   |   |   |
| 4.23.3                   | 30 (Db)                           | Damp heat, cyclic                            | 55 °C; 24 h;<br>90 % to 100 % RH;<br>1 cycle  |   |   |   |
| 4.23.4                   | 1 (Aa)                            | Cold   | - 55 °C; 2 h  |   |   |   |
| 4.23.5                   | 13 (M)                            | Low air pressure                             | 8.5 kPa; 2 h;<br>15 °C to 35 °C   |   |   |   |
| 4.23.6                   | 30 (Db)                           | Damp heat, cyclic                            | 55 °C; 5 days;<br>95 % to 100 % RH;<br>5 cycles   | $\pm (0.05 \% R + 0.01 \Omega)$<br>no visible damage                    | $\pm (0.1 \% R + 0.01 \Omega)$<br>no visible damage                   | $\pm (0.25 \% R + 0.05 \Omega)$<br>no visible damage                    |
| 4.13                     | -                                 | Short time overload                          | Room temperature;<br>$U = 2.5 \times \sqrt{P_{70} \times R}$ or<br>$U = 2 \times U_{\max.}$ ; 5 s                 | $\pm (0.01 \% R + 0.01 \Omega)$<br>no visible damage                    | $\pm (0.02 \% R + 0.01 \Omega)$<br>no visible damage                  | $\pm (0.05 \% R + 0.01 \Omega)$<br>no visible damage                    |



# MBA/SMA 0204, MBB/SMA 0207, MBE/SMA 0414 - Precision

Precision Thin Film Leaded Resistors

Vishay Beyschlag

| TEST PROCEDURES AND REQUIREMENTS |                               |  |   |  |  |  |
|----------------------------------|-------------------------------|--|---|--|--|--|
| IEC 60115-1 CLAUSE               | IEC 60068-2- TEST METHOD      | TEST                                       | PROCEDURE   | REQUIREMENTS PERMISSIBLE CHANGE ( $\Delta R$ max.)   |  |  |
|                                  |                               |  | Stability for product types:  | <b>STABILITY CLASS 0.05</b>  | <b>STABILITY CLASS 0.1</b>   | <b>STABILITY CLASS 0.25</b>  |
|                                  |                               |  | <b>MBA/SMA 0204</b>   | 100 $\Omega$ to 100 k $\Omega$   | 43 $\Omega$ to < 100 $\Omega$ ;<br>> 100 $\Omega$ to 221 k $\Omega$  | 22 $\Omega$ to 332 k $\Omega$  |
|                                  |                               |  | <b>MBB/SMA 0207</b>   | 100 $\Omega$ to 270 k $\Omega$   | 43 $\Omega$ to < 100 $\Omega$ ;<br>> 270 k $\Omega$ to 510 k $\Omega$  | 22 $\Omega$ to 1 M $\Omega$  |
|                                  |                               |  | <b>MBE/SMA 0414</b>   | 100 $\Omega$ to 470 k $\Omega$   | 43 $\Omega$ to <100 $\Omega$ ;<br>> 470 k $\Omega$ to 1 M $\Omega$   | 22 $\Omega$ to 1.5 M $\Omega$  |
| 4.19                             | 14 (Na)                       | Rapid change of temperature                | 30 min at LCT = - 55 °C<br>30 min at UCT = 125 °C<br><br>5 cycles<br><br>MBA/SMA 0204: 500 cycles<br>MBB/SMA 0207: 200 cycles<br>MBE/SMA 0414: 100 cycles | $\pm (0.01 \% R + 0.01 \Omega)$<br>no visible damage<br><br>$\pm (0.25 \% R + 0.05 \Omega)$<br>no visible damage | $\pm (0.02 \% R + 0.01 \Omega)$<br>no visible damage<br><br>$\pm (0.25 \% R + 0.05 \Omega)$<br>no visible damage | $\pm (0.05 \% R + 0.01 \Omega)$<br>no visible damage<br><br>$\pm (0.25 \% R + 0.05 \Omega)$<br>no visible damage |
| 4.29                             | 45 (XA)                       | Component solvent resistance               | Isopropyl alcohol<br>+ 23 °C; toothbrush method   | Marking legible;<br>No visible damage  |  |  |
| 4.18.2                           | 20 (Tb)                       | Resistance to soldering heat               | Unmounted components;<br>(260 $\pm$ 3) °C;<br>(10 $\pm$ 1) s  | $\pm (0.01 \% R + 0.01 \Omega)$<br>no visible damage   | $\pm (0.02 \% R + 0.01 \Omega)$<br>no visible damage   | $\pm (0.05 \% R + 0.01 \Omega)$<br>no visible damage   |
| 4.17                             | 20 (Ta)                       | Solderability                              | + 235 °C; 2 s<br>solder bath method;<br>SnPb40<br><br>+ 245 °C; 3 s<br>solder bath method;<br>SnAg3Cu0.5  | Good tinning ( $\geq$ 95 % covered, no visible damage)   |  |  |
| 4.22                             | 6 (B4)                        | Vibration                                  | 6 h;<br>10 Hz to 2000 Hz<br>1.5 mm or 196 m/s <sup>2</sup>  | $\pm (0.01 \% R + 0.01 \Omega)$  | $\pm (0.02 \% R + 0.01 \Omega)$  | $\pm (0.05 \% R + 0.01 \Omega)$  |
| 4.16                             | 21 (Ua)<br>21 (Ub)<br>21 (Uc) | Robustness of terminations                 | Tensile, bending and torsion  | $\pm (0.01 \% R + 0.01 \Omega)$  | $\pm (0.02 \% R + 0.01 \Omega)$  | $\pm (0.05 \% R + 0.01 \Omega)$  |
| 4.7                              | -                             | Voltage proof                              | $U_{RMS} = U_{ins}$ ; 60 s  | No flashover or breakdown  |  |  |
| 4.25.3                           | -                             | Endurance at upper category temperature    | 85 °C; 1000 h<br>125 °C; 1000 h   | $\pm (0.05 \% R + 0.01 \Omega)$  | $\pm (0.1 \% R + 0.01 \Omega)$   | $\pm (0.25 \% R + 0.05 \Omega)$  |
| 4.40                             | -                             | Electrostatic discharge (human body model) | IEC 61340-3-1;<br>3 pos. + 3 neg.<br>MBA/SMA 0204: 2 kV<br>MBB/SMA 0207: 4 kV<br>MBE/SMA 0414: 6 kV   | $\pm (0.5 \% R + 0.05 \Omega)$   |  |  |

## Notes

(1)  $\pm (0.03 \% R + 0.01 \Omega)$  for MBB/SMA 0207

(2)  $\pm (0.15 \% R + 0.05 \Omega)$  for MBB/SMA 0207



**12NC INFORMATION FOR HISTORICAL CODING REFERENCE**

- The resistors have a 12-digit numeric code starting with 2312
- The subsequent 4 digits indicate the resistor type, specification and packaging; see the 12NC table
- The remaining 4 digits indicate the resistance value:
  - The first 3 digits indicate the resistance value
  - The last digit indicates the resistance decade in accordance with resistance decade table shown below

**Last Digit of 12NC Indicating Resistance Decade**

| RESISTANCE DECADE                | LAST DIGIT |
|----------------------------------|------------|
| 10 $\Omega$ to 99.9 $\Omega$     | 9          |
| 100 $\Omega$ to 999 $\Omega$     | 1          |
| 1 k $\Omega$ to 9.99 k $\Omega$  | 2          |
| 10 k $\Omega$ to 99.9 k $\Omega$ | 3          |
| 100 k $\Omega$ to 999 k $\Omega$ | 4          |
| 1 M $\Omega$ to 9.99 M $\Omega$  | 5          |

**12NC Example (For Historical coding reference of MBA 0204/MBB 0207/MBE 0414)**

The 12NC code of a MBA 0204 resistor, value 47 k $\Omega$  and TCR 25 with  $\pm 0.1$  % tolerance, supplied on bandolier in a box of 5000 units is: 2312 906 74703.

**12NC CODE FOR HISTORICAL CODING REFERENCE OF MBA 0204/MBB 0207/MBE 0414**

| DESCRIPTION |                |              | 2312 ... ..... (BANDOLIER) |               |               |               |               |
|-------------|----------------|--------------|----------------------------|---------------|---------------|---------------|---------------|
|             |                |              | AMMOPACK                   |               | REEL          |               |               |
| TYPE        | TCR            | TOL.         | C1 1000 units              | CT 5000 units | R1 1000 units | R2 2500 units | RP 5000 units |
| MBA 0204    | $\pm 25$ ppm/K | $\pm 0.25$ % | 901 6....                  | 906 6....     | 701 6....     | -             | 806 6....     |
|             |                | $\pm 0.1$ %  | 901 7....                  | 906 7....     | 701 7....     | -             | 806 7....     |
|             | $\pm 15$ ppm/K | $\pm 0.25$ % | 902 6....                  | 907 6....     | 702 6....     | -             | 807 6....     |
|             |                | $\pm 0.1$ %  | 902 7....                  | 907 7....     | 702 7....     | -             | 807 7....     |
| MBB 0207    | $\pm 25$ ppm/K | $\pm 0.25$ % | 911 6....                  | 916 6....     | 711 6....     | -             | 816 6....     |
|             |                | $\pm 0.1$ %  | 911 7....                  | 916 7....     | 711 7....     | -             | 816 7....     |
|             | $\pm 15$ ppm/K | $\pm 0.25$ % | 912 6....                  | 917 6....     | 712 6....     | -             | 817 6....     |
|             |                | $\pm 0.1$ %  | 912 7....                  | 917 7....     | 712 7....     | -             | 817 7....     |
| MBE 0414    | $\pm 25$ ppm/K | $\pm 0.25$ % | 921 6....                  | -             | -             | 826 6....     | -             |
|             |                | $\pm 0.1$ %  | 921 7....                  | -             | -             | 826 7....     | -             |
|             | $\pm 15$ ppm/K | $\pm 0.25$ % | 922 6....                  | -             | -             | 827 6....     | -             |
|             |                | $\pm 0.1$ %  | 922 7....                  | -             | -             | 827 7....     | -             |



### Disclaimer

All product specifications and data are subject to change without notice.

Vishay Intertechnology, Inc., its affiliates, agents, and employees, and all persons acting on its or their behalf (collectively, "Vishay"), disclaim any and all liability for any errors, inaccuracies or incompleteness contained herein or in any other disclosure relating to any product.

Vishay disclaims any and all liability arising out of the use or application of any product described herein or of any information provided herein to the maximum extent permitted by law. The product specifications do not expand or otherwise modify Vishay's terms and conditions of purchase, including but not limited to the warranty expressed therein, which apply to these products.

No license, express or implied, by estoppel or otherwise, to any intellectual property rights is granted by this document or by any conduct of Vishay.

The products shown herein are not designed for use in medical, life-saving, or life-sustaining applications unless otherwise expressly indicated. Customers using or selling Vishay products not expressly indicated for use in such applications do so entirely at their own risk and agree to fully indemnify Vishay for any damages arising or resulting from such use or sale. Please contact authorized Vishay personnel to obtain written terms and conditions regarding products designed for such applications.

Product names and markings noted herein may be trademarks of their respective owners.