



AUDIO PHONE PLUGS & JACKS

2-CONDUCTOR SUB-MINIATURE PLUGS

2.5 - 2極超小形単頭プラグ

No. **MP-101MH** (2.5 -2極)

MONO SCREW PART: PLASTICS

No. **MP-101A** (2.5 -2極)

MONO SCREW PART: METAL

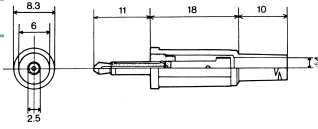

No. **MP-101ML** (2.5 -2極)

MONO SCREW PART: PLASTICS

No. **MP-101MLA**

MONO SCREW PART: METAL

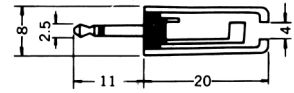

No. **MP-101MR** (2.5 -2極)

SCREW PART: PLASTICS
MONO



No. **MP-101C** (2.5 -2極)

MONO w/shielded handle

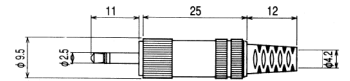

No. **MC-25MN** (2.5 -2極)

SUB-MINIATURE PLUG WITH 1.8M LONG CABLE
2-CONDUCTOR



No. **MP-022LN** (2.5 -2極)

MONO

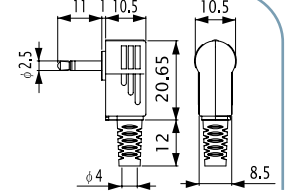

No. **MC-25MNL** (2.5 -2極)

SUB-MINIATURE RIGHT ANGLE PLUG WITH 1.8M LONG CABLE
2-CONDUCTOR



2-CONDUCTOR SUB-MINIATURE JACKS

2.5 - 2極超小形単頭ジャック

No. **MJ-165N** (2.5 -2極)

SUB-MINIATURE INLINE JACK
MONO

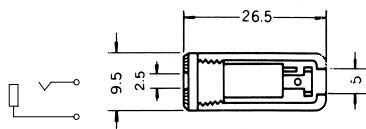

No. **MJ-165AN** (2.5 -2極)

SUB-MINIATURE INLINE JACK
MONO

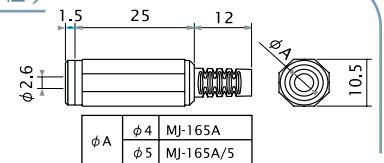

No. **MJ-0252S** (2.5 -2極)

2-CONDUCTOR SUB-MINIATURE INLINE JACK
MONO

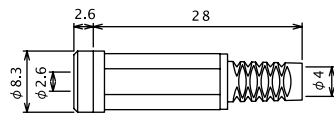

No. **MJ-2625** (2.5 -2極)

2-CONDUCTOR SUB-MINIATURE JACK FOR P.C.B
MONO

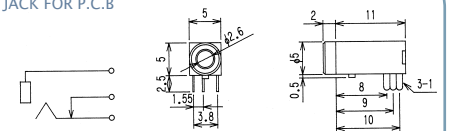

Marushin electric mfg. co., ltd

2-CONDUCTOR SUB-MINIATURE JACKS

2.5 - 2極超小形単頭ジャック

No.MJ-165H (2.5 -2極)

PANEL MOUNT SUB-MINIATURE JACK
MONO

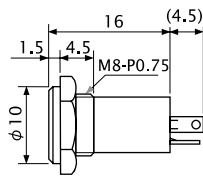

No.MJ-165SP (2.5 -2極)

SNAP-IN MOUNT SUB-MINIATURE JACK
MONO

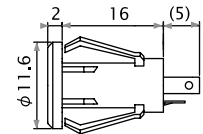

No.MJ-255 (2.5 -2極)

PANEL MOUNT SUB-MINIATURE JACK
MONO

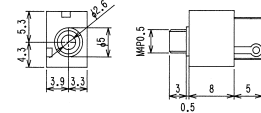

3-CONDUCTOR SUB-MINIATURE PLUGS

2.5 - 3極超小形単頭プラグ

No.MP-026L (2.5 -3極)

3-CONDUCTOR SUB-MINIATURE PLUG
w/shielded handle
STEREO

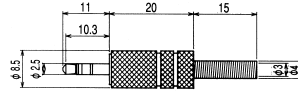

No.MP-025MH (2.5 -3極)

3-CONDUCTOR SUB-MINIATURE PLUG
STEREO

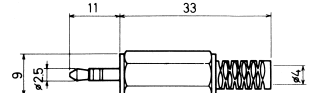

No.MC-25STL (2.5 -3極)

SUB-MINIATURE RIGHT ANGLE PLUG WITH 1.8M LONG CABLE
3-CONDUCTOR



No.MP-023LN (2.5 -3極)

3-CONDUCTOR SUB-MINIATURE RIGHT ANGLE PLUG
STEREO

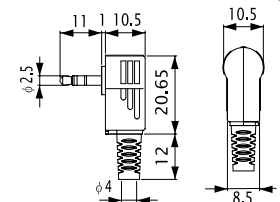

3-CONDUCTOR SUB-MINIATURE JACKS

No.MC-25ST (2.5 -3極)

SUB-MINIATURE PLUG WITH 1.8M LONG CABLE
3-CONDUCTOR



No.MJ-072 (2.5 -3極)

SUB-MINIATURE INLINE JACK
STEREO

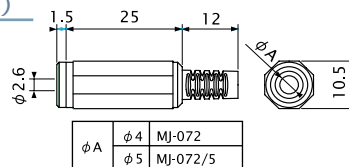

2.5 - 3極超小形単頭ジャック

No.MJ-0253S (2.5 -3極)

3-CONDUCTOR SUB-MINIATURE INLINE JACK
STEREO

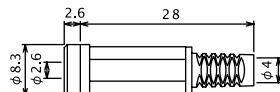

No.MJ-071 (2.5 -3極)

SUB-MINIATURE INLINE JACK
STEREO

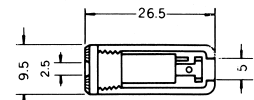

No.MJ-3625 (2.5 -3極)

3-CONDUCTOR SUB-MINIATURE JACK FOR P.C.B
STEREO

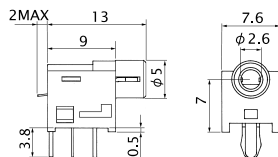

No.MJ-2-348A0 (2.5 -3極) With Metal Sleeve

No.MJ-2-348B0 (2.5 -3極) Without Metal Sleeve

3-CONDUCTOR SUB-MINIATURE JACK FOR P.C.B
STEREO

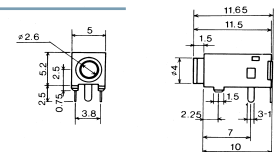

No.MJ-A18 (2.5 -3極)

3-CONDUCTOR SUB-MINIATURE JACK FOR P.C.B
STEREO

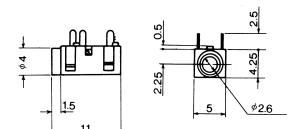



AUDIO PHONE PLUGS & JACKS

3-CONDUCTOR SUB-MINIATURE JACKS

2.5 - 3極超小形単頭ジャック

No. M02-A04A0 (2.5 -3極)

3-CONDUCTOR SUB-MINIATURE JACK FOR P.C.B
STEREO

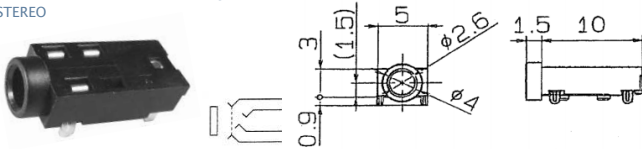

No. M02-909A0 (2.5 -3極) SMT

3-CONDUCTOR SUB-MINIATURE JACK FOR P.C.B
STEREO

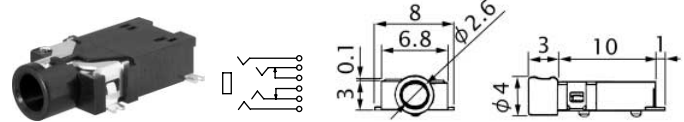

No. MJ-8925 (2.5 -3極) SMT

3-CONDUCTOR SUB-MINIATURE JACK FOR P.C.B
STEREO

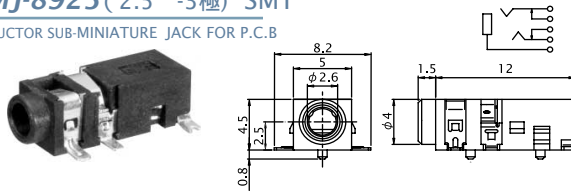

No. MJ-070N (2.5 -3極)

PANEL MOUNT SUB-MINIATURE JACK STEREO

No. MJ-070N0 (2.5 -3極)

SUB-MINIATURE JACK FOR P.C.B WITHOUT SCREW THREAD STEREO

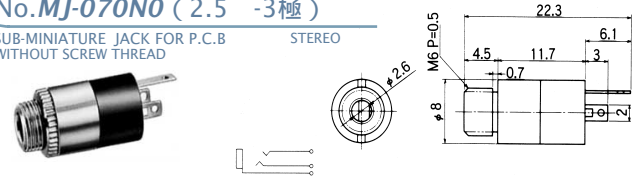

No. MJ-071H (2.5 -3極)

3-CONDUCTOR SUB-MINIATURE JACK
STEREO

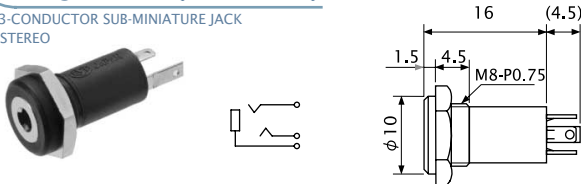

No. MJ-071SP (2.5 -3極)

SNAP-IN MOUNT SUB-MINIATURE JACK
STEREO

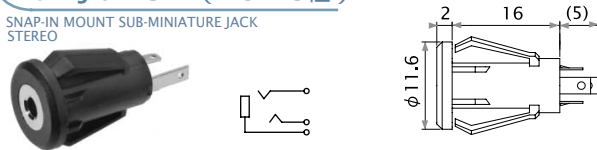

Marushin electric mfg. co., ltd



AUDIO PHONE PLUGS & JACKS

4-CONDUCTOR SUB-MINIATURE PLUGS & JACKS

2.5 - 4極超小形単頭プラグ・ジャック

No.MP-425 (2.5 -4極)

SUB-MINIATURE PLUG
4-CONDUCTOR

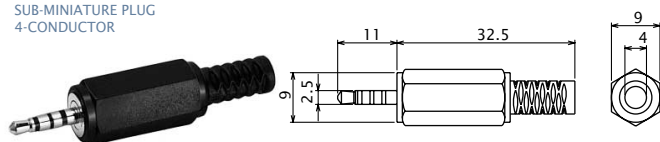

No.MP-425LN (2.5 -4極)

SUB-MINIATURE RIGHT ANGLE PLUG
4-CONDUCTOR

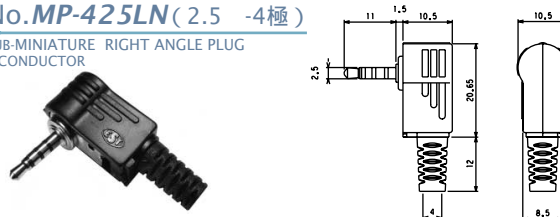

No.MC-4250 (2.5 -4極)

SUB-MINIATURE PLUG WITH 1.8M LONG CABLE
4-CONDUCTOR



No.MJ-0254S (2.5 -4極)

SUB-MINIATURE INLINE JACK
4-CONDUCTOR

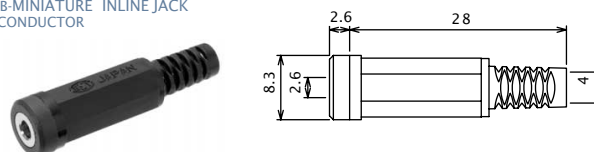

No.MC-4250L (2.5 -4極)

SUB-MINIATURE RIGHT ANGLE PLUG WITH 1.8M LONG CABLE
4-CONDUCTOR



No.MJ-068 (2.5 -4極)

SUB-MINIATURE INLINE JACK
4-CONDUCTOR

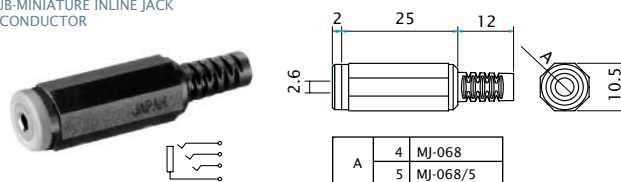

No.MJ-068SP (2.5 -4極)

SNAP-IN MOUNT SUB-MINIATURE JACK
4-CONDUCTOR

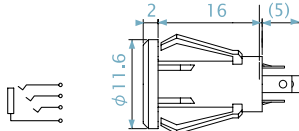

取付穴参考寸法
Mounting hole dimension

取付板板厚
Thickness of mounting board
t=1.0-1.8

No.MJ-069 (2.5 -4極)

PANEL MOUNT SUB-MINIATURE JACK
4-CONDUCTOR

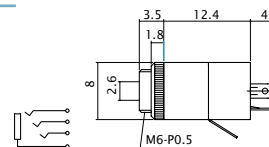

No.MJ-068H (2.5 -4極)

PANEL MOUNT SUB-MINIATURE JACK
4-CONDUCTOR

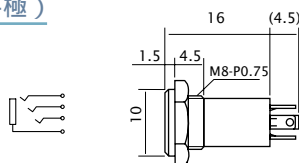

No.MC-254 (2.5 -4極)

SUB-MINIATURE PLUG WITH 1.8M LONG CABLE
4-CONDUCTOR

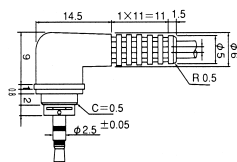

No.M19-442A (2.5 -4極)

SUB-MINIATURE PLUG FOR MOLDING
4-CONDUCTOR

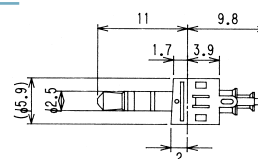

2-CONDUCTOR MINIATURE PLUGS & JACKS

3.5 - 2極小形単頭プラグ・ジャック

No.MP-105AC (3.5 -2極)

2-CONDUCTOR MINIATURE PLUG
MONO

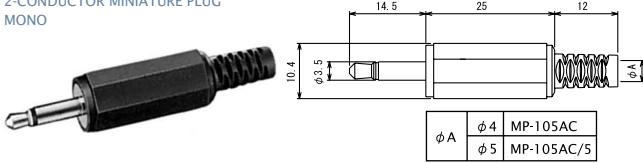

No.MP-105LC (3.5 -2極)

2-CONDUCTOR MINIATURE PLUG
MONO

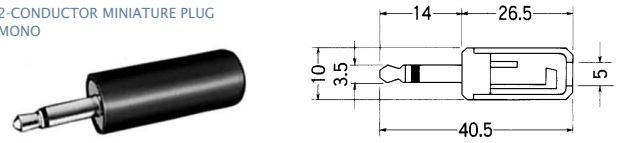

No.MP-106LC (3.5 -2極)

2-CONDUCTOR MINIATURE PLUG w/shielded handle
MONO

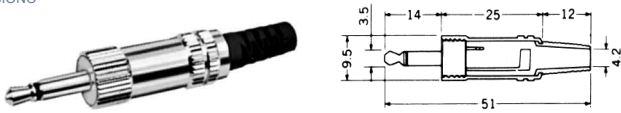

No.MP-104M (3.5 -2極)

2-CONDUCTOR MINIATURE PLUG.
MONO

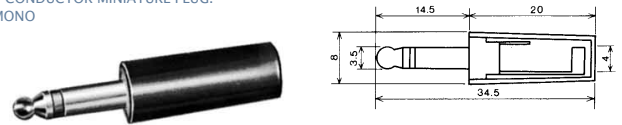

No.MP-105MC (3.5 -2極)

2-CONDUCTOR MINIATURE PLUG
MONO

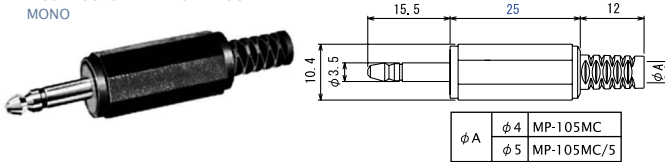

No.MP-011LN (3.5 -2極)

RIGHT ANGLE 2-CONDUCTOR MINIATURE PLUG
MONO

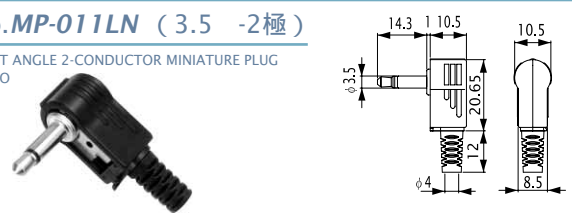

No.MP-106PC (3.5 -2極)

2-CONDUCTOR MINIATURE PLUG w/shielded handle
MONO

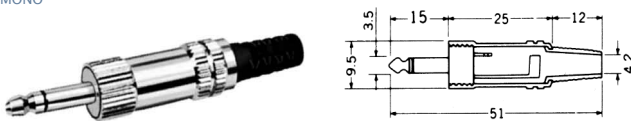

No.MP-105L (3.5 -2極)

2-CONDUCTOR MINIATURE PLUG.
MONO

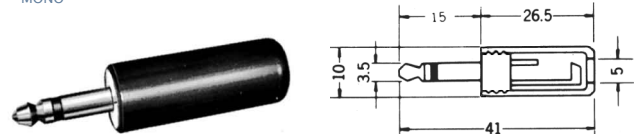

No.MC-35MN (3.5 -2極)

MINIATURE PLUG WITH 1.8M LONG CABLE
2-CONDUCTOR



No.MC-35MNL (3.5 -2極)

MINIATURE RIGHT ANGLE PLUG WITH 1.8M LONG CABLE
2-CONDUCTOR



No.MJ-164N (3.5 -2極)

MINIATURE INLINE JACK
MONO

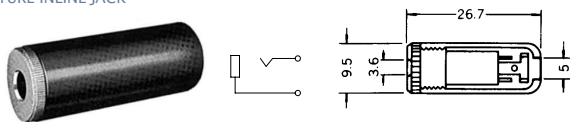

No.MJ-164AN (3.5 -2極)

MINIATURE INLINE JACK
MONO

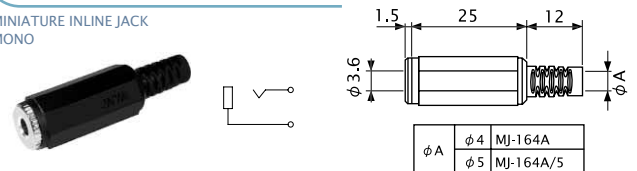

No.MJ-166MN (3.5 -2極)

MINIATURE INLINE JACK
MONO

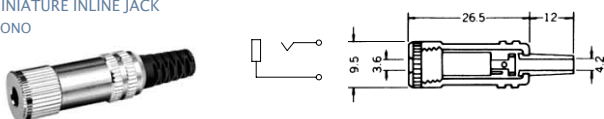



AUDIO PHONE PLUGS & JACKS

3-CONDUCTOR MINIATURE PLUGS

3.5 - 3極小形単頭プラグ

No. MP-019MS (3.5 -3極)

3-CONDUCTOR MINIATURE PLUG
STEREO
Screw Part : PLASTICS

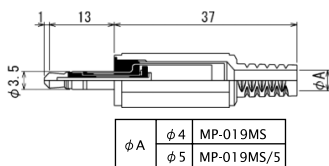

No. MP-019LC (3.5 -3極)

3-CONDUCTOR MINIATURE PLUG
STEREO
Screw Part : METAL

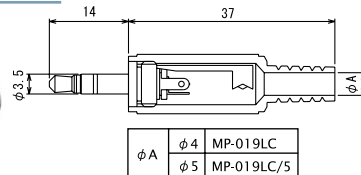

No. MP-013MS (3.5 -3極)

3-CONDUCTOR MINIATURE PLUG.
STEREO
Screw Part : PLASTICS

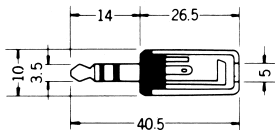

No. MP-013LC (3.5 -3極)

3-CONDUCTOR MINIATURE PLUG.
STEREO
Screw Part : METAL

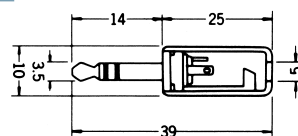
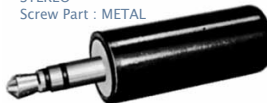

No. MP-060M (3.5 -3極)

3-CONDUCTOR MINIATURE PLUG. w/shielded handle
STEREO
Screw Part : PLASTICS

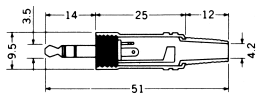

No. MP-061M (3.5 -3極)

3-CONDUCTOR MINIATURE PLUG. w/shielded handle
STEREO
Screw Part : METAL

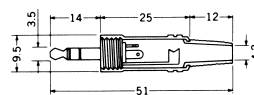

No. MP-012LN (3.5 -3極)

RIGHT ANGLE 3-CONDUCTOR MINIATURE PLUG
STEREO

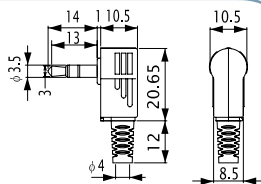

No. MC-35ST (3.5 -3極)

MINIATURE PLUG WITH 1.8M LONG CABLE
3-CONDUCTOR



No. MC-35STL (3.5 -3極)

MINIATURE RIGHT ANGLE PLUG WITH 1.8M LONG CABLE
3-CONDUCTOR



3-CONDUCTOR MINIATURE JACKS

3.5 - 3極小形単頭ジャック

No. MJ-073N (3.5 -3極)

MINIATURE INLINE JACK
STEREO

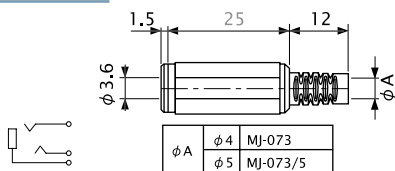

No. MJ-075N (3.5 -3極)

MINIATURE INLINE JACK
STEREO

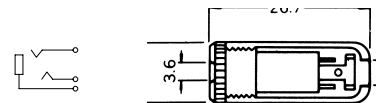

No. MJ-076MN (3.5 -3極)

MINIATURE INLINE JACK
STEREO

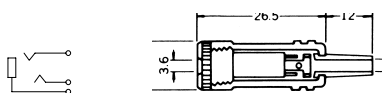

No. MJ-8435 (3.5 -3極)

3-CONDUCTOR MINIATURE JACK FOR P.C.B
STEREO

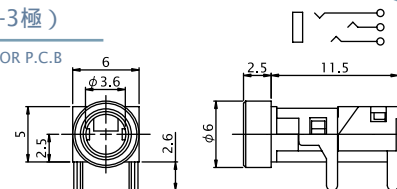

3-CONDUCTOR MINIATURE JACKS

3.5 - 3極小形単頭ジャック

No. M03-836A0 (3.5 -3極)

3-CONDUCTOR MINIATURE JACK FOR P.C.B STEREO

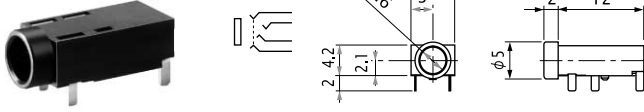

No. MJ-1635 (3.5 -3極)

3-CONDUCTOR MINIATURE JACK FOR P.C.B STEREO

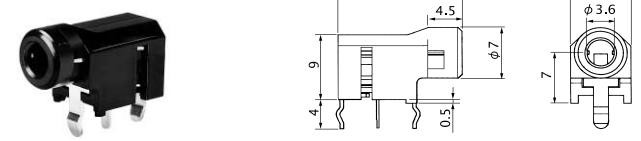

No. MJ-156L (3.5 -3極)

No. MJ-156L-5 (3.5 -3極)

3-CONDUCTOR MINIATURE JACK FOR P.C.B STEREO

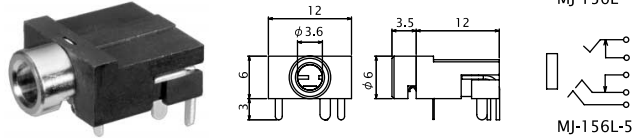

No. MJ-1835 (3.5 -3極)

3-CONDUCTOR MINIATURE JACK FOR P.C.B STEREO

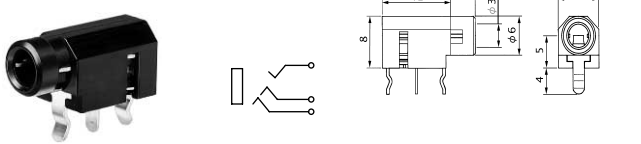

No. MJ-2335-C (3.5 -3極)

3-CONDUCTOR MINIATURE JACK FOR P.C.B STEREO

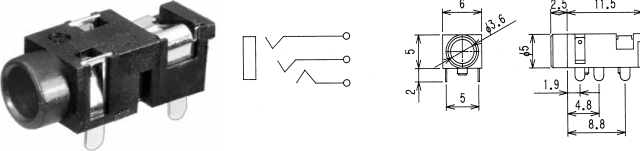

No. MJ-2035 (3.5 -3極)

3-CONDUCTOR MINIATURE JACK FOR P.C.B STEREO

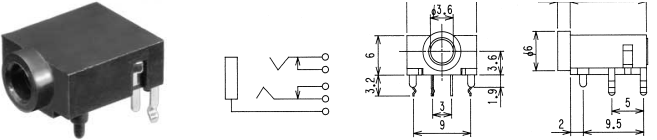

No. MJ-3335-5 (3.5 -3極)

3-CONDUCTOR MINIATURE JACK FOR P.C.B STEREO

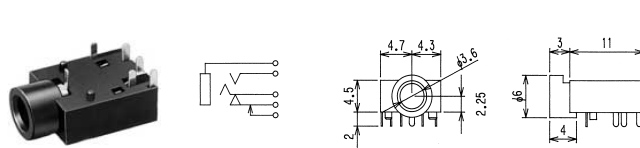

No. MJ-2435-C (3.5 -3極)

3-CONDUCTOR MINIATURE JACK FOR P.C.B STEREO

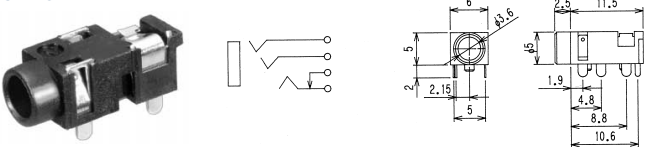

No. MJ-150 (3.5 -3極 縦型)

3-CONDUCTOR MINIATURE JACK FOR P.C.B STEREO (VERTICAL TYPE)

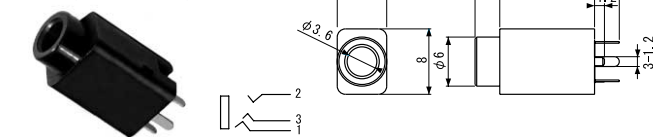

No. MX-387GL (3.5 -3極)

3-CONDUCTOR MINIATURE JACK FOR P.C.B STEREO

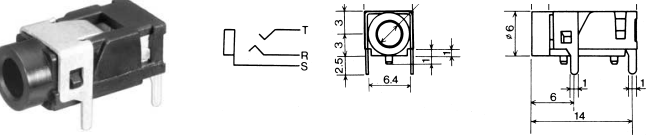

No. MJ-2735-5T (3.5 -3極)

No. MJ-2735-3T (3.5 -3極)

3-CONDUCTOR MINIATURE JACK FOR P.C.B STEREO



No. MJ-1535 (3.5 -3極)

3-CONDUCTOR MINIATURE JACK FOR P.C.B STEREO

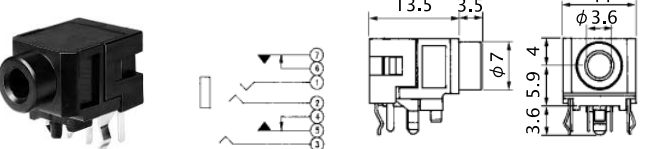

No. MJ-352W-0 (3.5 -3極)

3-CONDUCTOR MINIATURE JACK FOR P.C.B STEREO

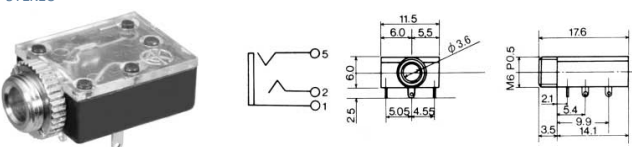

No. MJ-352W-C (3.5 -3極)

3-CONDUCTOR MINIATURE JACK FOR P.C.B STEREO

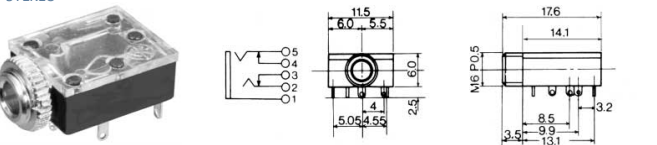

3-CONDUCTOR MINIATURE JACKS

3.5 - 3極小形単頭ジャック

No. MJ-073SP (3.5 -3極)

SNAP-IN MOUNT MINIATURE JACK
STEREO

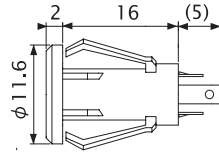

No. MJ-073H (3.5 -3極)

PANEL MOUNT MINIATURE JACK
STEREO

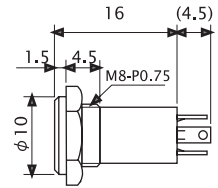

No. MJ-355W (3.5 -3極)

PANEL MOUNT MINIATURE JACK
STEREO

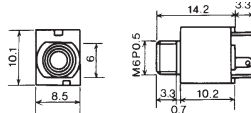
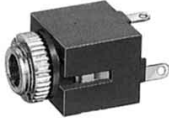

No. MJ-074N (3.5 -3極)

PANEL MOUNT MINIATURE JACK
STEREO

No. MJ-074N0 (3.5 -3極)

3-CONDUCTOR MINIATURE JACK FOR P.C.B
WITHOUT SCREW THREAD
STEREO

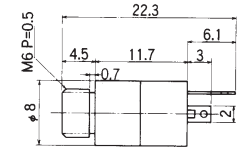
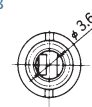

MJ-074N

No. MJ-082 (3.5 -3極)

No. MJ-083 (3.5 -3極)

PANEL MOUNT MINIATURE JACK
STEREO

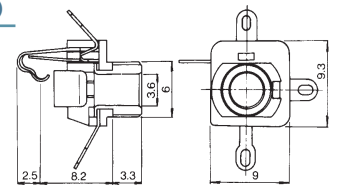
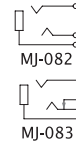

MJ-083

4-CONDUCTOR MINIATURE PLUGS & JACKS

3.5 - 4極小形単頭プラグ・ジャック

No. MP-435 (3.5 -4極)

4-CONDUCTOR MINIATURE PLUG

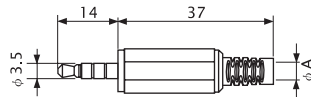

φA	φ4	MP-435
	φ5	MP-435/5

No. MP-435LN (3.5 -4極)

4-CONDUCTOR MINIATURE RIGHT ANGLE PLUG

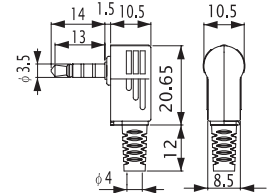

No. MJ-064 (3.5 -4極)

MINIATURE INLINE JACK

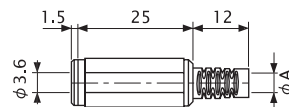

φA	φ4	MJ-064
	φ5	MJ-064/5

No. MC-4350 (3.5 -4極)

4-CONDUCTOR MINIATURE PLUG WITH 1.8M LONG CABLE



No. M03-A01B0 (3.5 -4極)

No. M03-A01C0 (3.5 -4極)

MINIATURE INLINE JACK FOR MOLDING
4-CONDUCTOR

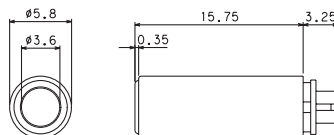
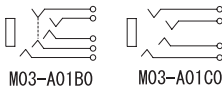

No. MC-4350L (3.5 -4極)

MINIATURE RIGHT ANGLE PLUG WITH 1.8M LONG CABLE
4-CONDUCTOR



Marushin electric mfg. co., ltd



AUDIO PHONE PLUGS & JACKS

5-CONDUCTOR MINIATURE PLUG & JACKS 3.5 - 5極小形単頭プラグ・ジャック

No. **M03-A10A0** (3.5 -5極)
5-CONDUCTOR MINIATURE JACK FOR P.C.B

No. **M03-A10C0** (3.5 -5極) SMT
5-CONDUCTOR MINIATURE JACK FOR P.C.B

No. **M19-A11Z0** (3.5 -5極)
5-CONDUCTOR MINIATURE PLUG FOR MOLDING

No. **M03-A01A0** (3.5 -5極)
MINIATURE INLINE JACK FOR MOLDING
5-CONDUCTOR

6-CONDUCTOR MINIATURE PLUG & JACKS 3.5 - 6極小形単頭プラグ・ジャック

No. **M03-A50A0** (3.5 -6極)
6-CONDUCTOR MINIATURE JACK FOR P.C.B

No. **M03-A50C0** (3.5 -6極) SMT
6-CONDUCTOR MINIATURE JACK FOR P.C.B

No. **M19-A11Y0** (3.5 -6極)
6-CONDUCTOR MINIATURE PLUG FOR MOLDING

Marushin electric mfg. co., ltd

2-CONDUCTOR 1/4" PHONE PLUGS & JACKS

6.3 - 2極大型単頭プラグ・ジャック

No.MP-109B (6.3 -2極)

2-CONDUCTOR 1/4" PHONE PLUG.
MONO

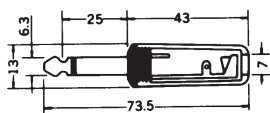

No.MP-114M (6.3 -2極)

2-CONDUCTOR 1/4" PHONE PLUG.
MONO

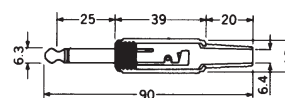

No.MP-111MS (6.3 -2極)

2-CONDUCTOR 1/4" PHONE PLUG.
w/shielded handle
MONO

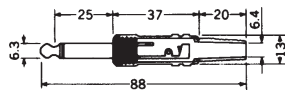

No.MP-127L (6.3 -2極)

2-CONDUCTOR 1/4" RIGHT ANGLE PHONE PLUG.
MONO

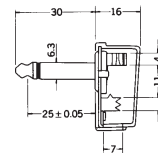

No.MP-123 (6.3 -2極)

2-CONDUCTOR RIGHT ANGLE 1/4" PHONE PLUG.
w/shielded handle
MONO

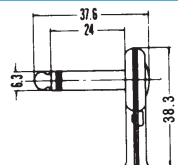

No.MJ-168M (6.3 -2極)

2-CONDUCTOR 1/4" PHONE INLINE JACK
MONO

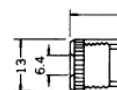

No.MJ-116M (6.3 -2極)

2-CONDUCTOR 1/4" PHONE INLINE JACK
MONO

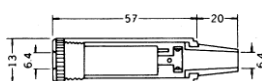

No.MJ-169MS (6.3 -2極)

2-CONDUCTOR 1/4" PHONE INLINE JACK
w/shielded handle
MONO

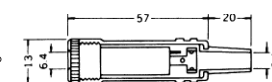

No.MJ-168A (6.3 -2極)

2-CONDUCTOR 1/4" PHONE INLINE JACK
MONO

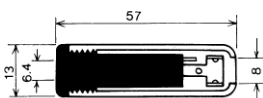

No.MJ-116A (6.3 -2極)

2-CONDUCTOR 1/4" PHONE INLINE JACK
MONO

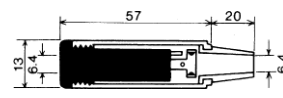

No.MJ-169A (6.3 -2極)

2-CONDUCTOR 1/4" PHONE INLINE JACK
w/shielded handle
MONO

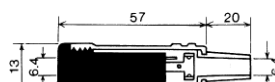

No.MJ-159M (6.3 -2極)

2-CONDUCTOR PANEL MOUNT 1/4" PHONE JACK
MONO

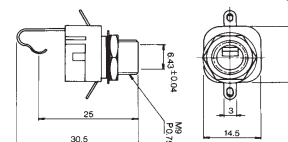

No.MJ-160M (6.3 -2極)

2-CONDUCTOR PANEL MOUNT 1/4" PHONE JACK
MONO

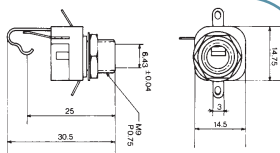

No.MJ-185 (6.3 -2極)

2-CONDUCTOR PANEL MOUNT 1/4" PHONE JACK
MONO

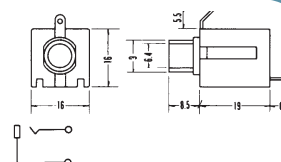

No.MJ-186 (6.3 -2極)

2-CONDUCTOR PANEL MOUNT 1/4" PHONE JACK
MONO

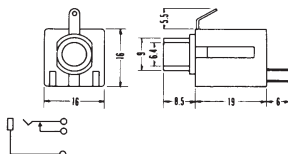

No.MJ-185LP (6.3 -2極)

2-CONDUCTOR PANEL MOUNT 1/4" PHONE JACK
W/ISOLATED BUSHING (パネル絶縁タイプ)
MONO

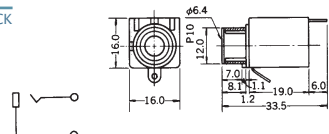

No.MJ-186LP (6.3 -2極)

2-CONDUCTOR PANEL MOUNT 1/4" PHONE JACK
W/ISOLATED BUSHING (パネル絶縁タイプ)
MONO

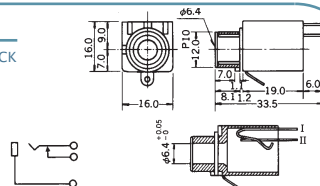

3-CONDUCTOR 1/4" PHONE PLUGS & JACKS

6.3 - 3極大型単頭プラグ・ジャック

No.MP-119B (6.3 -3極)

3-CONDUCTOR 1/4" PHONE PLUG.
STEREO

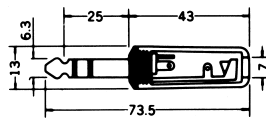

No.MP-115M (6.3 -3極)

3-CONDUCTOR 1/4" PHONE PLUG.
STEREO

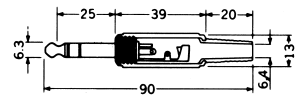

No.MP-120MS (6.3 -3極)

3-CONDUCTOR 1/4" PHONE PLUG.
w/shielded handle
STEREO

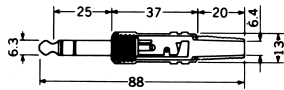

No.MP-128L (6.3 -3極)

3-CONDUCTOR 1/4" RIGHT ANGLE PHONE PLUG.
STEREO

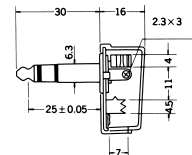

No.MJ-175MN (6.3 -3極)

3-CONDUCTOR 1/4" PHONE INLINE JACK
STEREO

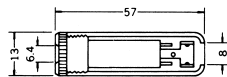

No.MJ-117MM (6.3 -3極)

3-CONDUCTOR 1/4" PHONE INLINE JACK
STEREO

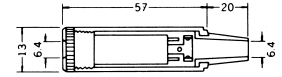

No.MJ-177MSN (6.3 -3極)

3-CONDUCTOR 1/4" PHONE INLINE JACK
w/shielded handle
STEREO

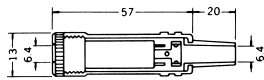

No.MJ-175AN (6.3 -3極)

3-CONDUCTOR 1/4" PHONE INLINE JACK
STEREO

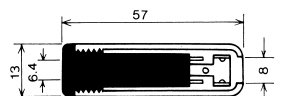

No.MJ-117AN (6.3 -3極)

3-CONDUCTOR 1/4" PHONE INLINE JACK
STEREO

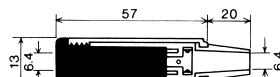

No.MJ-177AN (6.3 -3極)

3-CONDUCTOR 1/4" PHONE INLINE JACK
w/shielded handle
STEREO

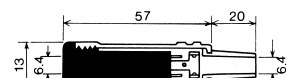

No.MJ-161M (6.3 -3極)

3-CONDUCTOR PANEL MOUNT 1/4" PHONE JACK
STEREO

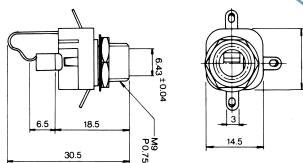

No.MJ-178M (6.3 -3極)

3-CONDUCTOR PANEL MOUNT 1/4" PHONE JACK
STEREO

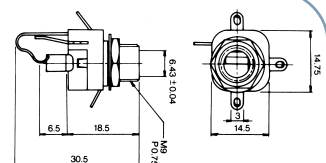

No.MJ-187 (6.3 -3極)

3-CONDUCTOR OPEN CIRCUIT JACK
STEREO

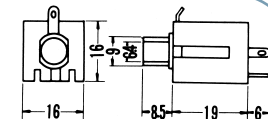

No.MJ-189 (6.3 -3極)

3-CONDUCTOR PANEL MOUNT 1/4" PHONE JACK
STEREO

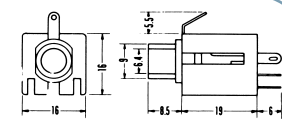

No.MJ-187LP (6.3 -3極)

3-CONDUCTOR PANEL MOUNT 1/4" PHONE JACK
W/ISOLATED BUSHING (パネル絶縁タイプ)
STEREO

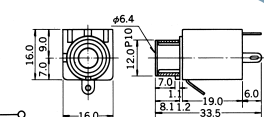

No.MJ-189LP (6.3 -3極)

3-CONDUCTOR PANEL MOUNT 1/4" PHONE JACK
W/ISOLATED BUSHING (パネル絶縁タイプ)
STEREO

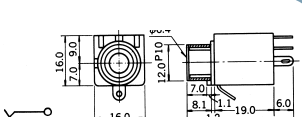

No.MJ-188-C (6.3 -3極)

3-CONDUCTOR PANEL MOUNT 1/4" PHONE JACK
STEREO

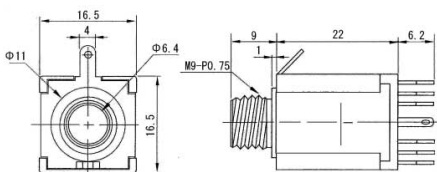

No.MJ-188LPD-2SC (6.3 -3極)

3-CONDUCTOR 1/4" PHONE JACK FOR P.C.B
STEREO

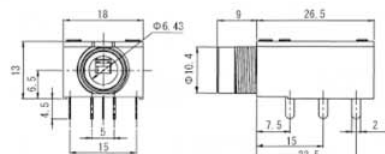

No.MJ-188LPD-6C (6.3 -3極)

No.MJ-188LPD-8C (6.3 -3極)

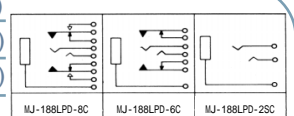



DC PLUGS & JACKS

EIAJ RC5320A TYPE1

電圧区分1 適合品

RATING 定 格 : DC3.15V 2A

No.MP-201

2.35 × 0.7 DC PLUG
EIAJ RC5320A TYPE1 電圧区分1
(DC 3.15V Max)

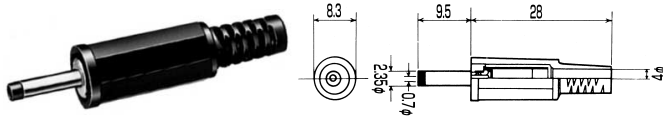

No.MP-201LN

2.35 × 0.7 DC PLUG
EIAJ RC5320A TYPE1 電圧区分1
(DC 3.15V Max)

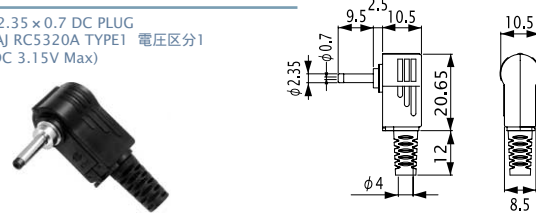

No.MC-5321

DC ADAPTOR CABLE L=1800mm
2.35 × 0.7
EIAJ RC5320A TYPE1 電圧区分1
(DC3.15V)



No.MC-5321L

DC ADAPTOR CABLE L=1800mm
2.35 × 0.7
EIAJ RC5320A TYPE1 電圧区分1
(DC3.15V)



No.M04-450DJ

DC JACK FOR P.C.B.
PLUG TYPE: 2.35 × 0.7
EIAJ RC5320A TYPE1 電圧区分1
(DC 3.15V 2A)

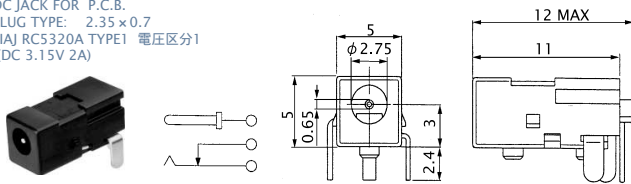

No.M04-451DJ

DC JACK FOR P.C.B.
PLUG TYPE: 2.35 × 0.7
EIAJ RC5320A TYPE1 電圧区分1
(DC 3.15V 2A)

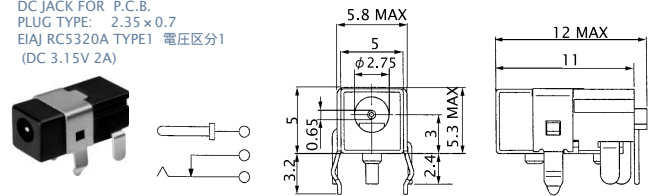

No.M04-959A0

DC JACK FOR P.C.B.
PLUG TYPE: 2.35 × 0.7
EIAJ RC5320A TYPE1 電圧区分1
(DC 3.15V 2A)

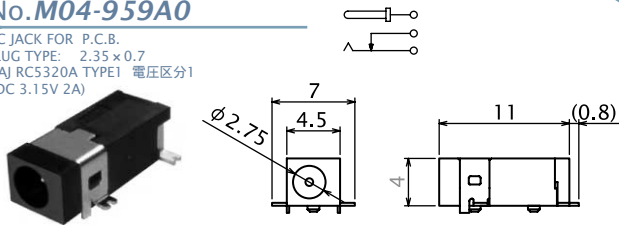

No.M04-A18A0

DC JACK
PLUG TYPE: 2.35 × 0.7
EIAJ RC5320A TYPE1 電圧区分1
(DC3.15V 2A)

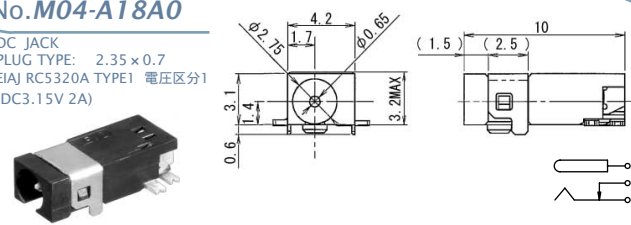

No.MJ-095N

DC INLINE JACK
PLUG TYPE: 2.35 × 0.7
EIAJ RC5320A TYPE1 電圧区分1
(DC 3.15V 2A)

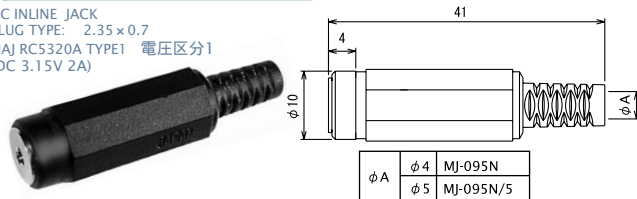

No.MJ-16

PANEL MOUNT DC JACK
PLUG TYPE: 2.35 × 0.7
EIAJ RC5320A TYPE1 電圧区分1
(DC 3.15V 2A)

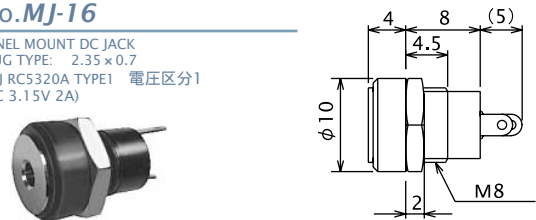



DC PLUGS & JACKS

EIAJ RC5320A TYPE2

電圧区分2 適合品

RATING 定 格: DC6.3V 2A

No.MP-202

4.0 x 1.7 DC PLUG
EIAJ RC5320A TYPE2 電圧区分2
(DC 3.15V ~ 6.3V)

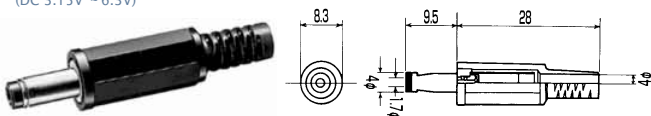

No.MP-202LN

4.0 x 1.7 DC PLUG
EIAJ RC5320A TYPE2 電圧区分2
(DC 3.15V ~ 6.3V)

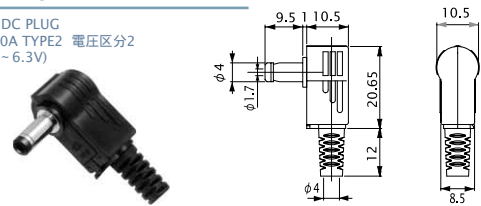

No.MC-5322

DC ADAPTOR CABLE L=1800mm
4.0 x 1.7 DC PLUG
EIAJ RC5320A TYPE2 電圧区分2
(DC 3.15V ~ 6.3V)



No.MC-5322L

DC ADAPTOR CABLE L=1800mm
4.0 x 1.7 DC PLUG
EIAJ RC5320A TYPE2 電圧区分2
(DC 3.15V ~ 6.3V)



No.M04-339A0

DC JACK FOR P.C.B.
PLUG TYPE: 4.0 x 1.7
EIAJ RC5320A TYPE2 電圧区分2
(DC 3.15V ~ 6.3V 2A)

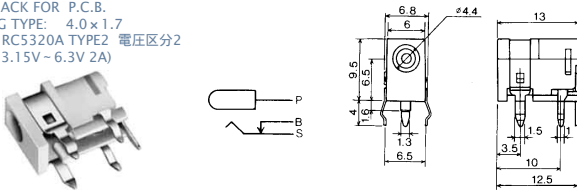

No.M04-730A0

DC JACK FOR P.C.B.
PLUG TYPE: 4.0 x 1.7
EIAJ RC5320A TYPE2 電圧区分2
(DC 3.15V ~ 6.3V 2A)

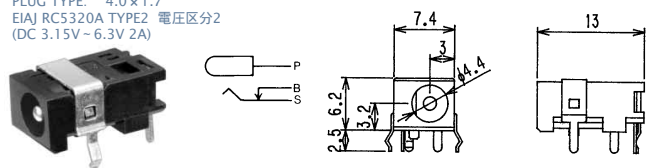

No.M04-260DJ

DC JACK FOR P.C.B.
PLUG TYPE: 4.0 x 1.7
EIAJ RC5320A TYPE2 電圧区分2
(DC 3.15V ~ 6.3V 2A)

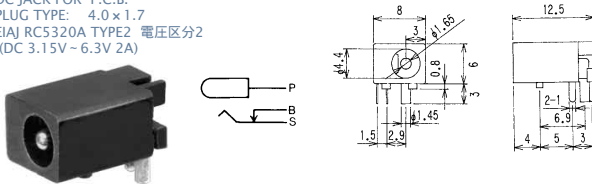

No.M04-520DJ

DC JACK FOR P.C.B. (VERTICAL TYPE)
PLUG TYPE: 4.0 x 1.7
EIAJ RC5320A TYPE2 電圧区分2
(DC 3.15V ~ 6.3V 2A)

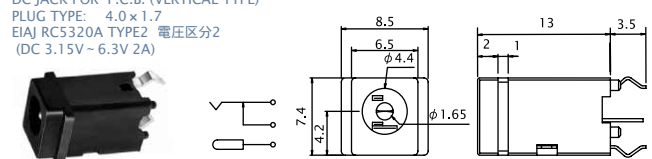

No.MJ-17

PANEL MOUNT DC JACK
PLUG TYPE: 4.0 x 1.7
EIAJ RC5320A TYPE2 電圧区分2
(DC 3.15V ~ 6.3V 2A)

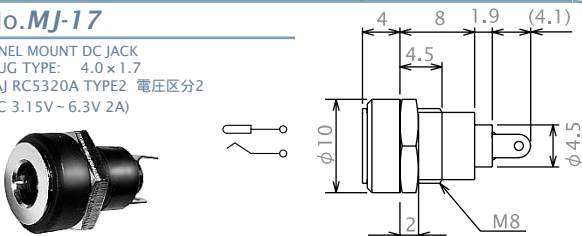

No.MJ-12

PANEL MOUNT DC JACK
PLUG TYPE: 4.0 x 1.7
EIAJ RC5320A TYPE2 電圧区分2
(DC 3.15V ~ 6.3V 2A)

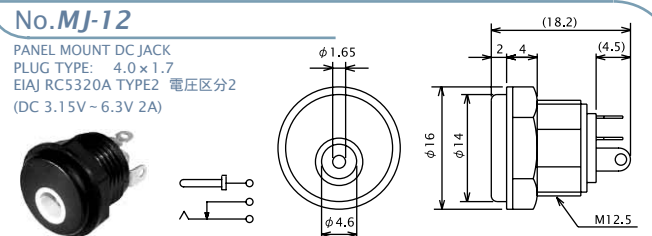

No.MJ-72

PANEL MOUNT DC JACK
PLUG TYPE: 4.0 x 1.7
EIAJ RC5320A TYPE2 電圧区分2
(DC 3.15V ~ 6.3V 2A)

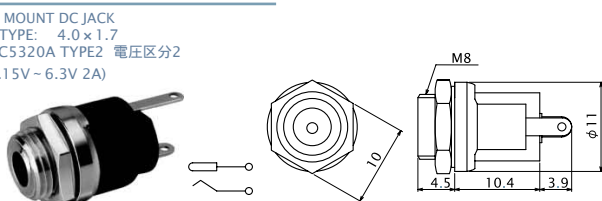

No.MJ-42

PANEL MOUNT DC JACK
PLUG TYPE: 4.0 x 1.7
EIAJ RC5320A TYPE2 電圧区分2
(DC 3.15V ~ 6.3V 2A)

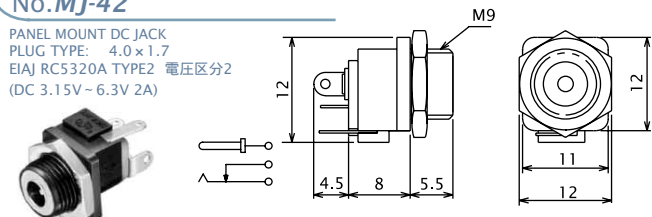

No.MJ-096N

DC INLINE JACK
PLUG TYPE: 4.0 x 1.7
EIAJ RC5320A TYPE2 電圧区分2
(DC 3.15V ~ 6.3V 2A)

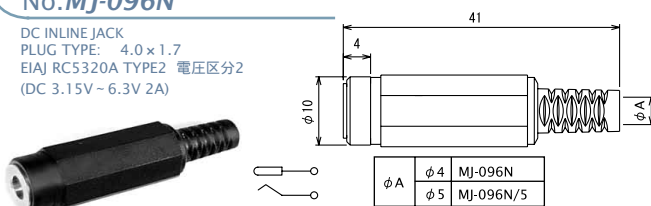

No.MJ-62

SNAP-IN MOUNT DC JACK
PLUG TYPE: 4.0 x 1.7
EIAJ RC5320A TYPE2 電圧区分2
(DC 3.15V ~ 6.3V 2A)

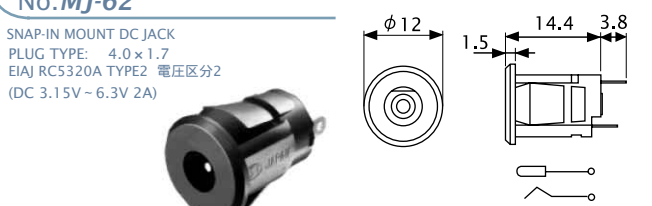

No.MC-5327

DC EXTENSION CABLE
PLUG TYPE: 4.0 x 1.7
EIAJ RC5320A TYPE2 電圧区分2
(DC 3.15V ~ 6.3V 2A)



No.MJ-28

DC INLINE JACK FOR MOLDING
PLUG TYPE: 4.0 x 1.7
EIAJ RC5320A TYPE2 電圧区分2
(DC 3.15V ~ 6.3V 2A)

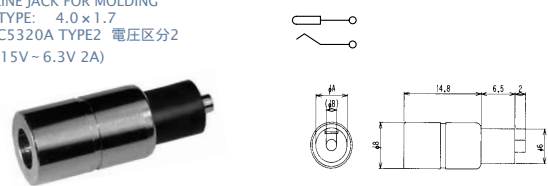



DC PLUGS & JACKS

EIAJ RC5320A TYPE2

電圧区分2 適合品

RATING 定 格: DC6.3V 2A

No. M04-A49A0

DC JACK
PLUG TYPE: 4.0 x 1.7
EIAJ RC5320A TYPE2 電圧区分2
(DC3.15V ~ 6.3V 2A)

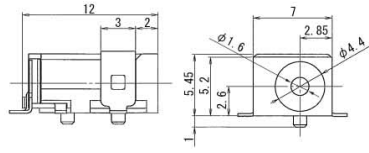

Marushin electric mfg. co., ltd

EIAJ RC5320A TYPE3

電圧区分3

適合品

RATING 定 格 : DC10.5V 2A

No.MP-203

4.75 × 1.7 DC PLUG
EIAJ RC5320A TYPE3 電圧区分3
(DC 6.3V ~ 10.5V)

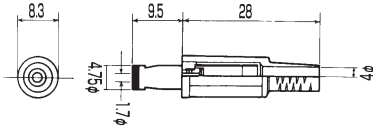

No.MP-203LN

4.75 × 1.7 DC PLUG
EIAJ RC5320A TYPE3 電圧区分3
(DC 6.3V ~ 10.5V)

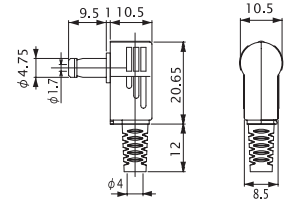

No.MC-5323

DC ADAPTOR CABLE L=1800mm
4.75 × 1.7 DC PLUG
EIAJ RC5320A TYPE3 電圧区分3
(DC 6.3V ~ 10.5V)



No.MC-5323L

DC ADAPTOR CABLE L=1800mm
4.75 × 1.7 DC PLUG
EIAJ RC5320A TYPE3 電圧区分3
(DC 6.3V ~ 10.5V)



No.M04-754A0

DC JACK FOR P.C.B.
PLUG TYPE: 4.75 × 1.7
EIAJ RC5320A TYPE3 電圧区分3
(DC 6.3V ~ 10.5V 2A)

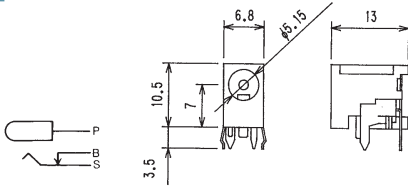

No.M04-533B0

DC JACK FOR P.C.B.
PLUG TYPE: 4.75 × 1.7
EIAJ RC5320A TYPE3 電圧区分3
(DC 6.3V ~ 10.5V 2A)

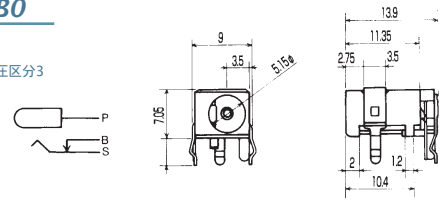

No.MJ-13

PANEL MOUNT DC JACK
PLUG TYPE: 4.75 × 1.7
EIAJ RC5320A TYPE3 電圧区分3
(DC 6.3V ~ 10.5V 2A)

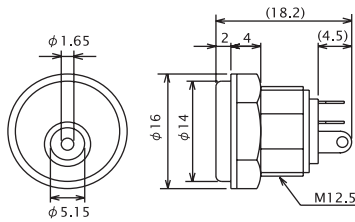

No.MJ-63

SNAP-IN MOUNT DC JACK
PLUG TYPE: 4.75 × 1.7
EIAJ RC5320A TYPE3 電圧区分3
(DC 6.3V ~ 10.5V 2A)

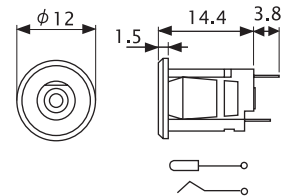

No.MJ-43

PANEL MOUNT DC JACK
PLUG TYPE: 4.75 × 1.7
EIAJ RC5320A TYPE3 電圧区分3
(DC 6.3V ~ 10.5V 2A)

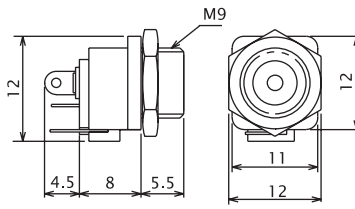

No.MJ-18

PANEL MOUNT DC JACK
PLUG TYPE: 4.75 × 1.7
EIAJ RC5320A TYPE3 電圧区分3
(DC 6.3V ~ 10.5V 2A)

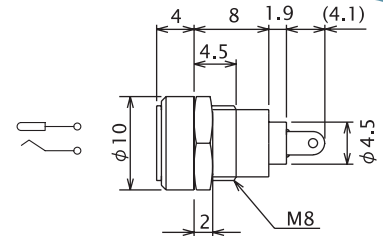

No.MJ-73

PANEL MOUNT DC JACK
PLUG TYPE: 4.75 × 1.7
EIAJ RC5320A TYPE3 電圧区分3
(DC 6.3V ~ 10.5V 2A)

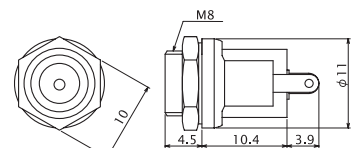

No.MJ-097N

DC INLINE JACK
PLUG TYPE: 4.75 × 1.7
EIAJ RC5320A TYPE3 電圧区分3
(DC 6.3V ~ 10.5V 2A)

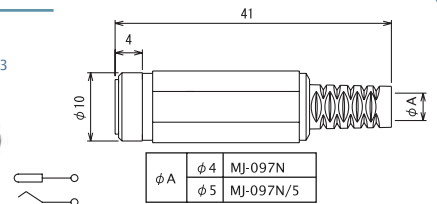

No.MC-5328

DC EXTENSION CABLE
PLUG TYPE: 4.75 × 1.7
EIAJ RC5320A TYPE3 電圧区分3
(DC 6.3V ~ 10.5V 2A)



No.MJ-29

DC INLINE JACK FOR MOLDING
PLUG TYPE: 4.75 × 1.7
EIAJ RC5320A TYPE3 電圧区分3
(DC 6.3V ~ 10.5V 2A)

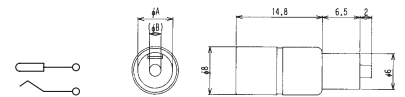

Marushin electric mfg. co., ltd

EIAJ RC5320A TYPE4

電圧区分4

適合品

RATING 定 格 : DC13.5V 2A

No.MP-204

5.5×3.3 (center pin : 1.0) DC PLUG
EIAJ RC5320A TYPE4 電圧区分4
(DC 10.5V ~ 13.5V 2A)

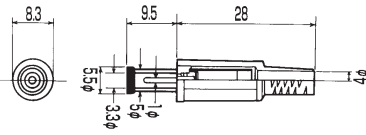

No.MP-204LN

5.5×3.3 (center pin : 1.0) RIGHT ANGLE DC PLUG
EIAJ RC5320A TYPE4 電圧区分4
(DC 10.5V ~ 13.5V 2A)

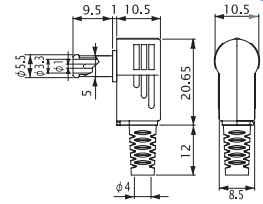

No.MC-5324

DC ADAPTOR CABLE L=1800mm
5.5×3.3 (center pin : 1.0) DC PLUG
EIAJ RC5320A TYPE4 電圧区分4
(DC 10.5V ~ 13.5V 2A)



No.MC-5324L

RIGHT ANGLE DC ADAPTOR CABLE L=1800mm
5.5×3.3 (center pin : 1.0) DC PLUG
EIAJ RC5320A TYPE4 電圧区分4
(DC 10.5V ~ 13.5V 2A)



No.M04-700A0

No.M04-700D1

DC JACK FOR P.C.B.
PLUG TYPE: 5.5×3.3 (center pin : 1.0)
EIAJ RC5320A TYPE4 電圧区分4
(DC 10.5V ~ 13.5V 2A)

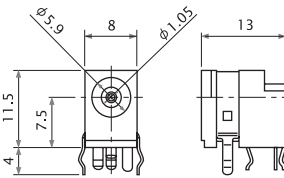
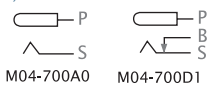

No.MJ-084N

DC INLINE JACK
PLUG TYPE: 5.5×3.3 (Center pin : 1.0)
EIAJ RC5320A TYPE4 電圧区分4
(DC 10.5V ~ 13.5V 2A)

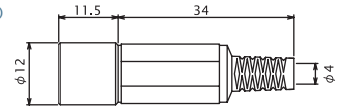

No.M04-480DJ

DC JACK FOR P.C.B.
PLUG TYPE: 5.5×3.3 (center pin : 1.0)
EIAJ RC5320A TYPE4 電圧区分4
(DC 10.5V ~ 13.5V 2A)

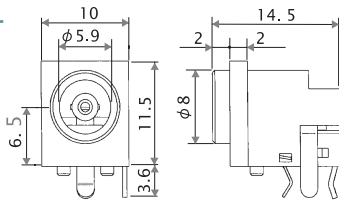

No.M04-390DJ

DC JACK FOR P.C.B.
PLUG TYPE: 5.5×3.3 (center pin : 1.0)
EIAJ RC5320A TYPE4 電圧区分4
(DC 10.5V ~ 13.5V 2A)

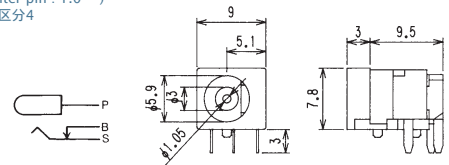

No.MJ-19

PANEL MOUNT DC JACK
PLUG TYPE: 5.5×3.3 (center pin : 1.0)
EIAJ RC5320A TYPE4 電圧区分4
(DC 10.5V ~ 13.5V 2A)

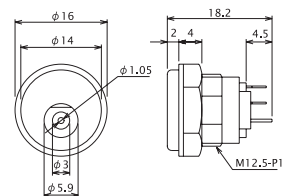

Marushin electric mfg. co., ltd.



DC PLUGS & JACKS

EIAJ RC5320A TYPE5 电压区分5 適合品

RATING 定格: DC18V 2A

No.MP-205

6.5×4.3(center pin: 1.4) DC PLUG
EIAJ RC5320A TYPE5 电压区分5
(DC 13.5V ~ 18V 2A)

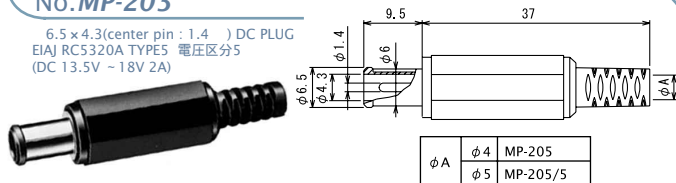

No.MC-5325

DC ADAPTOR CABLE L=1800mm
6.5×4.3(center pin: 1.4) DC PLUG
EIAJ RC5320A TYPE5 电压区分5
(DC 13.5V ~ 18V 2A)



No.MC-5325L

RIGHT ANGLE DC ADAPTOR CABLE L=1800mm
6.5×4.3(center pin: 1.4) DC PLUG
EIAJ RC5320A TYPE5 电压区分5
(DC 13.5V ~ 18V 2A)



No.MJ-085N

DC INLINE JACK
PLUG TYPE: 6.5×4.3 (Center pin: 1.4)
EIAJ RC5320A TYPE5 电压区分5
(DC 13.5V ~ 18V 2A)

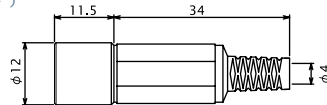

No.M05-532A0

DC JACK FOR P.C.B.
PLUG TYPE: 6.5×4.3(center pin: 1.4)
EIAJ RC5320A TYPE5 电压区分5
(DC 13.5V ~ 18V 2A)

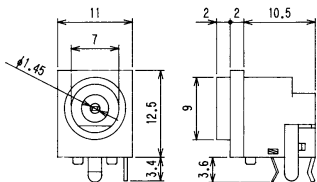
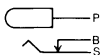

No.MJ-20

PANEL MOUNT DC JACK
PLUG TYPE: 6.5×4.3(center pin: 1.4)
EIAJ RC5320A TYPE5 电压区分5
(DC 13.5V ~ 18V 2A)

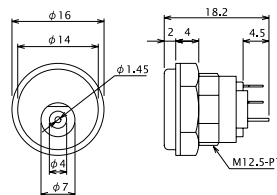

Marushin electric mfg. co., ltd



DC PLUGS & JACKS

PLUG TYPE 5.5 x 2.1 & 5.5 x 2.5

No. MP-121M

5.5 x 2.1 DC PLUG (DC12V 0.5A)

No. MP-122M

5.5 x 2.5 DC PLUG (DC12V 1A)

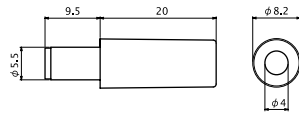

No. MP-121C

5.5 x 2.1 DC PLUG (DC12V 0.5A)

No. MP-122C

5.5 x 2.5 DC PLUG (DC12V 1A)

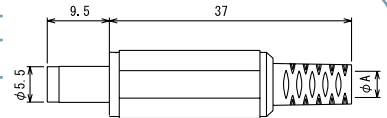

ϕA	$\phi 4$	MP-121C	MP-122C
	$\phi 5$	MP-121C/5	MP-122C/5

No. MP-136

5.5 x 2.1 LONG TYPE DC PLUG (DC12V 0.5A)

No. MP-137

5.5 x 2.5 LONG TYPE DC PLUG (DC12V 1A)

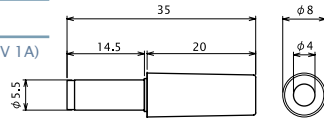

No. MP-136H

5.5 x 2.1 LONG TYPE DC PLUG (DC12V 0.5A)

No. MP-137H

5.5 x 2.5 LONG TYPE DC PLUG (DC12V 1A)

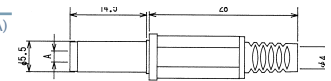

No. MP-136LN

5.5 x 2.1 RIGHT ANGLE DC PLUG (DC12V 0.5A)

No. MP-137LN

5.5 x 2.5 RIGHT ANGLE DC PLUG (DC12V 1A)

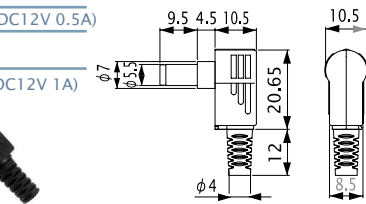

No. MC-2374

5.5 x 2.1 DC PLUG (DC12V 0.5A)

No. MC-2375

5.5 x 2.5 DC PLUG (DC12V 1A)



DC ADAPTOR CABLE L=1800mm

No. MJ-179P

PLUG TYPE: 5.5 x 2.1 (DC12V 0.5A)

No. MJ-180P

PLUG TYPE: 5.5 x 2.5 (DC12V 1A)



DC JACK FOR P.C.B.

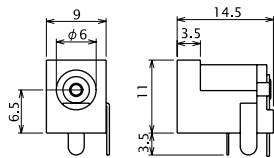

No. MC-2374L

5.5 x 2.1 DC PLUG (DC12V 0.5A)

No. MC-2375L

5.5 x 2.5 DC PLUG (DC12V 1A)



RIGHT ANGLE DC ADAPTOR CABLE L=1800mm

No. MJ-179SMT

PLUG TYPE: 5.5 x 2.1 (DC12V 0.5A)

No. MJ-180SMT

PLUG TYPE: 5.5 x 2.5 (DC12V 1A)



DC JACK FOR P.C.B. SMT

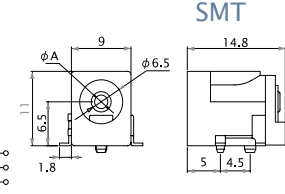

No. MJ-196P

PLUG TYPE: 5.5 x 2.1 (DC12V 0.5A)

No. MJ-197P

PLUG TYPE: 5.5 x 2.5 (DC12V 1A)



DC JACK FOR P.C.B.

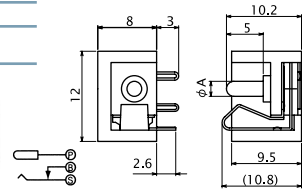

No. MJ-179LE-C

PLUG TYPE: 5.5 x 2.1 (DC12V 0.5A)

No. MJ-180LE-C

PLUG TYPE: 5.5 x 2.5 (DC12V 1A)



DC JACK FOR P.C.B.

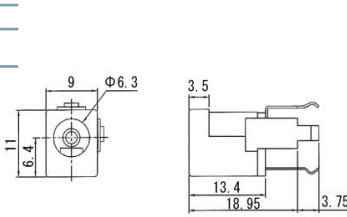

No. MJ-292DJ-C

PLUG TYPE: 5.5 x 2.1 (DC12V 0.5A)



DC JACK FOR P.C.B.

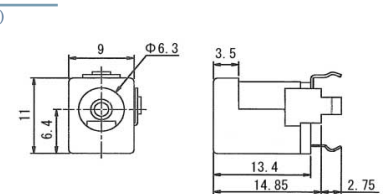

No. MJ-272DJ

PLUG TYPE: 5.5 x 2.1 (DC12V 0.5A)



DC JACK FOR P.C.B.

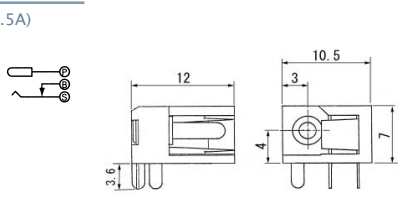

No. MJ-10

PLUG TYPE: 5.5 x 2.1 (DC12V 0.5A)

No. MJ-11

PLUG TYPE: 5.5 x 2.5 (DC12V 1A)



PANEL MOUNT DC JACK

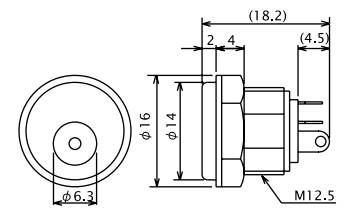

No. MJ-14

PLUG TYPE: 5.5 x 2.1 (DC12V 0.5A)

No. MJ-15

PLUG TYPE: 5.5 x 2.5 (DC12V 1A)

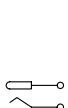

PANEL MOUNT DC JACK

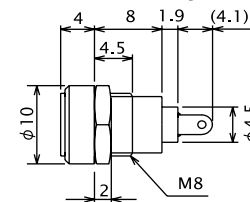

No. MJ-60

PLUG TYPE: 5.5 x 2.1 (DC12V 0.5A)

No. MJ-61

PLUG TYPE: 5.5 x 2.5 (DC12V 1A)

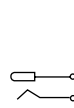

SNAP-IN MOUNT DC JACK

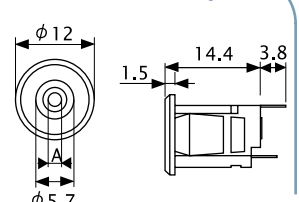

Marushin electric mfg. co., ltd.



DC PLUGS & JACKS

PLUG TYPE 5.5 × 2.1 & 5.5 × 2.5

No. MJ-40

PLUG TYPE: 5.5 × 2.1 (DC12V 0.5A)

PNANEL MOUNT DC JACK

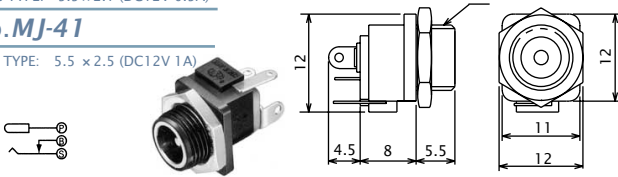

No. MJ-41

PLUG TYPE: 5.5 × 2.5 (DC12V 1A)

No. MJ-70

PLUG TYPE: 5.5 × 2.1 (DC12V 0.5A)

PNANEL MOUNT DC JACK

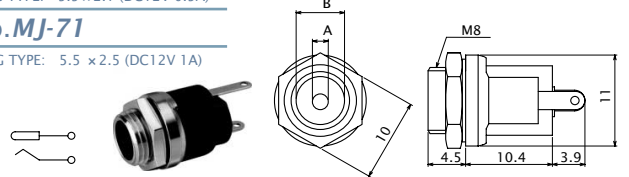

No. MJ-71

PLUG TYPE: 5.5 × 2.5 (DC12V 1A)

No. MJ-181M

PLUG TYPE: 5.5 × 2.1 (DC12V 0.5A)

PNANEL MOUNT DC JACK

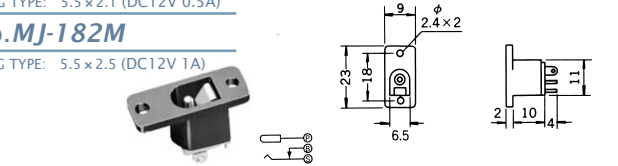

No. MJ-182M

PLUG TYPE: 5.5 × 2.5 (DC12V 1A)

No. MJ-179

PLUG TYPE: 5.5 × 2.1 (DC12V 0.5A)

PNANEL MOUNT DC JACK

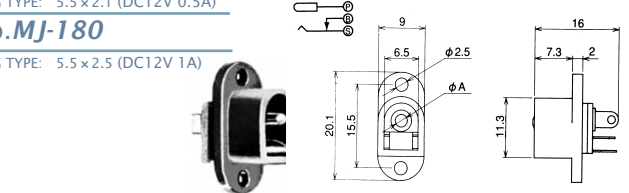

No. MJ-180

PLUG TYPE: 5.5 × 2.5 (DC12V 1A)

No. MJ-196

PLUG TYPE: 5.5 × 2.1 (DC12V 0.5A)

DC JACK INSERT TYPE

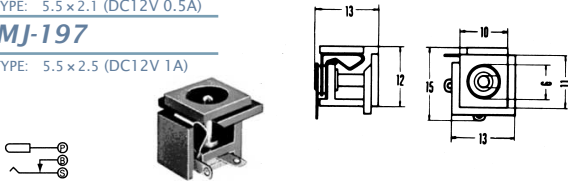

No. MJ-197

PLUG TYPE: 5.5 × 2.5 (DC12V 1A)

No. MJ-181MS

PLUG TYPE: 5.5 × 2.1 (DC12V 0.5A)

PNANEL MOUNT DC JACK (SCREW TYPE)

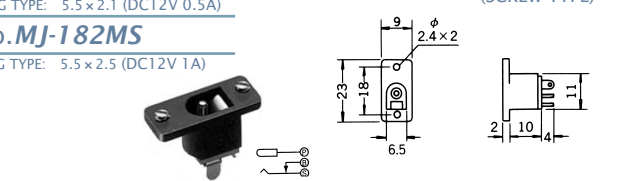

No. MJ-182MS

PLUG TYPE: 5.5 × 2.5 (DC12V 1A)

No. MJ-21

PLUG TYPE: 5.5 × 2.1 (DC12V 0.5A)

PNANEL MOUNT DC JACK

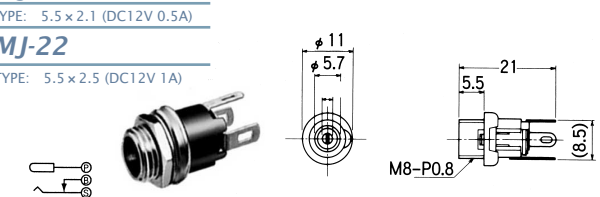

No. MJ-22

PLUG TYPE: 5.5 × 2.5 (DC12V 1A)

No. MJ-196E-C

PLUG TYPE: 5.5 × 2.1 (DC12V 0.5A)

DC JACK INSERT TYPE

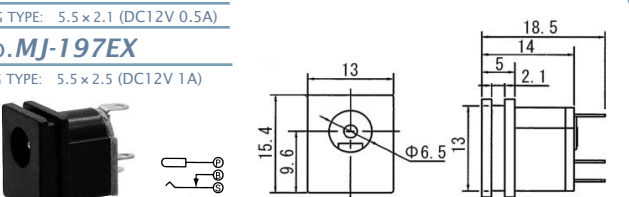

No. MJ-197EX

PLUG TYPE: 5.5 × 2.5 (DC12V 1A)

No. MJ-077N

PLUG TYPE: 5.5 × 2.1 (DC12V 0.5A)

DC INLINE JACK

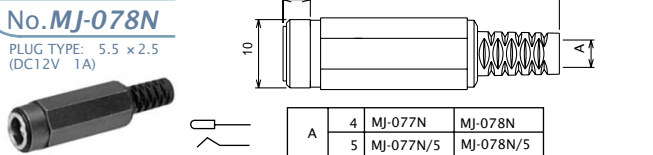

No. MJ-078N

PLUG TYPE: 5.5 × 2.5 (DC12V 1A)

No. MJ-21AM

PLUG TYPE: 5.5 × 2.1 (DC12V 0.5A)

PNANEL MOUNT DC JACK

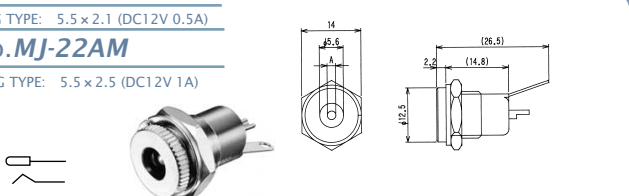

No. MJ-22AM

PLUG TYPE: 5.5 × 2.5 (DC12V 1A)

No. MC-2376

PLUG TYPE: 5.5 × 2.1 (DC12V 0.5A)

DC EXTENSION CABLE L=1800mm



No. MC-2377

PLUG TYPE: 5.5 × 2.5 (DC12V 1A)

No. MJ-23

PLUG TYPE: 5.5 × 2.1 (DC12V 0.5A)

DC INLINE JACK FOR MOLDING



No. MJ-24

PLUG TYPE: 5.5 × 2.5 (DC12V 1A)

No. MA-121SL

PLUG TYPE: 5.5 × 2.1用

DC PLUG ADAPTOR STRAIGHT PLUG TO RIGHT ANGLE PLUG

No. MA-122SL

PLUG TYPE: 5.5 × 2.5用

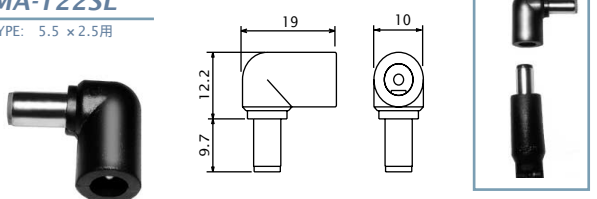

No. MC-1J3P

1 JACK 3 PLUGS (5.5 × 2.1mm) (DC12V 0.5A)

DC CENTIPEDE POWER CABLE

No. MC-1J5P

1 JACK 5 PLUGS (5.5 × 2.1mm) (DC12V 1A)



Other combinations are available upon request.

Marushin electric mfg. co., ltd.



DC PLUGS & JACKS

PLUG TYPE 5.5x2.1 & 5.5x2.5 高容量タイプ High-capacity current type

No. MJ-179PH

DC JACK FOR P.C.B.
PLUG TYPE: 5.5x2.1 (DC12V 4A/2A*SW接点部)
(DC12V 4A/2A* Switch part)

* UL94V-0材使用
Use of flame retardant material (UL94V-0)

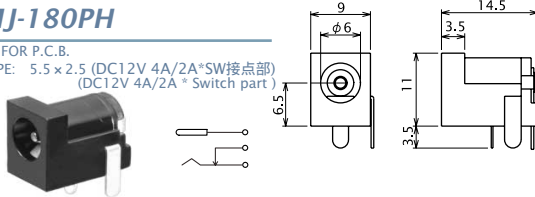

No. MJ-180PH

DC JACK FOR P.C.B.
PLUG TYPE: 5.5x2.5 (DC12V 4A/2A*SW接点部)
(DC12V 4A/2A* Switch part)

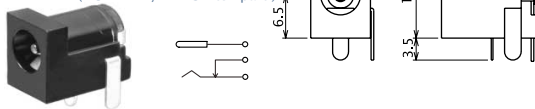

No. MP-121-1

5.5 x 2.1 DC PLUG FOR MOLDING
(DC12V 4A)

* センターコンタクトをフォーク端子（音叉形）形状とし、接触の安定化を図りました。
Two-point contacts assure highly reliable electrical and mechanical connection

No. MP-122-1

5.5 x 2.5 DC PLUG FOR MOLDING
(DC12V 4A)

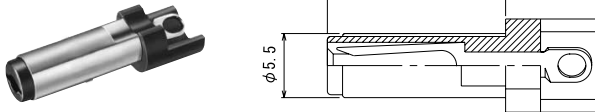

No. MP-121CF

5.5 x 2.1 DC PLUG (DC12V 4A)

* センターコンタクトをフォーク端子（音叉形）形状とし、接触の安定化を図りました。
Two-point contacts assure highly reliable electrical and mechanical connection

No. MP-122CF

5.5 x 2.5 DC PLUG (DC12V 4A)

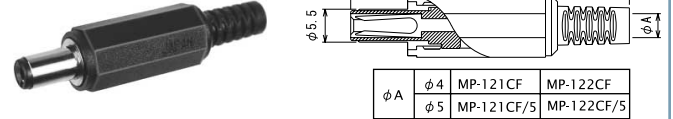

No. MJ-R02

ON-OFFスイッチ付DCジャック
DC POWER JACK WITH SWITCH
PLUG TYPE: 5.5x2.1 (DC12V 2.5A)

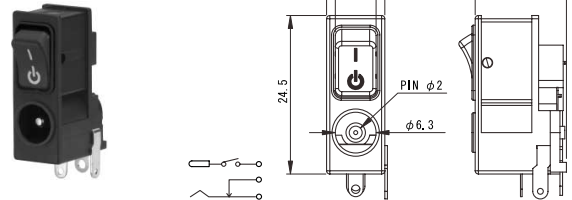

No. MJ-S04

ON-OFFスイッチ付DCジャック
DC POWER JACK WITH SWITCH
PLUG TYPE: 5.5x2.1 (DC12V 2A)

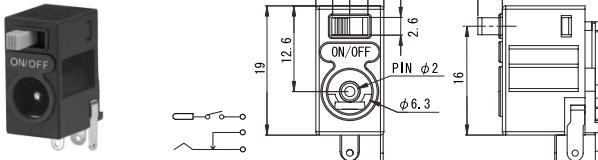

Marushin electric mfg. co., ltd



DC PLUGS & JACKS

PLUG TYPE 3.5 × 1.1

No. MP-135NK

3.5 × 1.1 DC PLUG
(DC12V 0.5A)

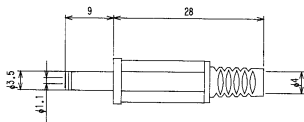

PLUG TYPE 6.3 × 3.1

No. MP-065L

6.3 × 3.1 DC PLUG
(DC12V 2A)

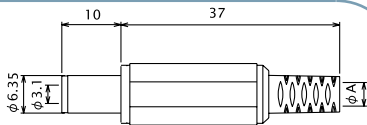

ϕA	$\phi 4$	MJ-065L
	$\phi 5$	MJ-065L/5

No. MJ-065M

PANEL MOUNT DC JACK
PLUG TYPE: 6.3 × 3.1
(DC12V 2A)

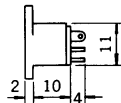
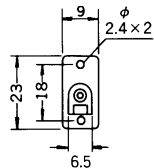

Marushin electric mfg. co., ltd



RCA PHONO PLUGS & JACKS

No. MR-566N

RCA PHONO PLUG
w/shielded handle & cable protector



No. MR-567MS

RCA PHONO JACK
w/shielded handle & cable protector



No. MR-595N

RCA PHONO PLUG



No. MR-596

RCA PHONO JACK



No. MR-595BN

No. MR-595BGN GOLD PLATING (金メッキタイプ)

RCA PHONO PLUG



No. MR-596B

RCA PHONO JACK



No. MR-568N

RCA PHONO PLUG



No. MR-569M

RCA PHONO JACK



No. MR-573P

RCA PHONO PIN JACK FOR P.C.B.

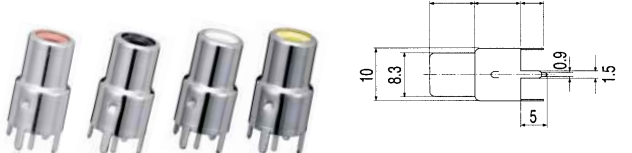

No. MR-3324G

RCA PHONO PLUG (Spring I. D. 7 mm)

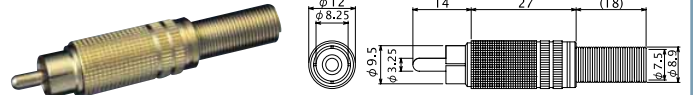

No. MR-3325G

RCA PHONO PLUG (Spring I. D. 6 mm)

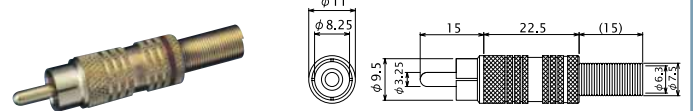

No. MR-544LN

RIGHT ANGLE RCA PHONO PLUG (SOLDERLESS TYPE)

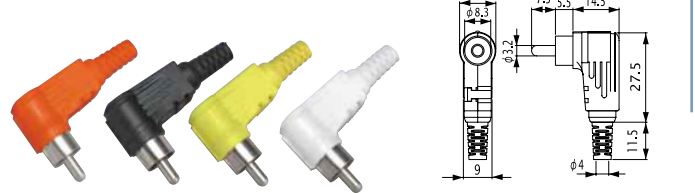

No. MR-565M

PANEL MOUNT RCA PHONO JACK
WITH COLOR RING



No. MR-565MG

W/GOLD PLATING (金メッキタイプ)

PANEL MOUNT RCA PHONO JACK



No. MR-565

PANEL MOUNT RCA PHONO JACK



No. MR-565G

W/GOLD PLATING (金メッキタイプ)

PANEL MOUNT RCA PHONO JACK



No. MR-599

No. MR-599G W/GOLD PLATING (金メッキタイプ)

PANEL MOUNT RCA PHONO JACK

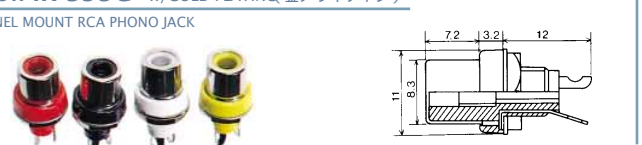

No. MR-699

No. MR-699G W/GOLD PLATING (金メッキタイプ)

ISOLATED RCA PANEL MOUNT PHONE JACK
パネル絶縁型ピンジャック





RCA PHONO JACKS

No. *MR-551LN*

No. *MR-552LN* w/SWITCH

RIGHT ANGLE RCA PHONO PIN JACK FOR P.C.B.

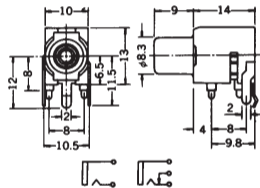

Marushin electric mfg. co., ltd

No. MA-69S (3.5-3極 ↔ 6.3-3極)

ADAPTER 3-CONDUCTOR 1/4" PLUG TO 3-CONDUCTOR MINIATURE JACK

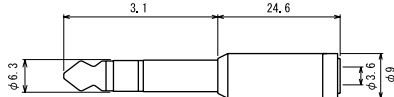

No. MA-68 (6.3-3極 ↔ 3.5-3極)

MOLDED ADAPTOR 3-CONDUCTOR MINIATURE PLUG TO 3-CONDUCTOR 1/4" STEREO JACK

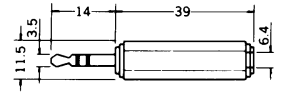

No. MA-68S (6.3-3極 ↔ 3.5-3極)

ADAPTER 3-CONDUCTOR MINIATURE PLUG TO 3-CONDUCTOR 1/4" JACK

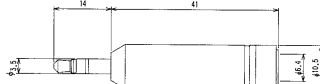

No. MA-69 (3.5-3極 ↔ 6.3-3極)

MOLDED ADAPTOR 3-CONDUCTOR 1/4" PLUG TO 3-CONDUCTOR MINIATURE JACK

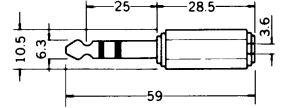

No. MA-66S (RCA ↔ 3.5-2極)

ADAPTER MONO MINIATURE PLUG TO RCA JACK

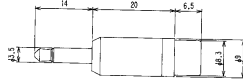

No. MA-85 (3.5-3極 × 2 ↔ 6.3-3極)

ADAPTOR 1/4" STEREO PLUG TO TWO 3.5MM STEREO JACKS

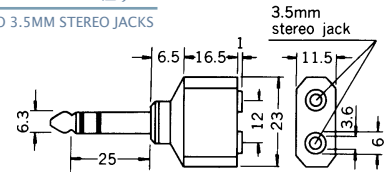

No. MA-36S (RCA ↔ 6.3-2極)

ADAPTOR MONO 1/4" PLUG TO RCA JACK

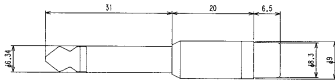

No. MA-80 (3.5-3極 × 2 ↔ 3.5-3極)

ADAPTOR 3.5MM STEREO PLUG TO TWO 3.5MM STEREO JACKS

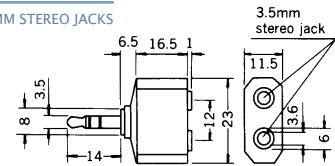

No. MA-47S (RCA中継)

ADAPTOR COUPLED RCA JACK

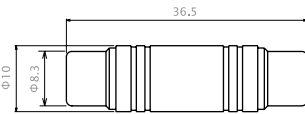

No. MA-88 (RCA × 2 ↔ 3.5-3極)

ADAPTOR 3.5MM STEREO PLUG TO TWO RCA JACKS

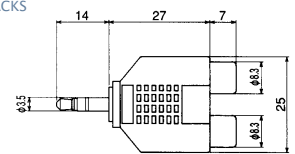

No. MA-76S (3.5-3極 ↔ 3.5-2極)

ADAPTER MONO MINIATURE PLUG TO STEREO MINIATURE JACK

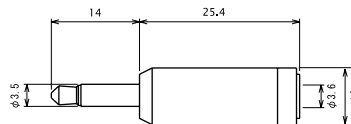

No. MA-90 (RCA × 2 ↔ RCA)

ADAPTOR RCA PLUG TO TWO RCA JACKS

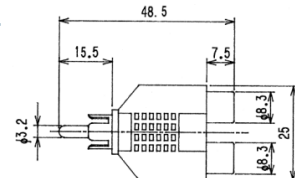

No. MA-47 (RCA中継)

ADAPTER COUPLED RCA JACK

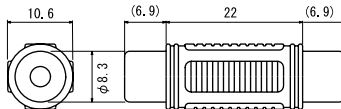

No. MA-91J (RCA × 2 ↔ RCA)

ADAPTOR RCA JACK TO TWO RCA JACKS

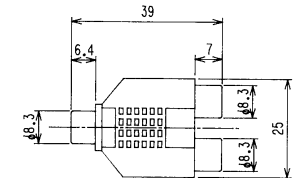

No. MA-235SPJ (3.5-3極 ↔ 2.5-3極)

ADAPTER 2.5MM STEREO PLUG TO 3.5MM STEREO JACK

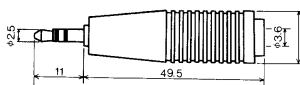

No. MA-77 (3.5-2極 ↔ 3.5-3極)

ADAPTOR 3.5MM STEREO PLUG TO 3.5MM MONO JACK

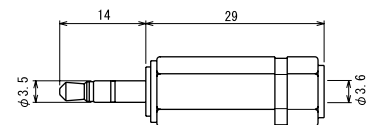

No. MA-78 (3.5-2極 ↔ 2.5-2極)

ADAPTER 2.5MM MONO PLUG TO 3.5MM MONO JACK

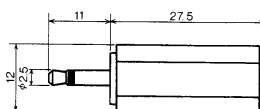

No. MA-76 (3.5-3極 ↔ 3.5-2極)

ADAPTOR 3.5MM MONO PLUG TO 3.5MM STEREO JACK

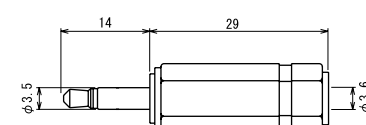



DIN PLUGS & JACKS

No. MP-371/3~8

MINI. CIRCULAR CONNECTOR SOLDER TYPE

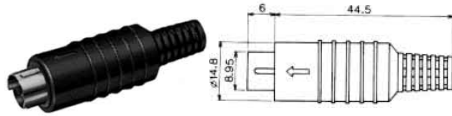

No. of Contact	3P	4P	5P	6P	7P	8P
CONTACT CONFIGURATION						
Model	MP-371/3	MP-371/4	MP-371/5	MP-371/6	MP-371/7	MP-371/8

No. MP-374

MINI. CIRCULAR CONNECTOR 4P FOR S-VHS

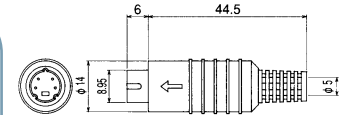

No. MP-371/9~10

MINI. CIRCULAR CONNECTOR SOLDER TYPE

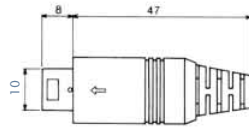

No. of Contact	9P	10P
CONTACT CONFIGURATION		
No. of Contact	MP-371/9	MP-371/10

No. MJ-372/3~9

MINI DIN IN-LINE SOCKET

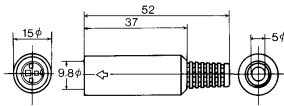

Arrange-ment of Contacts							
Model	MJ-372/3	MJ-372/4	MJ-372/5	MJ-372/6	MJ-372/7	MJ-372/8	MJ-372/9

No. MJ-381/3~8

MINI DIN SOCKET PANEL MOUNT TYPE

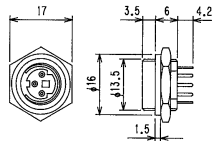

Arrange-ment of Contacts					
Model	MJ-381/3	MJ-381/4	MJ-381/5	MJ-381/6	MJ-381/8

No. MJ-373/3~9

MINI DIN SOCKET SERIES

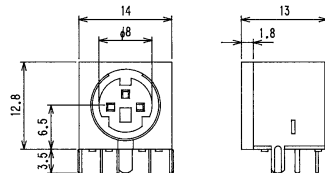

Arrange-ment of Contacts							
Model	MJ-373/3	MJ-373/4	MJ-373/5	MJ-373/6	MJ-373/7	MJ-373/8	MJ-373/9

No. MP-371C

CABLE CLAMP FOR MP-371 & MJ-372
MP-371, MJ-372用コードクランプ



No. MP-130 ~ MP-018

DIN PLUG

No of Contact	3P	5P (180°)	5P (240°)	6P	7P	8P
Arrangement						
Model	6 MP-130	MP-132	MP-133	MP-016	MP-017	MP-018
A	8 MP-130/8	MP-132/8	MP-133/8	MP-016/8	MP-017/8	MP-018/8

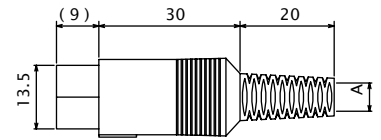

No. MP-130L ~ MP-018L

RIGHT ANGLE DIN PLUG

No of Contact	3P	5P (180°)	5P (240°)	6P	7P	8P
Arrangement						
Model	MP-130L	MP-132L	MP-133L	MP-016L	MP-017L	MP-018L

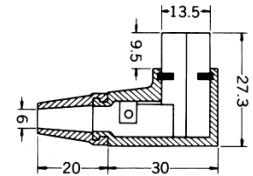
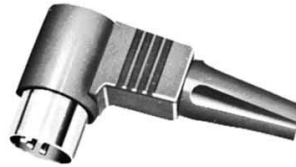

No. MJ-50 ~ MJ-56

INLINE DIN SOCKET

No of Contact	3P	5P	5P	6P	7P	8P
Arrangement						
Model	MJ-50	MJ-52	MJ-53	MJ-54	MJ-55	MJ-56

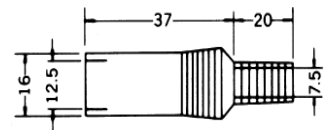

No. MJ-190 ~ MJ-173

PANEL MOUNT DIN SOCKET

No of Contact	3P	5P	5P	6P	7P	8P
Arrangement						
Model	MJ-190	MJ-192	MJ-193	MJ-194	MJ-172	MJ-173

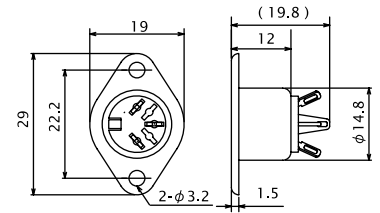

No. MP-05B

5P DIN METAL PLUG (240°) WITH LOCKING RING

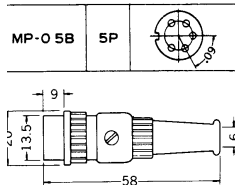

No. MJ-05B

5P DIN JACK (240°)

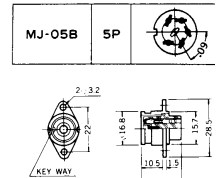

No. MP-134S

2P DIN PLUG SOLDERLESS TYPE

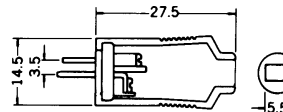

No. MP-134LS

RIGHT ANGLE 2P DIN PLUG SOLDERLESS TYPE

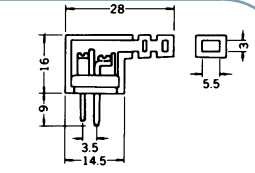

No. MJ-135S

2P DIN INLINE JACK SOLDERLESS TYPE

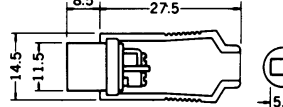

No. MJ-135LS

RIGHT ANGLE 2P DIN INLINE JACK SOLDERLESS TYPE

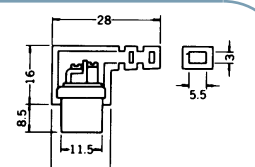

No. MP-134

2P DIN PLUG

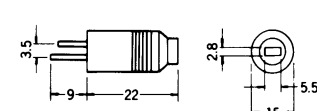

No. MJ-731

2P DIN SOCKET

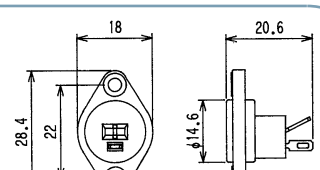

No. MJ-135

2P DIN INLINE JACK

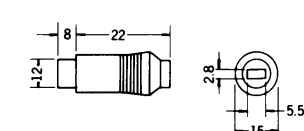



AC/DC PLUGS & SOCKETS

No.MJ-27S

PANEL MOUNT AC CONNECTOR
AC250V 2.5A

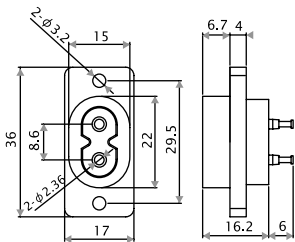

No.MP-199

2P PLUG

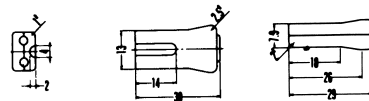

No.MI-767D

2P PLUG

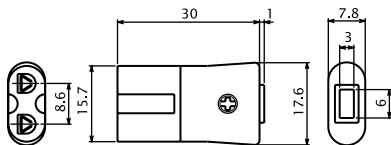

No.MI-198N

2P PLUG

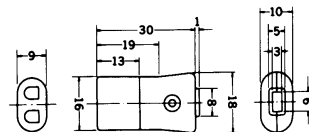

Marushin electric mfg. co., ltd.

No.MTV-245LS MALE PAL
 No.MTV-045LS FEMALE PAL
 No.MTV-245FS MALE NTSC
QUICK TERMINATE
 FULL SHIELDED COAXIAL CONNECTORS

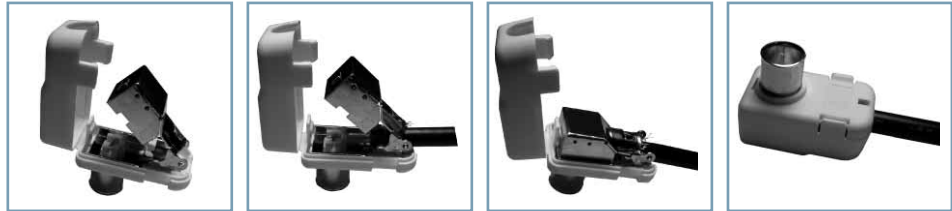

ケースを開け
OPEN UP

処理済ケーブルを挿し込み
PUSH THE CABLE

ケースを閉めれば
SHUT DOWN TO TERMINATE !

ハイ！出来上がり!!



QUICK TERMINATE COAXIAL CONNECTORS
SCREW TYPE

QUICK TERMINATE COAXIAL CONNECTORS

No.MTV-225L PAL
COAXIAL TV AERIAL WIRE CONNECTOR
PLUG ANGLE TYPE

No.MTV-235 PAL
COAXIAL TV AERIAL WIRE CONNECTOR
PLUG

No.MTV-025L PAL
COAXIAL TV AERIAL WIRE CONNECTOR
FEMALE PLUG ANGLE TYPE

No.MTV-035 PAL
COAXIAL TV AERIAL WIRE CONNECTOR
FEMALE PLUG

No.MTV-225LS PAL
COAXIAL TV AERIAL WIRE CONNECTOR
MALE PLUG ANGLE TYPE(SHIELDED)

No.MTV-235F NTSC
COAXIAL TV AERIAL WIRE CONNECTOR
F MALE PLUG

No.MTV-025LS PAL
COAXIAL TV AERIAL WIRE CONNECTOR
FEMALE PLUG ANGLE TYPE(SHIELDED)

No.MTV-240 PAL
COAXIAL TV AERIAL WIRE CONNECTOR
METAL MALE PLUG

No.MTV-225F NTSC
COAXIAL TV AERIAL WIRE CONNECTOR
F MALE PLUG ANGLE TYPE

No.MTV-040 PAL
COAXIAL TV AERIAL WIRE CONNECTOR
METAL FEMALE PLUG

No.MTV-225FS NTSC
COAXIAL TV AERIAL WIRE CONNECTOR
F MALE PLUG ANGLE TYPE(SHIELDED)

No.MTV-240F NTSC
COAXIAL TV AERIAL WIRE CONNECTOR
METAL F MALE PLUG



T.V. & VIDEO CONNECTORS

No. MP-141S PAL

COAXIAL TV AERIAL WIRE CONNECTOR
PLUG(SCREW TYPE) Color : Black & White

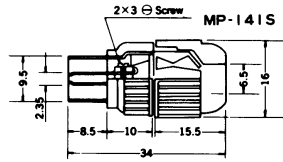

No. MP-555 PAL

HF COAXIAL TV AERIAL WIRE CONNECTOR
(SCREW TYPE) MALE

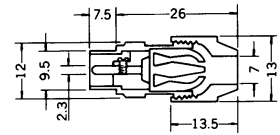

No. MJ-014S PAL

COAXIAL TV AERIAL WIRE CONNECTOR
F MALE PLUG(SCREW TYPE) Color : Black & White

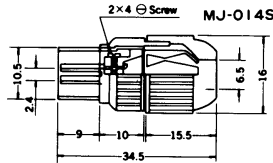

No. MJ-055S PAL

HF COAXIAL TV AERIAL WIRE CONNECTOR
(SCREW TYPE) FEMALE

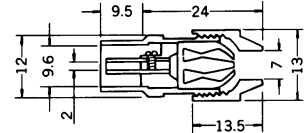

No. MVA-5J UNIVERSAL

COAXIAL CABLE JOINTER

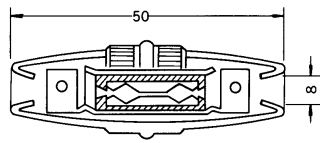

No. MP-150LE PAL

COAXIAL TV AERIAL WIRE CONNECTOR PLUG
ANGLE TYPE (screw type)

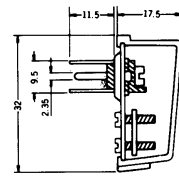

No. MVA-4F PAL-SECAM

COAX. ADAPTOR SECAM MALE TO PAL FEMALE

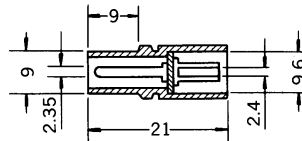

No. MJ-015LE PAL

COAXIAL TV AERIAL WIRE CONNECTOR FEMALE PLUG
ANGLE TYPE (screw type)

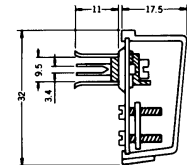

No. MJ-091C PAL

CHASSIS MTG. COAXIAL SOCKET

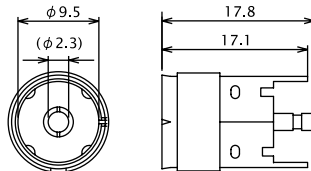

No. MVA-1 PAL

COAXIAL WIRE ADAPTOR MALE TO MALE

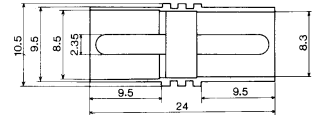

No. MJ-092 PAL

CHASSIS MTG. COAXIAL SOCKET

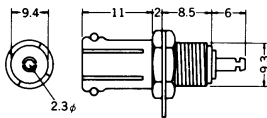

No. MVA-3 PAL

COAXIAL WIRE ADAPTOR FEMALE TO FEMALE

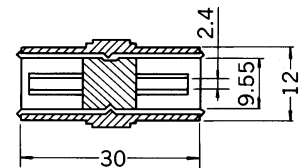

No. MJ-093P PAL

CHASSIS MTG. COAXIAL MALE SOCKET

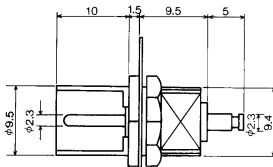

No. MVA-3F SECAM

COAXIAL WIRE ADAPTOR FEMALE TO FEMALE

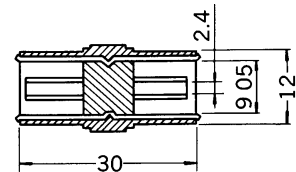

No. MVA-10S PAL

COAXIAL ADAPTOR

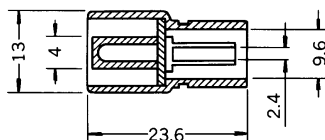

No. MVA-9S PAL

COAXIAL ADAPTOR

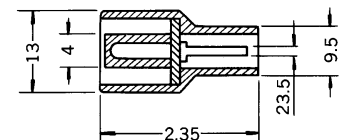



COAXIAL CONNECTORS & ADAPTORS

No. MNC-600AB

INSULATED BNC RECEPTACLE

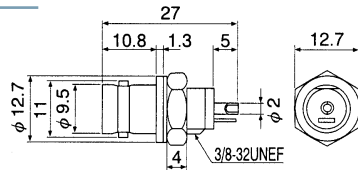

No. MNC-541

BNC STRAIGHT ADAPTOR MALE TO MALE

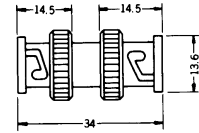

No. MR-598C

CRIMP TYPE BNC CONNECTOR

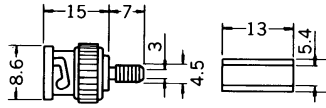

No. MNC-532L

BNC ELBOW ADAPTOR

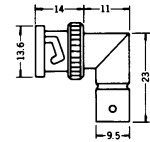

No. MNC-576

BNC PLUG

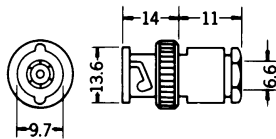

No. MNC-533T

BNC T-ADAPTOR

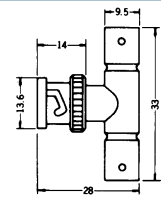

No. MNC-577

BNC PLUG TO F JACK.

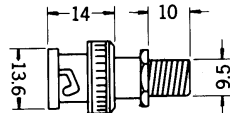

No. MNC-540

BNC STRAIGHT ADAPTOR FEMALE TO FEMALE

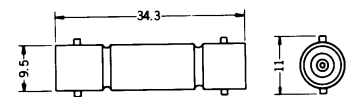

No. MNC-578

BNC PLUG TO RCA JACK.

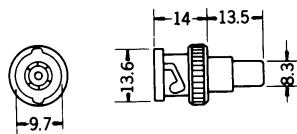

No. MNC-534T

T-ADAPTOR, THREE BNC FEMALES

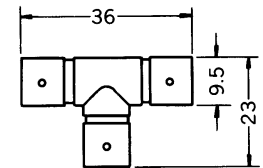

No. MNC-542

RCA TO BNC JACK

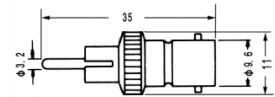

No. MNC-542FP

F PLUG TO BNC JACK

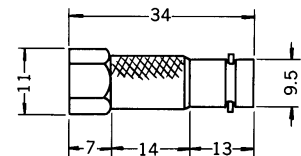

No. MR-587/6

(PL-259)

UHF CONNECTOR

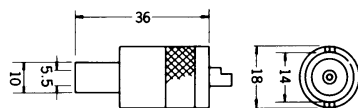

No. MR-587/9

(PL-259)

UHF CONNECTOR

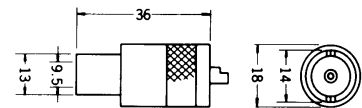

No. MNC-575

BNC PLUG TO PL-259 JACK.

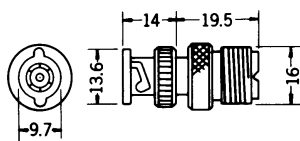

No. MNC-580

PL-259 TO BNC JACK

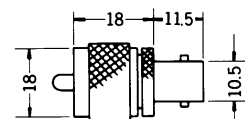

No. MR-574C

ADAPTOR RCA PLUG TO FEMALE PL-259

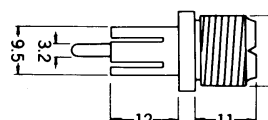

No. MR-590

METAL ADAPTOR : Coupled coaxial cable connector

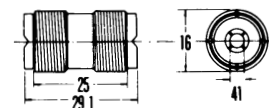



COAXIAL CONNECTORS & ADAPTORS

No. MR-580FJ

UHF PLUG TO F JACK

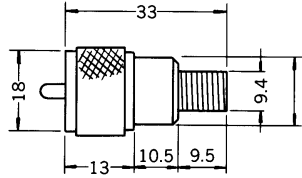

No. MR-581J

PL-259(UHF)PLUG TO RCA JACK

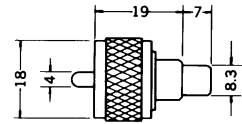

No. MR-574FP

F PLUG TO UHF JACK

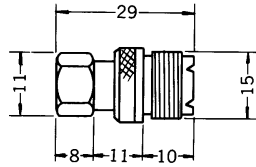

No. MR-574FJ

F JACK TO UHF JACK

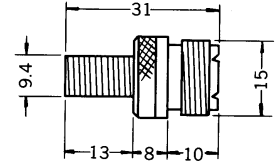

No. MP-557F

F TYPE QUICK ADAPTOR

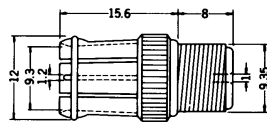

No. MR-582

ADAPTOR F PLUG TO PAL JACK

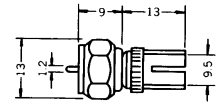

No. MR-559F

F TYPE QUICK PLUG TO RCA JACK

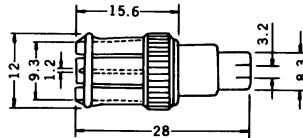

No. MR-584J

F TYPE PANEL MOUNT SOCKET

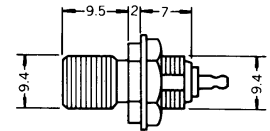

No. MPC-733F

F TYPE QUICK CONNECTOR FOR RG58

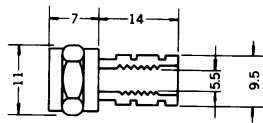

No. MR-583

F TYPE SOCKET

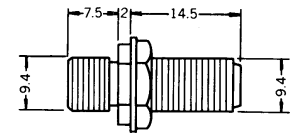

No. MPC-734F

F TYPE QUICK CONNECTOR FOR RG58

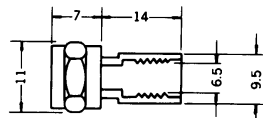

No. MPC-739F

F TYPE CONNECTOR

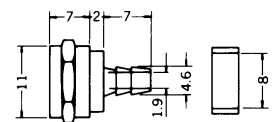

No. MPC-715RP

RCA PLUG TO F PLUG

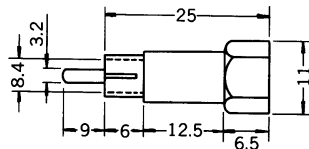

No. MPC-715RJ

RCA PLUG TO F JACK

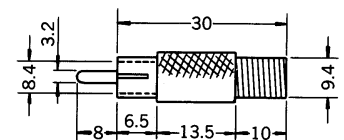

No. MPC-715FJ

RCA JACK TO JACK

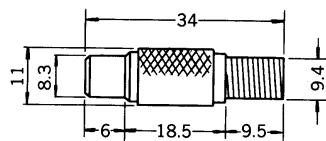

No. MPC-716PF

PAL PLUG TO F JACK

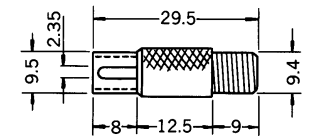

No. MPC-735BF

F JACK TO BNC JACK

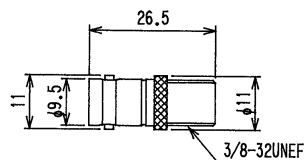

No. MPC-716RP

PAL PLUG TO RCA JACK

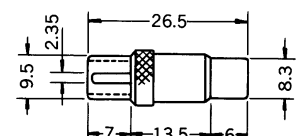



METAL & SCART CONNECTORS

No. MI-719 ~ MI-753

METAL CONNECTOR

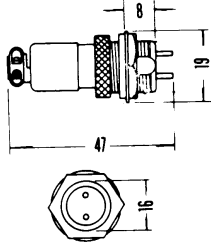

	PLUG	SOCKET
MI-719 2P		
MI-720 3P		
MI-721 4P		
MI-747 5P		
MI-748 6P		
MI-752 7P		
MI-753 8P		

No. MRC-30P

3P METAL CONNECTOR

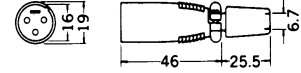

No. MRC-31J

FEMALE CANNON CONNECTOR 3P

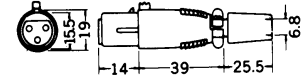

No. MRC-40-3P

MALE CANNON CONNECTOR

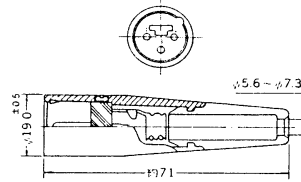

No. MRC-32P

3P PANEL MOUNT MALE JACK

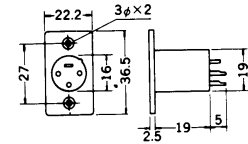

No. MRC-43-3J

FEMALE CANNON CONNECTOR

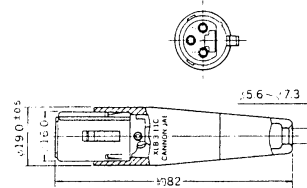

No. MRC-33J

3P PANEL MOUNT FEMALE JACK

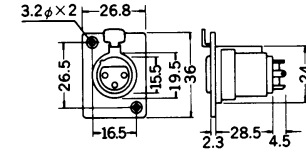

No. MRS-670

SCART(RGB)PLUGS
WITH 20 CONTACT

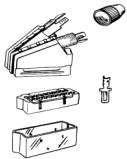

No. MRS-670M

SCART(RGB)PLUGS
20 CONTACT INSTALLED

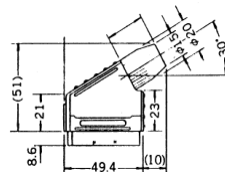
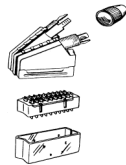

No. MRS-671J

INLINE TYPE SCART SOCKET



Marushin electric mfg.co.,ltd.



IRIS & MICRO CONNECTORS

IRIS & MICRO CONNECTORS

RATING: 0.5A 30V DC マイクロコネクタ 定 格 : DC30V 0.5A

No. MD4-156N-1

PANEL MOUNT IRIS CONNECTOR

No. MD4-156N-2

PANEL MOUNT IRIS CONNECTOR FOR PC BOARD

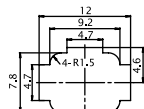
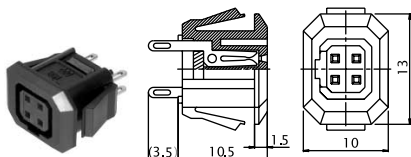

パネル取付穴寸法参考図
適合シャーシ厚 t1.6

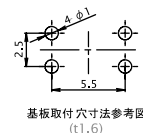

基板取付穴寸法参考図
(t1.6)

端子部詳細 Detail of pins	
MD4-156N-1	MD4-156N-2
0.6 1.2	0.4 0.7 0.75

No. MD4-158N-1

PANEL MOUNT IRIS CONNECTOR

No. MD4-158N-2

PANEL MOUNT IRIS CONNECTOR FOR PC BOARD

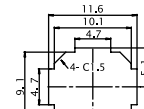
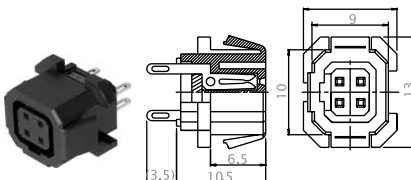

パネル取付穴寸法参考図
適合シャーシ厚 t1.6

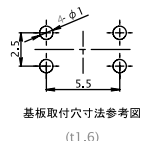

基板取付穴寸法参考図
(t1.6)

端子部詳細 Detail of pins	
MD4-158N-1	MD4-158N-2
0.6 1.2	0.4 0.7 0.75

No. MD4-157J

IRIS CONNECTOR FOR PC BOARD

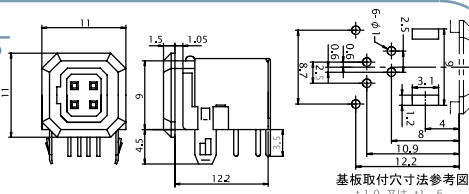

基板取付穴寸法参考図
(t1.0又はt1.6)

No. ME4-191J

CAMERA PLUG
(CABLE SIZE : 2-4)

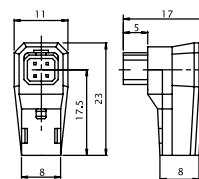

No. MD8-110N

PANEL MOUNT 8P MICRO CONNECTOR
(DC30V 0.5A)

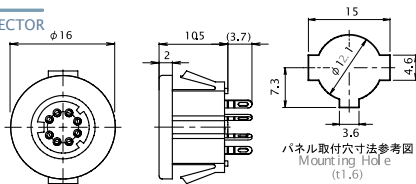

パネル取付穴寸法参考図
Mounting Hole
(t1.6)

No. ME8-120J

8P MICRO CONNECTOR CABLE
(DC30V 0.5A)

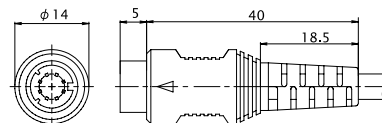



AUTO ANTENNA PLUGS, JACKS & AUTO PLUGS, SOCKETS

No. **MP-129**

AUTO PLUG

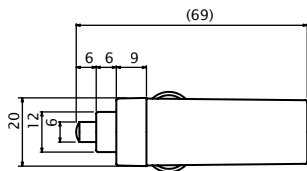

No. **MP-222**

AUTO PLUG W/BUILT-IN FUSE HOLDER

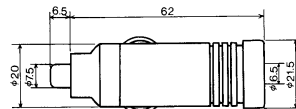

No. **MP-129N**

AUTO PLUG

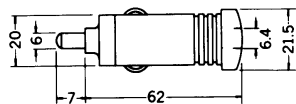

No. **MYBC-012S**

CHASSIS MOUNTED CAR LIGHTER SOCKET

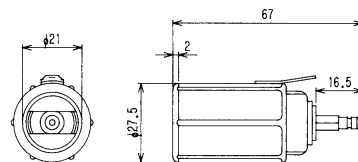

No. **MP-126M**

SOLDERLESS AUTO ANTENNA PLUG

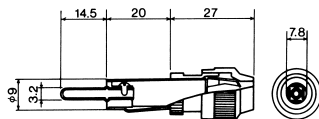

No. **MJ-176M**

SOLDERLESS AUTO ANTENNA INLINE JACK

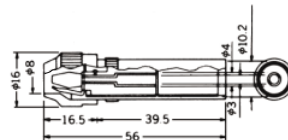

Marushin electric mfg.co.,ltd



MARUSHIN

ヒューズホルダー FUSE HOLDERS

安全規格認可番号一覧表 *Ratings and Safety standard approval No.*

品番 MODEL No.	U L E 8 9 8 7 2	C S A L R 5 9 2 2 9
MF524	10A 250V AC	10A 250V AC
MF524M	10A 250V AC	10A 250V AC
MF525	10A 250V AC	10A 250V AC
MF525M	10A 250V AC	10A 250V AC
MF526	10A 250V AC	10A 250V AC
MF527	10A 250V AC	10A 250V AC
MF528	10A 250V AC	10A 250V AC
MF528H	10A 250V AC	10A 250V AC
MF530	15A 250V AC FASTON 16A 250V AC SOLDER	16A 250V AC
MF530H	15A 250V AC FASTON 16A 250V AC SOLDER	16A 250V AC
MF500	10A 250V AC	10A 250V AC
MF500H	10A 250V AC	10A 250V AC
MF522	10A 250V AC	10A 250V AC
MF560	16A 250V AC	16A 250V AC
MF560A	16A 250V AC	16A 250V AC
MF561	10A 250V AC	10A 250V AC
MF561A	10A 250V AC	10A 250V AC
MF564	E 1 4 5 5 6 9 15A 250V AC	L R 9 4 6 2 8 15A 250V AC

製品仕様 Specification

項目	仕様
定格	個別規程による
接触抵抗	DC 1Aにて10m 以下
絶縁抵抗	DC 500Vにて100M 以上
耐電圧	AC 1500V 1分間(端子間)
適合ヒューズ	個別規程による

Items	Specification
Rating	Shall be in accordance with individual specifications.
Contact resistance	10m MAX at 1A DC
Insulation resistance	100M MIN at 500V DC
Withstand voltage	1,500V AC for 1 minute
Matching Fuse	Shall be in accordance with individual specifications.

Marushin electric mfg. co., ltd.



MARUSHIN

ヒューズホルダー FUSE HOLDERS

定格	Rating
適合ヒューズ	Matching Fuse
キャップ着脱方式	Cap Release method
端子形状	Terminal type
主絶縁材	Insulation material(Body)
取得規格	Approval

No. MF-524

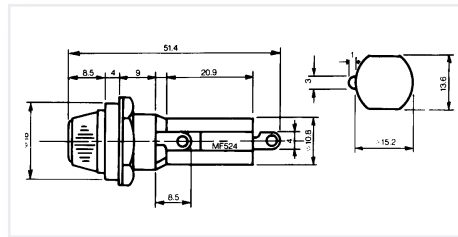

10A 250V AC
6.35 × 31.8mm 6.4 × 30mm
ネジ式 Screw type cap
ハンダ端子 Soldering terminal
フェノール樹脂 Phenolic resin
UL Ⓢ

No. MF-524M

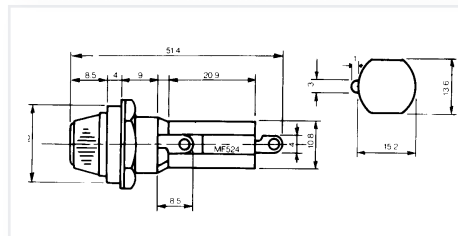

10A 250V AC
6.35 × 31.8mm 6.4 × 30mm
ネジ式 Screw type cap
ハンダ端子 Soldering terminal
フェノール樹脂 Phenolic resin
UL Ⓢ

No. MF-525

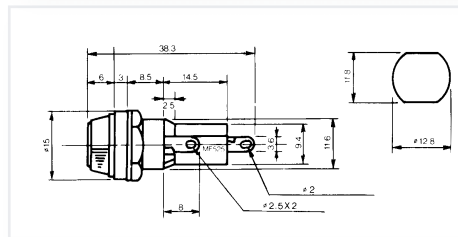

10A 250V AC
5.2 × 20mm
ネジ式 Screw type cap
ハンダ端子 Soldering terminal
フェノール樹脂 Phenolic resin
UL Ⓢ

No. MF-525M

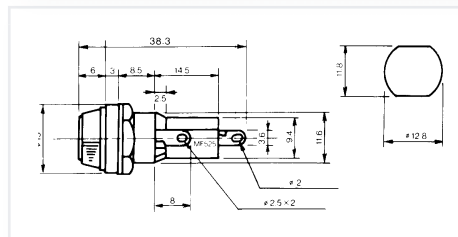

10A 250V AC
5.2 × 20mm
ネジ式 Screw type cap
ハンダ端子 Soldering terminal
フェノール樹脂 Phenolic resin
UL Ⓢ

No. MF-526

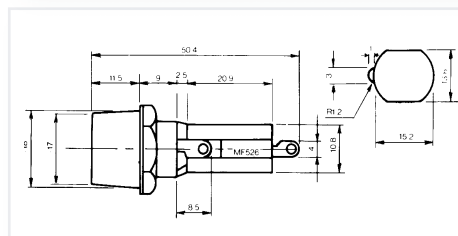

10A 250V AC
6.35 × 31.8mm 6.4 × 30mm
ネジ式 Screw type cap
ハンダ端子 Soldering terminal
フェノール樹脂 Phenolic resin
UL Ⓢ

No. MF-527

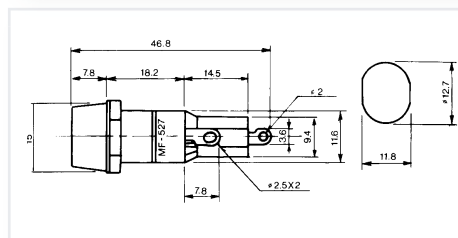

10A 250V AC
5.2 × 20mm
ネジ式 Screw type cap
ハンダ端子 Soldering terminal
フェノール樹脂 Phenolic resin
UL Ⓢ

ヒューズホルダー FUSE HOLDERS

定格	Rating
適合ヒューズ	Matching Fuse
キャップ着脱方式	Cap Release method
端子形状	Terminal type
主絶縁材	Insulation material(Body)
取得規格	Approval

EST バヨネット式ヒューズホルダーの特長

THE FEATURE OF EST MARUSHIN'S BAYONET FUSE HOLDERS

1. セルフリリース(せり上がり)機構 SELF-RELEASE MECHANISM

新開発のセルフリリース機構の採用により、ヒューズ管未装着時に於いてもキャップは回転によりボディから“せり上がり”“来ますので、取り外しが容易に行なえます。

The fuse carrier can be released in either case of with or without fuse by new developed self-release mechanism.

2. セルフロック機構 SELF-LOCK MECHANISM

新開発のセルフロック機構の採用により、ヒューズ管未装着時のキャップの脱落を防止致します。

The fuse carrier to be locked in either case of with or without fuse by new developed self-lock mechanism.

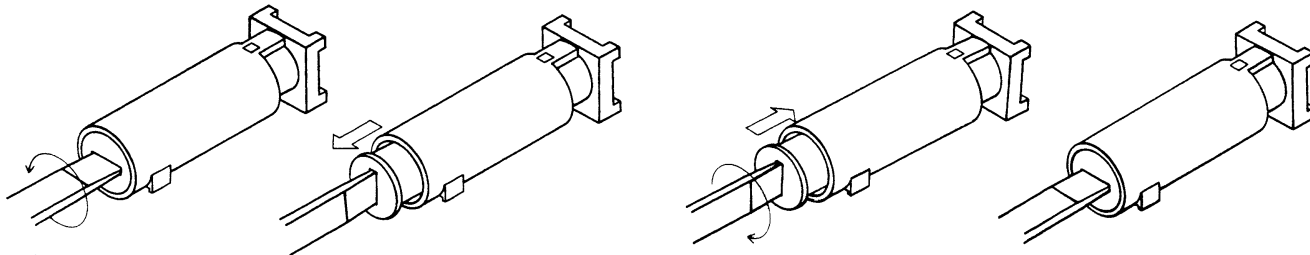

<ご使用上の注意>

バヨネット式は、その構造上、ツマミを押す又は振動により回路の瞬断、接触不良、焼損の原因となる事がありますので、その可能性がある場所、装置へはご使用にならないで下さい。

No. MF-528

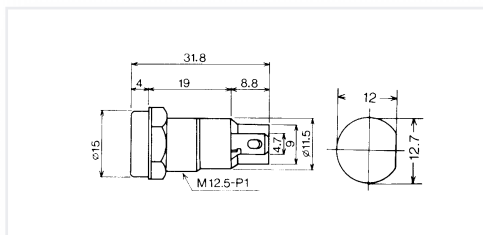

10A 250V AC

5.2 × 20mm

バヨネット式 BAYONET type cap

ファストン端子 187 FASTON 187

P.B.T



No. MF-528H

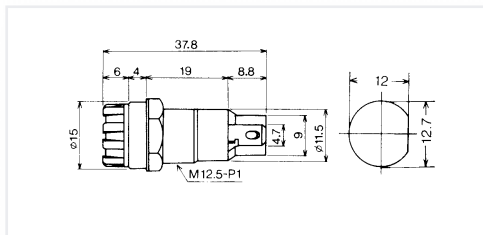

10A 250V AC

5.2 × 20mm

バヨネット式 BAYONET type cap

ファストン端子 187 FASTON 187

P.B.T



No. MF-530

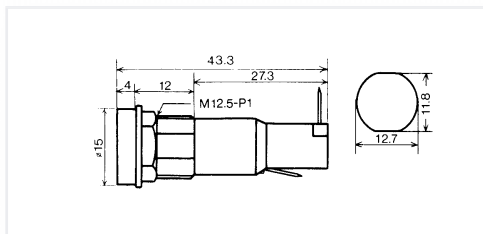

16A 250V AC

15A 250V AC(UL/ファストン結線時 For FASTON)

6.35 × 31.8mm 6.4 × 30mm

バヨネット式 BAYONET type cap

ファストン端子 187 FASTON 187

P.B.T



No. MF-530H

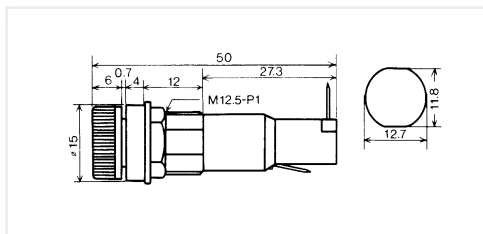

16A 250V AC

15A 250V AC(UL/ファストン結線時 For FASTON)

6.35 × 31.8mm 6.4 × 30mm

バヨネット式 BAYONET type cap

ファストン端子 187 FASTON 187

P.B.T





MARUSHIN

ヒューズホルダー FUSE HOLDERS

定格	Rating
適合ヒューズ	Matching Fuse
キャップ着脱方式	Cap Release method
端子形状	Terminal type
主絶縁材	Insulation material(Body)
取得規格	Approval

No. MF-522

SCREW TYPE FUSE CARRIER WITH THE PROTECTIVE
THREAD FOR CONTACT

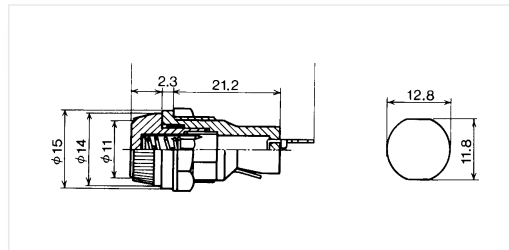

10A 250V AC

5.2 × 20mm

ネジ式

Screw type cap

ハンダ端子

Soldering terminal

P.B.T



No. MF-550 カバーなし WITHOUT COVER

No. MF-550C カバー付 W/COVER

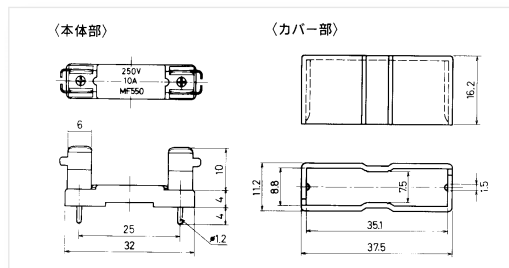

10A 250V AC

6.35 × 31.8mm 6.4 × 30mm

基板用端子

PC board terminal

P.B.T

No. MF-563 基板取付型 PC BOARD MOUNT TYPE

No. MF-563A リード配線型 LERD WIRING TYPE

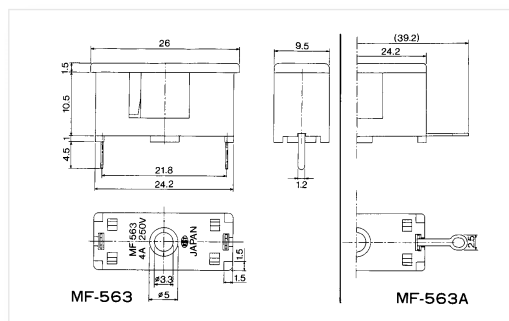

4A 250V AC

5.2 × 20mm

563 : 基板用端子 PC board terminal

563A : ハンダ端子 Soldering terminal

66ナイロン

Polyamide

Marushin electric mfg. co., ltd.



FUSE HOLDERS

No. MF-503

IN-LINE FUSE HOLDER
MATCHING FUSE : 6.35 x 31.8mm
RATING : 3A 250V AC

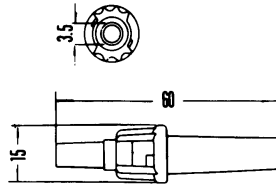

No. MF-506M

IN-LINE FUSE HOLDER
MATCHING FUSE : 6.35 x 31.8mm
RATING : 10A 250V AC

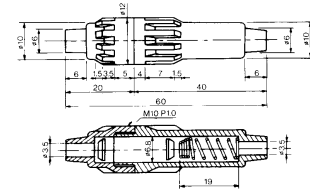

No. MF-503LS

MINIATURE IN-LINE FUSE HOLDER
MATCHING FUSE : 5.2 x 20mm
RATING : 3A 250V AC

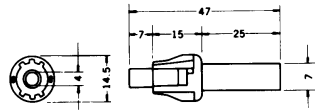

No. MF-507M

IN-LINE FUSE HOLDER
MATCHING FUSE : 5.2 x 20mm
RATING : 10A 250V AC

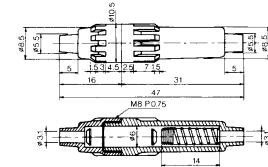

No. MF-505

SINGLE FUSE BASE
MATCHING FUSE : 6.35 x 31.8mm
RATING : 3A 250V AC



No. MF-505LS

MINIATURE SINGLE FUSE BASE
MATCHING FUSE : 5.2 x 20mm
RATING : 3A 250V AC



No. MF-506ML/200

MF-506M w/200mm ROPED CABLE (AWG#20)
MATCHING FUSE : 6.35 x 31.8mm
RATING : 5A 125V AC



No. MF-507ML/200

MF-507M w/200mm ROPED CABLE (AWG#20)
MATCHING FUSE : 5.2 x 20mm
RATING : 3A 125V AC



No. MF-520

IN-LINE FUSE HOLDER
MATCHING FUSE : 6.35 x 31.8mm

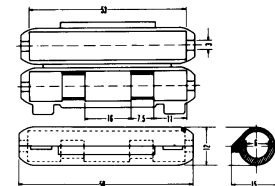
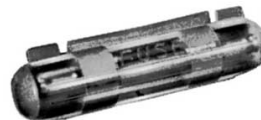



PUSH TERMINALS

No. MT-478E

4P PUSH TERMINAL

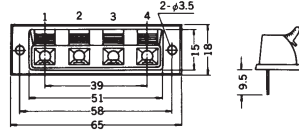
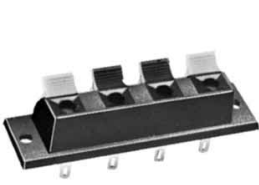

No. MT-476E

2P PUSH TERMINAL

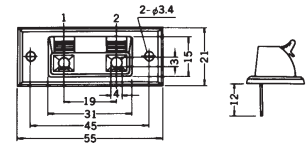

Marushin electric mfg. co., ltd.



BINDING POSTS

No.MT-480

HEAVY DUTY BINDING POST
50A
Color : Black & Red

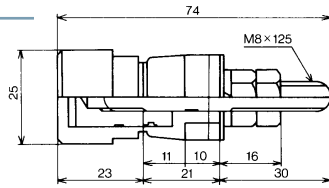

No.MT-487

BINDING POST
15A

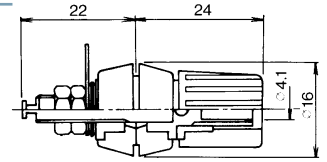

No.MT-481

HEAVY DUTY BINDING POST
50A
Color : Black & Red

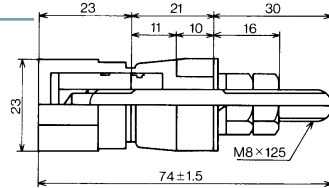

No.MT-491

BINDING POST (NYLON)
15A

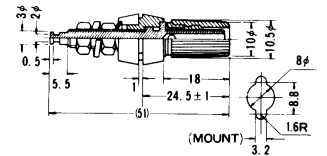

No.MT-482

HEAVY DUTY BINDING POST
50A
Color : Black & Red

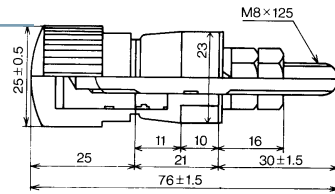

No.MT-490

BINDING POST (NYLON)
10A

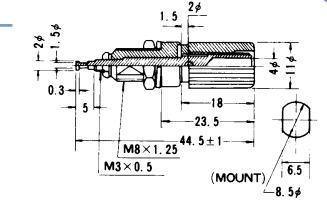

No.MT-483

HEAVY DUTY BINDING POST
30A
Color : Black & Red

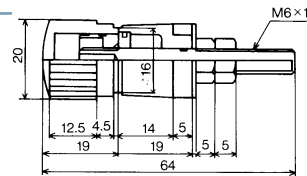

No.MT-488

BINDING POST
15A
Color : Black & Red

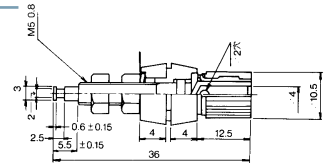

No.MT-484

HEAVY DUTY BINDING POST
30A
Color : Black & Red

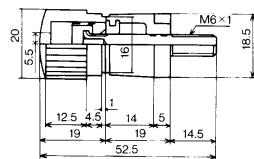

No.MT-489

BINDING POST
15A
Color : Black & Red

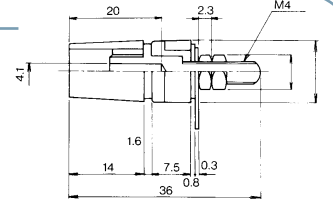

No.MT-486H

BINDING POST
10A
Color : Black & Red

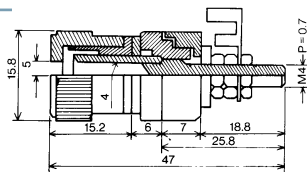

No.MT-902

METAL TYPE BINDING POST
5A

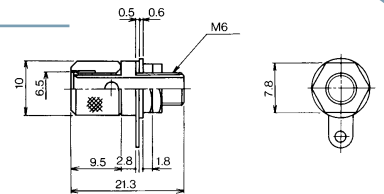

No.MT-406H

ARMY TYPE BINDING POST
10A
Color : Black & Red

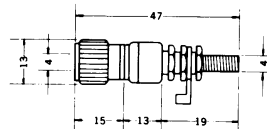

No.MT-903

METAL TYPE BINDING POST
5A

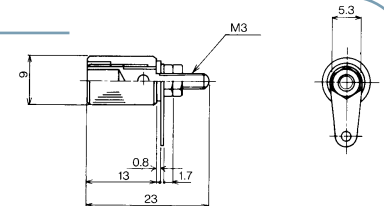

No.MT-404

ARMY TYPE BINDING POST (12mm)
10A
Color : Black & Red

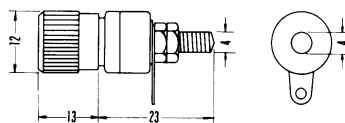

No.MT-405

ARMY TYPE BINDING POST (16mm)
10A
Color : Black & Red

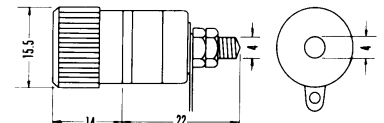



CLIPS, BANANA & TESTER PINS, SOCKETS, LEADS

No. MK-601

ALLIGATOR CLIP w/Molded Handle
Color : Black & Red

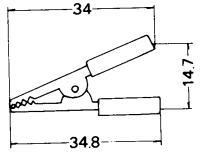

No. MK-603

ALLIGATOR CLIP w/Vinyl Boot
Color : Black & Red

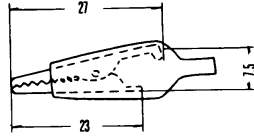

No. MK-604

ALLIGATOR CLIP w/Vinyl Boot
Color : Black & Red

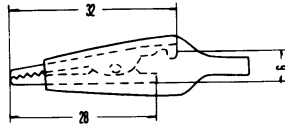

No. MK-605

ALLIGATOR CLIP w/Vinyl Boot
Color : Black & Red

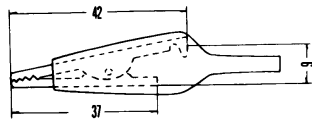

No. MK-612

TEST LEAD SET
Color : Kit of Black, Red, Yellow, Green & White
20 Clips & 10 wirer

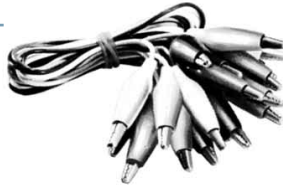

No. MK-608A 50A

No. MK-608B 30A

BATTERY CLIP w/COVERS.

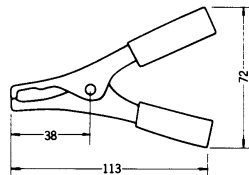

No. MK-609 5A WITHOUT VINYL BOOTS

No. MK-609C 5A W/BOOTS

No. MK-610 10A WITHOUT VINYL BOOTS

No. MK-610C 10A W/BOOTS

No. MK-611 30A WITHOUT VINYL BOOTS

No. MK-611C 30A W/BOOTS

BATTERY CLIP



No. MK-621

BANANA PLUG w/Long Handle
Colors : Black & Red

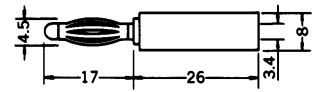

No. MK-624

BANANA PLUG w/Long Handle
Colors : Black & Red

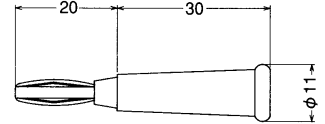

No. MK-621L

BANANA PLUG
Colors : Black & Red

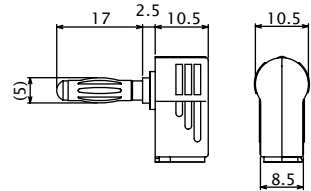

No. MK-628

BANANA JACK
Colors : Black & Red

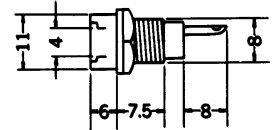

No. MK-626

BANANA JACK
Colors : Black & Red

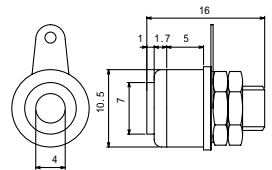

No. MK-632

BANANA PLUG TYPE TEST LEAD SET



No. MK-630

PIN TIP TYPE TEST LEAD SET

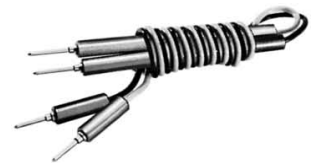

No. MK-616

MICRO TEST PIN TIP PLUG
Colors : Red,Black,Yellow,Green,Blue and White

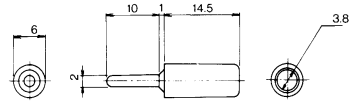

No. MK-617

MICRO TEST PIN TIP SOCKET
Colors : Red,Black,Yellow,Green,Blue and White

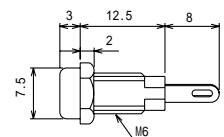



電源スイッチ POWER SWITCHES



製品仕様 Specification

項目	仕様	Items	Specification
定格	MSR5 シリーズ 6A 250V AC MSR8 シリーズ 4A 250V AC 6A 125V AC MSR6 6A 125-250V AC MSR7 10A 250V AC	Rating	MSR5 Serie 6A 250V AC MSR8 Serie 4A 250V AC 6A 125V AC MSR6 6A 125-250V AC MSR7 10A 250V AC
接触抵抗	20m 以下	Contact resistance	20m MAX
絶縁抵抗	DC500V 100M 以上	Insulation resistance	100M MIN
耐電圧	AC2000V 1分間	Withstand voltage	2000V AC for 1 minute
負荷寿命	10,000回	Life	10,000cycles
使用温度範囲	- 25 ~ + 85	Operating temperature	- 25 ~ + 85

取付穴参考寸法 Mounting hole dimension

取付板板厚 Thickness of mounting board	Y	Z
0.75 ~ 1.25	19.2	13.1
1.25 ~ 2.00	19.5	13.1

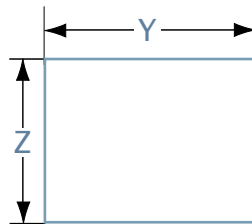

端子形状 Terminal style

ハンダ端子 Soldering terminal	ファストン端子 187 FASTON terminal 187	基板用端子 PC board mount terminal

外形図 Out line drawing

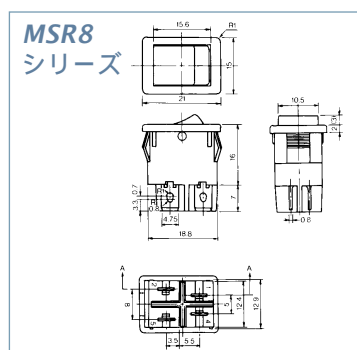
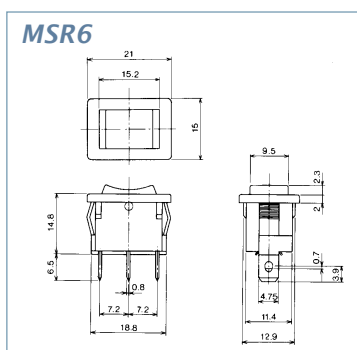
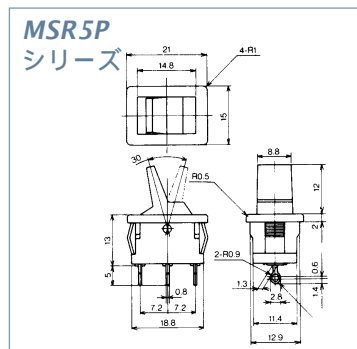
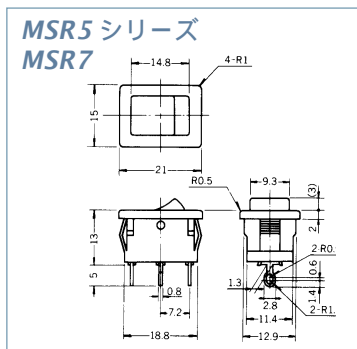

表示バラエティ Marking variety

0		4	
1		5	
2		6	
3		7	

照光式ツマミカラー Knob color for illuminating

MSR8-N 1	RED 250V
MSR8-N 1 / TT	RED 125V
MSR8-N 2	ORANGE 250V
MSR8-N 2 / TT	ORANGE 125V
MSR8-N 3	GREEN 250V
MSR8-N 3 / TT	GREEN 125V



電源スイッチ POWER SWITCHES

製品体系一覽表 Available product line

モデルNo. MODEL No.	ツマミ形状 Knob style	回路構成 Circuit arrangement	動作種類 Operation mode	端子形状 Terminal type	
No.MSR5	ロッカー Rocker	SPST 2P	ON-OFF	ハンダ端子 Soldering	
No.MSR5X	ロッカー Rocker	SPDT 3P	ON-ON	ハンダ端子 Soldering	
No.MSR5-2	ロッカー Rocker	SPST 2P	ON-OFF	ファストン端子 187 FASTON 187	
No.MSR5-2X	ロッカー Rocker	SPDT 3P	ON-ON	ファストン端子 187 FASTON 187	
No.MSR5-4	ロッカー Rocker	SPST 2P	ON-OFF	基板用端子 PC board	
No.MSR5R	ロッカー Rocker	SPST 2P	(ON)-OFF	ハンダ端子 Soldering	モーメンタリー MOMENTARY
No.MSR5XR	ロッカー Rocker	SPDT 3P	(ON)-ON	ハンダ端子 Soldering	モーメンタリー MOMENTARY
No.MSR5-2R	ロッカー Rocker	SPST 2P	(ON)-OFF	ファストン端子 187 FASTON 187	モーメンタリー MOMENTARY
No.MSR5-2XR	ロッカー Rocker	SPDT 3P	(ON)-ON	ファストン端子 187 FASTON 187	モーメンタリー MOMENTARY
No.MSR5-4R	ロッカー Rocker	SPST 2P	(ON)-OFF	基板用端子 PC Board	モーメンタリー MOMENTARY
No.MSR5-P	レバー Lever	SPST 2P	ON-OFF	ハンダ端子 Soldering	
No.MSR5XP	レバー Lever	SPDT 3P	ON-ON	ハンダ端子 Soldering	
No.MSR5-2P	レバー Lever	SPST 2P	ON-OFF	ファストン端子 187 FASTON 187	
No.MSR5-2XP	レバー Lever	SPDT 3P	ON-ON	ファストン端子 187 FASTON 187	
No.MSR5-4P	レバー Lever	SPST 2P	ON-OFF	基板用端子 PC Board	
No.MSR5PR	レバー Lever	SPST 2P	(ON)-OFF	ハンダ端子 Soldering	モーメンタリー MOMENTARY
No.MSR5XPR	レバー Lever	SPDT 3P	(ON)-ON	ハンダ端子 Soldering	モーメンタリー MOMENTARY
No.MSR5-2PR	レバー Lever	SPST 2P	(ON)-OFF	ファストン端子 187 FASTON 187	モーメンタリー MOMENTARY
No.MSR5-2XPR	レバー Lever	SPDT 3P	(ON)-ON	ファストン端子 187 FASTON 187	モーメンタリー MOMENTARY
No.MSR5-4PR	レバー Lever	SPST 2P	(ON)-OFF	基板用端子 PC Board	モーメンタリー MOMENTARY
No.MSR6	ロッカー Rocker	SPDT 3P	ON-OFF-ON	ファストン端子 187 FASTON 187	
No.MSR7	ロッカー Rocker	SPST 2P	ON-OFF	ファストン端子 187 FASTON 187	
No.MSR8	ロッカー Rocker	DPST	ON-OFF	ファストン端子 187 FASTON 187	
No.MSR8-N	ロッカー Rocker	DPST	ON-OFF	ファストン端子 187 FASTON 187	照光式 ILLUMINATING

Marushin electric mfg. co., ltd.



POWER SWITCHES

電源スイッチ POWER SWITCHES

回路構成
動作種類
端子形状

Circuit arrangement
Operation mode
Terminal type

MSR9 SERIES

製品仕様 Specification

項目 Items	仕様 Specification
定格 Rating	3A 125V AC
接触抵抗 Contact resistance	20m MAX
絶縁抵抗 Insulation resistance	100M MIN
耐電圧 Withstand voltage	1,000V AC for 1 minute
負荷寿命 Life	10,000cycles

外形寸法 Outline drawing

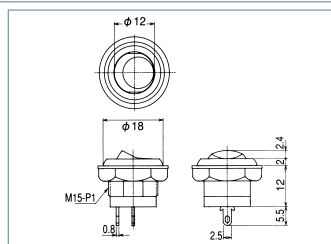

参考取付穴寸法 Mounting hole dimension

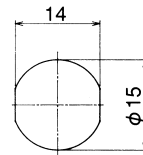

No. MSR9



SPST 2P
ON-OFF
ハンダ端子
Soldering terminal

No. MSR9X



SPDT 3P
ON-ON
ハンダ端子
Soldering terminal

Marushin electric mfg.co.,ltd.



PUSH BUTTON SWITCHES

No. MS-312

BABY PUSH BUTTON SWITCH
(PUSH ON TYPE)

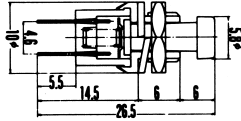

No. MS-313

BABY PUSH BUTTON SWITCH
(PUSH OFF TYPE)

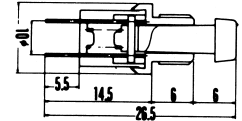

No. MS-350

MINIATURE PUSH BUTTON SWITCH
(PUSH ON TYPE)

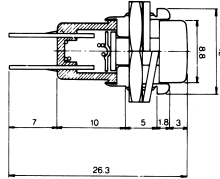

No. MS-351

MINIATURE PUSH BUTTON SWITCH
(PUSH OFF TYPE)

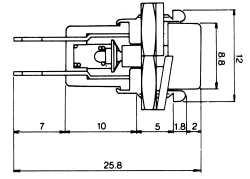

No. MS-350M

MINIATURE PUSH BUTTON SWITCH (PUSH ON TYPE)
ALL PLASTIC HOUSING

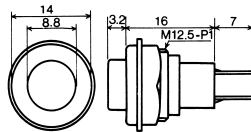

No. MS-351M

MINIATURE PUSH BUTTON SWITCH (PUSH OFF TYPE)
ALL PLASTIC HOUSING

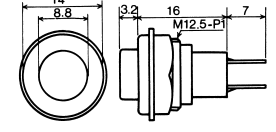

No. MS-356M

PUSH BUTTON SWITCH (PUSH ON TYPE)



Specification

Items	Specification
Circuit arrangement	SPST
Operation mode	OFF-(ON) Momentary
Rating	3A 125V AC
Contact resistance	20m Max
Insulation resistance	100M Min
Withstand voltage	1,000V AC for 1minute

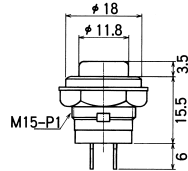

No. MS-357

PUSH BUTTON SWITCH (PUSH ON TYPE)

No. MS-358

PUSH BUTTON SWITCH ALTERNATE
(PUSH ON, PUSH OFF TYPE)



Specification

Items	Specification
Circuit arrangement	SPST
Operation mode	MS-357 OFF-(ON) Momentary MS-358 OFF-ON Alternate
Rating	3A 125V AC
Contact resistance	20m Max
Insulation resistance	100M Min
Withstand voltage	1,000V AC for 1 minute

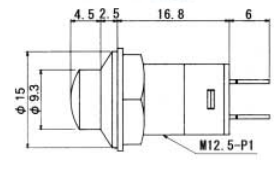

No. MS-300

MINIATURE PUSH BUTTON SWITCH (PUSH ON TYPE)
超小型プッシュスイッチ

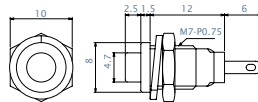

No. MS-400

MINIATURE INLINE PUSH BUTTON SWITCH (PUSH ON TYPE)
超小型手元プッシュスイッチ

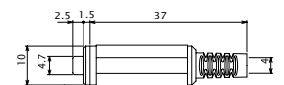

No. MS-311

MINIATURE PUSH BUTTON SWITCH (PUSH ON TYPE)
超小型プッシュスイッチ

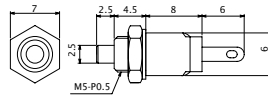

No. MS-370M

PUSH BUTTON SWITCH (PUSH ON TYPE)

No. MS-371M

PUSH BUTTON SWITCH (PUSH OFF TYPE)

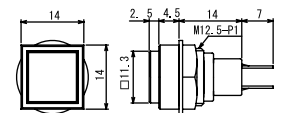

No. MS-327

PUSH BUTTON SWITCH (2P)
(PUSH ON TYPE)
Rating : 125 Volts 3 Amp.

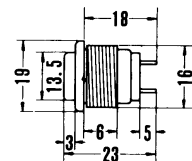



PUSH BUTTON SWITCHES

No. MS-380

PUSH BUTTON SWITCH (PUSH ON TYPE)

No. MS-381

PUSH BUTTON SWITCH (PUSH OFF TYPE)



Body Color : Black
Cap Color : Black / Red

SNAP-IN MOUNT TYPE
スナップインタイプ

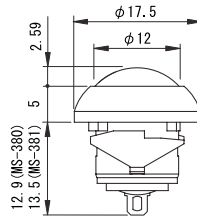

No. MS-384L

PUSH BUTTON SWITCH W/LED
(PUSH ON - PUSH OFF : ALTERNATE TYPE)



ILLUMINATED
照光式

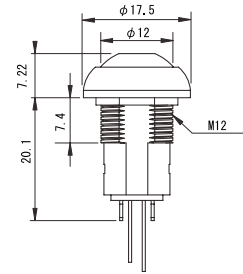

Model No	Body Color	Cap Color	LED Color
MS-384L1#1	Black	Black	Red
MS-384L1#2	Black	Black	Blue
MS-384L1#3	Black	Black	Green
MS-384L0#1	Black	Red	Red
MS-384L0#2	Black	Red	Blue
MS-384L0#3	Black	Red	Green

No. MS-382

PUSH BUTTON SWITCH (PUSH ON TYPE)

No. MS-383

PUSH BUTTON SWITCH (PUSH OFF TYPE)



Body Color : Black
Cap Color : Black / Red

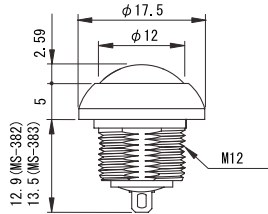

Specifications

Items	Specification
Rating	MS-380 ~ 383 : 125V AC 125mA / 32V AC 400mA / 50V DC 100mA MS-384L : 125V AC 2A / 24V DC 100mA
Contact resistance	50mΩmax
Insulation resistance	1,000 MΩ at 500V DC
Dielectric strength	1,000 V AC for 1 minute
Panel thickness	MS-380 , 381 : t 0.8mm ~ t 1.8mm MS-382 ~ 384L : t 1.5mm ~ t 4.0mm



SLIDE SWITCHES

No. MS-280

3P MINIATURE SLIDE SWITCH
(P 2T)

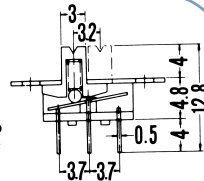
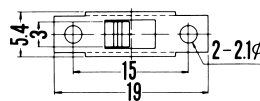

Marushin electric mfg. co., ltd