

- NOTES:
- 1. PARTS TO BE BULK PACKED.
  - 2. SOLDER CONTACTS ARE PRESSED INTO CONNECTOR.  
SIZE 12 CONTACTS AND SIZE 26 CONTACTS (POSITIONS 3, 7, 8) FACE TOP KEY (UP).  
SIZE 26 CONTACTS (POSITIONS 4-6) FACE DOWN.
  - 3. ALL DIMENSIONS ARE FOR REFERENCE ONLY EXCEPT WHERE NOTED WITH TOLERANCE.

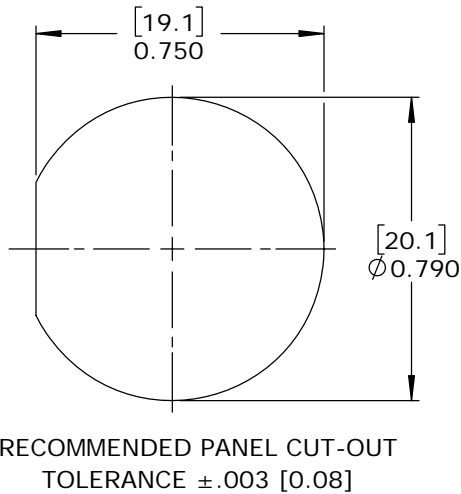
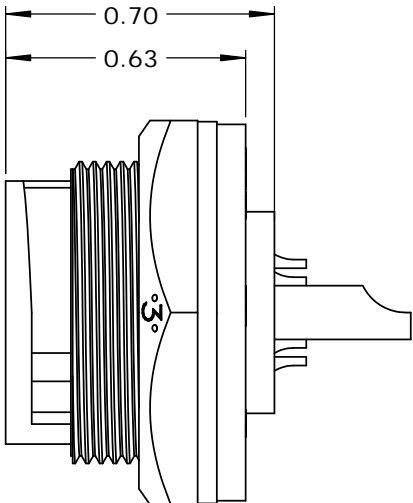
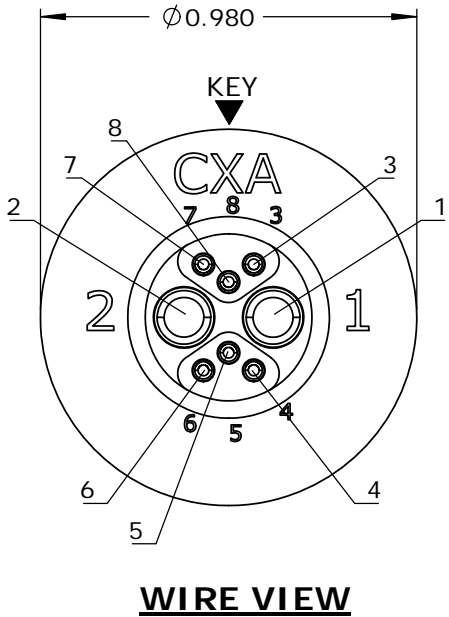
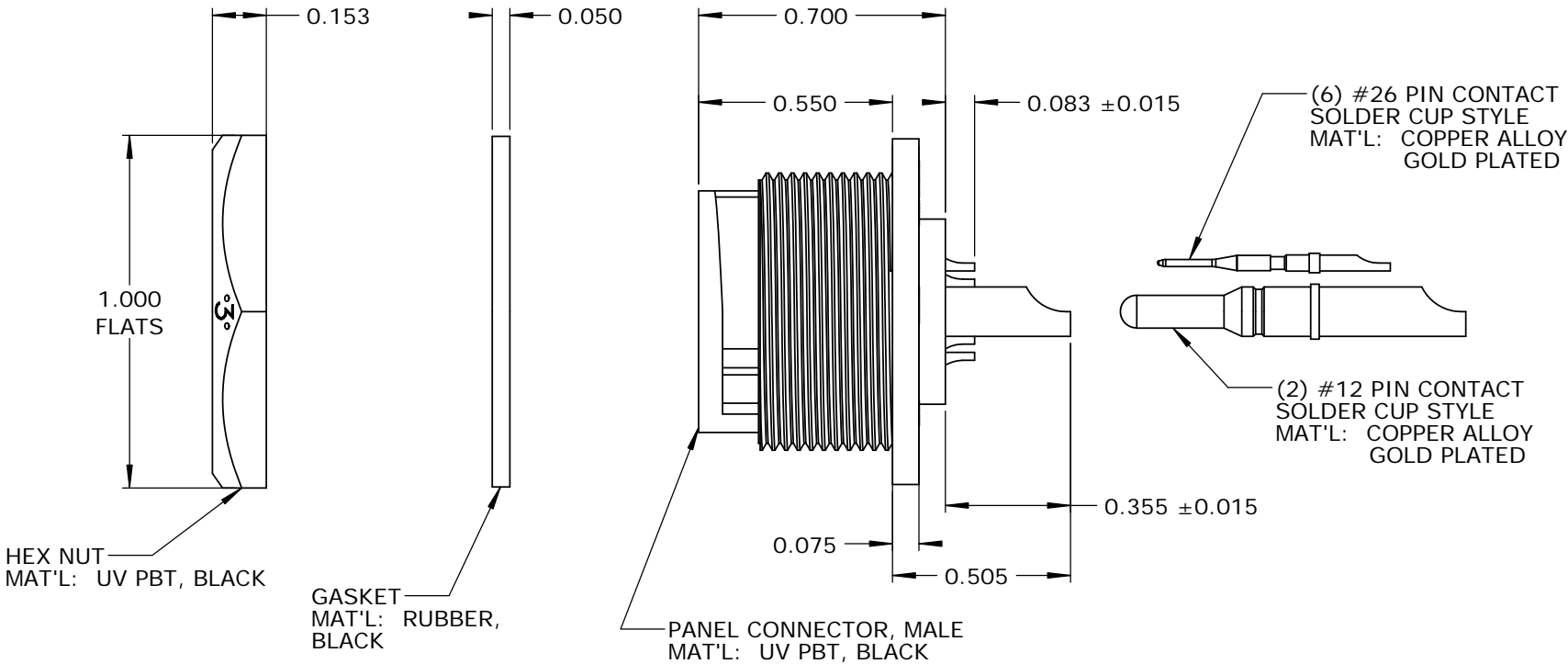
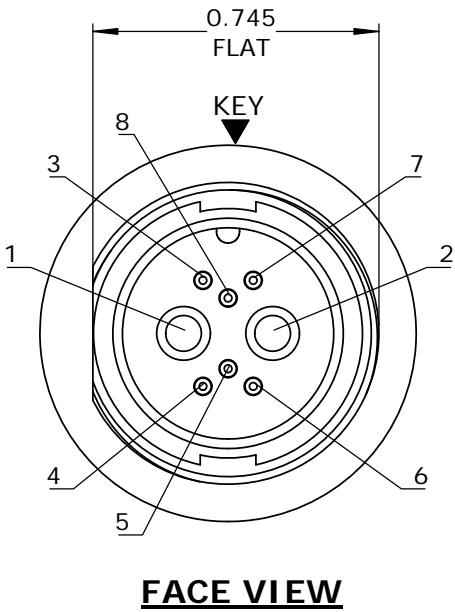
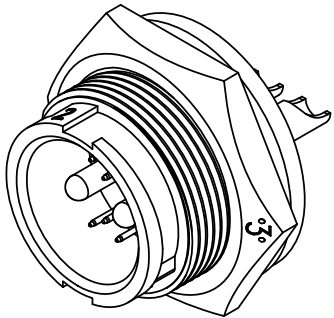

CUSTOMER APPROVAL	
THIS DOCUMENT CONTAINS CONFIDENTIAL INFORMATION PROPRIETARY TO CONXALL CORPORATION. ANY REPRODUCTION, DISCLOSURE, OR USE OF THIS DOCUMENT /INFORMATION IS EXPRESSLY PROHIBITED UNLESS AUTHORIZED IN WRITING BY CONXALL CORPORATION.	
APPROVED BY:	_____
DATE:	_____

RoHS COMPLIANT

A	AB	05-10-19	RELEASE PER DOR 14-6281TC	
REV.	INIT.	DATE	DESCRIPTION	
ALL INFORMATION ILLUSTRATED IS THE PROPERTY OF "CONXALL CORPORATION". UNAUTHORIZED DUPLICATION OR DISTRIBUTION OF THIS DOCUMENT IS PROHIBITED.			ORIG. DRAWN BY: AB	DATE: 07-17-14
			CHECKED BY:	
ALL UNITS ARE IN FEET, INCHES, FRACTION OF INCHES AND DECIMALS.			APPROVED BY:	
			SCALE: NTS	SIZE: B
- CRITICAL CHARACTERISTIC FLAG PER SPEC. XXXX			SHEET: 1 OF 1	
			FILE: SAME AS P/N	DIRECTORY: SLW
TITLE: PANEL CONNECTOR KIT (2) #12 + (6) #26 PIN CONTACTS, SOLDER MULTI-CON-X, WEATHER RESISTANT STANDARD PRODUCT				REV A
CUSTOMER: STANDARD PRODUCT				
PART NUMBER: W4B82-8PG-300				