

FRONT VIEW

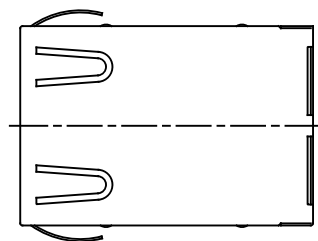

TOP VIEW

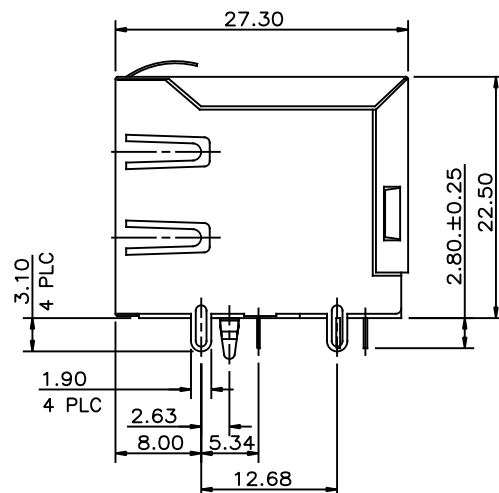

SIDE VIEW

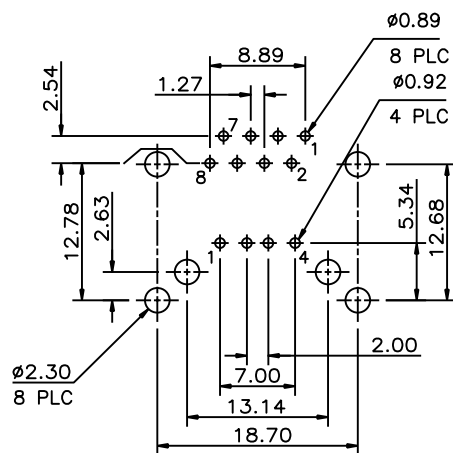

RECOMMENDED P.C.B. LAYOUT
(COMPONENT SIDE OF BOARD)
TOLERANCE: ± 0.05

LOCATE HOLES
 $\phi 0.13 [0.005]$
POSITION DIMENSIONS
ARE BASIC

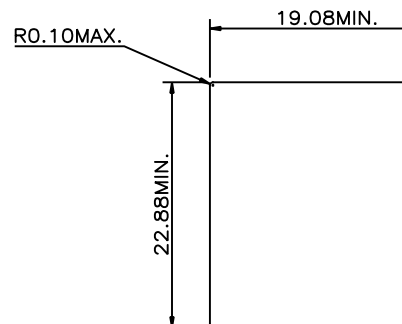

RECOMMENDED PANEL CUTOUT

MATERIALS:

RJ:

HOUSING & COVER: ENGINEERING THERMOPLASTIC
FLAMMABILITY RATING UL 94V-0, COLOUR: BLACK

CONTACTS: PHOSPHOR BRONZE

PLATING: SELECTIVE GOLD PLATING ON MATING SURFACES
SEE AMPHENOL PART NUMBER FOR DETAIL.

50 μ [1.27 MICRONS]

MIN. NICKEL UNDERPLATE

GOLD FLASH ON CONTACT TAILS.

SHIELD: BRASS PLATED WITH NICKEL.

USB:

HOUSING: ENGINEERING THERMOPLASTIC
FLAMMABILITY RATING UL 94V-0,
COLOUR: BLACK

CONTACTS: PHOSPHOR BRONZE

PLATING: SELECTIVE GOLD FLASH ON MATING SURFACES

50 μ [1.27 MICRONS]

MIN. NICKEL UNDERPLATE

100 μ TIN PLATING ON CONTACT TAILS

SHIELD: BRASS PLATED WITH NICKEL.

RECOMMEND SOLDER PROCESS

WAVE SOLDER ,PEAK TEMPERATURE 260° FOR 5~8 SECOND

AMPHENOL PARTNUMBER: RJE36-188-3X03

GOLD PLATING

0 = GOLD FLASH

1 = 6 μ INCH

2 = 15 μ INCH

3 = 30 μ INCH

4 = 50 μ INCH

UNLESS SPECIFIED OTHERWISE	DRAWN STEVE.X	DATE JUL 15/21
PRIMARY UNITS MILLIMETER	CHECKED KELVIN.T	JUL 15/21
SECONDARY	M.E. APP'D	
REFERENCE IN PARENTHESES	Q.A. APP'D	
GENERAL TOLERANCES	DWG APPR. L.CHAN	JUL 15/21
1 DECIMAL PLACE ± 0.30	ENG. REL. NO.	
2 DECIMAL PLACES ± 0.25	REF.	
3 DECIMAL PLACES ± 0.20	THIRD ANGLE PROJECTION	DO NOT SCALE DRAWING
ANGULAR DEGREES $\pm 1.0^\circ$		

Amphenol Canada Corp.			
Commercial Products			
TITLE		RJ45 OVER SINGLE USB 2.0 COMBO, DIP TYPE	
		WITH TABS -RoHS COMPLIANT	
DWG. NO.		P-RJE36-188-3X03	
CODE ID NO. 03554		DWG SIZE: C	SCALE: N/A
SHEET 1		OF 1	