

HALOGEN FREE

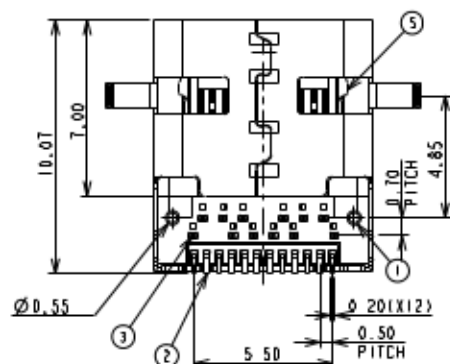
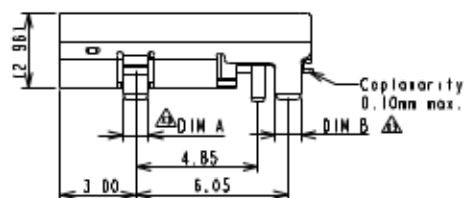
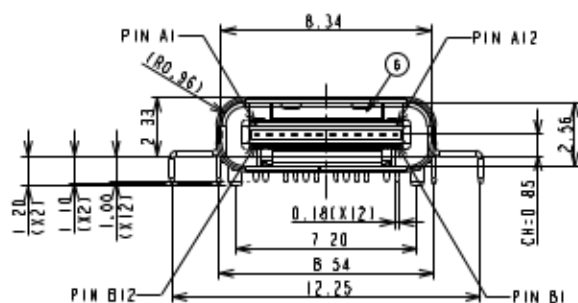
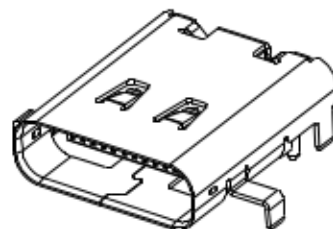
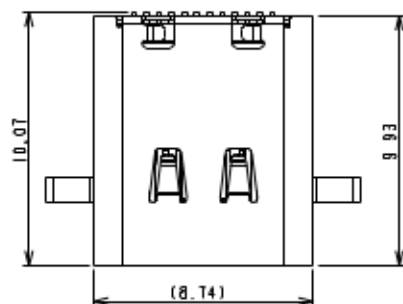

TABLE B: PIN ASSIGNMENT

PIN NO.	A1	A2	A3	A4	A5	A6	A7	A8	A9	A10	A11	A12
SIGNAL NAME	GND	SSTXp1	SSTXn1	VBUS	CC1	Dp1	Dn1	SBU1	VBUS	SSRXn2	SSRXp2	GND
PIN NO.	B12	B11	B10	B9	B8	B7	B6	B5	B4	B3	B2	B1
SIGNAL NAME	GND	SSRXp1	SSRXn1	VBUS	SBU2	Dn1	Dp1	CC2	VBUS	SSTXn2	SSTXp2	GND

REV.	ECN	DESCRIPTION	DATE	DRAWN	CHECKED	APPROVED
X5	SZECR14228-04	AX3, AX1, WX1, DX1	04/21/15	XD	ROGER	ROGER
X6	SZECR14228-05	AX1, WX1	09/10/15	Rbl, 3a	Alan.Tsai	

TABLE A: PRODUCT NUMBERING CODE

C-AR20-A K 5 1 X  
① ② ③ ④ ⑤ ⑥

1 CONNECTOR TYPE:  
AR20: USB TYPE-C RECP R/A CONN

2 NO. OF POSITION:  
A: 24 POSITIONS.

3 COLOR OF INSULATOR:  
K: BLACK.

4 PLATING OF CONTACT:  
1: GOLD FLASH ON CONTACT AREA.  
5 Au 30u" PLATING ON CONTACT AREA

5 PLATING OF FRONT SHELL  
1: SOLDERING NICKEL

6 SHELL TYPE & PACKAGE:  
0: SEE TABLE C & TAPE REEL  
1: SEE TABLE C & TAPE REEL

TABLE C: SHELL TYPE

PRODUCT NUMBERING	DIM A	DIM B	DIM C	DIM D
C-AR20-AK510	1.00	1.00	1.40 ± 0.05	1.80 <sup>+0.10</sup> <sub>-0</sub>
C-AR20-AK511	1.30	1.30	1.70 ± 0.05	2.10 <sup>+0.10</sup> <sub>-0</sub>

8	EMI RING	2	H- AR20-EOXXX	METAL / Ni PLATED
5	GROUND PLATE	1	H- AR20-BOXXX	METAL / Ni PLATED
4	SHELL	1	S- AR20-10XXX	METAL / Ni PLATED
3	DOWN-CONTACT	12	T- AR20-DOXXX	COPPER ALLOY / Au PLATED
2	UP-CONTACT	12	T- AR20-UOXXX	COPPER ALLOY / Au PLATED
1	HALF PRODUCT	2	AR20-ANXXXX	HI-TEMP. G.F. UL94V-0

ITEM	NAME	Q'TY	PART #	MATERIAL / FINISH
1	GENERAL R.	23	AVEN	DT/23/14
2	DESIGN	23	AVEN	DT/23/14
3	CHECKED	23	ROGER	DT/23/14
4	APPROVED	23	ROGER	DT/23/14
5	SCALE	5	1	
6	SHEET	1	OF 2	
7	UNIT	MM		
8	C-AR20-AK510			

CnC Tech, LLC

USB 2.0 TYPE-C CONN.  
RECEPTACLE - MID MOUNT TYPE

SERIES	AR20 SERIES	SIZE	A3
ONE NO	C- AR20-00-00	REV.	X6

