

REVISIONS

P	LTR	DESCRIPTION	DATE	DWN	APVD
	R5	REVISED PER ECR-25-242924	04AUG2025	SA	DSC

AMP WIRE RANGE	Listed	LR7189 Certified
22-16 AWG SOLID OR STRANDED	22-16 AWG SOLID OR STRANDED	22-16 AWG SOLID OR STRANDED

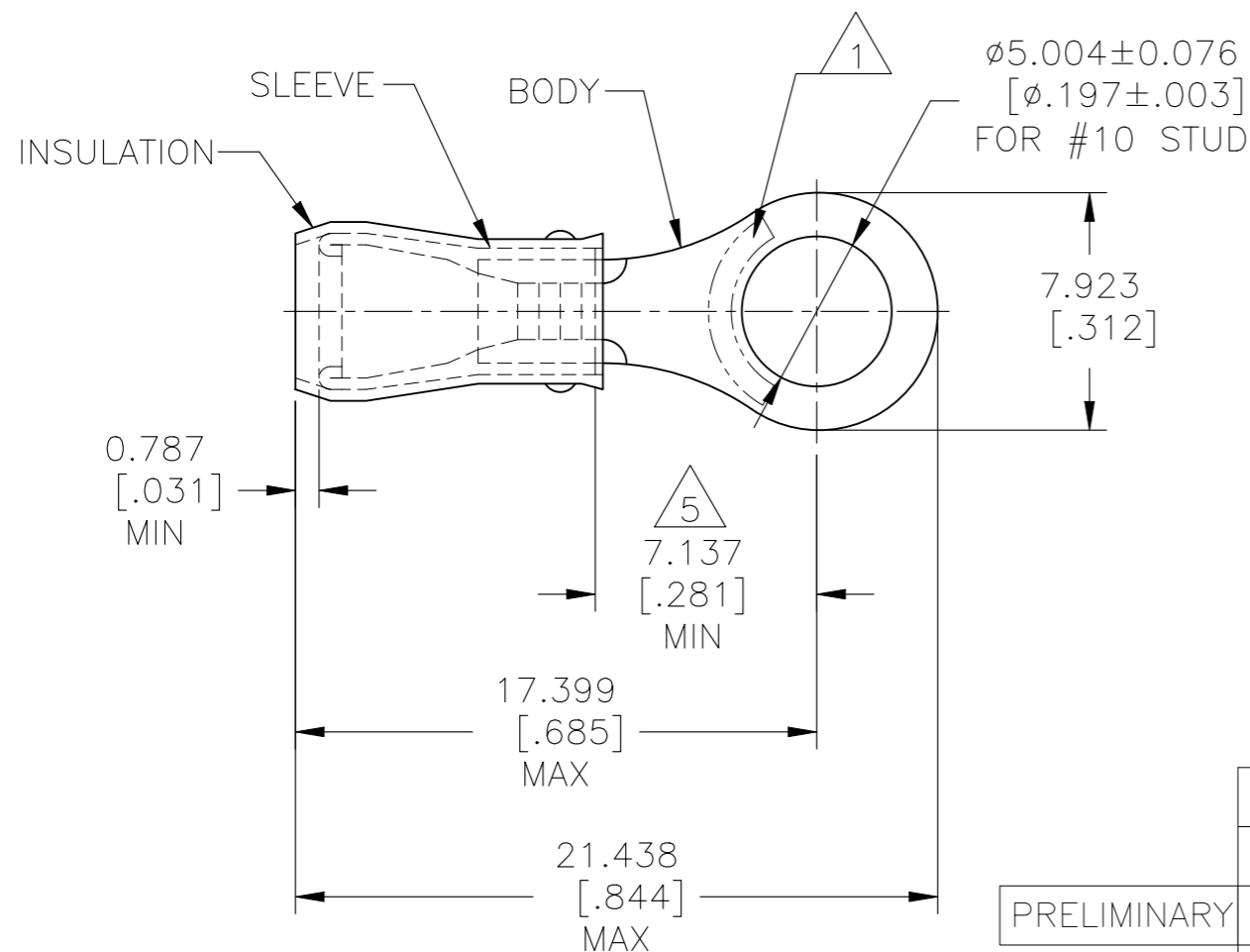

- 1 STAMP AMP 22-18* APPROX AS SHOWN
22-16 TERMINALS ARE STAMPED 22-18 IN
ACCORDANCE WITH MILITARY SPEC SAE AS7928
COMMERCIAL WIRE RANGE IS 22-16
- 2 WIRE INSUL, $\phi 2.667-3.556$ [$\phi 0.105-.140$]
- 3 BODY MATERIAL THK, 0.787 ± 0.051 [0.031 ± 0.002]
- 4 NOTE DELETED.
- 5 APPLIES FROM CENTER OF STUD HOLE
TO EDGE OF METAL WIRE BARREL.

PRELIMINARY

MILITARY P/N AND CLASS	QUANTITY	PACKAGE TYPE	PART NO
-	50	LOOSE PIECE, BAG	8-36154-5
-	100	LOOSE PIECE, BOX	8-36154-1
-	1 KIT = 250 PIECES	LOOSE PIECE	6-36154-0
-	5000	ON TAPE, REEL	2-36154-2
MS 25036-103 CLASS 1	1000	LOOSE PIECE	36154

AMP INCORPORATED
CUSTOMER SERVICE SYSTEMS

MAX RECOMMENDED OPERATING TEMPERATURE:
105°C [221°F]

VOLTAGE RATING:
300 V MAX

WIRE CROSS SECTIONAL AREA RANGE:
0.26-1.65mm² [509-3,260] CIR MILS
SOLID OR STRANDED

THIS DRAWING IS A CONTROLLED DOCUMENT.

DIMENSIONS:
mm [INCHES]

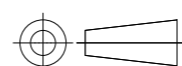

TOLERANCES UNLESS OTHERWISE SPECIFIED:

0 PLC	± -
1 PLC	± -
2 PLC	± -
3 PLC	± 0.127[.005]
4 PLC	± -
ANGLES	± -

MATERIAL BODY & SLEEVE:
COPPER ASTM B-152
INSULATION: NYLON PER
D4066

FINISH BODY & SLEEVE:
TIN PLATE
PER ASTM B 545
INSULATION: RED

DWN DK SCHRUM 02/16/93
CHK RE HERSEY 4/28/93
APVD ML ELLIS 4/28/93
PRODUCT SPEC
UL 486 A-B
APPLICATION SPEC
114-2157
WEIGHT -



NAME
TERMINAL, RING TONGUE,
PIDG™, WIRE SIZE : 22-16 AWG

SIZE	CAGE CODE	DRAWING NO	RESTRICTED TO
A3	00779	C-36154	-

FOR ADDITIONAL PRODUCT INFORMATION OR COPIES OF DRAWINGS AND TECHNICAL DOCUMENTS	PRODUCT INFORMATION CENTER 1-800-522-6752
FOR APPLICATION TOOLING INFORMATION	TOOLING ASSISTANCE CENTER 1-800-722-1111
FOR ORDER ENTRY	1-800-526-5142

CUSTOMER DRAWING SCALE 4:1 SHEET 1 OF 1 REV R5