

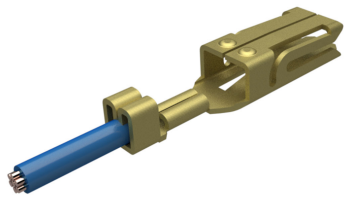

Part Number : [945180101](#)
Product Description : High Normal Force
Tabs, Tin Plated Brass, 20-18 AWG
Series Number : 94518
Status : Active
Product Category : Crimp Terminals



Documents & Resources

Drawings
[945180101_sd.pdf](#)
[945180001-PK-000.pdf](#)

Product Environment Compliance

Compliance

GADSL/IMDS	Not Relevant
China RoHS	
EU ELV	Compliant per 2000/53/EC
Low-Halogen Status	Low-Halogen per IEC 61249-2-21
REACH SVHC	Not Contained per D(2024)6225-DC (07 Nov 2024)
EU RoHS	Compliant per EU 2015/863

Multiple Part Product Compliance Statements

- Eu RoHS
- REACH SVHC
- Low-Halogen

Multiple Part Industry Compliance Documents

- IPC 1752A Class C
- IPC 1752A Class D
- Molex Product Compliance Declaration
- IEC-62474
- chemSHERPA (xml)

EU RoHS Certificate of Compliance

Part Details

General

Status	Active
Category	Crimp Terminals
Series	94518
Description	High Normal Force Tabs, Tin Plated Brass, 20-18 AWG
Application	Power, Wire-to-Board
Product Name	High Normal Force (HNF) Termin
UPC	800754333351

Physical

Gender	Female
Material - Metal	Brass
Material - Plating Mating	Tin
Material - Plating Termination	Tin
Net Weight	0.645/g
Packaging Type	Reel
Plating min - Mating	2.540µm
Plating min - Termination	2.540µm
Wire Insulation Diameter	2.20-2.80mm
Wire Size (AWG)	18, 20
Wire Size mm ²	0.50-1.00

Solder Process Data

Lead-Free Process Capability	N/A
------------------------------	-----

Application Tooling

Global

Description	Part Number
Extraction and Activation Tool	<u>638132700</u>
Hand Tool for RAST5 Normal Force Female Crimp Terminals	<u>638253500</u>
FineAdjust Applicator for RAST5 Normal Force Female Crimp Terminal	<u>639019700</u>

This document was generated on Mar 02, 2025