



1

2

3

4

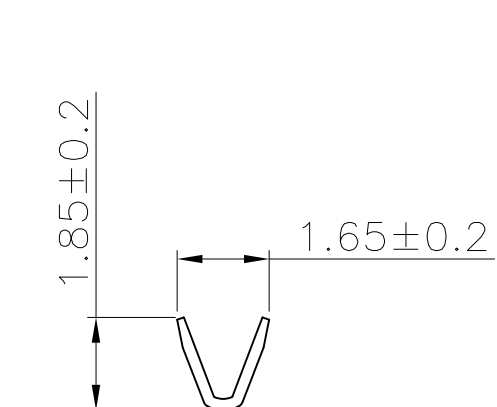

A-A
SCALE 2:1

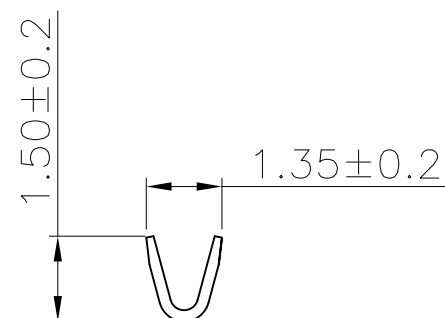

B-B
SCALE 2:1

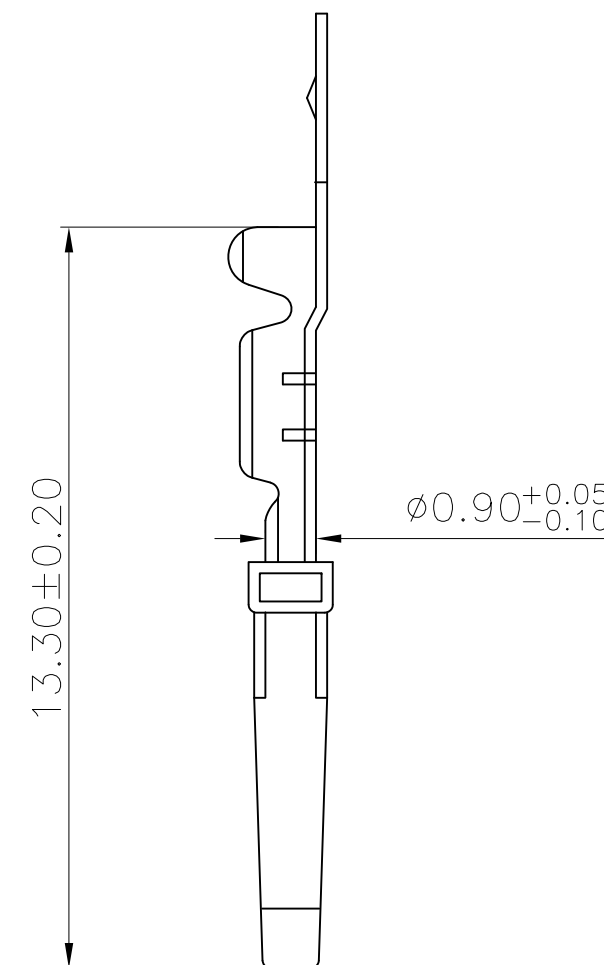
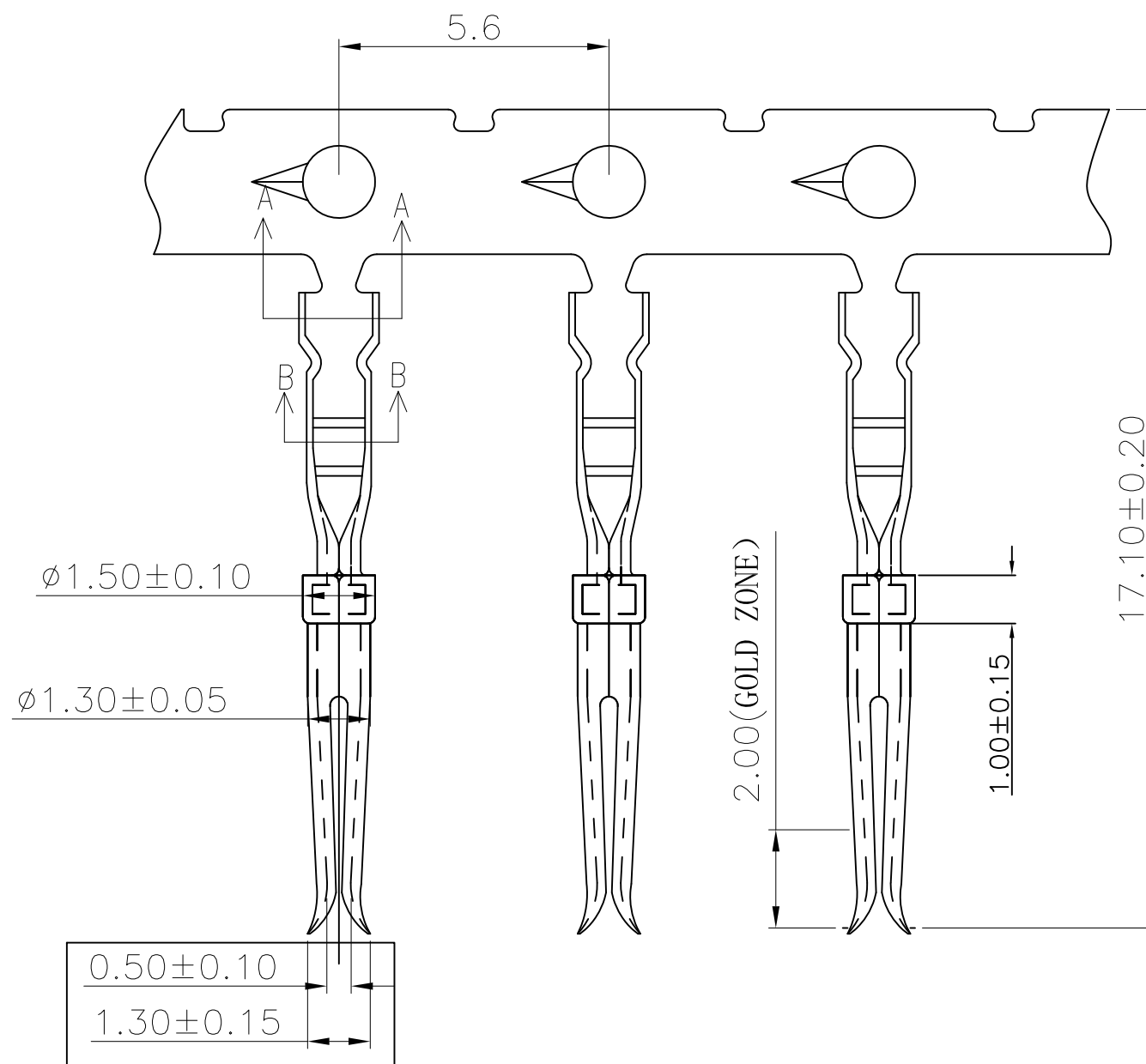

REMARK:

1. MATERIALS:

CONTACTS: COPPER ALLOY T=0.20mm, GOLD(G\F) TOP OVER
CONTACT AREA, 50u" Min. NICKEL UNDER PLATE.

2. PART NUMBER DESCRIPTION: 10090933-S XX X X LF

SERIES NO. _____ LF: ROHS COMPLIANT
TYPE _____ PACKAGING
S: SOCKET (FEMALE) 9: REEL, 15K PCS
GAUGE SIZE _____ CONTACT FINISH
22: 22(AWG) 4: GOLD FLASH

mat'l. code				surface	tolerance	projection	SIZE	PART NO.	PACKAGING
				ISO 1302	ISO 406 / ISO 1101		22AWG	10090933-S2249LF	REEL, 15KPCS
				tolerances unless otherwise specified			product family		
				angles	linear	mm	D-SUB		
A	T09-1157	J.H	2009-12-10		.0±0.38		title		
B	T10-0164	J.H	2010-10-19		.00±0.25		H/D D-SUB CRIMPING FEMALE CONTACT		
C	ELX-I-31477	AR	2018-10-16	0°±2°	.000±0.10	scale 1:1			
				dr	JASON HSU	2009-12-10	Amphenol FCi	dwg no	sheet 1 of 1
				engr	JASON HSU	2009-12-10		10090933	size
				chr	MITHUN PAUL	2018-10-16			A4
				appd	BKP	2018-10-16		type	Product Customer Drawing
sheet	revision	c							
index	sheet	1							

1

2

3

4