

REVISIONS					
REV	ECO	DESCRIPTION	DATE	BY	APPR
A3	-	RELEASE NEW DWG FORMAT	08JAN14	JARRY	
A4	-	REVISE DIME NSION, 31.7 WAS 31.3	11SEP20	KEVIN	TOMMY
A5	-	ADDED MORE MATERIAL TO NOTES	3MAR25	RO	RO
A6	-	ADDED IP RATING IP69K	10OCT2025	JHEAD	DH

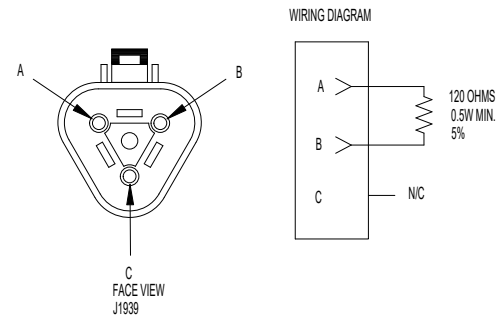
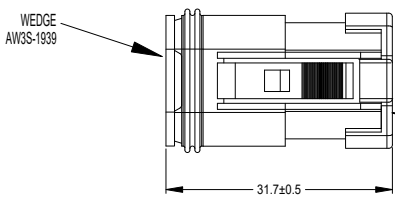
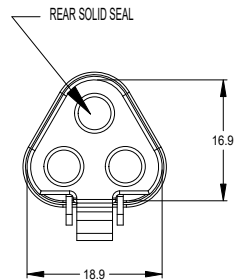
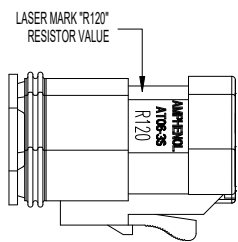
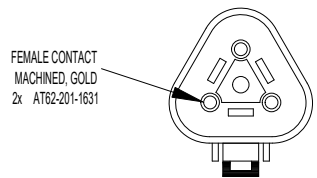
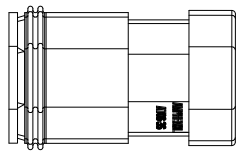

NOTES: UNLESS OTHERWISE SPECIFIED

- MATERIAL:  
HOUSING, END CAP & WEDGELOCK: THERMOPLASTIC  
SEAL: SILICONE RUBBER  
CONTACTS: COPPER ALLOY
- MODIFICATIONS: N/A
- SPECIFICATIONS:
  - CURRENT RATING: 13 AMPS
  - OPERATING TEMPERATURE: -55°C TO +125°C
  - DIELECTRIC WITHSTANDING VOLTAGE: LESS THAN 2 MILLIAMPS CURRENT LEAKAGE @ 1500 VOLTS AC.
  - INSULATION RESISTANCE: 1000 MEGOHMS MIN @ 25°C.
  - MOISTURE RESISTANCE:  
IP68 (1M OF WATER FOR A PERIOD OF 24 HOURS, MATED CONDITION)  
IP69K (MATED CONDITION)
  - MATING CYCLE DURABILITY: 100 CYCLES
  - RoHS COMPLIANT
- MATING PART: AT04-3P\* RECEPTACLE  
(\* = MODIFICATIONS AND COLORS)
- ALL DIMENSIONS ARE FOR REFERENCE USE ONLY.
- CONTACT SIZE: 16

PART NUMBER CHART	
COLOR	PART NUMBER
GREY	AT06-3S-RJ120
BLACK	AT06-3S-RJ120BK

SEE CHART		PART NUMBER		DESCRIPTION		ITEM
<b>QUANTITY</b>						
<b>MATERIALS LIST</b>						
UNLESS OTHERWISE SPECIFIED:		SIGNATURES		DATE		<p>Sine Systems - www.amphenol-sine.com 44724 Morley Drive Clinton Township, MI 48036</p>
1) All dimensions are in metric (mm).		DRAWN: KEVIN		11SEP20		
2) Tolerances are as follows:		CHECKED: ORION		11SEP20		
1 PL DEC ±0.30		ENGINEER:				
2 PL DEC ±0.15		APPROVAL: TOMMY		11SEP20		
3 PL DEC ±0.08		CUSTOMER:				
3) Note reference =		THIS DRAWING IS SUPPLIED FOR INFORMATION ONLY. DESIGN FEATURES, SPECIFICATIONS AND PERFORMANCE DATA SHOWN HEREON ARE THE PROPERTY OF THE AMPHENOL CORPORATION. NO RIGHTS OF REPRODUCTION ARE IMPLIED. ALL DIMENSIONS ARE SUBJECT TO NORMAL MANUFACTURING VARIATIONS.				
MATERIAL SPECIFICATIONS:		PROCESS SPECIFICATIONS:		NEXT ASSY:		SIZE: <b>B</b> TYPE: <b>C-</b> SCALE: <b>NONE</b>
				DWG NO: <b>AT06-3S-RJ120XX</b>		REVISION: <b>A6</b> SHEET <b>1</b> OF <b>1</b>

TITLE: PLUG, 3WAY, J1939, 120 OHM  
 DWG NO: AT06-3S-RJ120XX  
 REV: A6  
 SH: 1  
 OF: 1