

PART NUMBER
10118242-0X1RLF

PART NO. DESCRIPTION:

10118242-0XXXLF

LEAD FREE
PACKING TYPE
R: TAPE & REEL
CONTACT AREA PLATING
1: Au 15u"
2: Au 30u"
COLOR OPTION
0: BLACK
1: NATURAL

NOTES:

1. MATERIAL:

HOUSING: LCP+30%GF ,UL94 V-0,BLACK OR NATURAL

TERMINAL: COPPER ALLOY.

SHELL: STAINLESS STEEL

2. FINISH:

CONTACT AREA: GOLD PLATED

SOLDER AREA: GOLD FLASH PLATED

SHELL: TIN PLATED

NICKEL PLATED UNDER OVER ALL

3. PRODUCT SPECIFICATION: GS-12-0983.

4. PACKAGING SPECIFICATION: GS-14-2164.

5. THE PRODUCT MEETS EUROPEAN UNION DIRECTIVES AND OTHER COUNTRY REGULATIONS AS DESCRIBED IN GS-22-008,

6 THE CONNECTOR CAN WITHSTAND EXPOSURE TO 260 DEGREE PEAK TEMPERATURE FOR 10 SECONDS IN IR REFLOW OVEN.

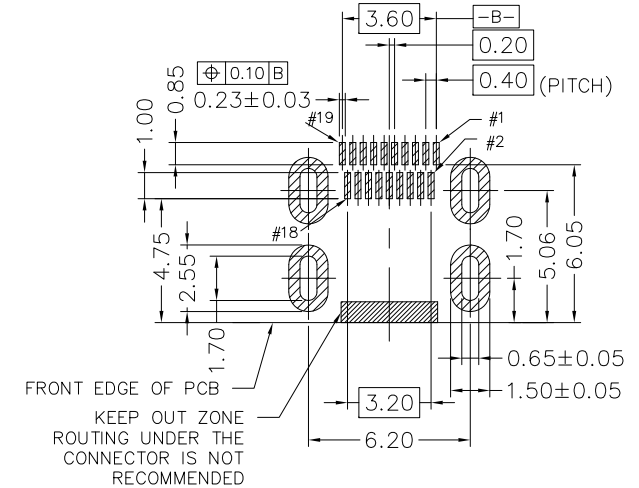
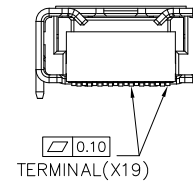
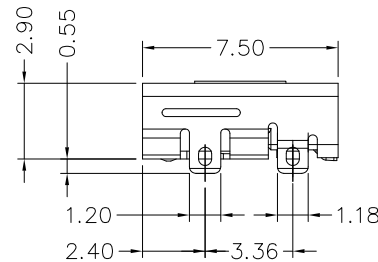
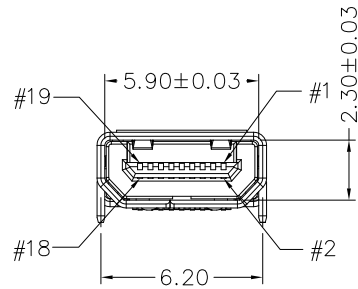
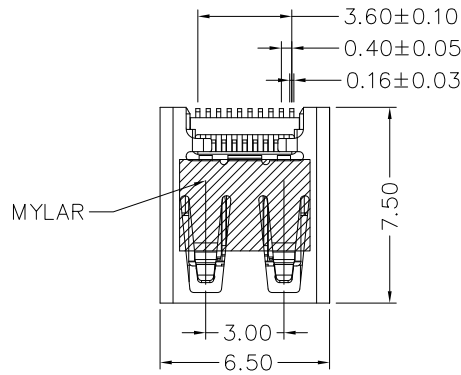

RECOMMENDED PCB LAYOUT (.XX±0.05)
CONNECTOR SIDE (TOP VIEW)

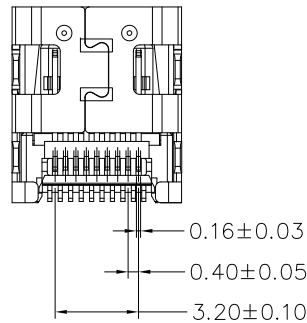

mat'l. code				surface		tolerance	projection	product family		
HPL528				ISO 1302		ASME Y14.5		HDMI		
ltr	ecr	no	dr	date	tolerances	unless	otherwise	specified	title	
A			LS	09/13/11	angles				HDMI TYPE D RECEPTACLE	
B	ELX-N-012816	ZK		09/07/12	linear					
C	ELX-N-16428	HENRY		12/04/13	±1'					
D	ELX-N-24781	TONY		08/23/16	dr	LEIF_SHEN	09/13/11		10118242	
E	ELX-N-25475	TONY		11/25/16	engr	LEIF_SHEN	09/13/11			
F	ELX-N-25898	TONY		01/12/17	chr	GARY_HSIEH	09/13/11			
					appd	GARY_HSIEH	09/13/11		CUSTOMER Drawing	
sheet	revision	F								
index	sheet	1								