

SHELL	A±0.38	B±0.12	C±0.10	D±0.25	E±0.07	PART NUMBER
09	30.81	24.99	16.96	16.21	10.96	D09S91C.PX3FLF
15	39.14	33.32	25.18	24.54	19.18	D15S91C.PX3FLF
25	53.03	47.04	39.12	38.25	33.12	D25S91C.PX3FLF
37	69.32	63.50	55.68	54.71	49.68	D37S91C.PX3FLF

Protection: 4 --> Flash Au
6 --> 0.76 μ Au

PC card drilling dimensions(after plating)
(thickness ≤ 3.20±0.30mm)

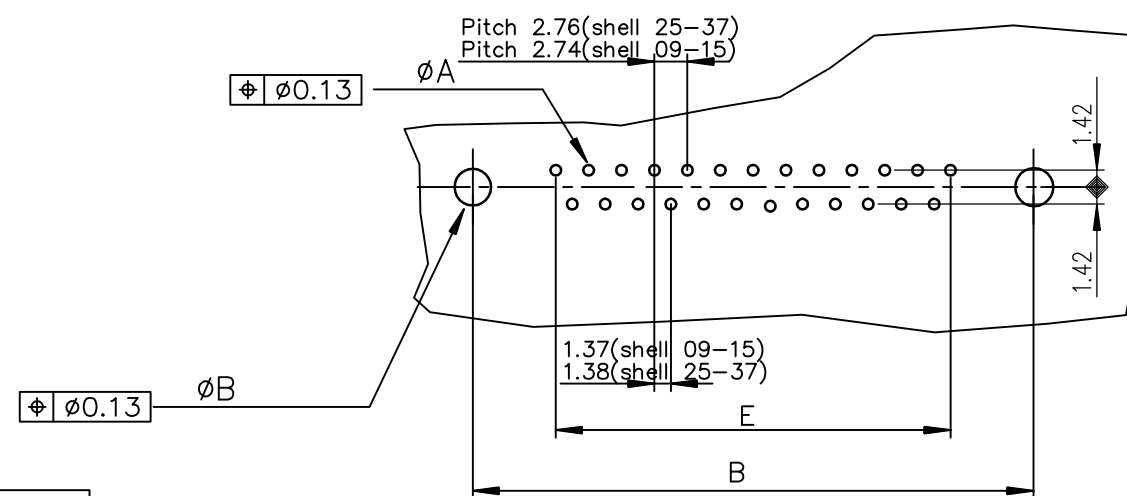

Notes:
1) The nut can protrude above the surface of insulator but maintaining the footprint dimension 6.0±0.15 mm.

NOTE 1

MATERIAL and PLATINGS

Contacts: GXT/gold over nickel on active area
mat pure tin over nickel on termination
Shells: steel,nickel 2 to 9 μ over copper 3 to 5 μ plating
Nuts: steel,nickel 2 to 4 μ plating
Grounding device: brass, 1 μ min nickel

NOTE 2

For other general characterisitics,except chacteristics in note 1
see drawing C01-8646-0001

mat'l. code				surface	tolerance	projection	product family			
-				ISO 1302	ISO 406 ISO 1101	MM	D-SUB			
ltr	ecn no	dr	date	tolerances unless otherwise specified		MM	title			
D	ELX-I-22878	AB	2015/01/06	angles	linear					
				0°±2'	.0±0.1 .00±0.1 .000±0.1	scale 2:1	FEMALE DELTA-D EUROPE			
				dr	M.PESSON 2008/09/29	FCI	RA PRESS FIT			
				engr	ALIAS BABU 2015/01/06		dwg no			
				chr	MITHUN PAUL 2015/01/06		sheet 1 of 1			
				app	BIJU K PAUL 2015/01/06		size			
sheet index	revision	D					C-8646-0913			
	sheet	1					A3			
							type Product Customer Drawing			