

Housing - HC-B 6-TFL-H-O1PG29S



1460024

<https://www.phoenixcontact.com/us/products/1460024>

Please be informed that the data shown in this PDF document is generated from our Online Catalog. Please find the complete data in the user documentation. Our General Terms of Use for Downloads are valid.



HEAVYCON B6 sleeve housing, for single locking latch, height: 72 mm, with 1 x Pg29 gland, lateral cable outlet

Commercial Data

Item number	1460024
Packing unit	1 pc
Minimum order quantity	10 pc
Note	Made to Order (non-returnable)
Sales Key	B10
Product Key	BF7AAC
Catalog Page	Page 486 (C-4-2013)
GTIN	4046356695169
Weight per Piece (including packing)	190.9 g
Weight per Piece (excluding packing)	178.25 g
Customs tariff number	85389099
Country of origin	DE

Housing - HC-B 6-TFL-H-O1PG29S



1460024

<https://www.phoenixcontact.com/us/products/1460024>

Technical Data

Notes

General	For contact inserts HC-B6, BB10, DD24, M
---------	--

Product properties

Type	B6
Product type	Housing with locking latch
Application	Standard
No. of cable outlets	1
Type of the screw connection	1x Pg29
Housing type	Sleeve housing
Locking type	for single locking latch
Shielded	no
Cable outlet	lateral
Pg screw connection	none

Dimensions

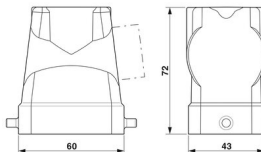
Dimensional drawing	
Width	43 mm
Height	72 mm
Length	60 mm

Material specifications

Housing surface material	Powder-coated, gray
Housing material	die-cast aluminum

Mechanical properties

Mechanical data

Type of the screw connection	1x Pg29
Locking type	Pin

Ambient conditions

Degree of protection	IP65
Ambient temperature (operation)	-40 °C ... 125 °C

Housing - HC-B 6-TFL-H-O1PG29S

1460024

<https://www.phoenixcontact.com/us/products/1460024>



Drawings

Dimensional drawing

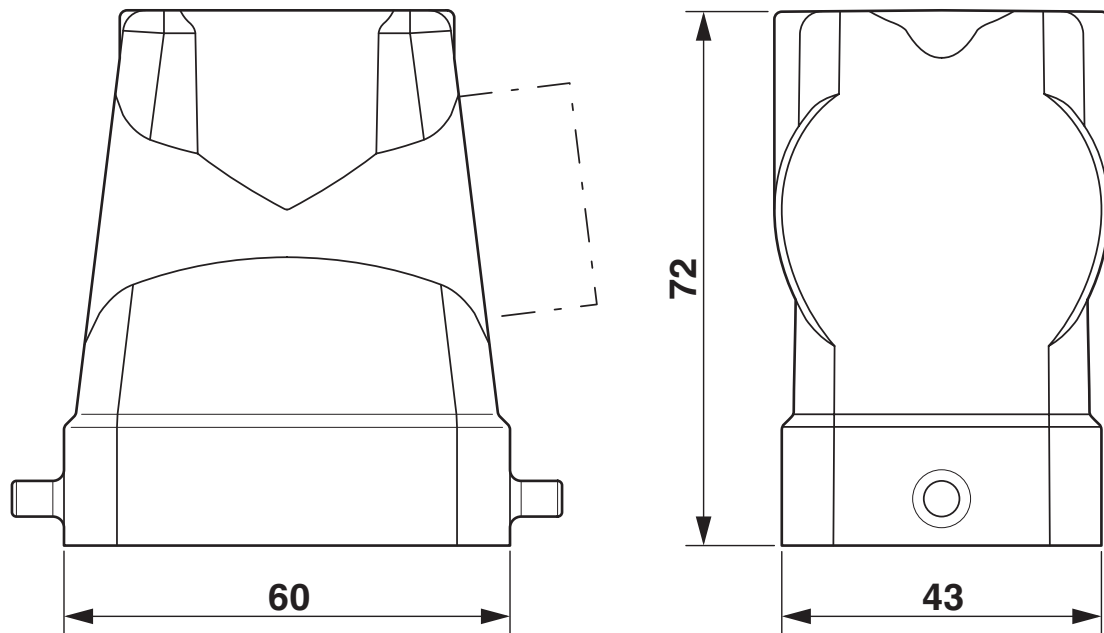

Dimensional drawing

Housing - HC-B 6-TFL-H-O1PG29S



1460024

<https://www.phoenixcontact.com/us/products/1460024>

Classifications

ECLASS

ECLASS-9.0	27440202
ECLASS-10.0.1	27440202
ECLASS-11.0	27440202

ETIM

ETIM 7.0	EC000437
----------	----------

UNSPSC

UNSPSC 21.0	31261501
-------------	----------

Housing - HC-B 6-TFL-H-O1PG29S



1460024

<https://www.phoenixcontact.com/us/products/1460024>

Environmental Product Compliance

China RoHS	Environmentally friendly use period: unlimited = EFUP-e
	No hazardous substances above threshold values

Housing - HC-B 6-TFL-H-O1PG29S



1460024

<https://www.phoenixcontact.com/us/products/1460024>

Accessories

Cable gland

Cable gland - G-INS-PG29-M68N-PNES-GY - 1411146

<https://www.phoenixcontact.com/us/products/1411146>



Cable gland, material for screw connection: PA, external cable diameter 18 mm .
.. 25 mm, shielding: no, connecting thread: Pg29, color: silver-gray RAL 7001

Cable gland

Cable gland - G-INS-PG29-M68N-NNES-S - 1411176

<https://www.phoenixcontact.com/us/products/1411176>



Cable gland, material for screw connection: Nickel-plated brass, external cable
diameter 18 mm ... 25 mm, shielding: no, connecting thread: Pg29, color: silver,
with O-ring

Housing - HC-B 6-TFL-H-O1PG29S

1460024

<https://www.phoenixcontact.com/us/products/1460024>



Cable gland

Cable gland - G-INSEC-PG29-M68N-NNES-S - 1411201

<https://www.phoenixcontact.com/us/products/1411201>



Cable gland, material for screw connection: Nickel-plated brass, external cable diameter 18 mm ... 25 mm, shielding: yes, connecting thread: Pg29, color: silver, with O-ring

Screw plug

Screw plug - HC-BS-PG29 - 1674532

<https://www.phoenixcontact.com/us/products/1674532>



Screw plug, material for screw connection: Nickel-plated brass, connecting thread: Pg29, color: silver

Phoenix Contact 2022 © - all rights reserved
<https://www.phoenixcontact.com>

Phoenix Contact USA
586 Fulling Mill Road
Middletown, PA 17057, United States
(+717) 944-1300
info@phoenixcon.com