

LOC		DIST		REVISIONS			
		P	LTN	DESCRIPTION	DATE	DWN	APVD
		1		PRELIMINARY DRAWING	11OCT2018	LL	SH
		2		UPDATE LAYOUT FOR LP	05NOV2018	LL	SH
		3		ADD DASH1-1	28AUG2019	JW	SH
		A		PRODUCTION RELEASE	16JUN2020	JW	SH

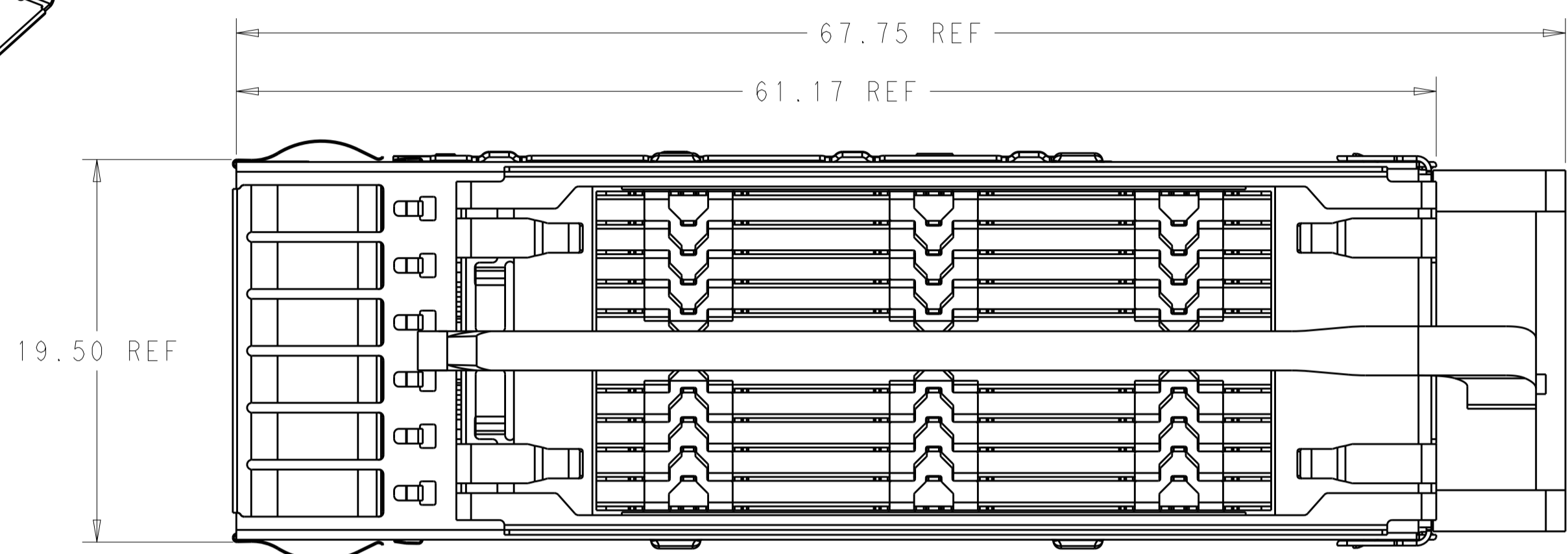
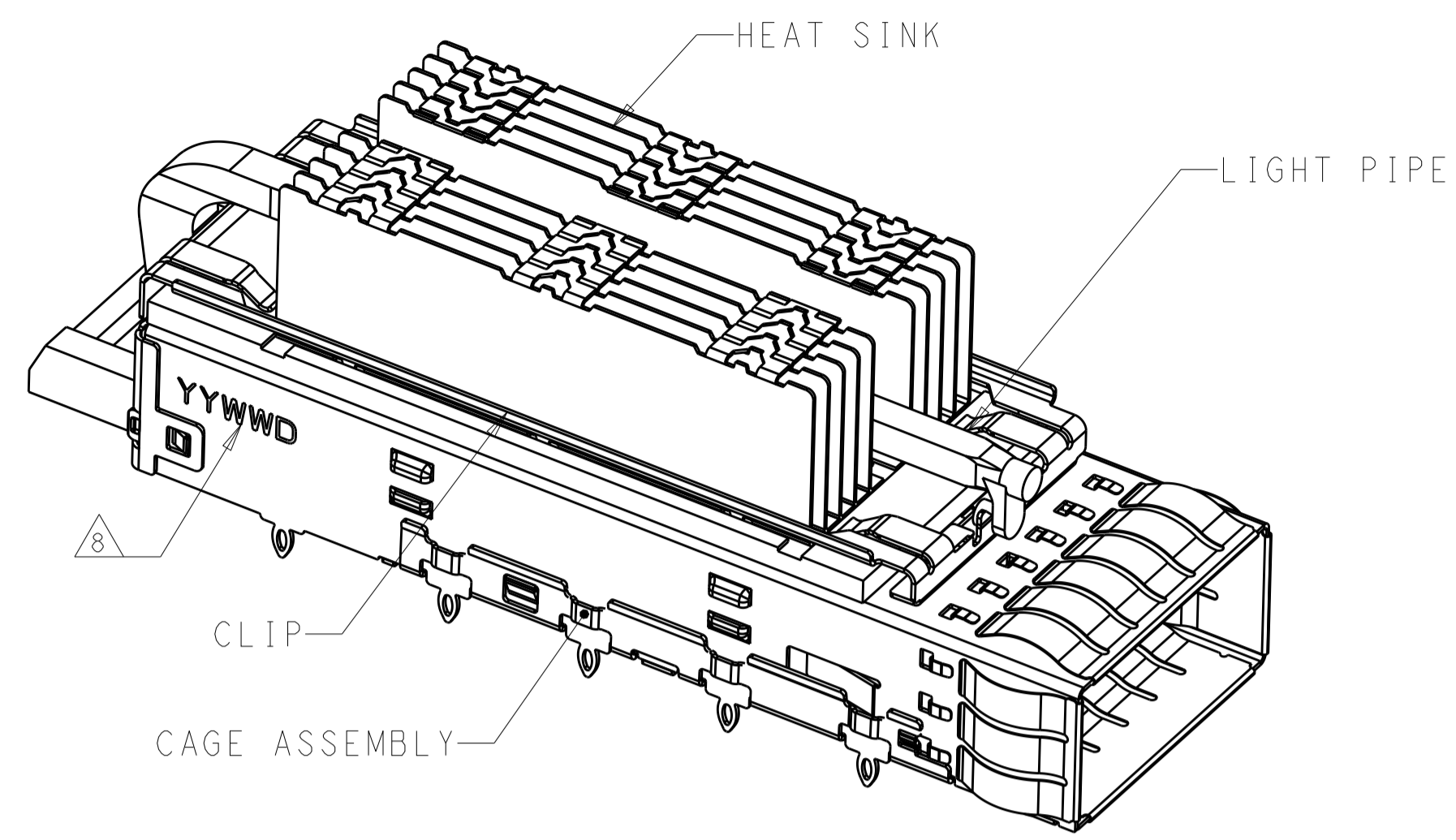

1. MATERIAL: CAGE MATERIAL : 0.25 THICK NICKEL SILVER.
 SPRING MATERIAL: COPPER ALLOY
 HEAT SINK MATERIAL: ALUMINUM
 CLIP MATERIAL: STAINLESS STEEL
 LIGHT PIPE MATERIAL: POLYCARBONATE

2. FINISH: SPRING: NICKEL PLATING
 HEAT SINK: BLACK ANODIZE

- ⚠ 3 DIMENSION APPLIES WITH MODULE INSTALLED IN THE CAGE TO TOP OF HEAT SINK.
- ⚠ 4 REFERENCE APPLICATION SPEC 114-32023 FOR RECOMMENDED DRILL HOLE DIAMETER AND PLATING THICKNESS.
- ⚠ 5 DATUM AND BASIC DIMENSIONS ESTABLISHED BY CUSTOMERS.
- 6. MINIMUM PC BOARD THICKNESS : SINGLES SIDED: 1.57 MIN
 DOUBLE SIDED: 2.20 MIN
- ⚠ 7 DATUM -A- IS TOP SURFACE OF THE HOST BOARD.
- ⚠ 8 DATE CODE (YYWWDD) MARKED APPROXIMATELY AS SHOWN
- 9. MATES WITH QSFP28 MSA COMPATIBLE TRANSCEIVER.

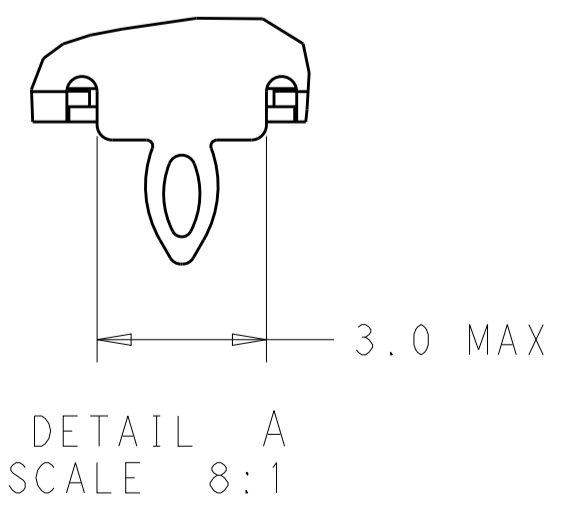
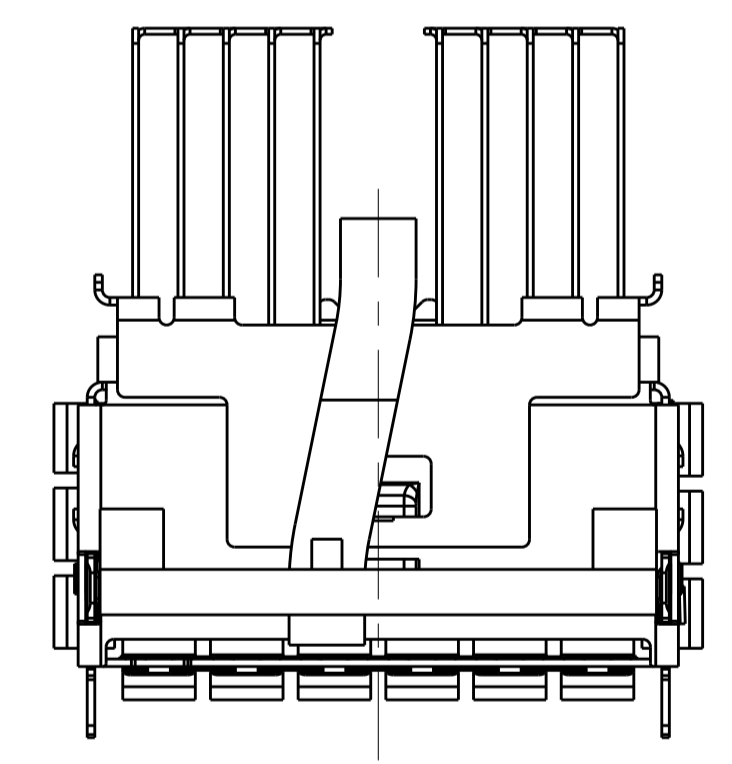
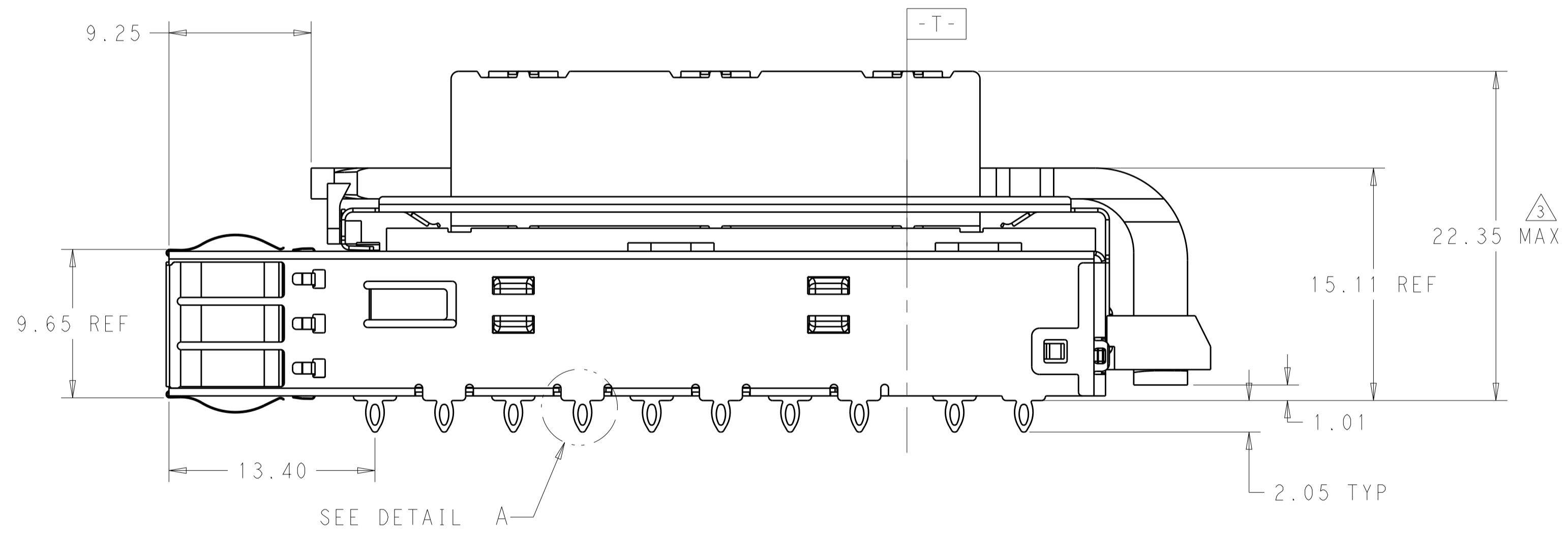
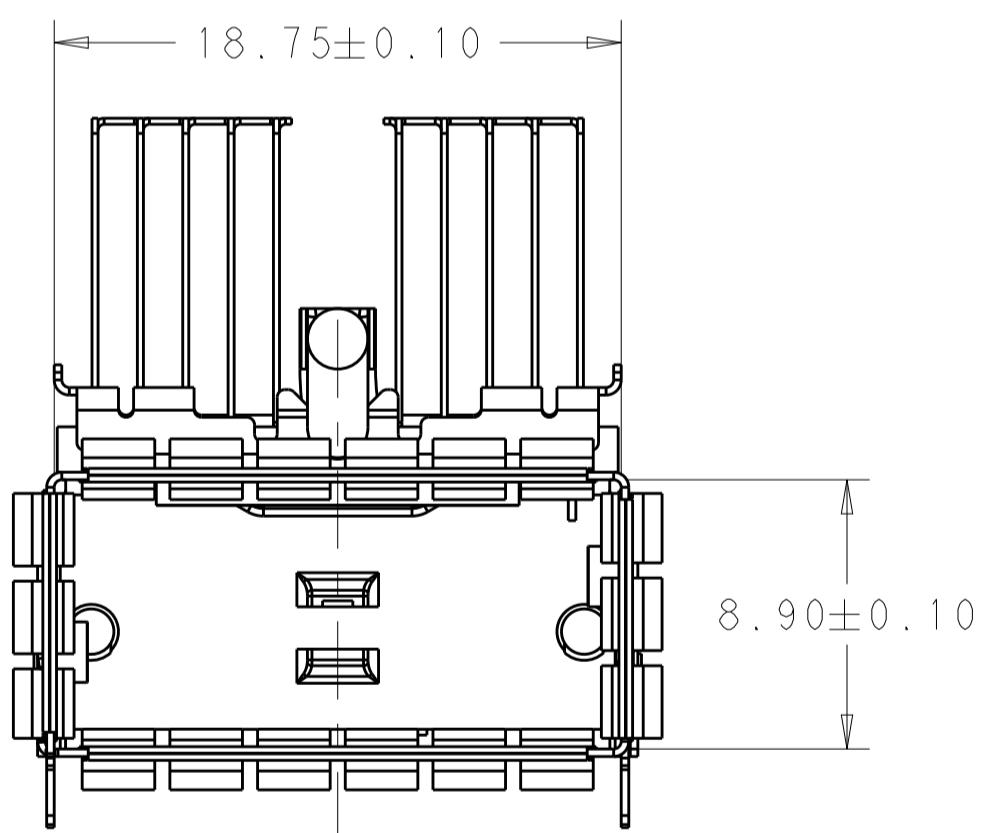

20µm COATING ON TOP AND SIDE SURFACE, 16µm ON BOTTOM SURFACE	1-2345015-1
NON-COATED	2345015-1
LIGHT PIPE	PART NUMBER

THIS DRAWING IS A CONTROLLED DOCUMENT.		DWN: LLo Li 11OCT2018	TE Connectivity
DIMENSIONS: mm		CHK: SEAN HAN 11OCT2018	
TOLERANCES UNLESS OTHERWISE SPECIFIED:		APVD:	NAME: CAGE ASSEMBLY, QSFP28, THRU BEZEL WITH EMI SPRING FINGER HEAT SINK, LIGHT PIPE
0 PLC ±0.25		PRODUCT SPEC: 108-19428	SIZE: CAGE CODE / DRAWING NO: A100779 / C=2345015
1 PLC ±0.25		APPLICATION SPEC: 114-32023	RESTRICTED TO: -
2 PLC ±0.25		WEIGHT: -	SCALE: 2:1 SHEET 1 OF 4 REV A
3 PLC ±0.25		MATERIAL: -	
4 PLC ±0.25		FINISH: -	
ANGLES: °		CUSTOMER DRAWING	

2345015-1 / 1-2345015-1 AS SHOWN

LOC		DIST		REVISIONS			
P	LTN	DESCRIPTION	DATE	DMN	APVD		
-	-	SEE SHEET 1	-	-	-		

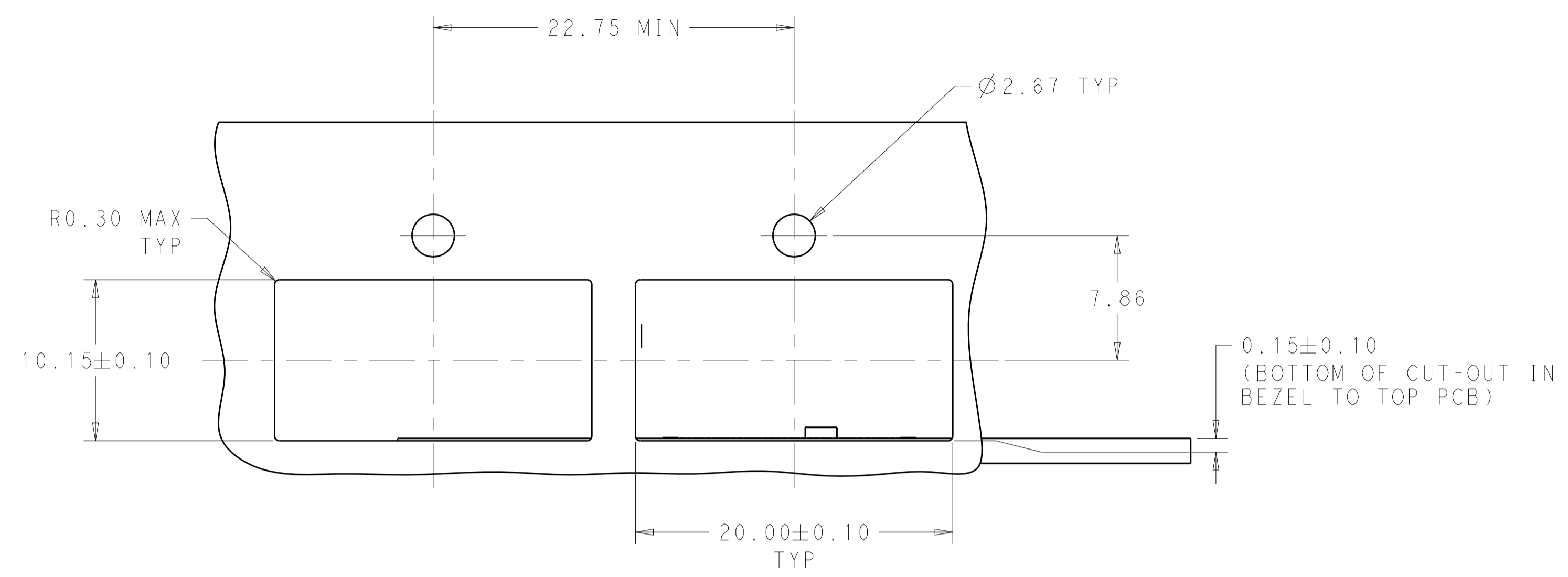

SINGLE LIGHT PIPE TYPE

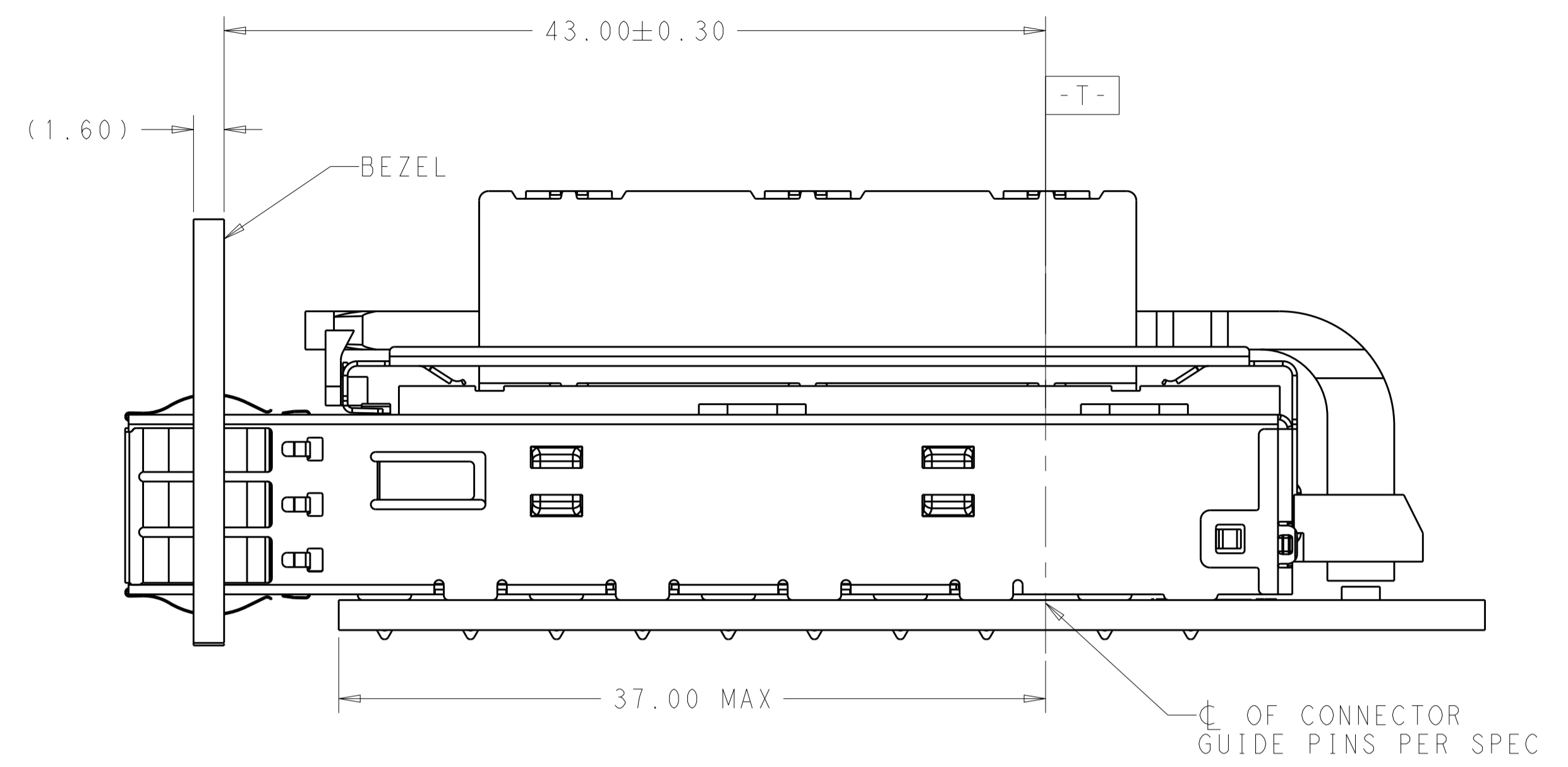

SINGLE SIDE MOUNTING
SCALE 4:1

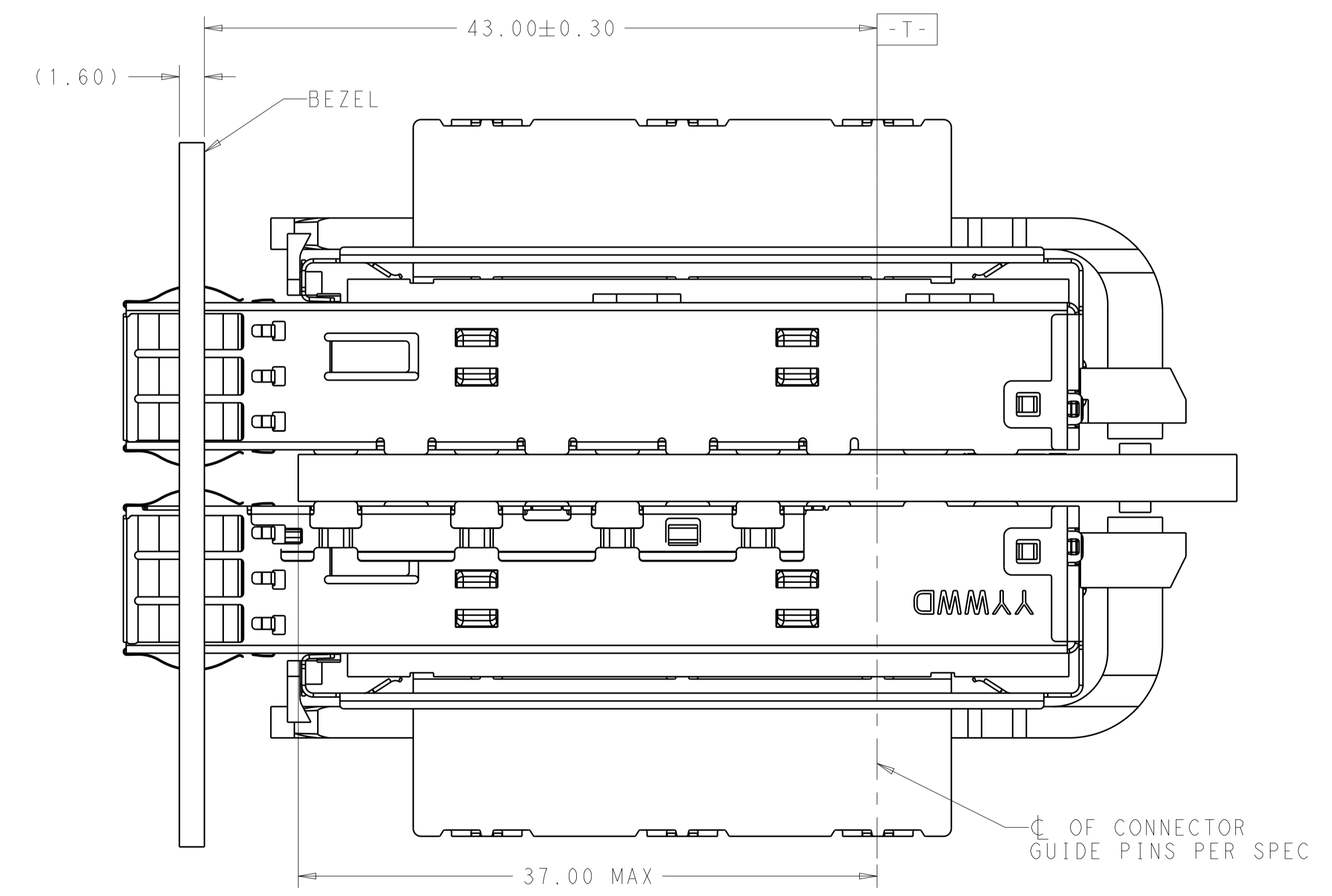
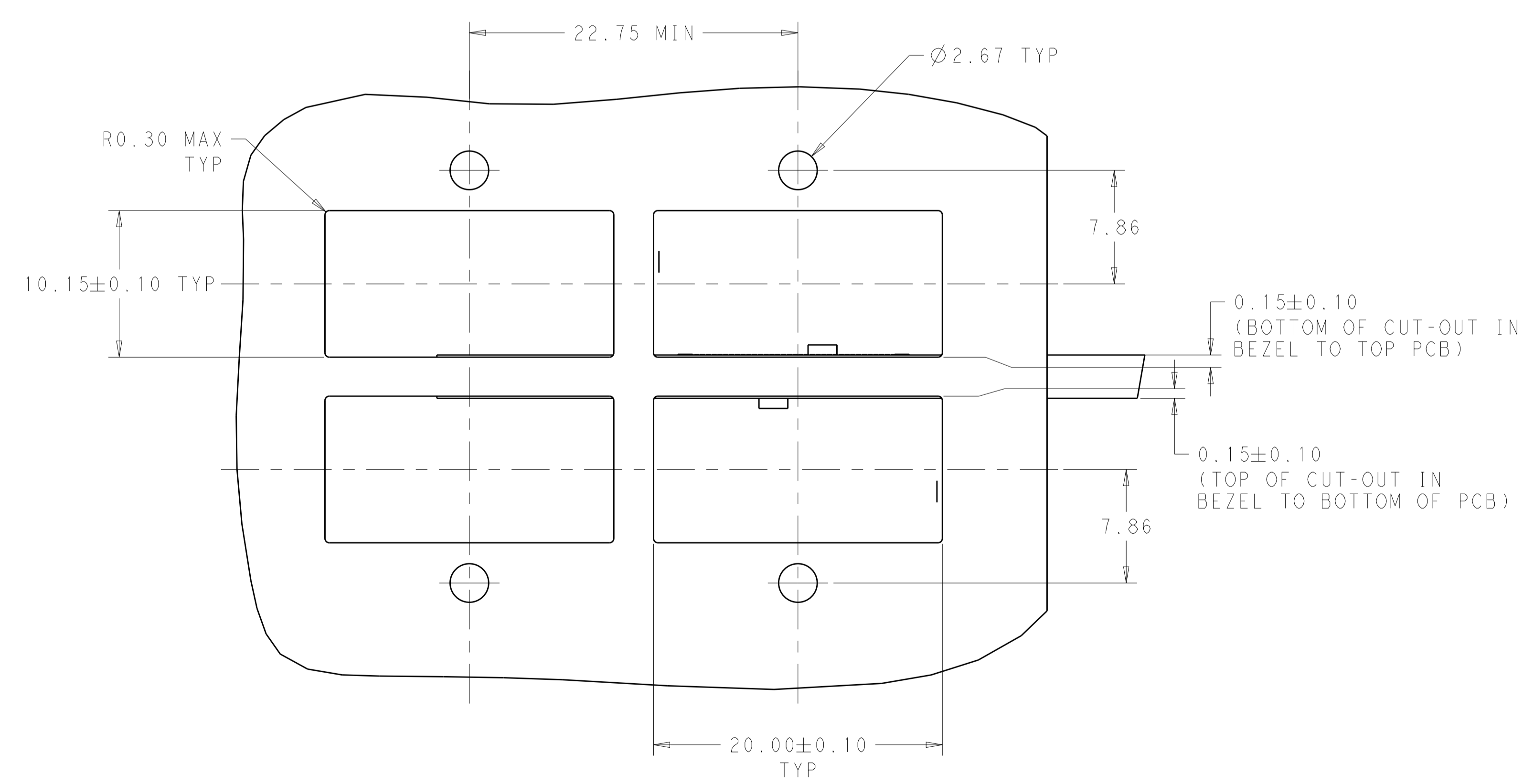

BELLY TO BELLY MOUNTING
SCALE 4:1

THIS DRAWING IS A CONTROLLED DOCUMENT.		DMN	11OCT2018	STE TE Connectivity
DIMENSIONS:		CHK	SEAN HAN	
mm	TOLERANCES UNLESS OTHERWISE SPECIFIED:	APVD		NAME
0 PLC	±0.25	PRODUCT SPEC	CAGE ASSEMBLY, QSFP28, THRU BEZEL	
1 PLC	±0.25	APPLICATION SPEC	WITH EMI SPRING FINGER	
2 PLC	±0.25	SIZE	HEAT SINK, LIGHT PIPE	
3 PLC	±0.25	WEIGHT	RESTRICTED TO	
4 PLC	±0.25	CUSTOMER DRAWING	A100779C=2345015	
ANGLES	±°	SCALE	2:1	SHEET 2 OF 4
MATERIAL	FINISH	REV	A	REV A

LOC	DIST	REV	DATE	BY	APPD
-	-	1	SEE SHEET 1	-	-

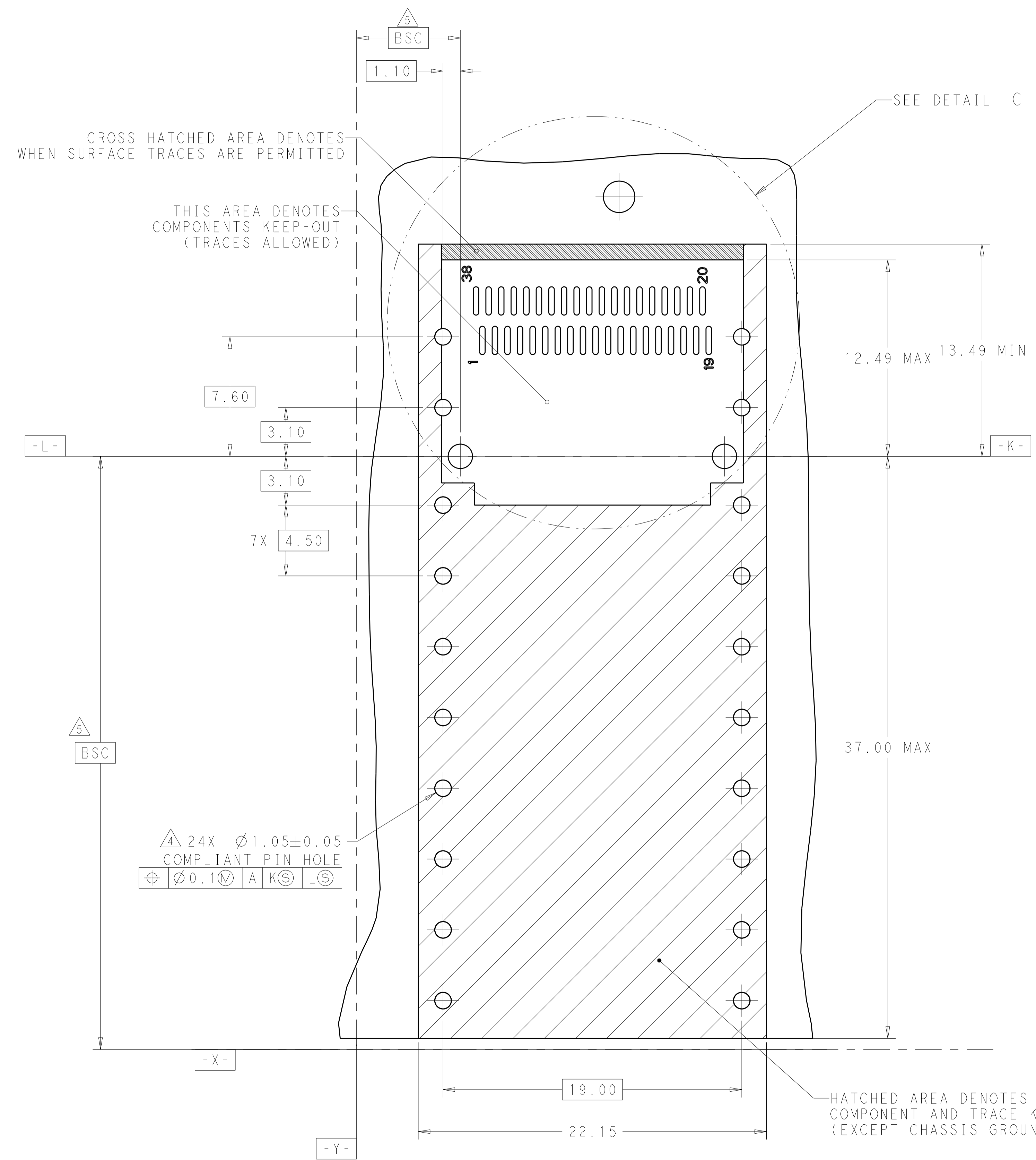

RECOMMENDED PCB LAYOUT
 BELLY TO BELLY TYPE
 PCB TOLERANCE: ± 0.05
 SCALE 6:1

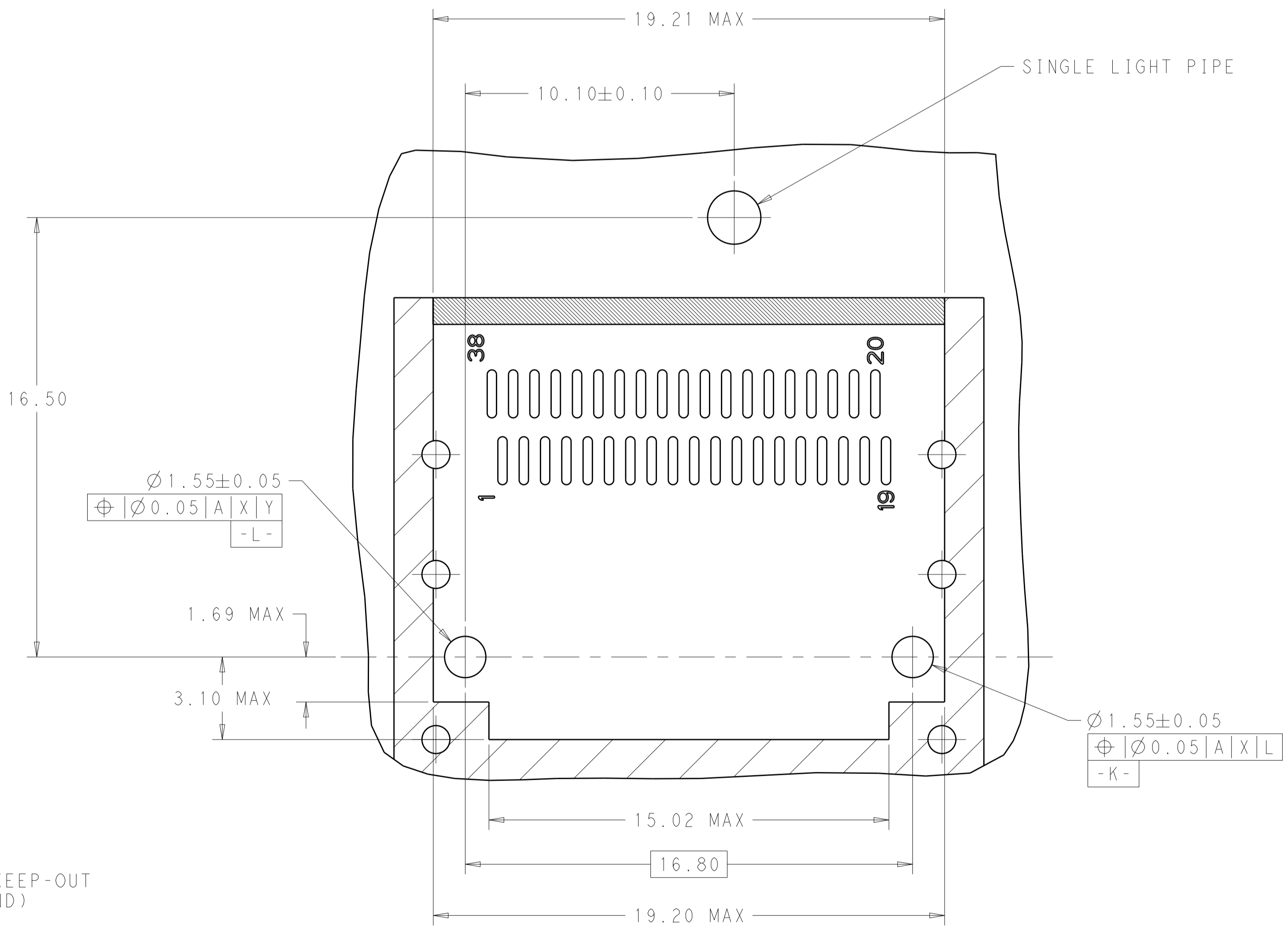

DETAIL C
 SCALE 8:1

THIS DRAWING IS A CONTROLLED DOCUMENT.		DWN 11OCT2018	TE Connectivity
DIMENSIONS: mm		CHK LEO LI 11OCT2018 SEAN HAN	
TOLERANCES UNLESS OTHERWISE SPECIFIED:		APVD	NAME
0 PLC ± 0.25	1 PLC ± 0.25	PRODUCT SPEC	CAGE ASSEMBLY, QSPF28, THRU BEZEL
2 PLC ± 0.25	3 PLC ± 0.25	APPLICATION SPEC	WITH EMI SPRING FINGER
4 PLC ± 0.25	ANGLES \pm	114-32023	HEAT SINK, LIGHT PIPE
MATERIAL	FINISH	WEIGHT	SIZE CAGE CODE DRAWING NO RESTRICTED TO
			A100779C=2345015
CUSTOMER DRAWING			SCALE 2:1 SHEET 4 OF 4 REV A