

PRODUCT NUMBER	PITCH
HWxx50x500J0G	5.08 mm

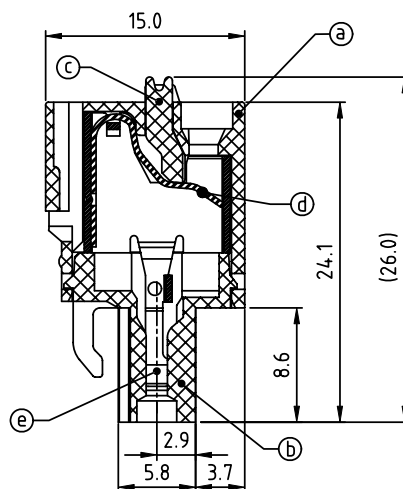

SECTION P-P

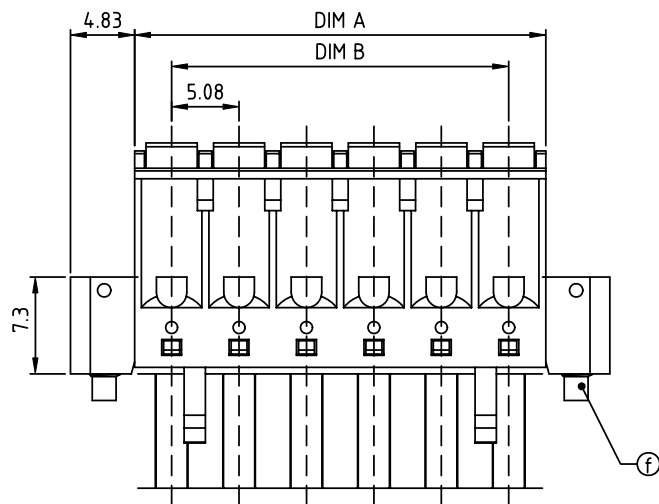
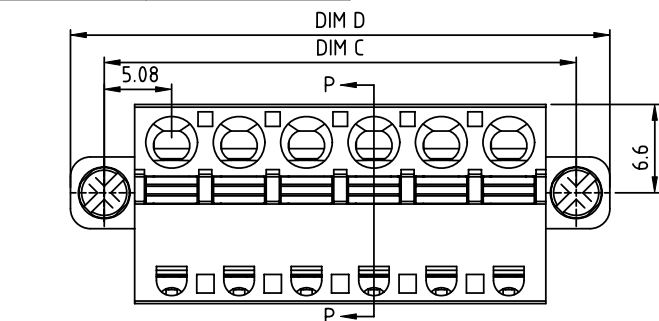
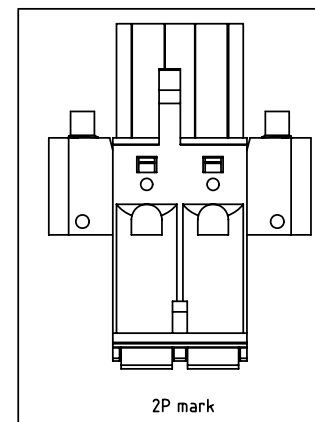

## Material:

- Item①Top body:Thermoplastic ( UL94V-0 )
- Item②Bottom body:Thermoplastic ( UL94V-0 )
- Item③Terminal lever:Thermoplastic ( UL94V-0 ) Orange(RAL2011/P)
- Item④Spring clamp:Stainless Steel
- Item⑤Female contact:PhBz ( CuSn ) Tin plated
- Item⑥Flange screw:Steel Zinc plating M2.5 solt "+/-"combination type

## Electrical cULus

- Voltage rating:300V
- Current rating:10A
- Solid wire(AWG):12-26
- Stranded wire(AWG):12-26
- Wire strip length:9-10mm
- Withstanding Voltage:1.6KV
- Operating temperature:-40°C to +115°C

Dimension  
 DIM A=N×5.08+0.5  
 DIM B=(N-1)×5.08  
 DIM C=(N-1)×5.08+10.16  
 DIM D=(N-1)×5.08+15.24  
 N=Number of poles

POLES	Tolerance
2p-6p	±0.15
7p-12p	±0.20
13p-16p	±0.30
17p-24p	±0.40

PART NO.: HW xx 50 x 5 00J0 G

Solid block	No. of poles	Color	RoHS compliant (lead<4%) In copper Alloy
02	2 poles	0 Black (RAL9005)	
03	3 poles	2 Red (RAL3001/D)	
...	...	3 Orange(RAL2011/P)	
24	24 poles	4 Yellow(RAL1018/A)	
		5 Green(RAL6018/T)	
		6 Blue (RAL5015/A)	
		8 Grey(RAL7035/D)	
		9 White(RAL1102)	
		C Green(RAL6018/U)	

mat'l. code				surface ASME Y14.5	tolerance ASME Y14.5	projection	product family	
ltr	ecn	no	dr	date	tolerances unless otherwise specified	MM	TERMINAL BLOCK	
					angles		title	
					X±0.5		TERMINAL BLOCK	
					X.X±0.3		SPRING CLAMP, PLUGGABLE PLUG, WITH FLANGE	
					X'±1"		CONTACT IN THE MIDDLE SIDE	
					dr	EVIN ZHONG 051514	dwg no	
					enrg	EVIN ZHONG 051514	sheet 1 of 1	
					chr	HANKE FENG 051514	size	
					appd	SHI JUN 051514	A4	
sheet index				revision	A		type	
				sheet	1		CUSTOMER Drawing	