

PRODUCT NUMBER

PITCH

VXxx12x000J0G

3.50 mm

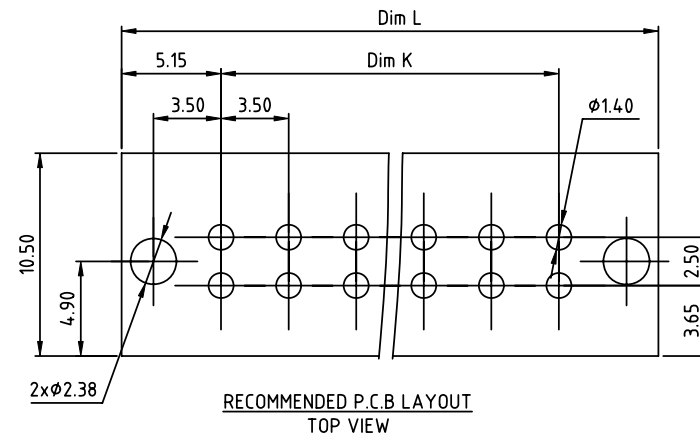
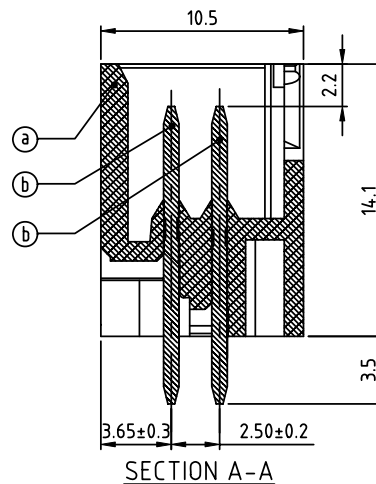
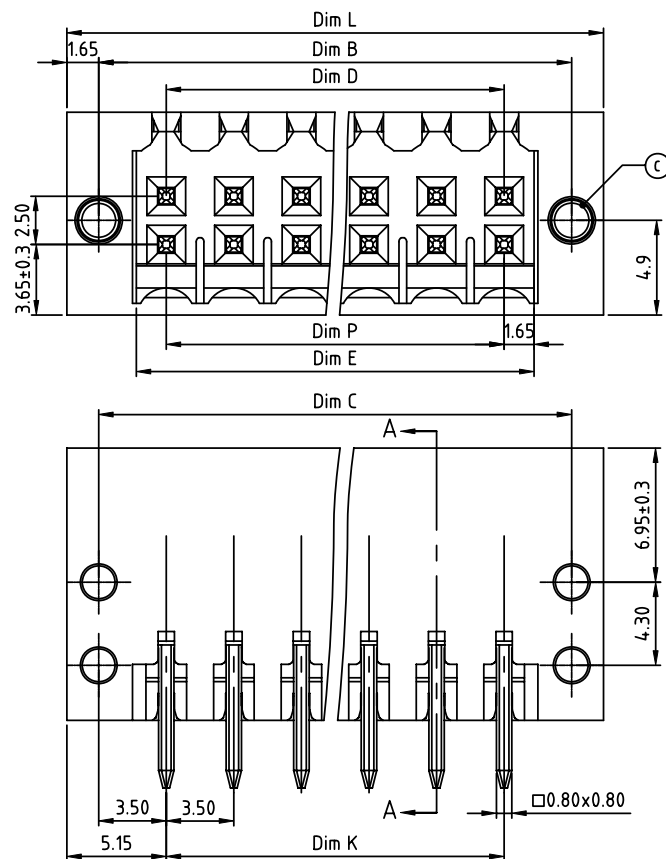

Material:

● Item ① Terminal housing: Thermoplastic(UL94V-0)

● Item ② Pin: Brass, Tin plated

● Item ③ With flange nut: Brass, Nickel plated. M2.0

Electrical:

● Voltage rating: 150V

● Current rating: 7A

● Withstanding Voltage: 1.3KV

● Operating temperature: -40°C to +115°C

● Soldering temperature: 260°C±5°C/5 Sec

● Safety Approval:



Dim L=(N/2-1)×3.5+10.3
Dim P=(N/2-1)×3.5
Dim K=(N/2-1)×3.5
Dim B=(N/2-1)×3.5+7.0
Dim C=(N/2-1)×3.5+7.0
Dim D=(N/2-1)×3.5
Dim E=(N/2-1)×3.5+3.3

N=Number of poles

Poles	Dim L	Dim P	Dim K	Dim B	Dim C	Dim D	Dim E
2x2p-2x6p	±0.15	±0.10	±0.10	±0.15	±0.15	±0.10	±0.15
2x7p-2x12p	±0.25	±0.20	±0.20	±0.25	±0.25	±0.20	±0.25
2x13p-2x18p	±0.35	±0.30	±0.30	±0.35	±0.35	±0.30	±0.35
2x19p-2x24p	±0.40	±0.35	±0.35	±0.40	±0.40	±0.35	±0.40

PART NO.: VX xx 12 x 0 00J0 G

Solid block
No. of poles
04 2x2 poles
06 2x3 poles
...
48 2x24 poles

Color
0 Black (RAL9005)
2 Red (RAL3001/D)
3 Orange(RAL2011/P)
4 Yellow(RAL1018/A)
5 Green(RAL6018/T)
6 Blue (RAL5015/A)
8 Grey(RAL7035/D)
9 White(RAL1102)
C Green(RAL6018/U)

RoHS compliant
(lead<4%)
In copper Alloy

mat'l. code				surface	tolerance	projection	product family	
ltr	ecn	no	dr	date	ASME Y14.5	ASME Y14.5	TERMINAL BLOCK	
					tolerances unless otherwise specified			
					angles	X.±0.5	title	
					flatness	X.X±0.3	TERMINAL BLOCK	
					X'±1"	X.XX±0.1	PLUGGABLE SOCKET, VERTICAL, WITH FLANGE	
					dr	EVIN ZHONG 050714	dwg no	
					enrg	EVIN ZHONG 050714	sheet 1 of 1 size	
					chr	HANKE FENG 050714	VXxx12x000J0G	
					appd	SHI JUN 050714	A4	
							type	
							CUSTOMER Drawing	
sheet index	revision	A						