

**COAXIAL ADAPTER, SMPM, 50 Ohm, jack / jack (female / female)**

31\_SMPM-50-0-3/111\_N

**Properties**

- Best performance-to-price ratio
- Excellent RF performance up to 65 GHz
- Small size, compact form factor
- Snap-on coupling mechanism with full detent and smooth bore
- Board-to-board solutions with bullets for axial and radial float

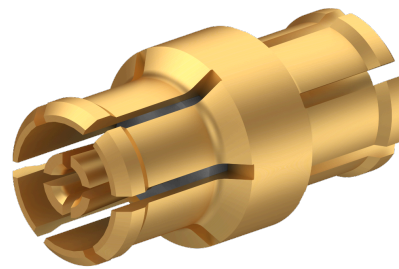

Product configuration		
Interface type	Gender	Standard
SMPM	jack (female)	MIL-STD-348B
SMPM	jack (female)	MIL-STD-348B

Interface and material data		
SMPM		
<b>Piece parts</b>	<b>Material</b>	<b>Plating</b>
Centre contact	Copper Beryllium Alloy	SUCOPRO Plating
Outer conductor	Copper Beryllium Alloy	SUCOPRO Plating
Body	Copper Beryllium Alloy	SUCOPRO Plating
Insulator	PTFE (Polytetrafluoroethylene)	
SMPM		
<b>Piece parts</b>	<b>Material</b>	<b>Plating</b>

Electrical Data (frequency related)		
<b>Frequency range</b>	<b>Return loss</b>	<b>VSWR</b>
0 GHz ... 26.5 GHz	26 dB	1.11
26.5 GHz ... 65 GHz	16 dB	1.38

Mechanical data	
Weight	0.08 g
Mating cycles	500

Engagement / Disengagement force				
	<b>Engagement</b>	<b>Engagement</b>	<b>Disengagement</b>	<b>Disengagement</b>
Interface class	Full detent	Smooth bore	Full detent	Smooth bore
Interface force typical	20 N	11 N	29 N	6.7 N

**COAXIAL ADAPTER, SMPM, 50 Ohm, jack / jack (female / female)**

31\_SMPM-50-0-3/111\_N

Interface class	The force is determined by the counterpart
Interface force typical	

**Environmental data**

Operation temperature	-65 °C ... 165 °C
-----------------------	-------------------

**Material compliance**

Item number	Directive / Regulation	Rating	Exemptions / Details
85236929	RoHS 2011/65/EU and (EU) 2015/863	Compliant with exemption	6c 6c
	REACH 1907/2006 Article 33 SVHC	Contains one or more SVHC >0,1%	CAS: 7439-92-1 Lead
85275972	RoHS 2011/65/EU and (EU) 2015/863	Compliant with exemption	6c
	REACH 1907/2006 Article 33 SVHC	Contains one or more SVHC >0,1%	CAS: 7439-92-1 Lead

**Ordering Information Table**

Item number	Item description	Packaging type
85236929	31_SMPM-50-0-3/111_NE	Single
85275972	31_SMPM-50-0-3/111_NH	Bulk 100 pcs

**Additional Information**

Remarks	<p>The values provided are typical and may vary depending on factors such as the mating connector, and installation condition.</p> <p>Mating force and mating cycles are determined by the mating connector (full detent or smooth bore).</p> <p>Mating cycles: full detent: 100 smooth bore: 500</p>
---------	---

HUBER+SUHNER is certified by ISO 9001, ISO 14001, ISO 45001, IATF 16949, AS/EN 9100 and ISO/TS 22163-IRIS. Waiver: Facts and figures herein are for information only and do not represent any warranty of any kind.  
DOCUMENT PIM-P60530 / Date of publication: 04.12.2025 / uncontrolled copy