

APPROVED: \_\_\_\_\_

DATE: \_\_\_\_\_ TITLE: \_\_\_\_\_

Rev	AWO #	Description	Date	Appr
-		RELEASED	12/04/07	
A		REVISED DIMENSION	8/30/11	
B		UPDATE DRAWING	11/25/19	AY/RC
C		UPDATE SPEC.	8/24/21	WX/TL

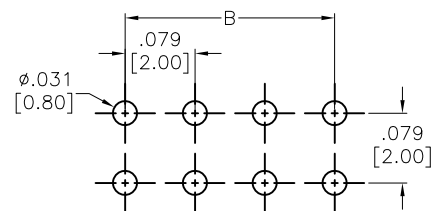
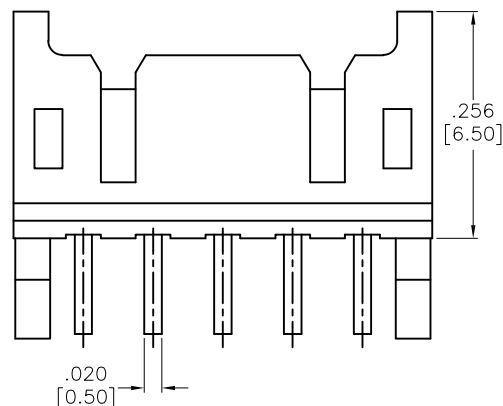
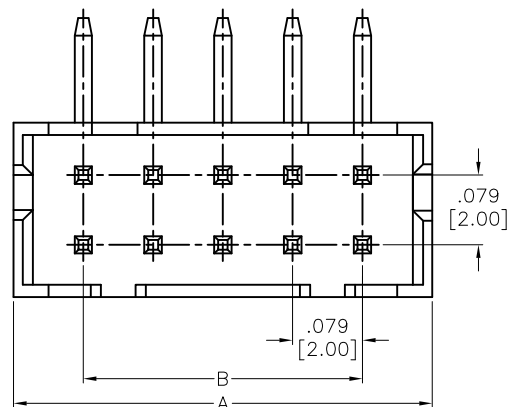

RECOMMENDED P.C.B LAYOUT

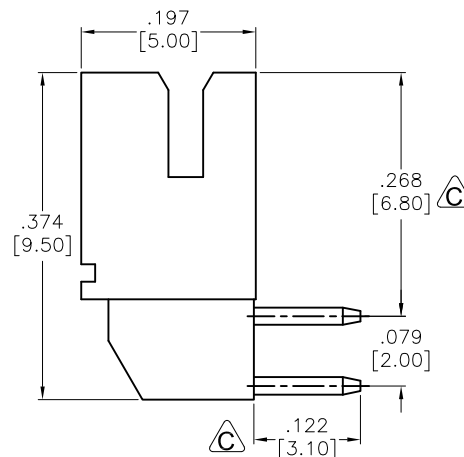

SPECIFICATIONS:

Material:

Insulator: Nylon66, rated UL 94V-0

Insulator color: Natural

Contacts: Brass

Plating:

Tin over Copper underplate overall

Electrical:

Voltage rating: 130 VAC/DC

Current rating: 2A AC/DC

Contact resistance: 20 mohms max

Insulation resistance: 1,000 Mohms min

Dielectric withstanding voltage: 500 VAC for 1 minute

Temperature Rating:

Operating temperature: -25°C to +85°C

Environmental:

Lead free, RoHS compliant



Positions: 4 thru 40

A= .079 [2.00] x No. of Positions per Row +.075 [1.90]

B= .079 [2.00] x No. of Space

UNLESS OTHERWISE SPECIFIED ALL DIMENSIONS ARE INCHES [MM]. TOLERANCES: EXCEPT AS NOTED

INCHES	HOLES
.X ± .10	ØX ± .10
.XX ± .020	ØXX ± .015
.XXX ± .015	ØXXX ± .010

DRAWN	SS	12/04/07
CHECKED		
APPROVED		

THIS DRAWING CONTAINS INFORMATION THAT IS PROPRIETARY AND SHOULD NOT BE USED WITHOUT PRIOR WRITTEN PERMISSION FROM ADAM TECH

**ADAM**  
**TECH**

909 Rahway Avenue,  
Union, NJ 07083  
Phone: 908-687-5000  
Fax: 908-687-5710

TITLE  
.079 [2.00] DOUBLE ROW, SHROUDED  
HEADER, RIGHT ANGLE, PCB, TIN PLATED

SIZE  
X

REF: S00015T SCALE: NTS SHEET 1 OF 1