

REVISIONS					
P	LTR	DESCRIPTION	DATE	DWN	APVD
A1		Revised as per ECR-23-193507	18JUL2023	SSM	WH

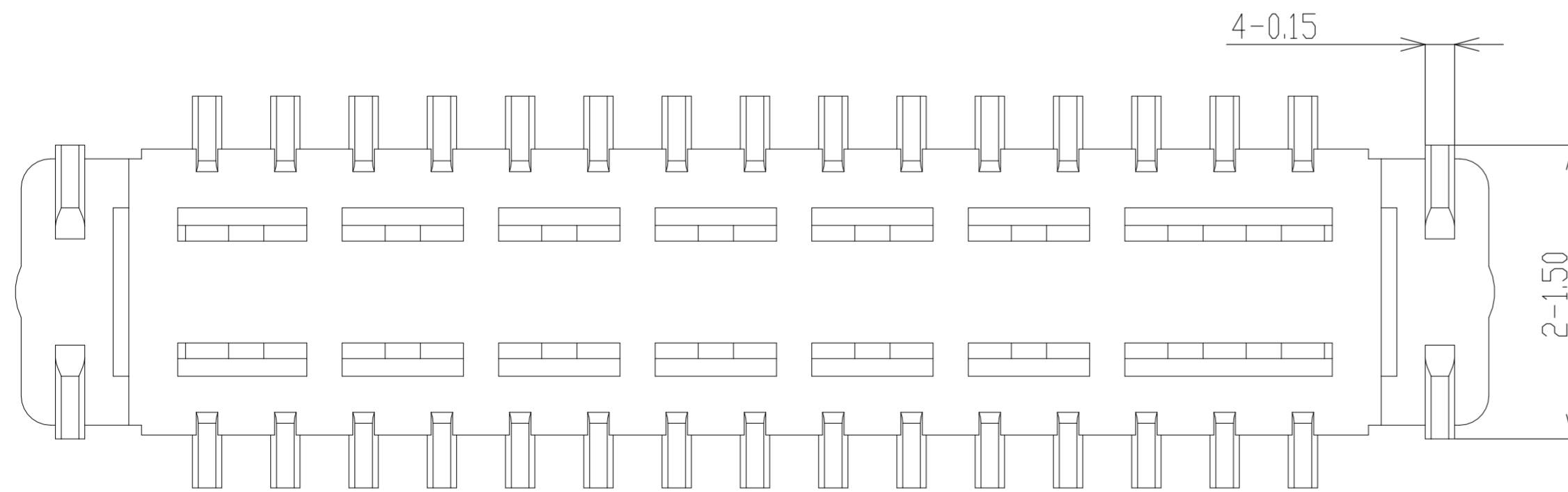
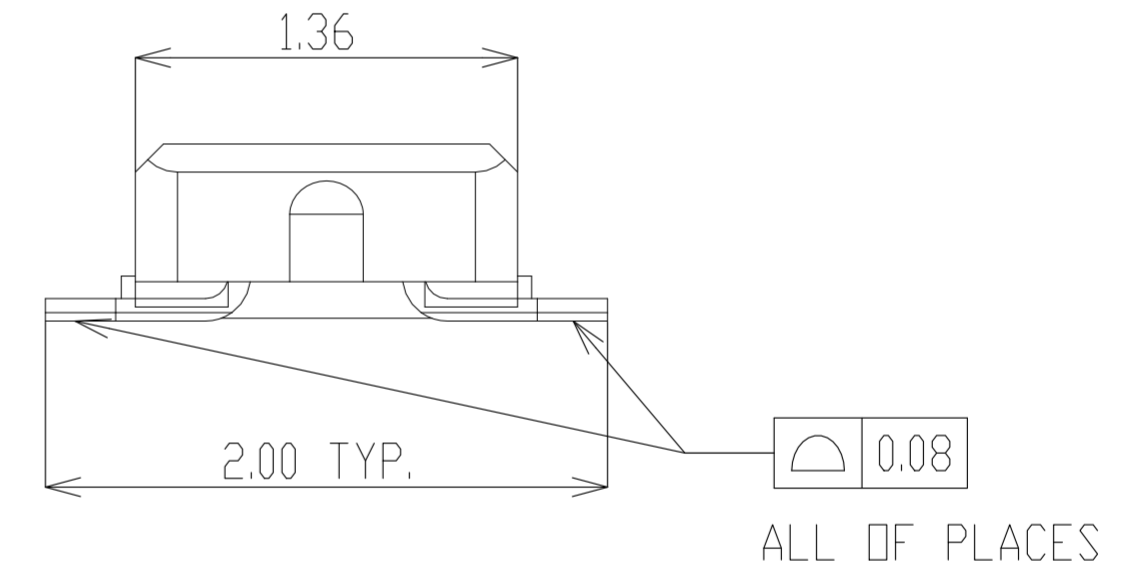
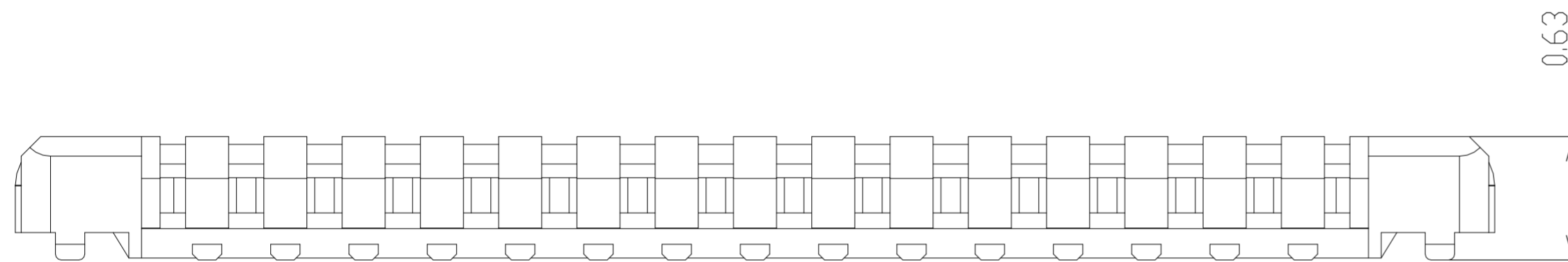
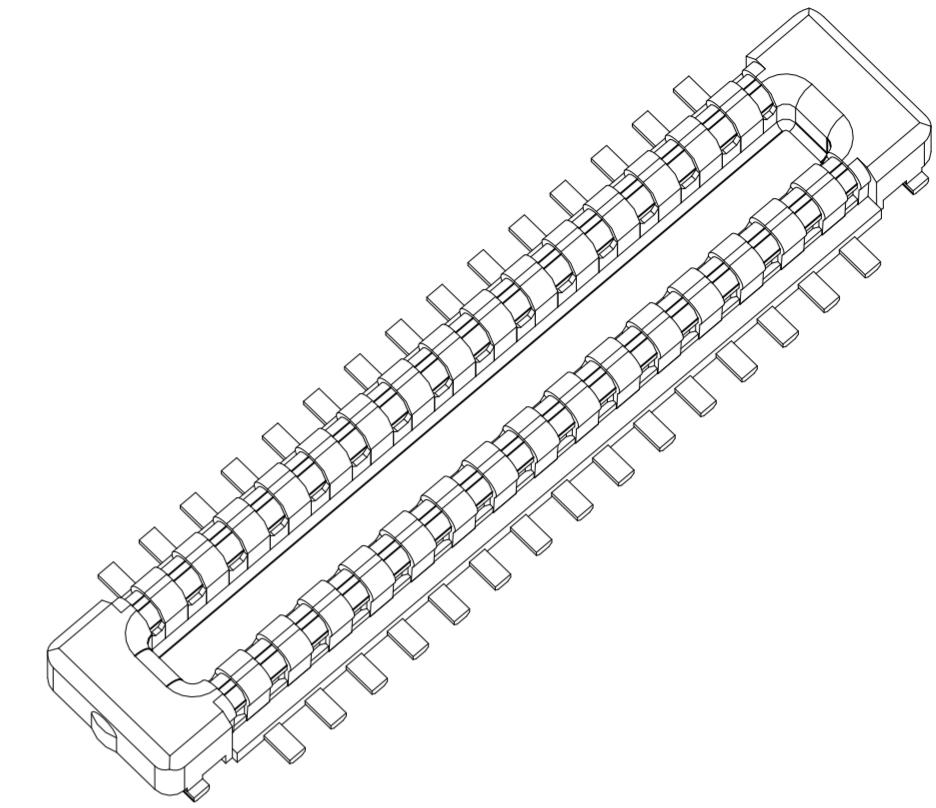
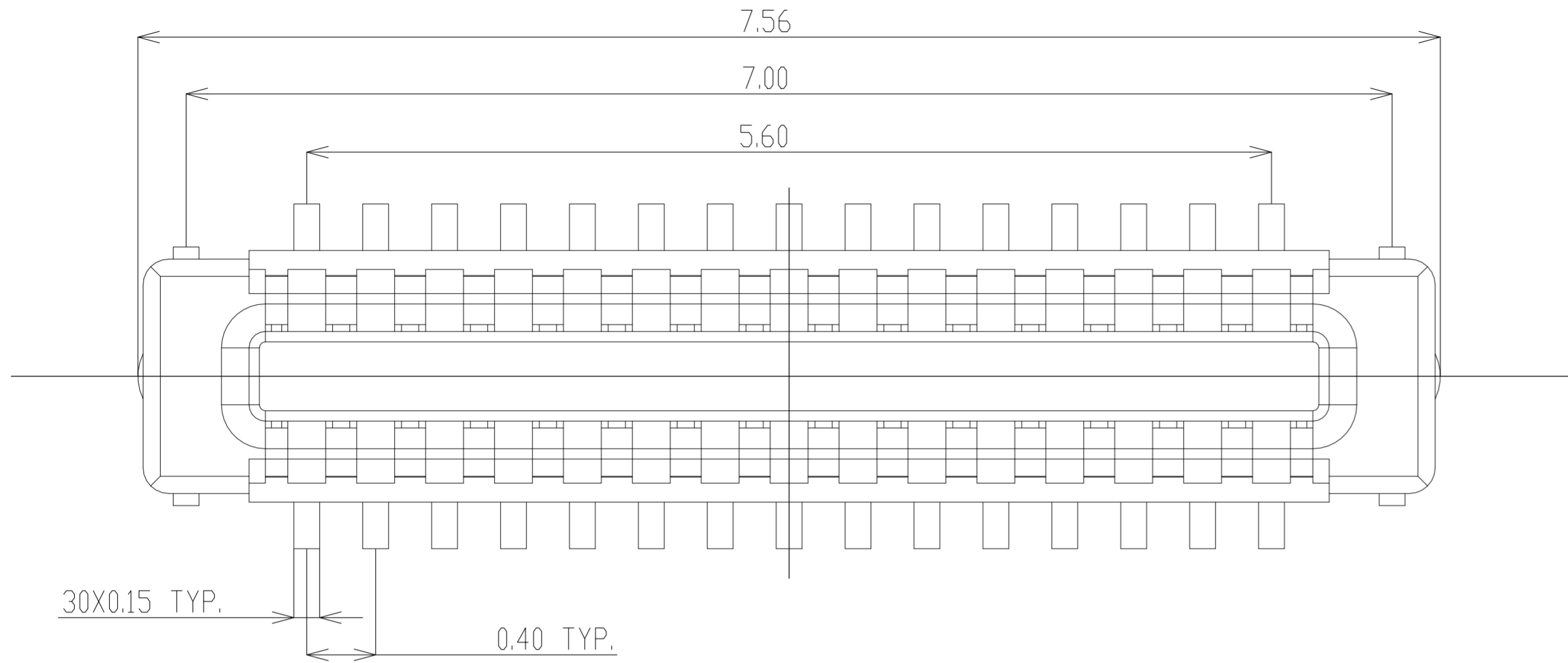

3-2363962-0
PART NUMBER

THIS DRAWING IS A CONTROLLED DOCUMENT.		DWN H.X 26SEP2019	TE Connectivity Ltd.		
DIMENSIONS: mm		CHK W.H 26SEP2019	0.4mm PITCH BTB CONN. H0.8 PLUG ASSEMBLY		
TOLERANCES UNLESS OTHERWISE SPECIFIED:		APVD -	NAME		
0 PLC ± -		PRODUCT SPEC	SEE NOTE 5		
1 PLC ± 0.3		APPLICATION SPEC	114-115040		
2 PLC ± 0.20		WEIGHT	SIZE A2	CAGE CODE 00779	DRAWING NO. C=2363962
3 PLC ± -		FINISH	RESTRICTED TO		
4 PLC ± -			SCALE 16:1 SHEET 1 of 12 REV A1		
ANGLES ± -					
MATERIAL			CUSTOMER DRAWING		

P	LTR	DESCRIPTION	DATE	DWN	APVD
-	-	SEE SHEET 1	-	-	-

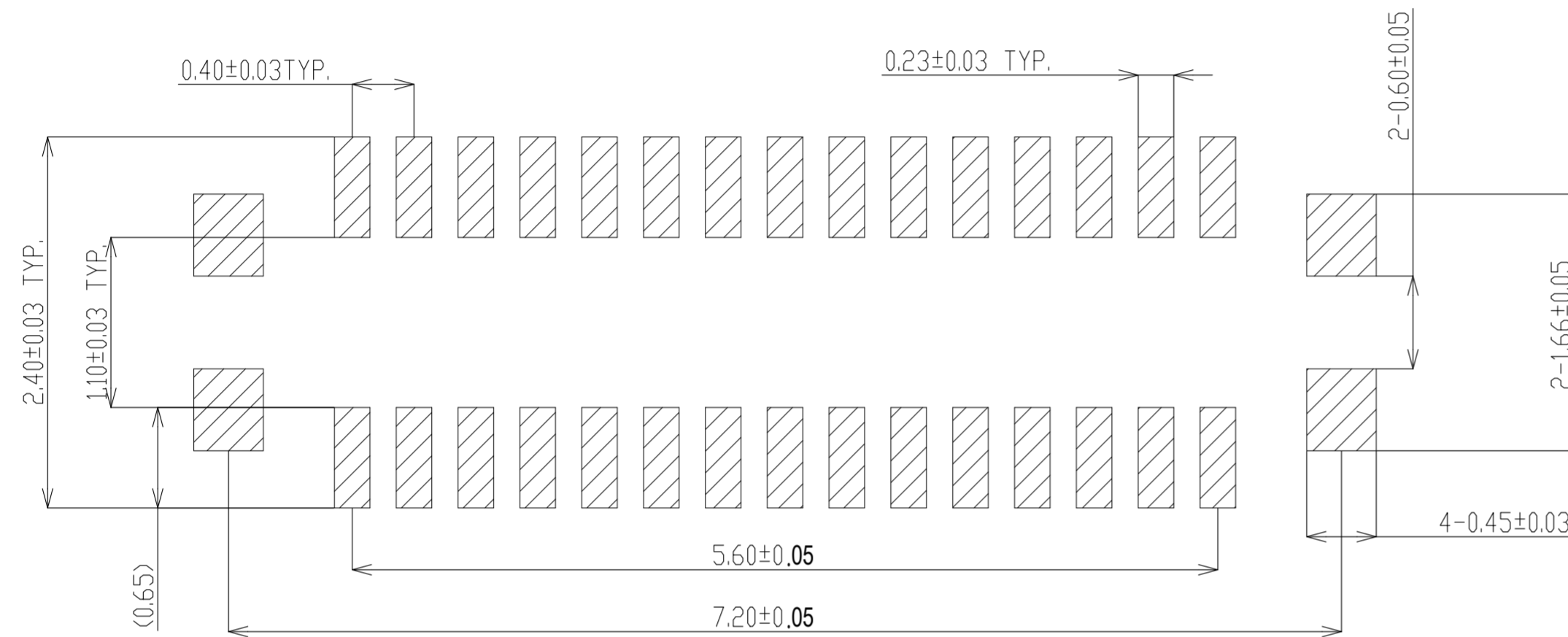

RECOMMENDED P.C.BOARD PATTERN DIMENSION (WITH HOLD DOWN)

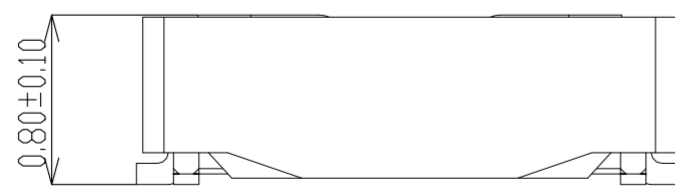

NOTES:

1.MATERIAL:

- 1.1 HOUSING: LCP, UL 94 V-0, COLOR: BLACK.
- 1.2 CONTACT: COPPER ALLOY.
- 1.3 HOLD DOWN: COPPER ALLOY.

2. FINISH:

- 2.1 CONTACT:
GOLD FLASH ON CONTACT AND SOLDERING AREA.
NICKEL UNDER PLATING OVERALL.
- 2.2 HOLD DOWN:
GOLD FLASH PLATING OVER NICKEL UNDER PLATING.

3.REFLOW SOLDER CAPABLE TO 260 °C.

4.MATING PLUG PART NUMBER: 3-2363961-0.

5.PRODUCT SPECIFICATION 108-115166

THIS DRAWING IS A CONTROLLED DOCUMENT.		DWN	26SEP2019	TE TE Connectivity Ltd.	
		CHK	26SEP2019		
DIMENSIONS: mm		TOLERANCES UNLESS OTHERWISE SPECIFIED:		NAME	
		0 PLC	± -	0.4mm PITCH BTB CONN.	
		1 PLC	± 0.3	H0.8 PLUG ASSEMBLY	
		2 PLC	± 0.20	-	
		3 PLC	± -	-	
MATERIAL		FINISH		SIZE	CAGE CODE
-		-	-	A2	00779
		APVD		DRAWING NO	RESTRICTED TO
		-		114-115040	-
		PRODUCT SPEC		SCALE	SHEET
		SEE NOTE 5		16:1	2 OF 12
		APPLICATION SPEC		REV	A1
		WEIGHT		CUSTOMER DRAWING	
		-			

REVISIONS					
P	LTR	DESCRIPTION	DATE	DWN	APVD
-	-	SEE SHEET 1	-	-	-

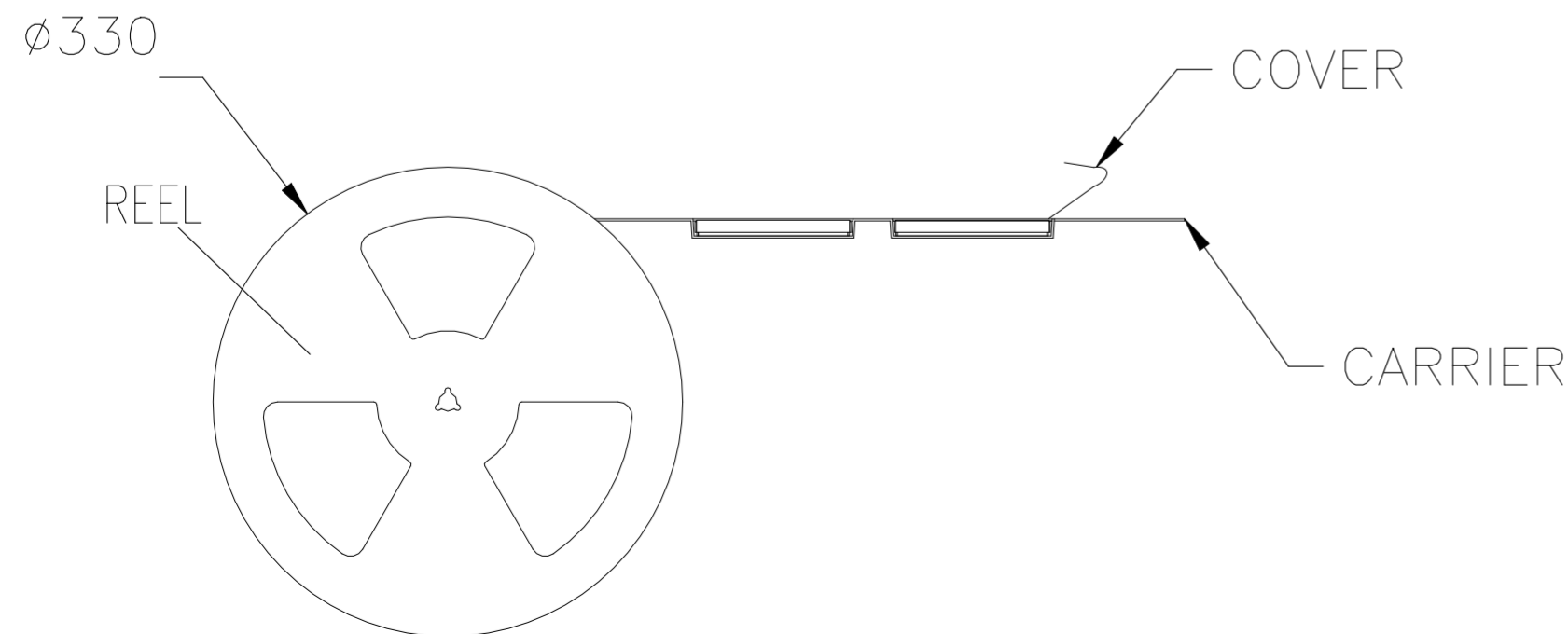
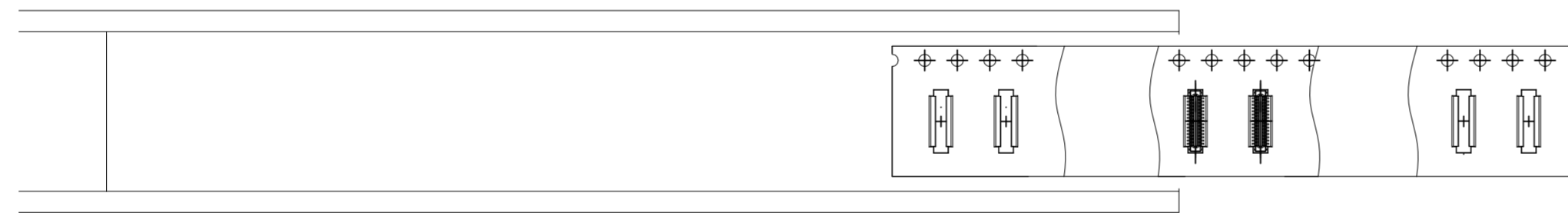
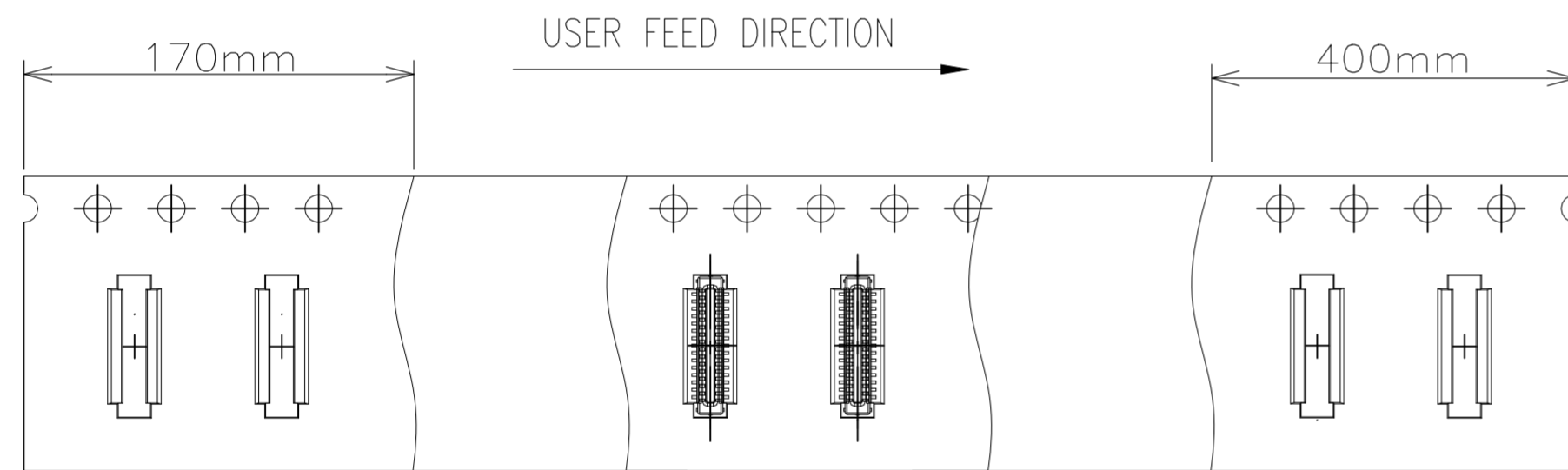
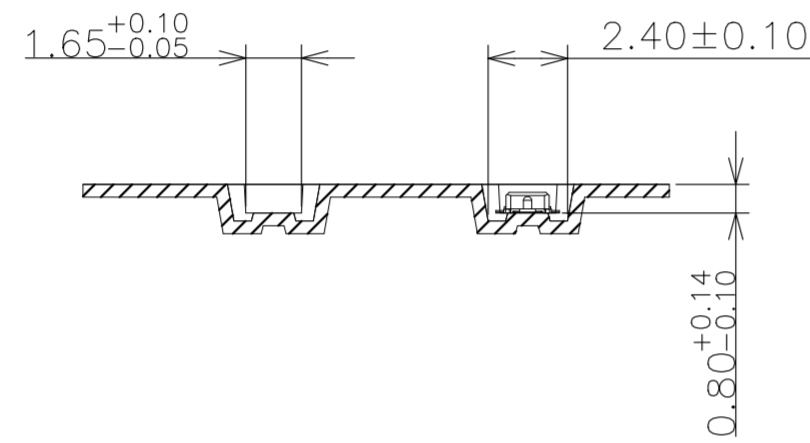
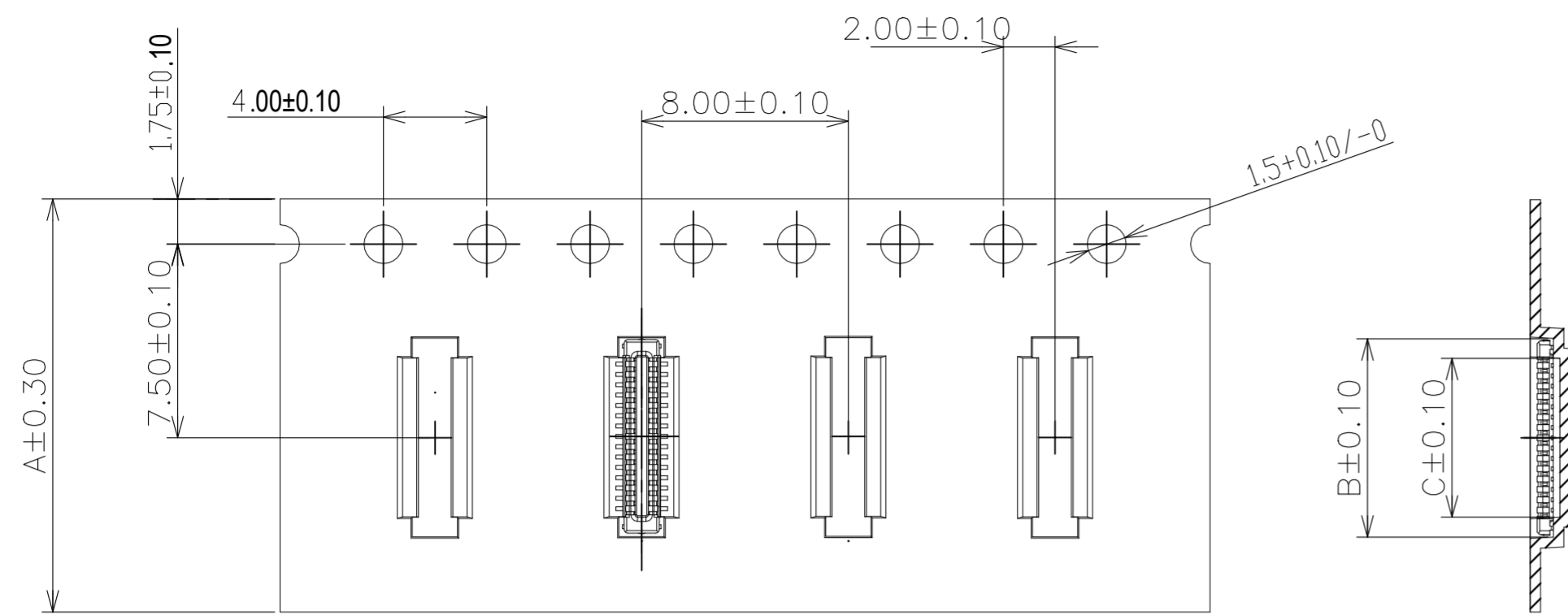

- NOTES :
- PACKAGING MATERIAL IN PLASTIC, RUBBER, INK, PIGMENT AND PAINT MUST MEET CONTROLLED SUBSTANCES SPEC PER 230-702.
 - * CADMIUM AND CADMIUM COMPOUNDS NOT TO EXCEED: 5 PPM.
 - * LEAD, CADMIUM, CHROM VI AND MERCURY NOT TO EXCEED: 100 PPM (COMBINED).
 - * CARRIER TAPES, COVER TAPES, REELS AND TAPED COMPONENTS MUST MEET THE REQUIREMENTS DEFINED PER EIA-481-C.
- MATERIAL :
 COVER TAPE : PET, COLOR: TRANSPARENT.
 CARRIER TAPE : POLYSTYRENES, BLACK COLOR.
 REEL : POLYSTYRENES, BLUE COLOR.
 SHIPPING BOX: CORRUGATED FIBER
 - DIMENSION :
 REEL : SEE DRAWING
 SHIPPING BOX : SEE DRAWING
 - QUANTITY : SEE TABLE
 - WEIGHT : SEE TABLE
 - PEELING RESISTANCE : 10gf~130gf
 - PEELING SPEED : 300mm/MINUTES

4.95	6.5	24.0	3.797KG	0.36KG	5000	6	30000	2-2363961-4
4.15	5.7	24.0	3.737KG	0.30KG	5000	6	30000	2-2363962-0
6.15	7.7	16.0	3.857KG	0.42KG	5000	6	30000	3-2363962-0
8.15	9.7	24.0	5.718KG	0.51KG	5000	6	30000	4-2363962-0
DIM C	DIM B	DIM A	GROSS WEIGHT	NET WEIGHT	PCS/ REEL	REEL/ BOX	PCS/ BOX	PART NUMBER

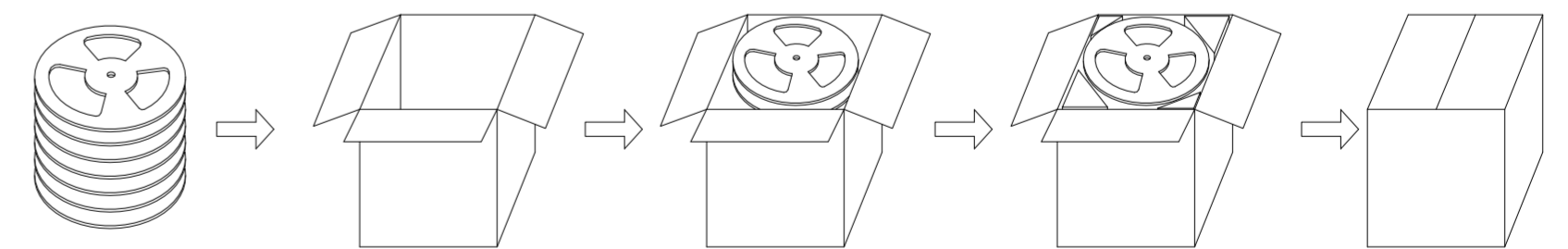

OUT BOX PACKAGE DIAGRAM DRAWING

THIS DRAWING IS A CONTROLLED DOCUMENT.		DWN	26SEP2019	TE TE Connectivity Ltd.	
		H.X			
		CHK	26SEP2019	NAME	
		W.H			
		APVD	-	PRODUCT SPEC	
		-			
		APPLICATION SPEC		SIZE	
		WEIGHT		CAGE CODE	
		CUSTOMER DRAWING		DRAWING NO	
		SCALE		RESTRICTED TO	
		16:1			
		SHEET		REV	
		3 OF 12			
		A1			

P	LTR	DESCRIPTION	DATE	DWN	APVD
-	-	SEE SHEET 1	-	-	-

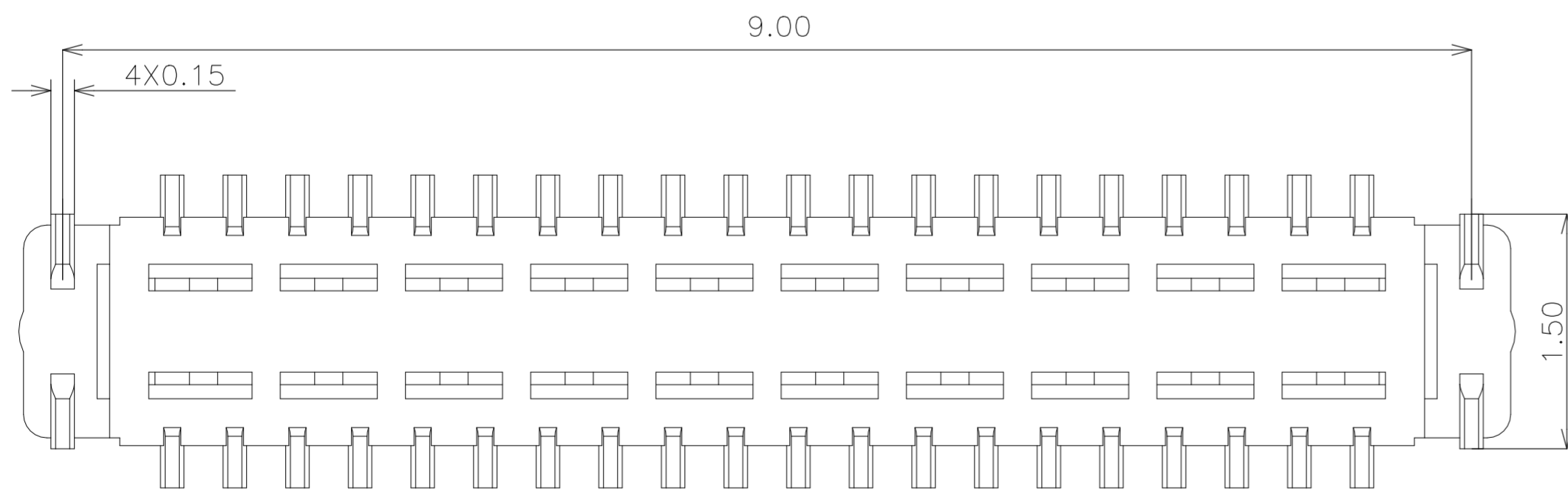
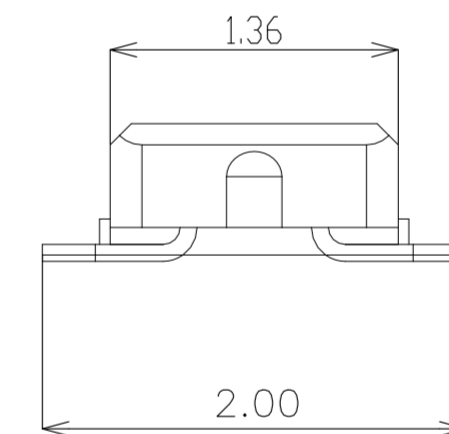
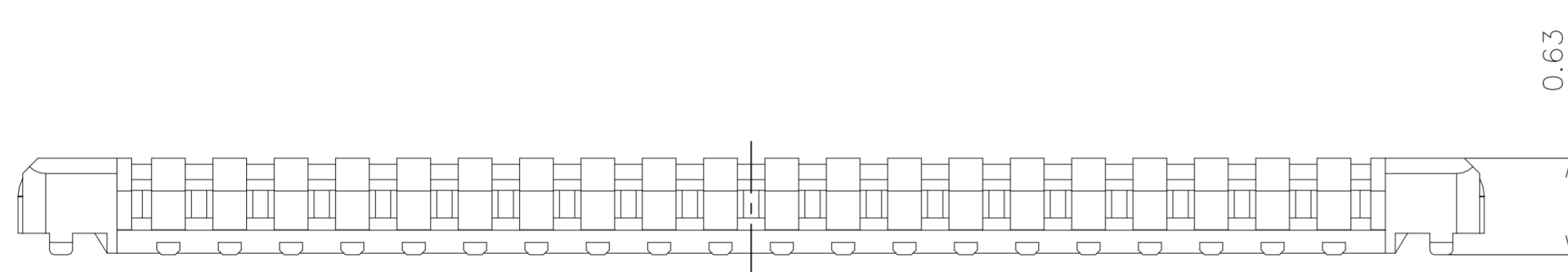
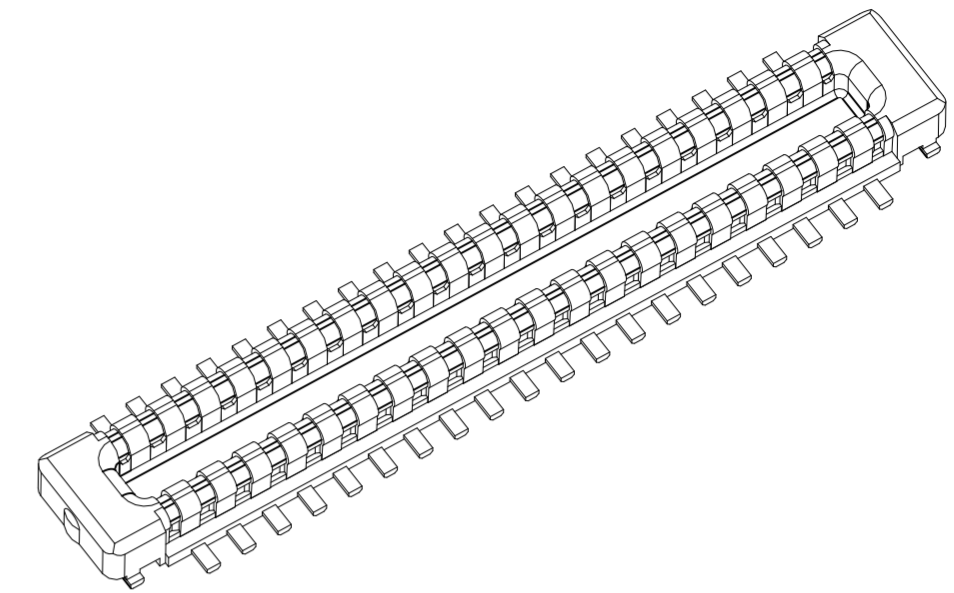
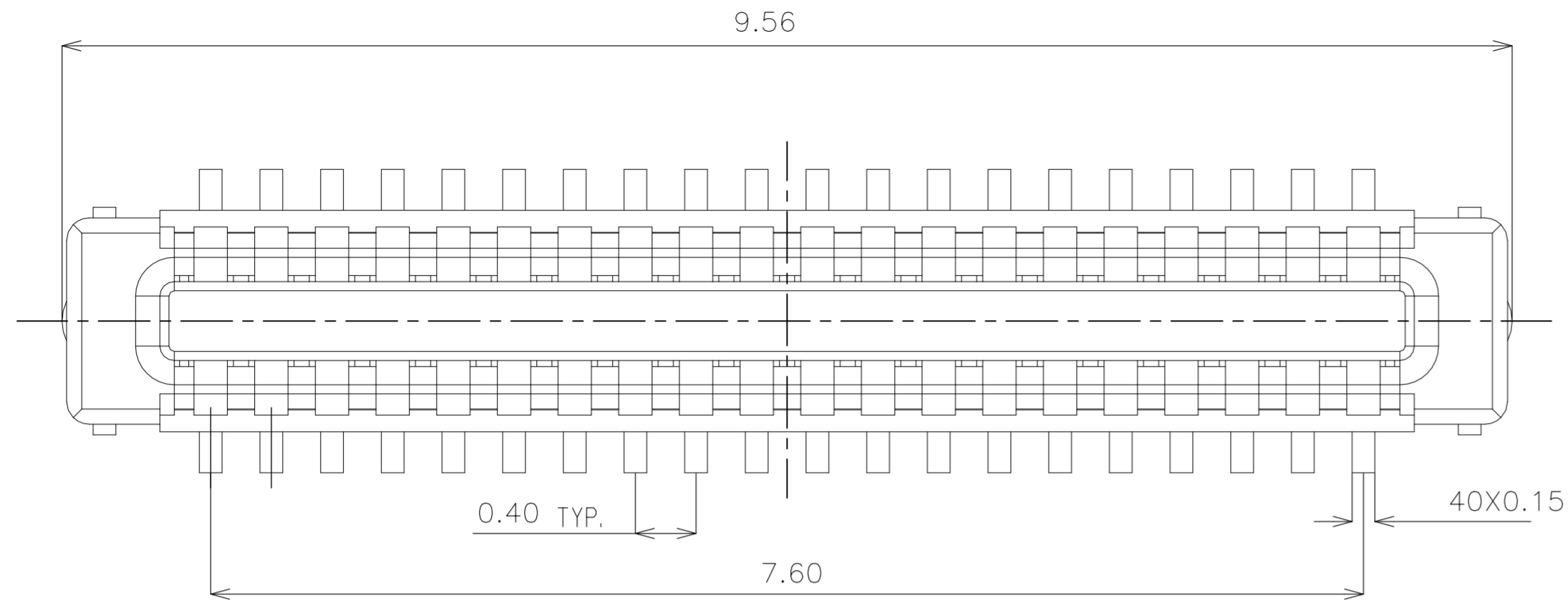

4-2363962-0
PART NUMBER

THIS DRAWING IS A CONTROLLED DOCUMENT.		DWN H.X	26SEP2019	TE Connectivity Ltd.			
		CHK W.H	26SEP2019				
		APVD -	-	NAME			
DIMENSIONS: mm		TOLERANCES UNLESS OTHERWISE SPECIFIED:		PRODUCT SPEC			
		0 PLC	± -	SEE NOTE 5			
		1 PLC	± 0.3	APPLICATION SPEC			
		2 PLC	± 0.20	114-115040			
		3 PLC	± -	SIZE	CAGE CODE	DRAWING NO	RESTRICTED TO
		4 PLC	± -	A2	00779	C=2363962	-
MATERIAL		FINISH		WEIGHT	SCALE		
-		-		-	16:1		
CUSTOMER DRAWING				SHEET	REV		
				4 OF 12	A1		

P	LTR	DESCRIPTION	DATE	DWN	APVD
-	-	SEE SHEET 1	-	-	-

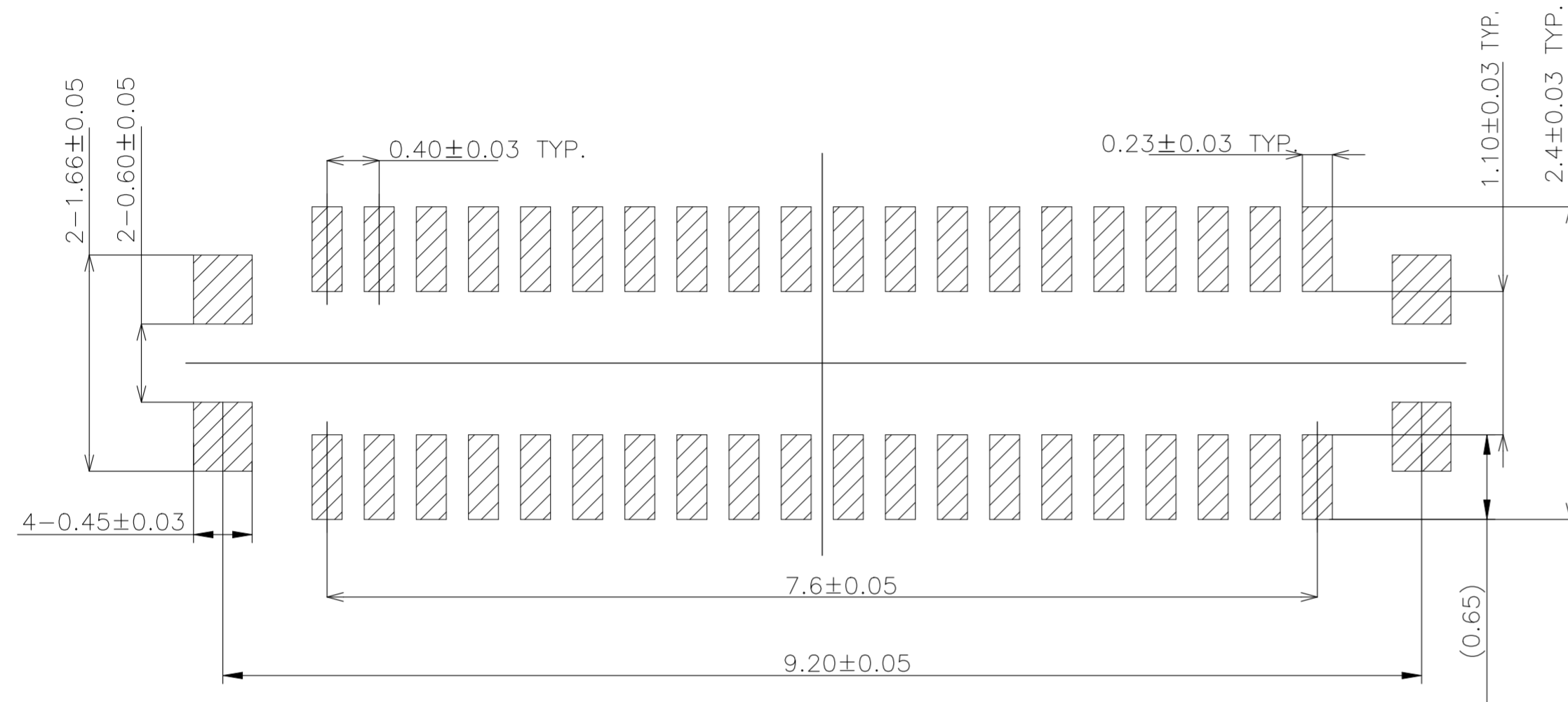

RECOMMENDED P.C.BOARD PATTERN DIMENSION (WITH HOLD DOWN)

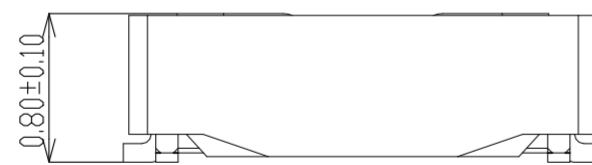

NOTES:

1.MATERIAL:

- 1.1 HOUSING: LCP, UL 94 V-0, COLOR: BLACK.
- 1.2 CONTACT: COPPER ALLOY.
- 1.3 HOLD DOWN: COPPER ALLOY.

2. FINISH:

- 2.1 CONTACT:
GOLD FLASH ON CONTACT AND SOLDERING AREA.
NICKEL UNDER PLATING OVERALL.
- 2.2 HOLD DOWN:
GOLD FLASH PLATING OVER NICKEL UNDER PLATING.

3. REFLOW SOLDER CAPABLE TO 260 °C.

4. MATING PLUG PART NUMBER: 4-2363961-0.

5. PRODUCT SPECIFICATION 108-115166

THIS DRAWING IS A CONTROLLED DOCUMENT.		DWN H.X	26SEP2019	TE TE Connectivity Ltd.	
DIMENSIONS: mm		CHK W.H	26SEP2019		
TOLERANCES UNLESS OTHERWISE SPECIFIED:		APVD -	-	NAME 0.4mm PITCH BTB CONN. H0.8 PLUG ASSEMBLY	
0 PLC ± - 1 PLC ± 0.3 2 PLC ± 0.20 3 PLC ± - 4 PLC ± - ANGLES ± -		PRODUCT SPEC SEE NOTE 5	APPLICATION SPEC 114-115040	SIZE A2	CAGE CODE 00779
MATERIAL -		FINISH -	WEIGHT -	DRAWING NO C=2363962	RESTRICTED TO -
CUSTOMER DRAWING			SCALE 16:1	SHEET 5 OF 12	REV A1

REVISIONS					
P	LTR	DESCRIPTION	DATE	DWN	APVD
-	-	SEE SHEET 1	-	-	-

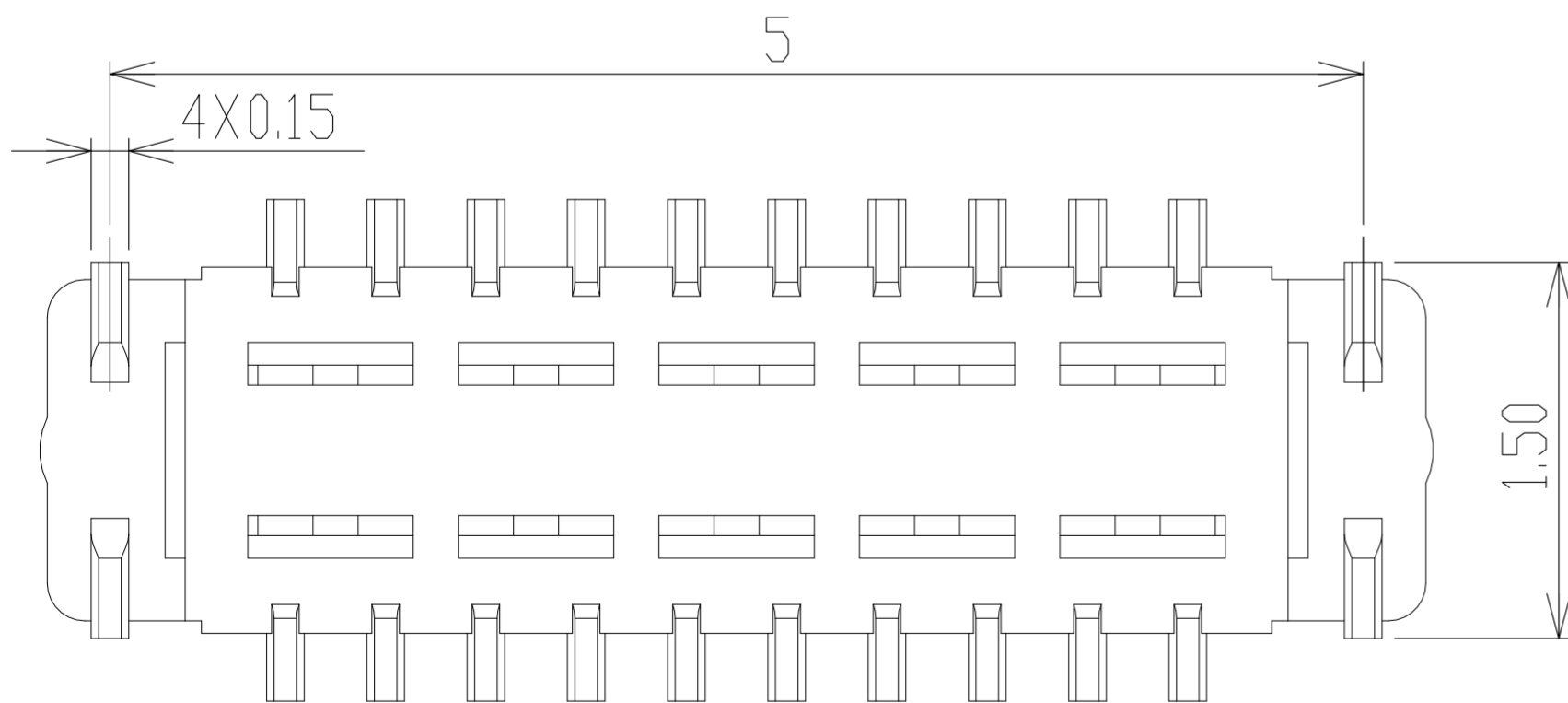
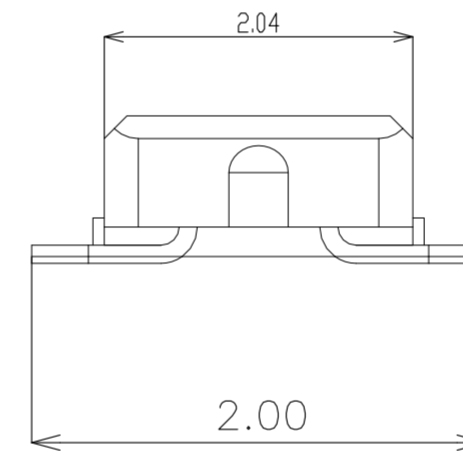
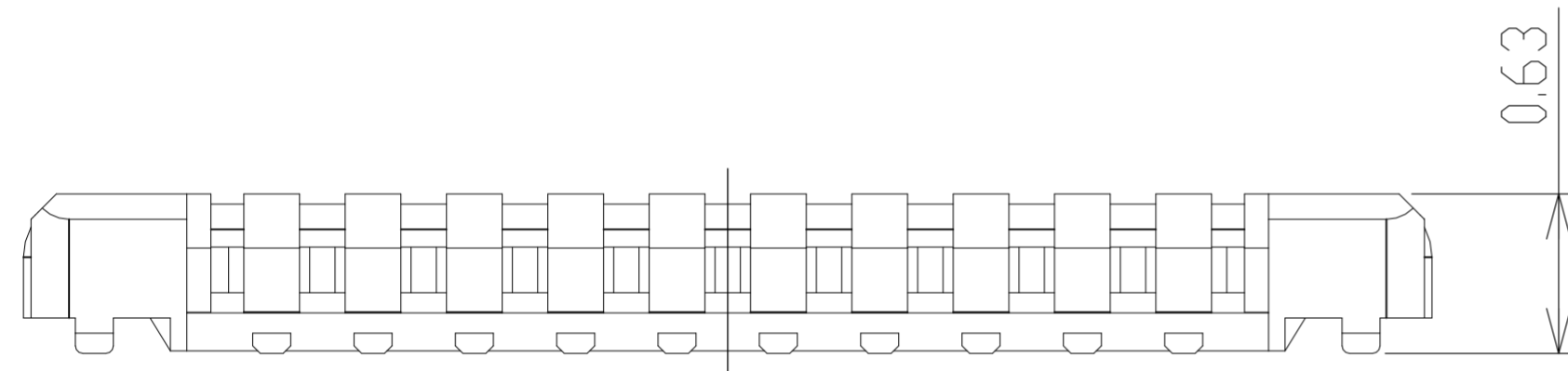
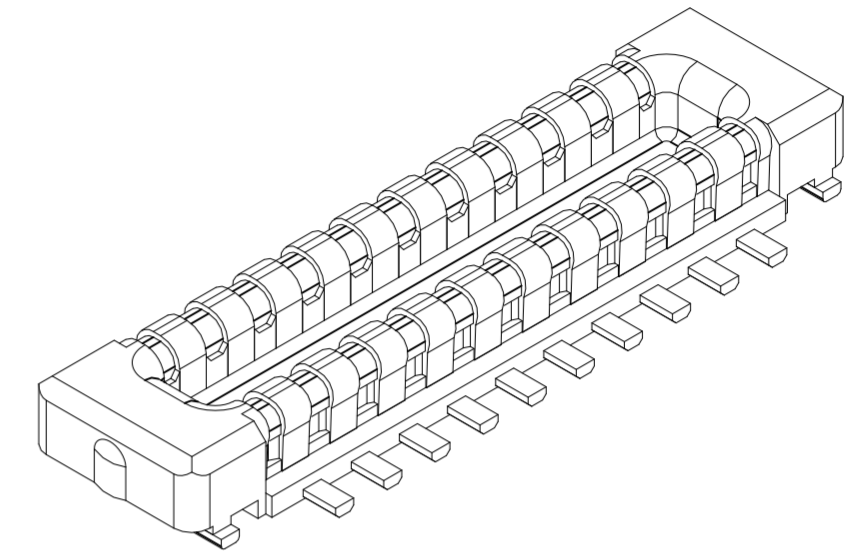
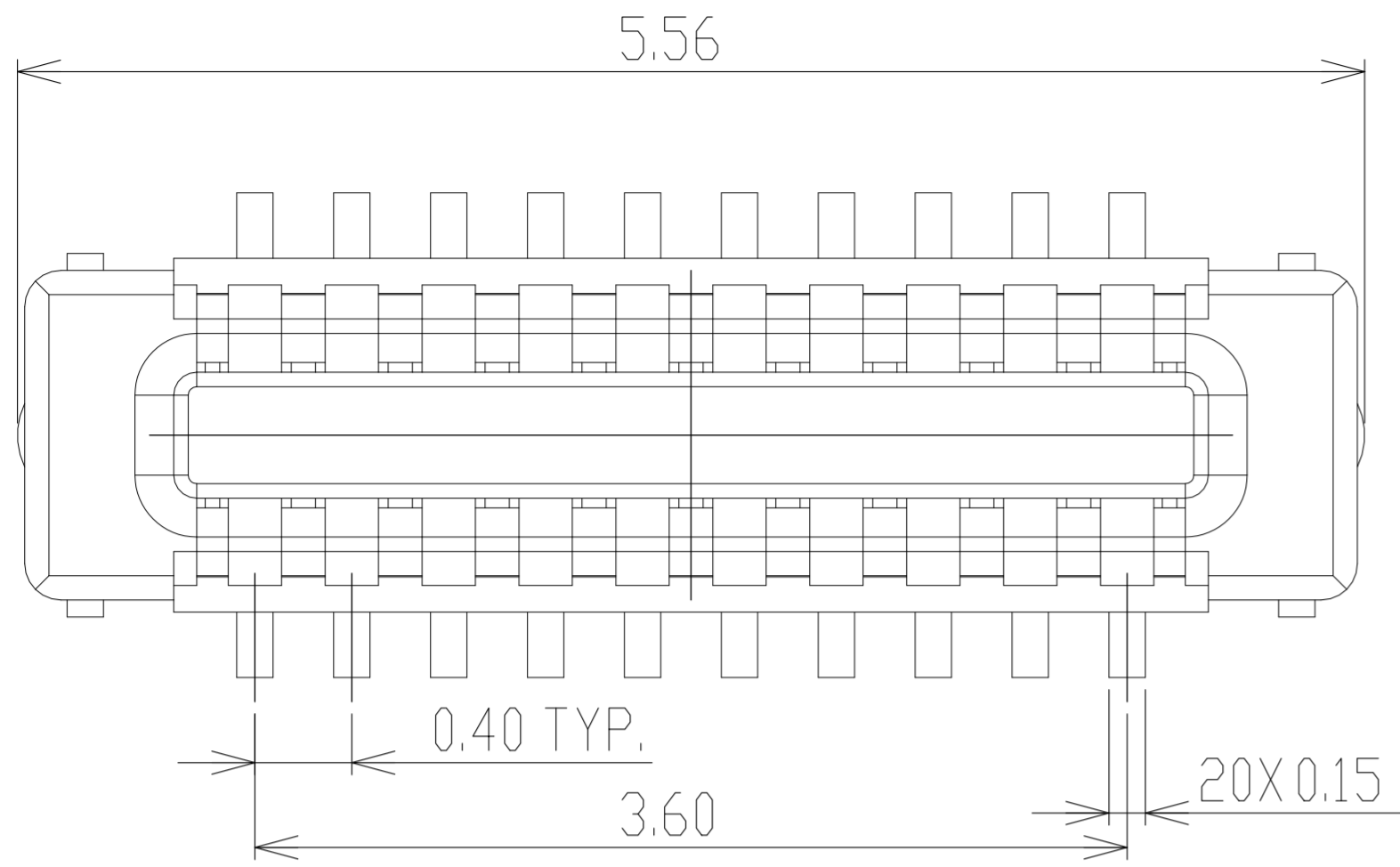

2-2363962-0
PART NUMBER

THIS DRAWING IS A CONTROLLED DOCUMENT.		DWN H.X	26SEP2019	TE Connectivity Ltd.			
		CHK W.H	26SEP2019				
		APVD -	-	NAME			
DIMENSIONS: mm		TOLERANCES UNLESS OTHERWISE SPECIFIED:		PRODUCT SPEC			
		0 PLC	± -	SEE NOTE 5			
		1 PLC	± 0.3	APPLICATION SPEC			
		2 PLC	± 0.20	114-115040			
		3 PLC	± -	SIZE	CAGE CODE	DRAWING NO	RESTRICTED TO
		4 PLC	± -	A2	00779	C=2363962	-
MATERIAL		FINISH		WEIGHT	SCALE		
-		-		-	16:1		
CUSTOMER DRAWING				SHEET	REV		
				7 of 12	A1		

REVISIONS					
P	LTR	DESCRIPTION	DATE	DWN	APVD
-	-	SEE SHEET 1	-	-	-

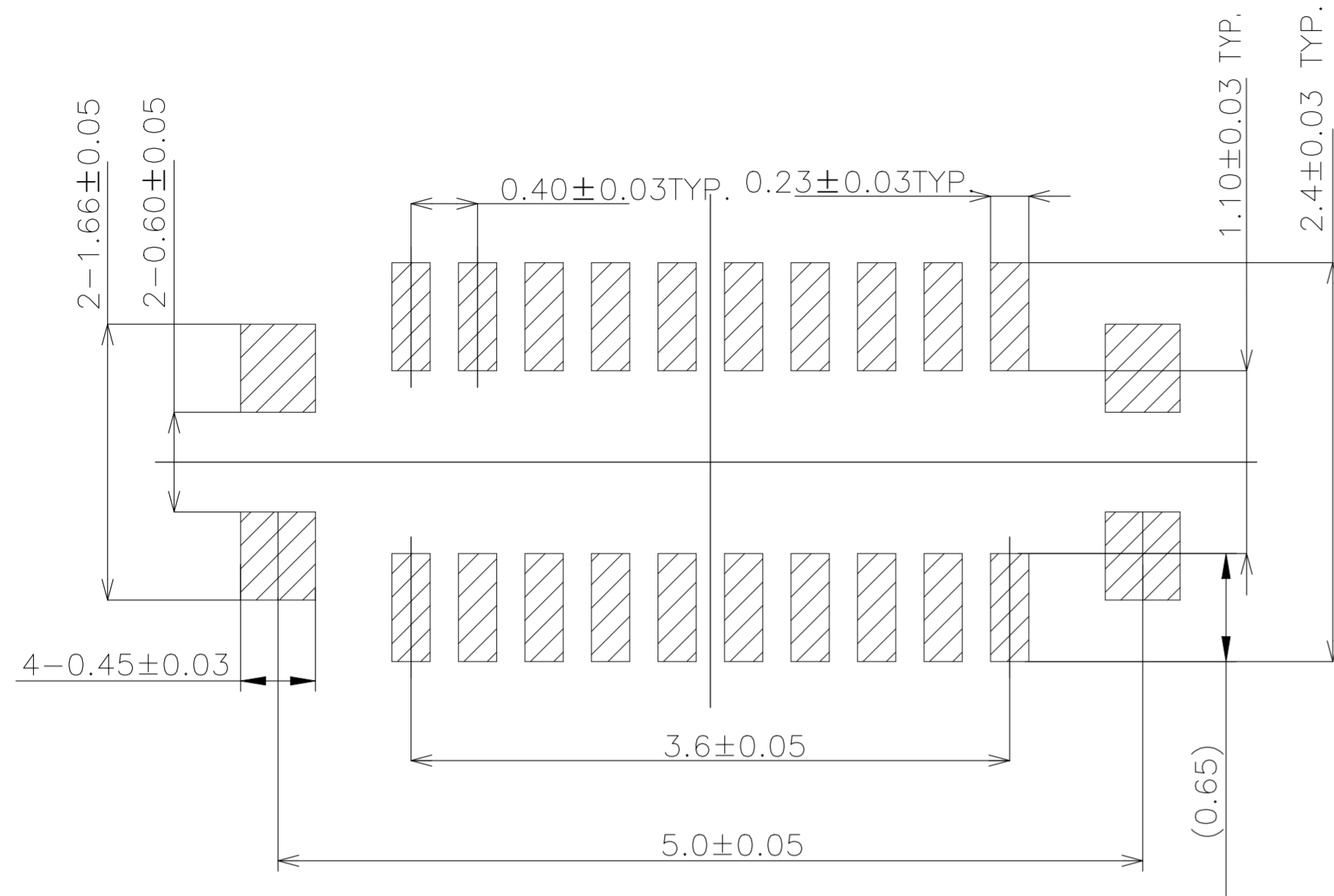

RECOMMENDED P.C. BOARD PATTERN DIMENSION (WITH HOLD DOWN)

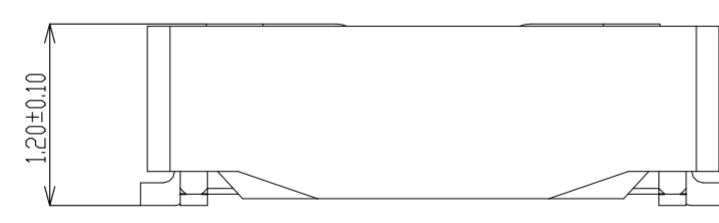

- NOTES:
- MATERIAL:
 - HOUSING: LCP, UL 94 V-0, COLOR: BLACK.
 - CONTACT: COPPER ALLOY.
 - HOLD DOWN: COPPER ALLOY.
 - FINISH:
 - CONTACT: GOLD FLASH ON CONTACT AND SOLDERING AREA. NICKEL UNDER PLATING OVERALL.
 - HOLD DOWN: GOLD FLASH PLATING OVER NICKEL UNDER PLATING.
 - REFLOW SOLDER CAPABLE TO 260 °C.
 - MATING PLUG PART NUMBER: 2-2363961-0.
 - PRODUCT SPECIFICATION 108-161052

THIS DRAWING IS A CONTROLLED DOCUMENT.		DWN H.X	26SEP2019	TE Connectivity Ltd.			
		CHK W.H	26SEP2019				
		APVD -	-	NAME			
DIMENSIONS: mm		TOLERANCES UNLESS OTHERWISE SPECIFIED:		PRODUCT SPEC			
		0 PLC	± -	SEE NOTE 5			
		1 PLC	± 0.3	APPLICATION SPEC			
		2 PLC	± 0.20	114-115040			
		3 PLC	± -	SIZE	CAGE CODE	DRAWING NO	RESTRICTED TO
		4 PLC	± -	A2	00779	C=2363962	-
MATERIAL		FINISH		WEIGHT	SCALE		
-		-		-	16:1		
CUSTOMER DRAWING				SHEET	REV		
				8 OF 12	A1		

2363962

A

REVISIONS					
P	LTR	DESCRIPTION	DATE	DWN	APVD
-	-	SEE SHEET 1	-	-	-

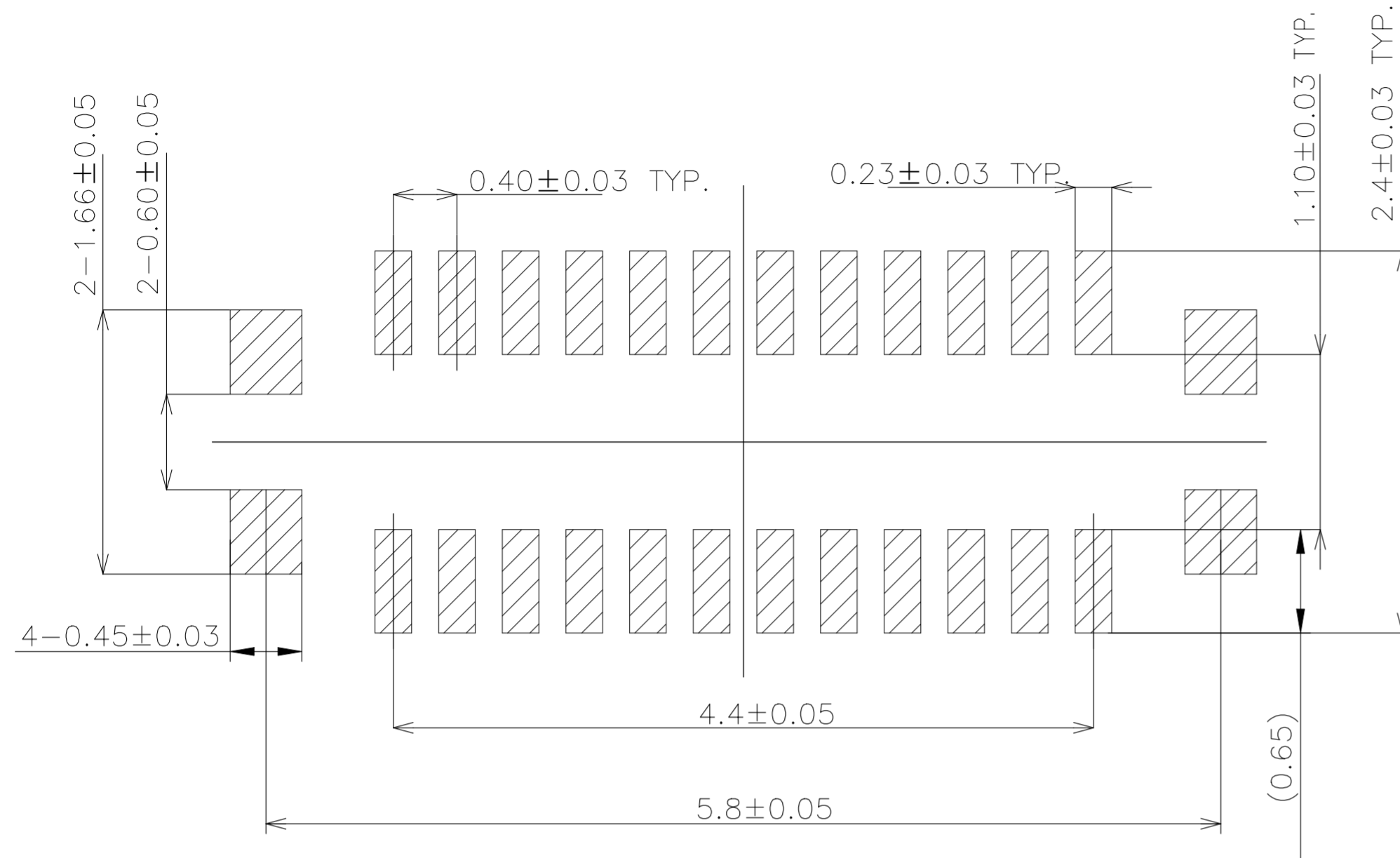

RECOMMENDED P.C.BOARD PATTERN DIMENSION (WITH HOLD DOWN)

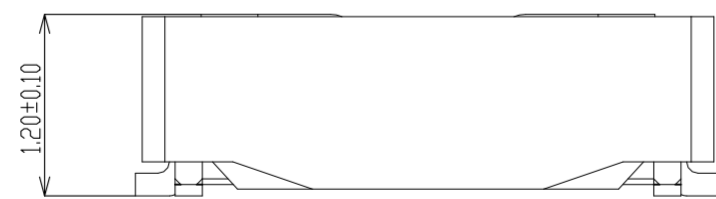

NOTES:

1.MATERIAL:

- 1.1 HOUSING: LCP, UL 94 V-0, COLOR: BLACK.
- 1.2 CONTACT: COPPER ALLOY.
- 1.3 HOLD DOWN: COPPER ALLOY.

2. FINISH:

- 2.1 CONTACT:
GOLD FLASH ON CONTACT AND SOLDERING AREA.
NICKEL UNDER PLATING OVERALL.
- 2.2 HOLD DOWN:
GOLD FLASH PLATING OVER NICKEL UNDER PLATING.

3.REFLOW SOLDER CAPABLE TO 260 °C.

4.MATING PLUG PART NUMBER: 2-2363961-4

5.PRODUCT SPECIFICATION 108-161052

THIS DRAWING IS A CONTROLLED DOCUMENT.		DWN	26SEP2019	TE TE Connectivity Ltd.	
		CHK	26SEP2019		
DIMENSIONS: mm		TOLERANCES UNLESS OTHERWISE SPECIFIED:		NAME	
		0 PLC	± -	0.4mm PITCH BTB CONN.	
		1 PLC	± 0.3	H0.8 PLUG ASSEMBLY	
		2 PLC	± 0.20	-	
		3 PLC	± -	-	
MATERIAL		FINISH		SIZE	CAGE CODE
-		-	-	A2	00779
		APVD		DRAWING NO	RESTRICTED TO
		-		114-115040	-
		PRODUCT SPEC		SCALE	SHEET
		SEE NOTE 5		16:1	11 OF 12
		APPLICATION SPEC		REV	A1
		WEIGHT		CUSTOMER DRAWING	
		-			