

Features:

- General purpose resistor ideal for commercial/industrial applications
- Flame retardant coatings standard
- Flameproof version available as CFF and CFFM
- Panasert available on selected sizes - contact Stackpole
- Auto sequencing/insertion compatible
- CFM (mini) ideal choice when size constraints apply
- Cut and formed products are available on select sizes - contact Stackpole
- Standard lead wire for CF and CFM is copper plated steel, with 100% tin over plate
- 100% tin plate on copper wire is available as type CFQ and CFQM
- RoHS compliant, REACH compliant, lead free and halogen free

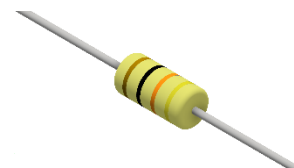

Electrical Specifications - CF, CFQ, PCF								
Type/Code	Size	Power Rating (W) @ 70°C	Maximum Working Voltage (V) ⁽¹⁾	Maximum Overload Voltage (V)	Dielectric Withstanding Voltage (V)	TCR (ppm/°C) per Ohmic Range	Ohmic Range (Ω) and Tolerance	
							2%	5%
CF, CFQ	18	0.125	250	500	350	< 10Ω = ± 400 ppm/°C	10 - 1M	1 - 22M
CF, CFQ, PCF	14	0.25	350	600	350	10Ω to 9.99KΩ = 0 ~ -400 ppm/°C	1 - 1M	1 - 22M
CF, CFQ	12	0.5	350	700	600	10KΩ to 99KΩ = 0 ~ -500 ppm/°C	10 - 1M	1 - 22M
CF, CFQ	1	1	500	1000	600	100KΩ to 999KΩ = 0 ~ -850 ppm/°C	1 - 1M	1 - 10M
CF, CFQ	2	2	500	1000	600	1MΩ and above = 0 ~ -1500 ppm/°C	1 - 1M	1 - 10M

(1) Lesser of $\sqrt{P \cdot R}$ or maximum working voltage.

Electrical Specifications - CFM, CFQM, PCFM								
Type/Code	Size	Power Rating (W) @ 70°C	Maximum Working Voltage (V) ⁽¹⁾	Maximum Overload Voltage (V)	Dielectric Withstanding Voltage (V)	TCR (ppm/°C) per Ohmic Range	Ohmic Range (Ω) and Tolerance	
							2%	5%
CFM, CFQM	14	0.25	250	500	350	< 10Ω = ± 400 ppm/°C	1 - 1M	1 - 10M
CFM, CFQM PCFM	12	0.5	350	600	350	10Ω to 9.99KΩ = 0 ~ -400 ppm/°C 10KΩ to 99KΩ = 0 ~ -500 ppm/°C 100KΩ to 999KΩ = 0 ~ -850 ppm/°C	1 - 1M	1 - 10M
CFM, CFQM	1	1	600	1000	600	1MΩ and above = 0 ~ -1500 ppm/°C	1 - 1M	1 - 10M

(1) Lesser of $\sqrt{P \cdot R}$ or maximum working voltage.

Electrical Specifications - CFF, CFFM								
Type/Code	Size	Power Rating (W) @ 70°C	Maximum Working Voltage (V) ⁽¹⁾	Maximum Overload Voltage (V)	Dielectric Withstanding Voltage (V)	TCR (ppm/°C) per Ohmic Range	Ohmic Range (Ω) and Tolerance	
							2%, 5%	
CFF	18	0.166	200	400	300	< 10Ω = ± 400 ppm/°C	1 - 2.2M	
	14	0.25	300	600	500	10Ω to 9.99KΩ = 0 ~ -400 ppm/°C	1 - 5.1M	
	12	0.5	350	700	500	10KΩ to 99KΩ = 0 ~ -500 ppm/°C	1 - 5.1M	
CFFM	14	0.25	250	500	300	100KΩ to 999KΩ = 0 ~ -850 ppm/°C	1 - 2.2M	
	12	0.5	300	600	500	1MΩ and above = 0 ~ -1500 ppm/°C	1 - 2.2M	

(1) Lesser of $\sqrt{P \cdot R}$ or maximum working voltage.

Mechanical Specifications

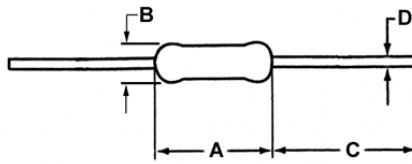

Type/Code	Size	A Body Length	B Body Diameter	C Lead Length (ref.)	D - Lead Diameter	Unit
CF	18	0.130 ± 0.012 3.30 ± 0.30	0.067 ± 0.012 1.70 ± 0.30	1.102 ± 0.118 28.00 ± 3.00	0.016 ± 0.003 0.40 ± 0.08	inches mm
CFQ	18	0.130 ± 0.012 3.30 ± 0.30	0.067 ± 0.012 1.70 ± 0.30	1.102 ± 0.118 28.00 ± 3.00	0.018 ± 0.003 0.45 ± 0.08	inches mm
CFF	18	0.126 ± 0.008 3.20 ± 0.20	0.073 ± 0.008 1.85 ± 0.20	1.102 ± 0.118 28.00 ± 3.00	0.018 ± 0.002 0.45 ± 0.05	inches mm
CF, CFF, CFQ, PCF	14	0.236 ± 0.012 6.00 ± 0.30	0.091 ± 0.012 2.30 ± 0.30	1.102 ± 0.118 28.00 ± 3.00	0.022 ± 0.003 0.55 ± 0.08	inches mm
CFFM	14	0.126 ± 0.008 3.20 ± 0.20	0.073 ± 0.008 1.85 ± 0.20	1.102 ± 0.118 28.00 ± 3.00	0.018 ± 0.002 0.45 ± 0.05	inches mm
CFM	14	0.130 ± 0.012 3.30 ± 0.30	0.067 ± 0.012 1.70 ± 0.30	1.102 ± 0.118 28.00 ± 3.00	0.016 ± 0.003 0.40 ± 0.08	inches mm
CFQM	14	0.130 ± 0.012 3.30 ± 0.30	0.067 ± 0.012 1.70 ± 0.30	1.102 ± 0.118 28.00 ± 3.00	0.018 ± 0.003 0.45 ± 0.08	inches mm
CF	12	0.335 ± 0.039 8.50 ± 1.00	0.106 ± 0.020 2.70 ± 0.50	1.102 ± 0.118 28.00 ± 3.00	0.022 ± 0.003 0.55 ± 0.08	inches mm
CFF, CFQ	12	0.335 ± 0.039 8.50 ± 1.00	0.106 ± 0.020 2.70 ± 0.50	1.102 ± 0.118 28.00 ± 3.00	0.028 ± 0.004 0.70 ± 0.10	inches mm
CFM, CFQM, CFFM	12	0.236 ± 0.012 6.00 ± 0.30	0.091 ± 0.012 2.30 ± 0.30	1.102 ± 0.118 28.00 ± 3.00	0.022 ± 0.003 0.55 ± 0.08	inches mm
CF, CFQ	1	0.433 ± 0.039 11.00 ± 1.00	0.177 ± 0.020 4.50 ± 0.50	1.181 ± 0.118 30.00 ± 3.00	0.031 ± 0.004 0.80 ± 0.10	inches mm
CFM, CFQM	1	0.354 ± 0.020 9.00 ± 0.50	0.138 ± 0.020 3.50 ± 0.50	1.102 ± 0.118 28.00 ± 3.00	0.028 ± 0.002 0.70 ± 0.05	inches mm
CF, CFQ	2	0.591 ± 0.039 15.00 ± 1.00	0.197 ± 0.020 5.00 ± 0.50	1.339 ± 0.157 34.00 ± 4.00	0.031 ± 0.004 0.80 ± 0.10	inches mm

Performance Characteristics							
Test	Test Method	Typical Result			Test Limit		
Current Noise	MIL-STD 202, Method 308	1Ω ~ 91KΩ	100KΩ ~ 910KΩ	1MΩ ~ 22MΩ	1Ω ~ 91KΩ	100KΩ ~ 910KΩ	1MΩ ~ 22MΩ
		0.15μ V/V	0.32μ V/V	0.54μ V/V	0.2μ V/V	0.4μ V/V	0.6μ V/V
Short Time Overload	JIS C5201-1, IEC60115-1, 4.13	ΔR < ±0.25%			ΔR ≤ ±(0.75% + 0.05Ω)		
Resistance to Soldering Heat	JIS C5201-1, IEC60115-1, 4.18	ΔR < ±0.3%			ΔR ≤ ±(0.5% + 0.05Ω)		
Rapid Change of Temperature	JIS C5201-1, IEC60115-1, 4.19	ΔR < ±0.3%			ΔR ≤ ±(1% + 0.05Ω)		
Endurance at 70°C	JIS C5201-1, IEC60115-1, 4.25.1	ΔR < ±1%			R < 100KΩ: ≤ ±(2% + 0.05Ω) R ≥ 100KΩ: ≤ ±(3% + 0.05Ω)		
Terminal Strength	MIL-STD 202, Method 211	ΔR < ±0.2%			ΔR ≤ ±(0.5% + 0.05Ω)		
Damp Heat (Steady state)	JIS C5201-1, IEC60115-1, 4.24	ΔR < ±1.5%			R < 100KΩ: ≤ ±(3% + 0.05Ω) R ≥ 100KΩ: ≤ ±(5% + 0.05Ω)		

Operating temperature range is -55 to +155°C

Power Derating Curve:

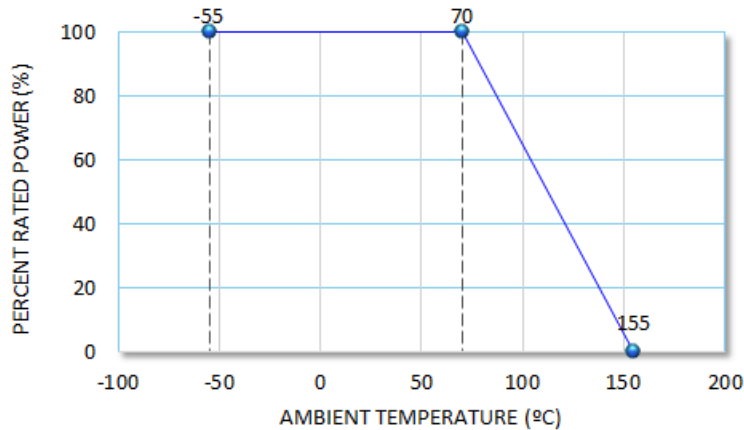

Recommended Resistor Reflow Profile

- Flow Soldering:**
- Pre-heating: 110°C MAX
 - Peak temperature/duration: 260°C within 10 seconds (1st, 2nd wave total)
 - Temperature profile (see chart on the right)

- Iron Soldering:**
- 380°C, 5 seconds, once/terminal

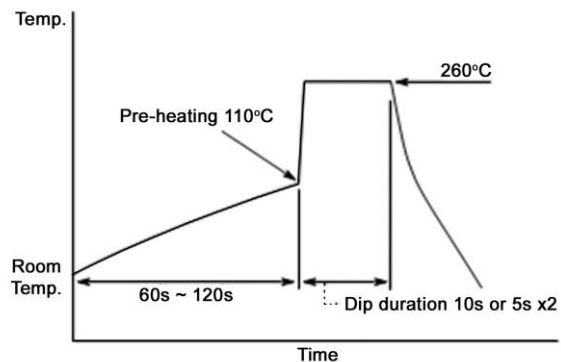

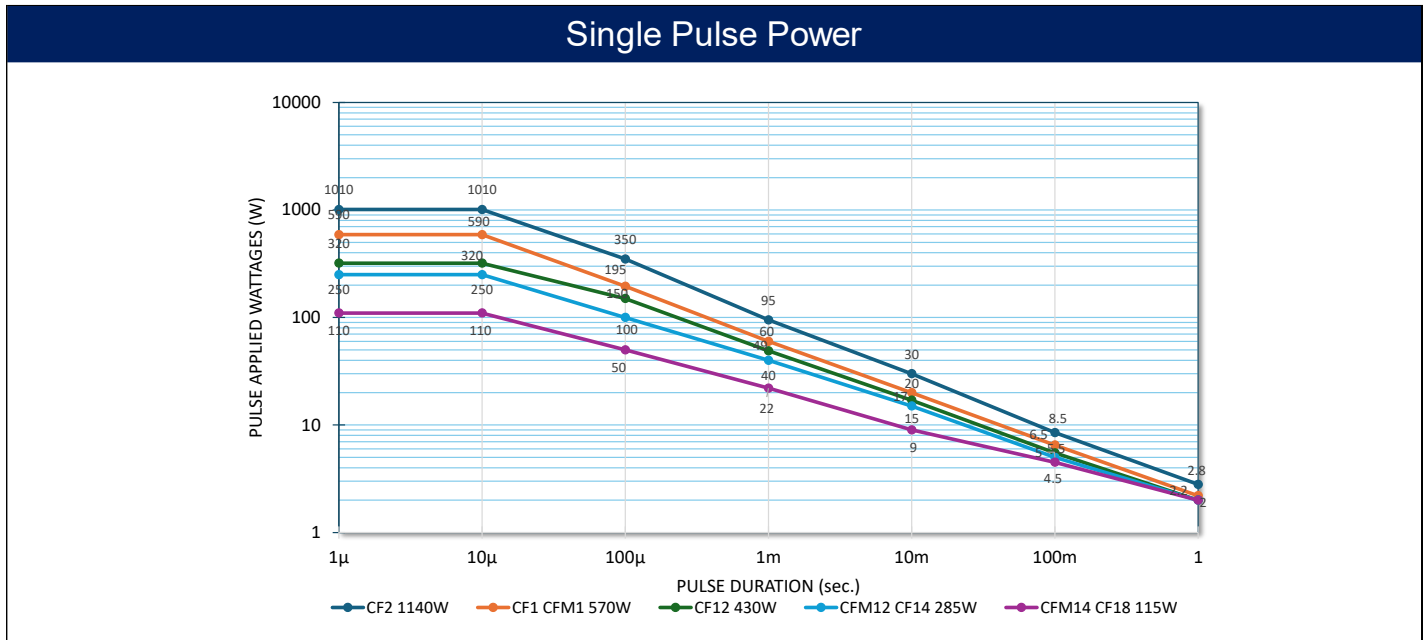

Repetitive Pulse Information

If repetitive pulses are applied to resistors, pulse wave form must be less than “Pulse limiting voltage”, “Pulse limiting current” or “Pulse limiting wattage” calculated by the formula below.

$$V_p = K\sqrt{P \times R \times T/t}$$

$$I_p = K\sqrt{P/R \times T/t}$$

$$P_p = K^2 \times P \times T/t$$

- Where: V_p : Pulse limiting voltage (V)
 I_p : Pulse limiting current (A)
 P_p : Pulse limiting wattage (W)
 P: Power rating (W)
 R: Nominal resistance (ohm)
 T: Repetitive period (sec.)
 t: Pulse duration (sec.)
 K: Coefficient: 0.8
 [Vr: Rated Voltage (V), Ir: Rated Current (A)]

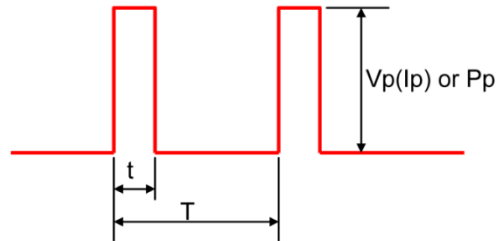

- Note 1: If $T > 10 \rightarrow T = 10$ (sec.), $T / t > 1000 \rightarrow T / t = 1000$.
 Note 2: If $T > 10$ and $T / t > 1000$, “Pulse Limiting power (single pulse) is applied.”
 Note 3: If $V_p < V_r$ ($I_p < I_r$ or $P_p < P$), V_r (I_r, P) is V_p (I_p, P_p).
 Note 4: Pulse limiting voltage (Current, Wattage) is applied at less than rated ambient temperature. If ambient temperature is more than the rated temperature (70°C), please decrease power rating according to “Power Derating Curve”.
 Note 5: Please assure sufficient margin for use period and conditions for “Pulse limiting voltage”.
 Note 6: If the pulse waveform is not square wave, please judge after transform the waveform into square wave according to the “Waveform Transformation to Square Wave”.

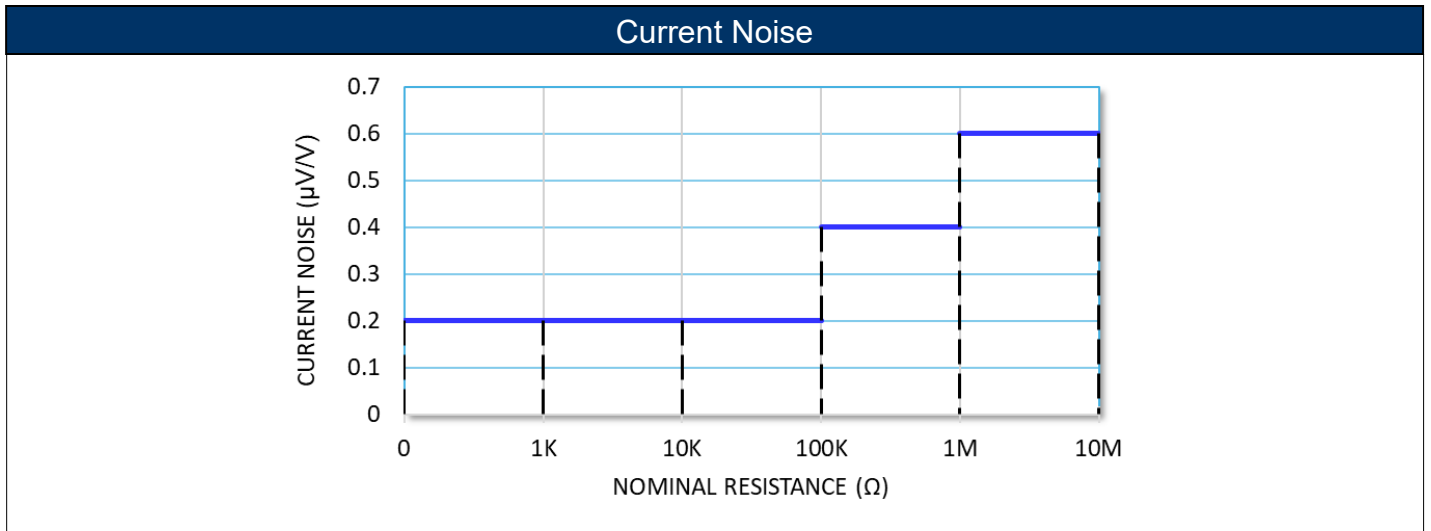

Component Flammability				
Product Type	Size	Total Polymer Mass (mg)	Polymer Type	IEC 695-2-2
CF	18	2.94	Epoxy	Meets specification
	14	6.77		
	12	8.57		
	1	9.98		
	2	11.35		
CFQ	18	2.94		
	14	6.77		
	12	8.57		
	1	9.98		
	2	11.35		
PCF	14	6.77		
CFM	14	2.94		
	12	6.77		
	1	8.57		
CFQM	14	2.94		
	12	6.77		
	1	8.57		
PCFM	12	6.77		
CFF	18	1.75		
	14	4.12		
	12	4.92		
CFFM	14	4.12		
	12	4.92		

Waveform Transformation to Square Wave

1. Discharge curve wave with time constant "t" → Square wave

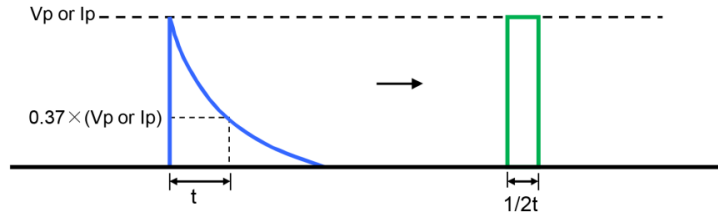

2. Damping oscillation wave with time constant of envelope "t" → Square wave

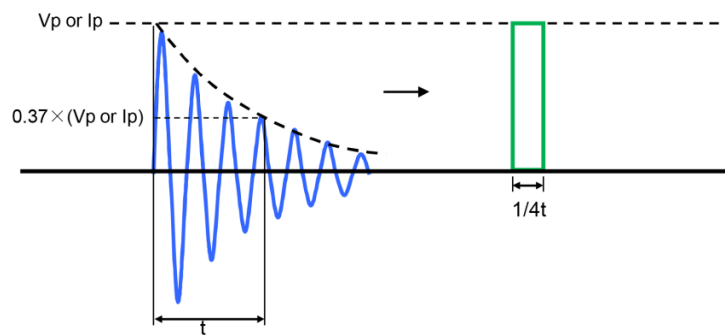

3. Half-wave rectification wave → Square wave

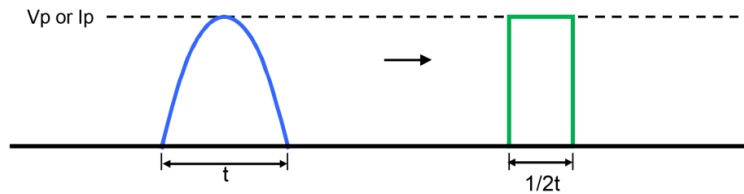

4. Triangular wave → Square wave

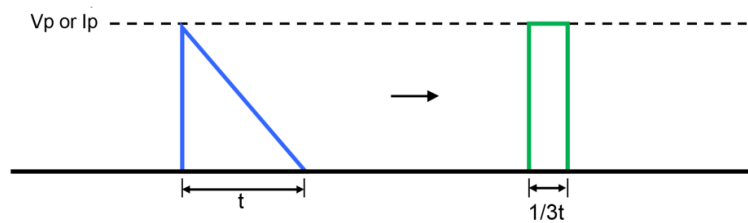

5. Special wave → Square wave

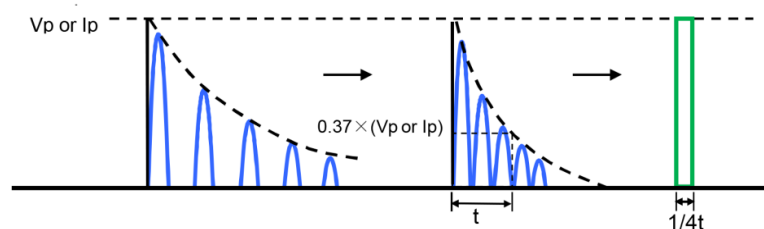

Reel Specifications

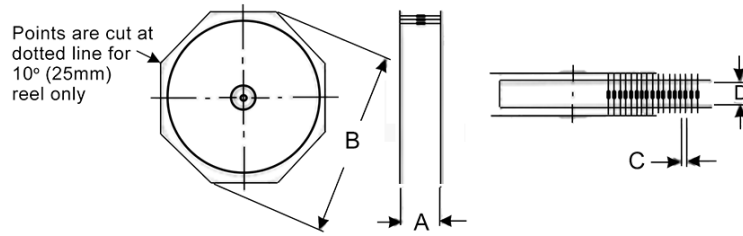

Type/Code	Size	Class	Tape	A Max ⁽¹⁾	B Max	C	D	Unit
CF, CFQ	18	I	0.250 6.35	2.508 63.70	13.504 343.00	0.197 ± 0.020 5.00 ± 0.50	2.063 ± 0.079 52.40 ± 2.00	inches mm
CFF	18	I	0.250 6.35	2.508 63.70	13.504 343.00	0.197 ± 0.020 5.00 ± 0.50	2.063 ± 0.079 52.40 ± 2.00	inches mm
CF, CFQ, CFF	14	I	0.250 6.35	2.638 67.00	13.504 343.00	0.197 ± 0.020 5.00 ± 0.50	2.063 ± 0.079 52.40 ± 2.00	inches mm
CF, CFQ, CFF	12	I	0.250 6.35	2.736 69.50	13.504 343.00	0.197 ± 0.020 5.00 ± 0.50	2.063 ± 0.079 52.40 ± 2.00	inches mm
CF, CFQ	1	I	0.250 6.35	2.972 75.50	13.504 343.00	0.197 ± 0.020 5.00 ± 0.50	2.063 ± 0.079 52.40 ± 2.00	inches mm
CF, CFQ	2	I	0.250 6.35	3.130 79.50	13.504 343.00	0.394 ± 0.020 10.00 ± 0.50	2.063 ± 0.079 52.40 ± 2.00	inches mm
CFM, CFQM, CFFM	14	I	0.250 6.35	2.508 63.70	13.504 343.00	0.197 ± 0.020 5.00 ± 0.50	2.063 ± 0.079 52.40 ± 2.00	inches mm
CFM, CFQM, CFFM	12	I	0.250 6.35	2.638 67.00	13.504 343.00	0.197 ± 0.020 5.00 ± 0.50	2.063 ± 0.079 52.40 ± 2.00	inches mm
CFM, CFQM	1	I	0.250 6.35	2.736 69.50	13.504 343.00	0.197 ± 0.020 5.00 ± 0.50	2.063 ± 0.079 52.40 ± 2.00	inches mm

Packaging is per EIA-296.

Ammo Packaging Specifications

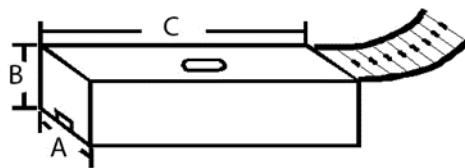

Type/Code	Size	A	B	C	Unit
CF, CFQ	16	2.953 ± 0.079 75.00 ± 2.00	2.756 ± 0.118 70.00 ± 3.00	10.039 ± 0.197 255.00 ± 5.00	inches mm
CF, CFQ	14	2.953 ± 0.079 75.00 ± 2.00	3.937 ± 0.118 100.00 ± 3.00	10.039 ± 0.197 255.00 ± 5.00	inches mm
CF, CFQ	12	2.953 ± 0.079 75.00 ± 2.00	2.756 ± 0.118 70.00 ± 3.00	10.039 ± 0.197 255.00 ± 5.00	inches mm
CFQ	2	2.953 ± 0.079 75.00 ± 2.00	3.543 ± 0.118 90.00 ± 3.00	10.039 ± 0.197 255.00 ± 5.00	inches mm

Ammo Packaging Specifications (cont.)

Type/Code	Size	A	B	C	Unit
CFM, CFQM	14	2.953 ± 0.079 75.00 ± 2.00	2.756 ± 0.118 70.00 ± 3.00	10.039 ± 0.197 255.00 ± 5.00	inches mm
CFM, CFQM	12	2.953 ± 0.079 75.00 ± 2.00	3.937 ± 0.118 100.00 ± 3.00	10.039 ± 0.197 255.00 ± 5.00	inches mm
CFQ, CFQM	1	2.953 ± 0.079 75.00 ± 2.00	2.953 ± 0.118 75.00 ± 3.00	10.039 ± 0.197 255.00 ± 5.00	inches mm

Radial Lead Taping Specifications (Pana-Sert PCF14)

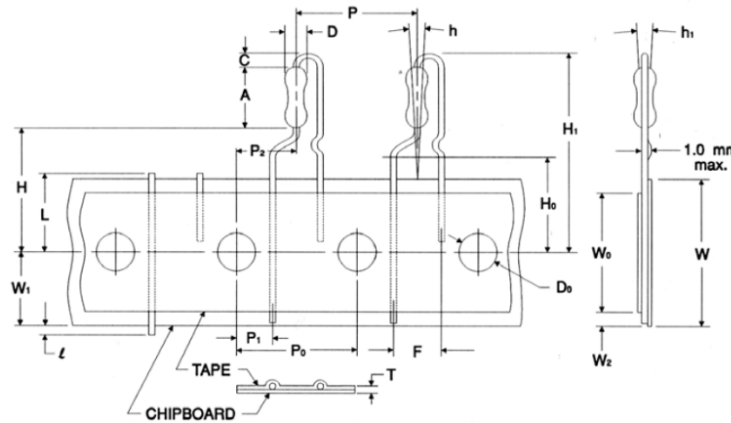

Symbol	Description	PANA-SERT	Unit	Symbol	Description	PANA-SERT	Unit
A	Resistor body length	0.256 ± 0.020 6.50 ± 0.50	inches mm	L	Cutout Length	0.433 max. 11.00 max.	inches mm
C	Height of bending	0.098 ± 0.020 2.50 ± 0.50	inches mm	P	Resistor pitch	0.500 ± 0.039 12.70 ± 1.00	inches mm
D	Resistor body diameter	0.091 ± 0.008 2.30 ± 0.20	inches mm	P ₀	Sprocket-hole pitch	0.500 ± 0.012 12.70 ± 0.30	inches mm
D ₀	Sprocket-hole diameter	0.157 ± 0.012 4.00 ± 0.30	inches mm	P ₁	Sprocket-hole center to lead center	0.152 ± 0.028 3.85 ± 0.70	inches mm
F	Resistor lead spacing	0.197 ± 0.039 5.00 ± 1.00	inches mm	P ₂	Sprocket-hole center to resistor center	0.250 ± 0.051 6.35 ± 1.30	inches mm
H	Height to bottom of resistor	0.748 ± 0.039 19.00 ± 1.00	inches mm	T	Thickness (chipboard and tape)	0.028 ± 0.008 0.70 ± 0.20	inches mm
H ₀	Height to lead clinch	0.630 ± 0.020 16.00 ± 0.50	inches mm	W	Chipboard width	0.709 +0.039 / -0.020 18.00 +1.00 / -0.50	inches mm
H ₁	Height of resistor	1.122 max. 28.50 max.	inches mm	W ₀	Hold-down tape width	0.49 min. 12.50 min.	inches mm
h	Resistor alignment	0 ± 0.079 (0 ± 5°) 0 ± 2.00 (0 ± 5°)	inches mm	W ₁	Sprocket-hole position	0.354 +0.030 / -0.020 9.00 +0.75 / -0.50	inches mm
h ₁	Resistor alignment	0 ± 0.079 (0 ± 5°) 0 ± 2.00 (0 ± 5°)	inches mm	W ₂	Hold-down tape position	0.118 max. 3.00 max.	inches mm
l	Lead protrusion	0.079 max. 2.00 max.	inches mm				

Surface Temperature Rise

Measurement Point

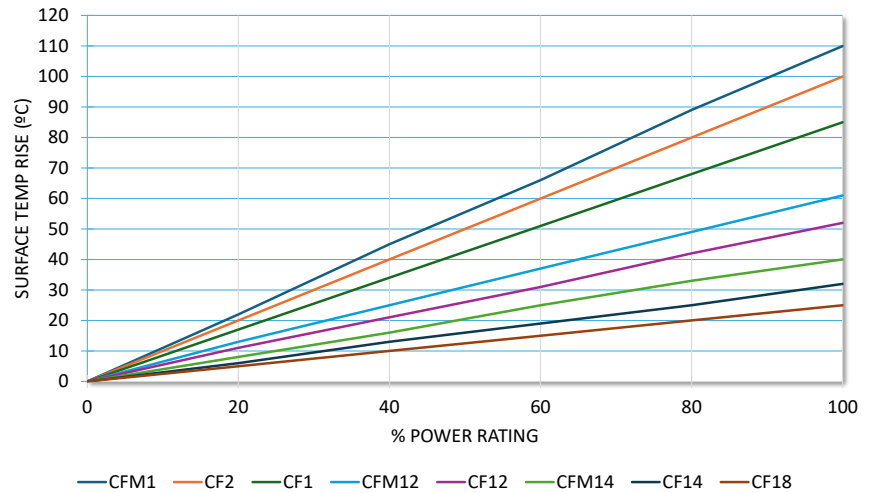
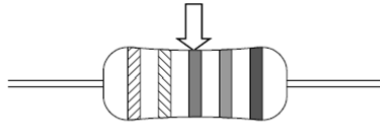

Standard Color Codes

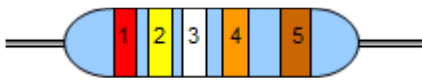

PRECISION - Have three significant-figure bands, a multiplier band, and a tolerance band.
Tolerances 1% or less.

GENERAL PURPOSE - Have two significant-figure bands, a multiplier band, and a tolerance band.
Tolerances 2% or greater.

Color	Nominal	Multiplier	Tolerance (%)
Black	0	1	-
Brown	1	10	1
Red	2	100	2
Orange	3	1K	-
Yellow	4	10K	-
Green	5	100K	0.5
Blue	6	1000K	0.25
Violet	7	-	0.1
Gray	8	-	-
White	9	0.001	-
Silver	-	0.01	10
Gold	-	0.1	5

COLOR BAND DESCRIPTION

BAND	PRECISION	GENERAL PURPOSE
1st band	Nominal	Nominal
2nd band	Nominal	Nominal
3rd band	Nominal	Multiplier
4th band	Multiplier	Tolerance
5th band	Tolerance	-

RoHS Compliance

Stackpole Electronics has joined the worldwide effort to reduce the amount of lead in electronic components and to meet the various regulatory requirements now prevalent, such as the European Union's directive regarding "Restrictions on Hazardous Substances" (RoHS 3). As part of this ongoing program, we periodically update this document with the status regarding the availability of our compliant components. All our standard part numbers are compliant to EU Directive 2011/65/EU of the European Parliament as amended by Directive (EU) 2015/863/EU as regards the list of restricted substances.

RoHS Compliance Status				
Standard Product Series	Description	Package/Termination Type	Standard Series RoHS Compliant	Lead-Free Termination Composition
CF	Carbon Film Leaded Resistor	Axial	YES	100% Matte Sn
CFM	Carbon Film Resistor (Mini)	Axial	YES	100% Matte Sn
CFF	Carbon Film Resistor (Flameproof)	Axial	YES	100% Matte Sn
CFFM	Carbon Film Resistor (Flameproof - mini)	Axial	YES	100% Matte Sn
PCF	Carbon Film Resistor (Panaset CF14)	Axial	YES	100% Matte Sn
PCFM	Carbon Film Resistor (Panaset CFM12)	Axial	YES	100% Matte Sn
CFQ	Carbon Film Resistor (Tin Plating on Copper Wire)	Axial	YES	100% Matte Sn
CFQM	Carbon Film Resistor (Tin Plating Mini on Copper Wire)	Axial	YES	100% Matte Sn
PCFQ	Carbon Film Resistor (Tin Plating on Copper Wire - Panaset)	Axial	YES	100% Matte Sn

"Conflict Metals" Commitment

We at Stackpole Electronics, Inc. are joined with our industry in opposing the use of metals mined in the "conflict region" of the eastern Democratic Republic of the Congo (DRC) in our products. Recognizing that the supply chain for metals used in the electronics industry is very complex, we work closely with our own suppliers to verify to the extent possible that the materials and products we supply do not contain metals sourced from this conflict region. As such, we are in compliance with the requirements of Dodd-Frank Act regarding Conflict Minerals.

Compliance to "REACH"

We certify that all passive components supplied by Stackpole Electronics, Inc. are SVHC (Substances of Very High Concern) free and compliant with the requirements of EU Directive 1907/2006/EC, "The Registration, Evaluation, Authorization and Restriction of Chemicals", otherwise referred to as REACH. Contact us for complete list of REACH Substance Candidate List.

Environmental Policy

It is the policy of Stackpole Electronics, Inc. (SEI) to protect the environment in all localities in which we operate. We continually strive to improve our effect on the environment. We observe all applicable laws and regulations regarding the protection of our environment and all requests related to the environment to which we have agreed. We are committed to the prevention of all forms of pollution.

How to Order



Product Series		Power Rating		Tolerance		Packaging			Resistance Value	
Code	Description	Code	W	Code	Tol	Code	Description	Product Code	Qty	Four characters with the multiplier used as the decimal holder. 10 ohm = 10R0 10.2 Kohm = 10K2 1 Mohm = 1M00
CF	Standard	18	0.125	G	2%	T	Tape and Reel	CF18, CFQ18, CFF18	5000	
CFM	Mini	CFF18	0.166	J	5%			CF14, CFM14, CFF14, CFFM14		
CFF	Flameproof	14	0.25					CFQ14, CFQM14		
CFFM	Flameproof (mini)	12	0.5					CF12, CFM12, CFF12, CFFM12		
PCF	Panasert CF14	1	1				CFQ12, CFQM12			
PCFM	Panasert CFM12	2	2				CFM1, CFQM1, PCF14, PCFM12	2500		
CFQ	Tin plating on copper wire						CF1, CFQ1	2000		
CFQM	Tin plating (mini)						CF2, CFQ2	1000		
PCFQ	Tin plating on copper wire Panasert					A	Ammo	CF18, CFQ18, CFF18	5000	
								CF14, CFF14, CFFM14, CFM14		
							CFQ14, CFQM14	2000		
							CFM12, CFFM12, CFQM12			
						CF12, CFF12, CFQ12, PCFM12	1000			
						CFM1, CFQM1				
						PCF14				
						CF1, CFQ1, CF2				