

PC QUICK-FIT MALE TERMINALS



Underwriters Laboratories, Inc. Recognized Component Program — UL File Number E201546



UL file number E201546 has been assigned to Keystone Electronics' "Quick-Fit" terminals (Refer to pages 52-54) indicating recognition by Underwriters Laboratories Inc. that they are in compliance with their component program.

Underwriters Laboratories Inc. component program assures that "Quick-Fit" terminals meet the dimensional and performance requirements of the National Electrical Manufacturers Association specification number NEMA2-1982-(1988) and UL310.

.250 (6.4) MALE TAB INSERTION TOOL

Designed to install .250 (6.4) male "Quick-Fit" terminals quickly and easily.

- Insert terminal into slot, spring clip will hold terminal securely for positioning
- Align terminal with mounting holes and "press-fit" to secure firmly in place
- Lift tool to release terminal

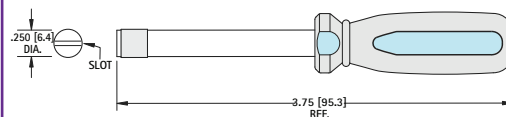

CAT. NO. 1288

.110 (2.8) TAB

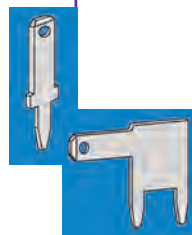
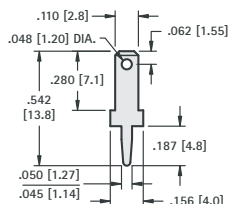

.110 (2.8) TAB

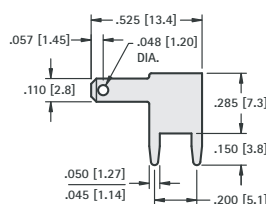

.187 (4.8) TAB

STURDI-MOUNT

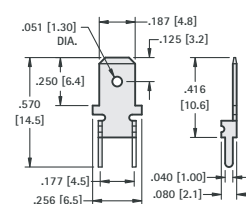

| CAT. NO. | MATERIAL | MTG. HOLE |
|----------|-----------------------------|-----------------|
| 1267 | .020 (.50) Brass, Tin Plate | .046 (1.2) Dia. |
| 1211 | .032 (.80) Brass, Tin Plate | .052 (1.3) Dia. |

| CAT. NO. | MATERIAL | MTG. HOLES |
|----------|-----------------------------|-----------------|
| 4903 | .020 (.50) Brass, Tin Plate | .046 (1.2) Dia. |
| 4906 | .032 (.80) Brass, Tin Plate | .052 (1.3) Dia. |

| CAT. NO. | MATERIAL | MTG. HOLES |
|----------|-----------------------------|-----------------|
| 4900 | .020 (.50) Brass, Tin Plate | .043 (1.1) Dia. |

.187 (4.8) TAB

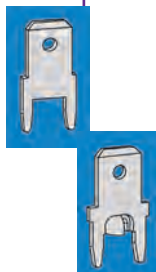
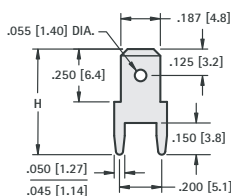

.187 (4.8) TAB

STURDI-MOUNT

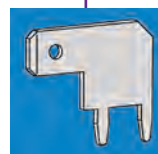
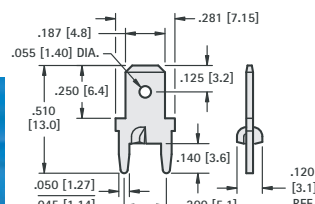

.187 (4.8) TAB

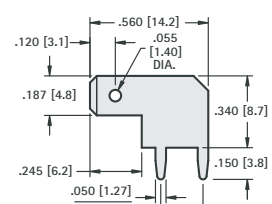

Material: Brass, Tin Plate

| CAT. NO. | H | MATL THICK | MTG. HOLES |
|----------|-------------|------------|-----------------|
| 1285 | .500 (12.7) | .020 (.50) | .046 (1.2) Dia. |
| 1212 | .500 (12.7) | .032 (.80) | .052 (1.3) Dia. |
| 1216 | .860 (21.8) | .032 (.80) | .052 (1.3) Dia. |

| CAT. NO. | MATERIAL | MTG. HOLES |
|----------|-----------------------------|-----------------|
| 1285-ST | .020 (.50) Brass, Tin Plate | .046 (1.2) Dia. |
| 1212-ST | .032 (.80) Brass, Tin Plate | .052 (1.3) Dia. |

| CAT. NO. | MATERIAL | MTG. HOLES |
|----------|-----------------------------|-----------------|
| 4904 | .020 (.50) Brass, Tin Plate | .046 (1.2) Dia. |
| 4907 | .032 (.80) Brass, Tin Plate | .052 (1.3) Dia. |

.205 (5.2) TAB

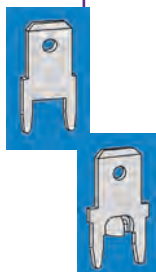
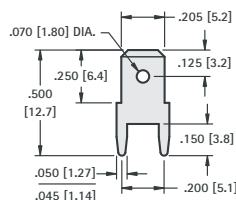

.205 (5.2) TAB

STURDI-MOUNT

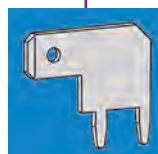
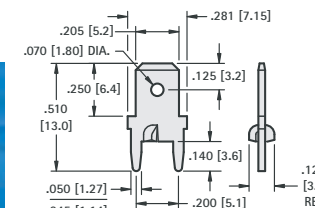

.205 (5.2) TAB

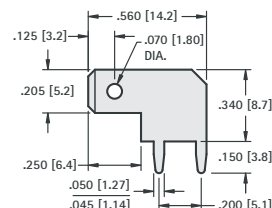

| CAT. NO. | MATERIAL | MTG. HOLES |
|----------|-----------------------------|-----------------|
| 1286 | .020 (.50) Brass, Tin Plate | .046 (1.2) Dia. |
| 1213 | .032 (.80) Brass, Tin Plate | .052 (1.3) Dia. |

| CAT. NO. | MATERIAL | MTG. HOLES |
|----------|-----------------------------|-----------------|
| 1286-ST | .020 (.50) Brass, Tin Plate | .046 (1.2) Dia. |
| 1213-ST | .032 (.80) Brass, Tin Plate | .052 (1.3) Dia. |

| CAT. NO. | MATERIAL | MTG. HOLES |
|----------|-----------------------------|-----------------|
| 4905 | .020 (.50) Brass, Tin Plate | .046 (1.2) Dia. |
| 4909 | .032 (.80) Brass, Tin Plate | .052 (1.3) Dia. |