

10 9 8 7 6 5 4 3 2 1

NOTES:

1. MATERIALS:
HOUSING - LIQUID CRYSTAL POLYMER (LCP),
UL94 V-0, COLOR: BLACK.
TERMINAL - COPPER ALLOY
2. FINISH: 30 μ IN MIN. GOLD ON MATING SURFACE;
MATTE TIN ON TAILS; NICKEL UNDERPLATE.
3. FINISH: 50 μ IN MIN. GOLD ON MATING SURFACE;
MATTE TIN ON TAILS; NICKEL UNDERPLATE.
4. THIS PART CONFORMS TO PRODUCT SPECIFICATION
PS-74031-999.
5. SINGLE ROW ASSEMBLY PACKED PER PK-70873-0876.
6. MATES WITH 75885 SERIES DAUGHTERCARD POWER ASSEMBLY.
7. MATING INTERFACE MEASURED FROM BOTTOM OF HOUSING.

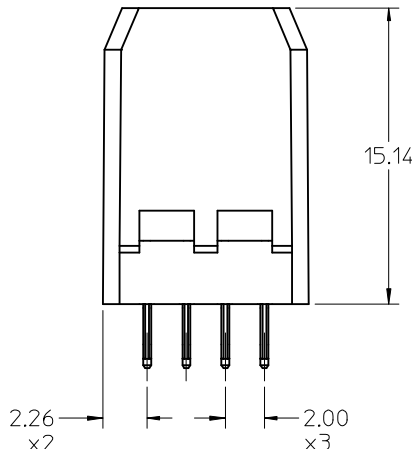
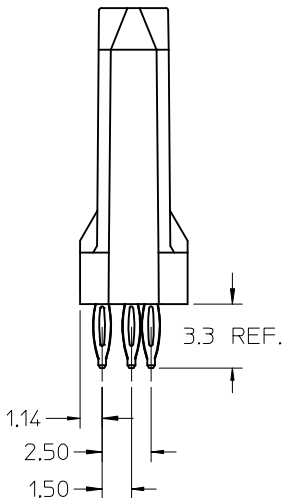
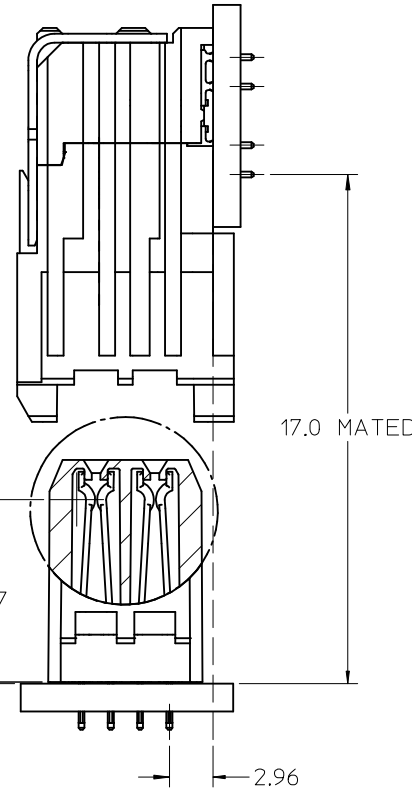
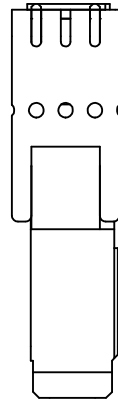
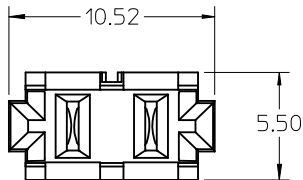

MOLEX P/N	GOLD THICKNESS
75888-6000	30uIn
75888-6050	50uIn

SINGLE ROW ASSEMBLY

ADD GEN. TOLERANCE EC NO: UCP2014-2587 DRWN:SVANG01 CHKD:WOLFE APPR:SMILLER	QUALITY SYMBOLS F=0 F=0 F=0	GENERAL TOLERANCES (UNLESS SPECIFIED) mm INCH 4 PLACES ± --- ± --- 3 PLACES ± --- ± --- 2 PLACES ± 0.13 ± --- 1 PLACE ± 0.25 ± --- 0 PLACE ± ± ANGULAR ± 5 ° DRAFT WHERE APPLICABLE MUST REMAIN WITHIN DIMENSIONS	DIMENSION STYLE MM ONLY DRAWN BY DATE J JONIAK 2005/08/09 CHECKED BY DATE J JONIAK 2005/08/09 APPROVED BY DATE J JONIAK 2005/08/09 MATERIAL NO. SEE CHART	SCALE 4:1 TITLE VHDM/HSD POWER 6 ROW BACKPLANE LEAD FREE SALES ASSEMBLY molex DOCUMENT NO. SD-75888-006	DESIGN UNITS METRIC THIRD ANGLE PROJECTION	SHEET NO. 1 OF 3

9 8 7 6 5 4 3 2 1

NOTES:

1. THIS DESIGN INTENDED AS OPTION TO HAVING TWO SINGLE ROW MODULES NEXT TO EACH OTHER.
2. FINISH: 30 μ IN GOLD ON MATING SURFACE; MATTE TIN ON TAILS; NICKEL UNDERPLATE.
3. FINISH: 50 μ IN GOLD ON MATING SURFACE; MATTE TIN ON TAILS; NICKEL UNDERPLATE.
4. DUAL ROW ASSEMBLIES PACKED PER PK-70873-545.

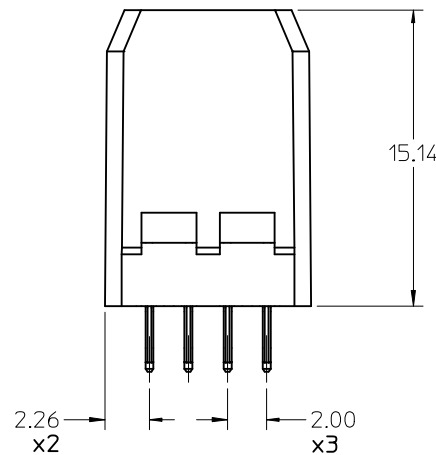
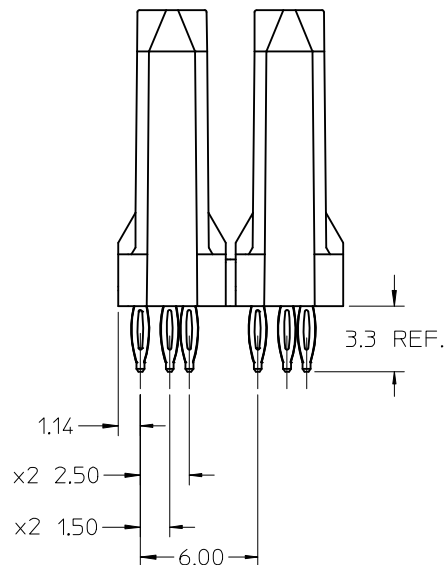
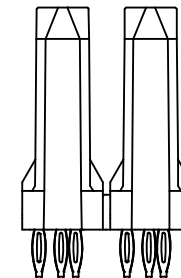
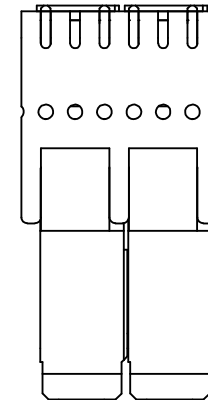
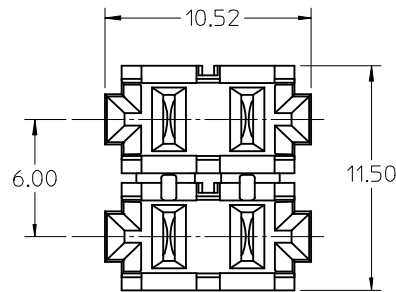

DUAL ROW ASSEMBLY

MOLEX P/N	CONTACT PLATING
75888-6002	SEE NOTE 2.
75888-6052	SEE NOTE 3.

SEE SHEET 1 EC NO: UCP2014-2587 DRWN:SVANG01 2013/12/17 CHKD:MMOLFE 2013/12/17 APPR:SMILLER 2013/12/19	DESCRIPTION	QUALITY SYMBOLS <div><div><div>▽</div><div>F</div><div>=</div><div>0</div></div><div><div>▽</div><div>F</div><div>=</div><div>0</div></div><div><div>▽</div><div>F</div><div>=</div><div>0</div></div></div>	GENERAL TOLERANCES (UNLESS SPECIFIED)		DIMENSION STYLE MM ONLY		SCALE 4:1	DESIGN UNITS METRIC	<div><div><div></div><div></div></div><div>THIRD ANGLE PROJECTION</div></div>	TITLE VHDM/HSD POWER 6 ROW BACKPLANE LEAD FREE SALES ASSEMBLY molex		
				mm	INCH	DRAWN BY JJONIAK	DATE 2005/08/09	APPROVED BY JJONIAK				
			4 PLACES	± ---	± ---	CHECKED BY	DATE	APPROVED BY JJONIAK				
			3 PLACES	± ---	± ---							
			2 PLACES	± 0.13	± ---							
			1 PLACE	± 0.25	± ---							
0 PLACE	±	±										
			ANGULAR ± 5 °		MATERIAL NO.		DOCUMENT NO.		SHEET NO.			
			DRAFT WHERE APPLICABLE MUST REMAIN WITHIN DIMENSIONS		SEE CHART		SD-75888-006		2 OF 3			
	REV B				SIZE B	THIS DRAWING CONTAINS INFORMATION THAT IS PROPRIETARY TO MOLEX INCORPORATED AND SHOULD NOT BE USED WITHOUT WRITTEN PERMISSION						

BOARD LAYOUTS: 1.8 mm MIN. BOARD THICKNESS

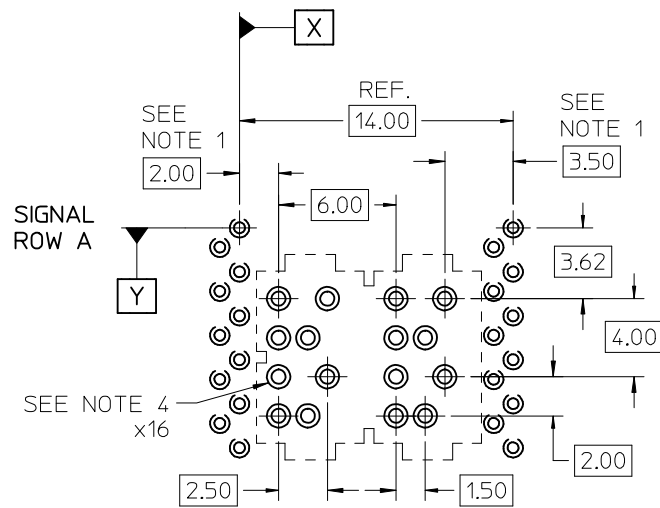

VHDM DUAL ROW POWER

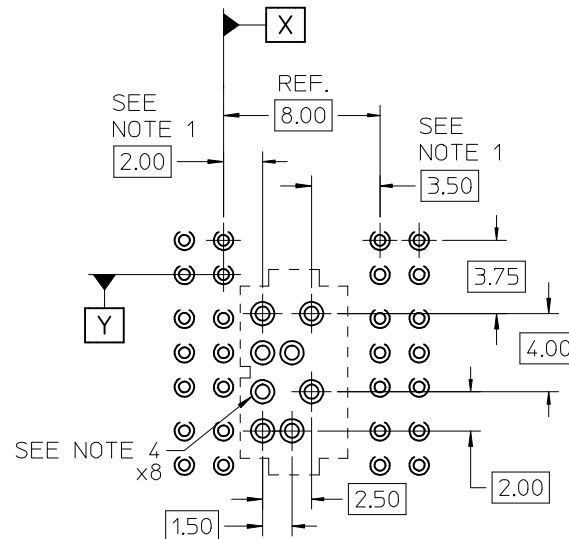

VHDM-HSD SINGLE ROW POWER

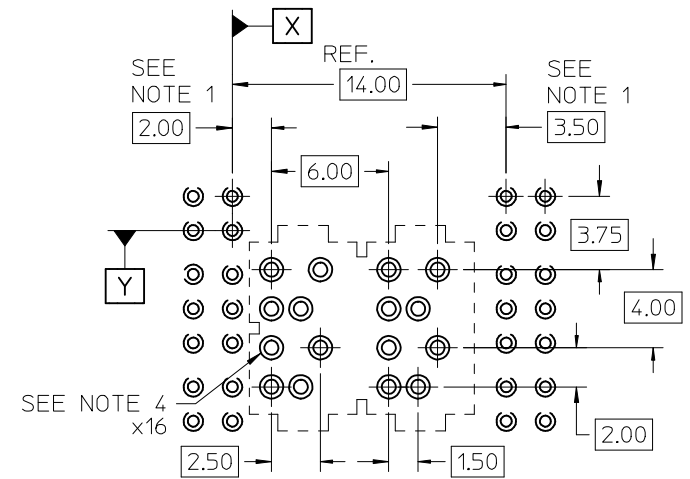

VHDM-HSD DUAL ROW POWER

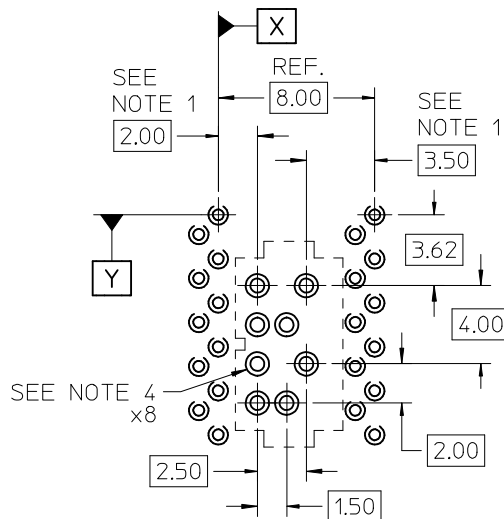

VHDM SINGLE ROW POWER

NOTES:

1. ADDITIONAL SPACING CAN BE ADDED IN MULTIPLES OF 2.0 mm AS REQUIRED. FOR EACH ADDITIONAL SINGLE ROW POWER, ADD 6.00 mm.
2. SIGNAL ROW A IS IN LINE WITH DATUM Y IN ALL FOUR LAYOUTS.
3. FOUR HOLES ARE USED PER POWER CONTACT.
4. EACH POWER HOLE TO BE MANUFACTURED AS FOLLOWS:
 $\varnothing 0.725 \pm 0.075$ PLATED THROUGH HOLE
 $\varnothing 1.20$ PAD
 $\varnothing 0.838$ DRILL

$\varnothing 0.10 \times Y$

SEE SHEET 1 EC NO: UCP2014-2587 DRAWN: SVANG01 2013/12/17 CHKD: MWLFE 2013/12/17 APPR: SMILLER 2013/12/19	DESCRIPTION	QUALITY SYMBOLS <div>▽=0</div> <div>▽=0</div> <div>▽=0</div>	GENERAL TOLERANCES (UNLESS SPECIFIED) <table><tr><td></td><td>mm</td><td>INCH</td></tr><tr><td>4 PLACES</td><td>± ---</td><td>± ---</td></tr><tr><td>3 PLACES</td><td>± ---</td><td>± ---</td></tr><tr><td>2 PLACES</td><td>± 0.13</td><td>± ---</td></tr><tr><td>1 PLACE</td><td>± 0.25</td><td>± ---</td></tr><tr><td>0 PLACE</td><td>±</td><td>±</td></tr></table> <div>ANGULAR ± 5 °</div> <div>DRAFT WHERE APPLICABLE MUST REMAIN WITHIN DIMENSIONS</div>		mm	INCH	4 PLACES	± ---	± ---	3 PLACES	± ---	± ---	2 PLACES	± 0.13	± ---	1 PLACE	± 0.25	± ---	0 PLACE	±	±	DIMENSION STYLE MM ONLY <div>DRAWN BY DATE JJONIAK 2005/08/09</div> <div>CHECKED BY DATE JJONIAK 2005/08/09</div> <div>APPROVED BY DATE JJONIAK 2005/08/09</div> <div>MATERIAL NO.</div> <div>SIZE B</div>	SCALE 4:1	DESIGN UNITS METRIC	 THIRD ANGLE PROJECTION	TITLE VHDM/HSD POWER 6 ROW BACKPLANE LEAD FREE SALES ASSEMBLY molex	DOCUMENT NO. SD-75888-006	SHEET NO. 3 OF 3
					mm	INCH																						
				4 PLACES	± ---	± ---																						
				3 PLACES	± ---	± ---																						
				2 PLACES	± 0.13	± ---																						
1 PLACE	± 0.25	± ---																										
0 PLACE	±	±																										
REV		THIS DRAWING CONTAINS INFORMATION THAT IS PROPRIETARY TO MOLEX INCORPORATED AND SHOULD NOT BE USED WITHOUT WRITTEN PERMISSION																										

10 9 8 7 6 5 4 3 2 1

NOTES:

1. MATERIALS:
HOUSING - LIQUID CRYSTAL POLYMER (LCP),
UL94 V-0, COLOR: BLACK.
TERMINAL - COPPER ALLOY
2. FINISH: 30 μ IN MIN. GOLD ON MATING SURFACE;
MATTE TIN ON TAILS; NICKEL UNDERPLATE.
3. FINISH: 50 μ IN MIN. GOLD ON MATING SURFACE;
MATTE TIN ON TAILS; NICKEL UNDERPLATE.
4. THIS PART CONFORMS TO PRODUCT SPECIFICATION
PS-74031-999.
5. SINGLE ROW ASSEMBLY PACKED PER PK-70873-0876.
6. MATES WITH 75885 SERIES DAUGHTERCARD POWER ASSEMBLY.
7. MATING INTERFACE MEASURED FROM BOTTOM OF HOUSING.

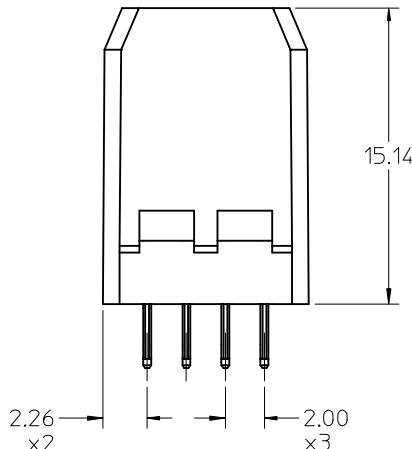
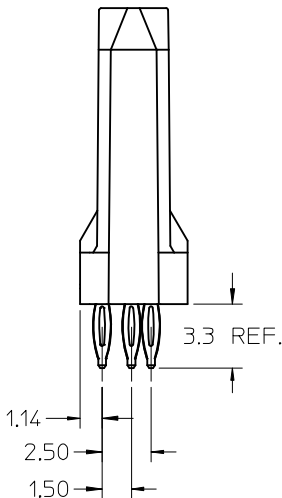
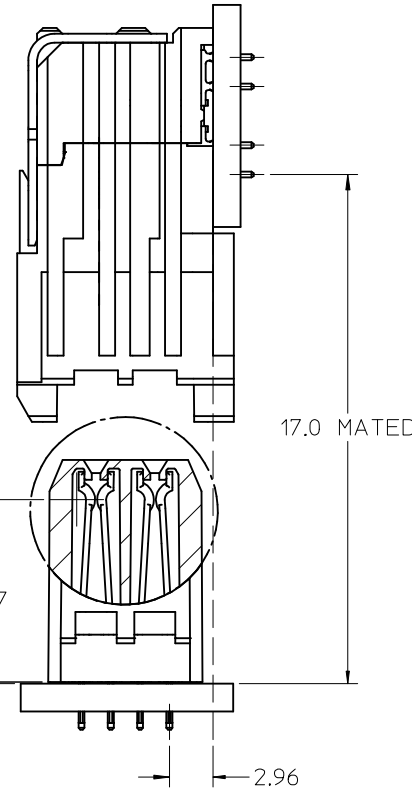
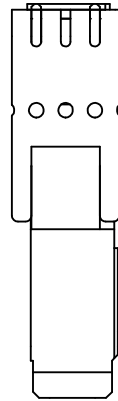
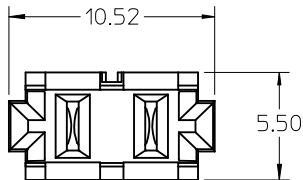

MOLEX P/N	GOLD THICKNESS
75888-6000	30 μ in
75888-6050	50 μ in

SINGLE ROW ASSEMBLY

ADD GEN. TOLERANCE EC NO: UCP2014-2587 DRWN:SVANG01 2013/12/17 CHKD:WOLFE 2013/12/17 APPR:SMILLER 2013/12/19 REV B	QUALITY SYMBOLS F=0 F=0 F=0	GENERAL TOLERANCES (UNLESS SPECIFIED) mm INCH 4 PLACES \pm --- \pm --- 3 PLACES \pm --- \pm --- 2 PLACES \pm 0.13 \pm --- 1 PLACE \pm 0.25 \pm --- 0 PLACE \pm \pm	DIMENSION STYLE MM ONLY DRAWN BY J JONIAK DATE 2005/08/09 CHECKED BY J JONIAK DATE 2005/08/09 APPROVED BY J JONIAK DATE 2005/08/09 MATERIAL NO. SEE CHART SIZE B	SCALE 4:1	DESIGN UNITS METRIC	THIRD ANGLE PROJECTION	TITLE VHDM/HSD POWER 6 ROW BACKPLANE LEAD FREE SALES ASSEMBLY molex DOCUMENT NO. SD-75888-006 SHEET NO. 1 OF 3

9 8 7 6 5 4 3 2 1

NOTES:

1. THIS DESIGN INTENDED AS OPTION TO HAVING TWO SINGLE ROW MODULES NEXT TO EACH OTHER.
2. FINISH: 30 μ IN GOLD ON MATING SURFACE; MATTE TIN ON TAILS; NICKEL UNDERPLATE.
3. FINISH: 50 μ IN GOLD ON MATING SURFACE; MATTE TIN ON TAILS; NICKEL UNDERPLATE.
4. DUAL ROW ASSEMBLIES PACKED PER PK-70873-545.

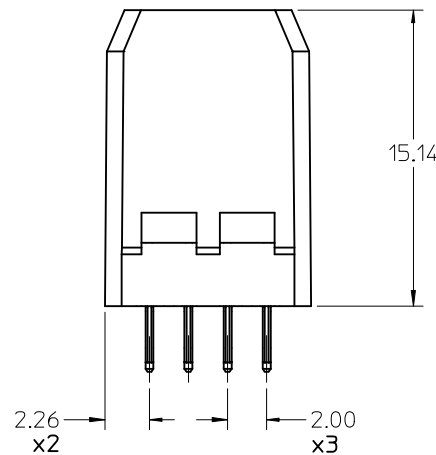
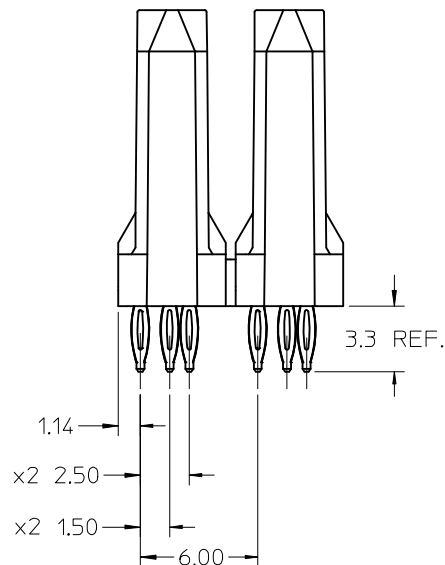
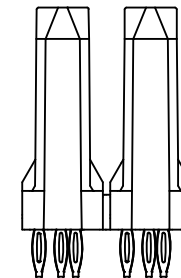
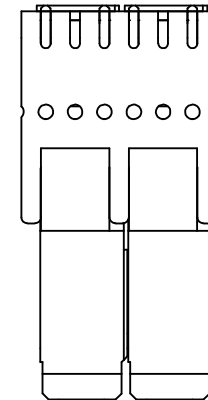
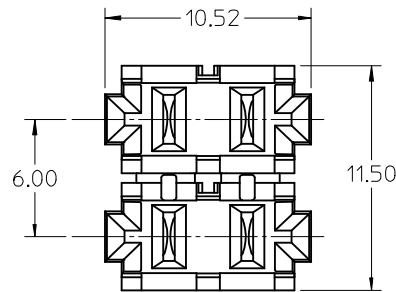

DUAL ROW ASSEMBLY

MOLEX P/N	CONTACT PLATING
75888-6002	SEE NOTE 2.
75888-6052	SEE NOTE 3.

SEE SHEET 1 EC NO: UCP2014-2587 DRWN:SVANG01 2013/12/17 CHKD:MMOLFE 2013/12/17 APPR:SMILLER 2013/12/19	DESCRIPTION	QUALITY SYMBOLS <div><div><div>▽</div><div>F</div><div>=0</div></div><div><div>▽</div><div>F</div><div>=0</div></div><div><div>▽</div><div>F</div><div>=0</div></div></div>	GENERAL TOLERANCES (UNLESS SPECIFIED)		DIMENSION STYLE MM ONLY		SCALE 4:1	DESIGN UNITS METRIC	 THIRD ANGLE PROJECTION		
				mm	INCH	DRAWN BY JJONIAK	DATE 2005/08/09	TITLE VHDM/HSD POWER 6 ROW BACKPLANE LEAD FREE SALES ASSEMBLY			
			4 PLACES	± ---	± ---	CHECKED BY JJONIAK	DATE 2005/08/09				
			3 PLACES	± ---	± ---	APPROVED BY JJONIAK		DATE 2005/08/09	molex		
			2 PLACES	± 0.13	± ---						
			1 PLACE	± 0.25	± ---	MATERIAL NO.		DOCUMENT NO.	SHEET NO. 2 OF 3		
			0 PLACE	±	±						
ANGULAR ± 5 ° DRAFT WHERE APPLICABLE MUST REMAIN WITHIN DIMENSIONS			SIZE B		SEE CHART SD-75888-006 THIS DRAWING CONTAINS INFORMATION THAT IS PROPRIETARY TO MOLEX INCORPORATED AND SHOULD NOT BE USED WITHOUT WRITTEN PERMISSION						

BOARD LAYOUTS: 1.8 mm MIN. BOARD THICKNESS

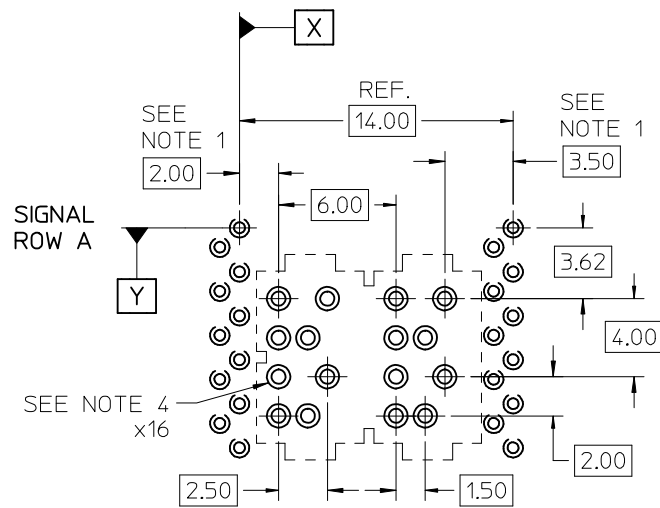

VHDM DUAL ROW POWER

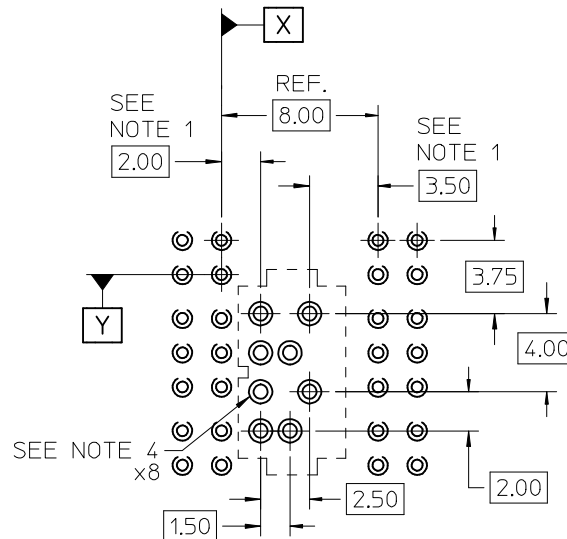

VHDM-HSD SINGLE ROW POWER

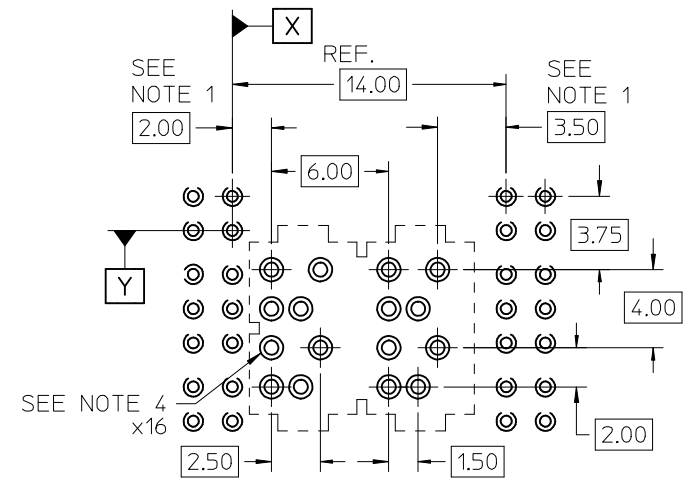

VHDM-HSD DUAL ROW POWER

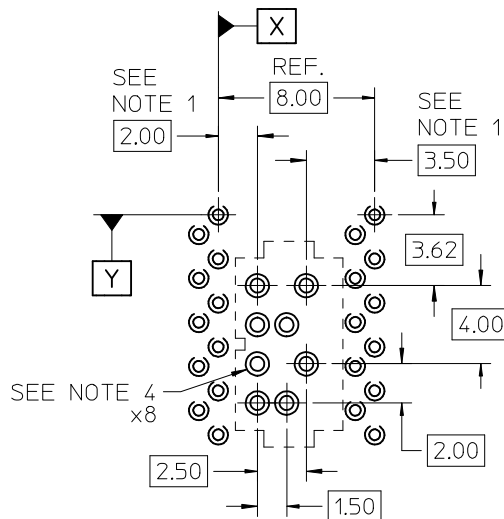

VHDM SINGLE ROW POWER

NOTES:

1. ADDITIONAL SPACING CAN BE ADDED IN MULTIPLES OF 2.0 mm AS REQUIRED. FOR EACH ADDITIONAL SINGLE ROW POWER, ADD 6.00 mm.
2. SIGNAL ROW A IS IN LINE WITH DATUM Y IN ALL FOUR LAYOUTS.
3. FOUR HOLES ARE USED PER POWER CONTACT.
4. EACH POWER HOLE TO BE MANUFACTURED AS FOLLOWS:

Ø0.725±0.075 PLATED THROUGH HOLE

Ø1.20 PAD

Ø0.838 DRILL

Ø0.10X|Y

SEE SHEET 1 EC NO: UCP2014-2587 DRAWN: SVANG01 2013/12/17 CHKD: MWLFE 2013/12/17 APPR: SMILLER 2013/12/19	DESCRIPTION	QUALITY SYMBOLS <div>▽=0</div> <div>▽=0</div> <div>▽=0</div>	GENERAL TOLERANCES (UNLESS SPECIFIED) <table><tr><td></td><td>mm</td><td>INCH</td></tr><tr><td>4 PLACES</td><td>± ---</td><td>± ---</td></tr><tr><td>3 PLACES</td><td>± ---</td><td>± ---</td></tr><tr><td>2 PLACES</td><td>± 0.13</td><td>± ---</td></tr><tr><td>1 PLACE</td><td>± 0.25</td><td>± ---</td></tr><tr><td>0 PLACE</td><td>±</td><td>±</td></tr><tr><td colspan="3">ANGULAR ± 5 °</td></tr></table>		mm	INCH	4 PLACES	± ---	± ---	3 PLACES	± ---	± ---	2 PLACES	± 0.13	± ---	1 PLACE	± 0.25	± ---	0 PLACE	±	±	ANGULAR ± 5 °			DIMENSION STYLE MM ONLY	SCALE 4:1	DESIGN UNITS METRIC	 THIRD ANGLE PROJECTION	TITLE VHDM/HSD POWER 6 ROW BACKPLANE LEAD FREE SALES ASSEMBLY molex	DOCUMENT NO. SD-75888-006	SHEET NO. 3 OF 3
					mm	INCH																									
				4 PLACES	± ---	± ---																									
				3 PLACES	± ---	± ---																									
				2 PLACES	± 0.13	± ---																									
1 PLACE	± 0.25	± ---																													
0 PLACE	±	±																													
ANGULAR ± 5 °																															
DRAWN BY JJONIAK	DATE 2005/08/09																														
CHECKED BY JJONIAK	DATE 2005/08/09																														
APPROVED BY JJONIAK	DATE 2005/08/09																														
MATERIAL NO.																															
REV	B	DRAFT WHERE APPLICABLE MUST REMAIN WITHIN DIMENSIONS	SIZE B	THIS DRAWING CONTAINS INFORMATION THAT IS PROPRIETARY TO MOLEX INCORPORATED AND SHOULD NOT BE USED WITHOUT WRITTEN PERMISSION																											