

REVISIONS				
P	LTR	DESCRIPTION	DATE	APVD
A2		REVISED AS PER ECN-26-368632	11FEB2026	WB MD

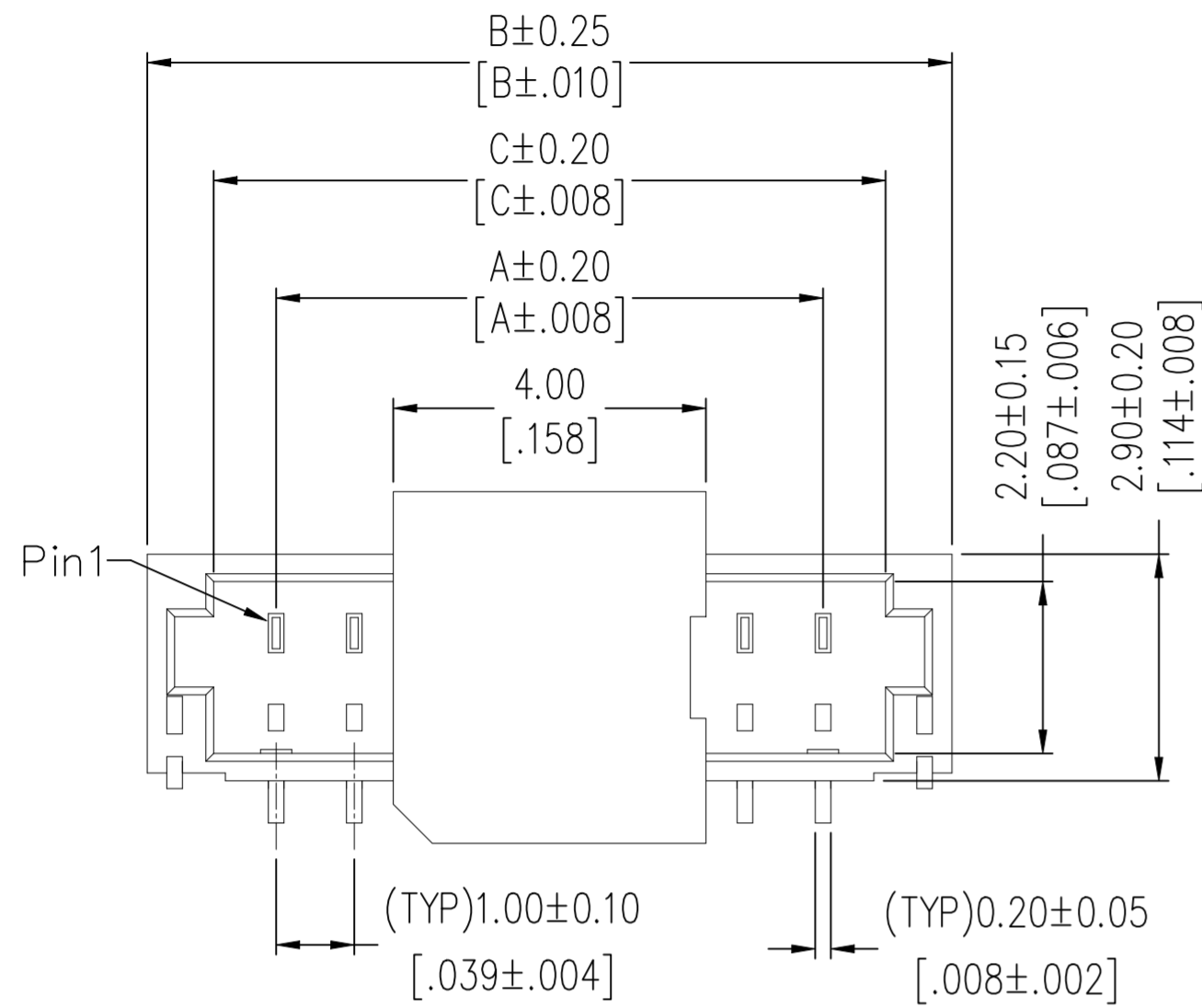

Recommended P.C.B Layout (Top Side)  
(PCB BOARD TOLERANCE±0.05)

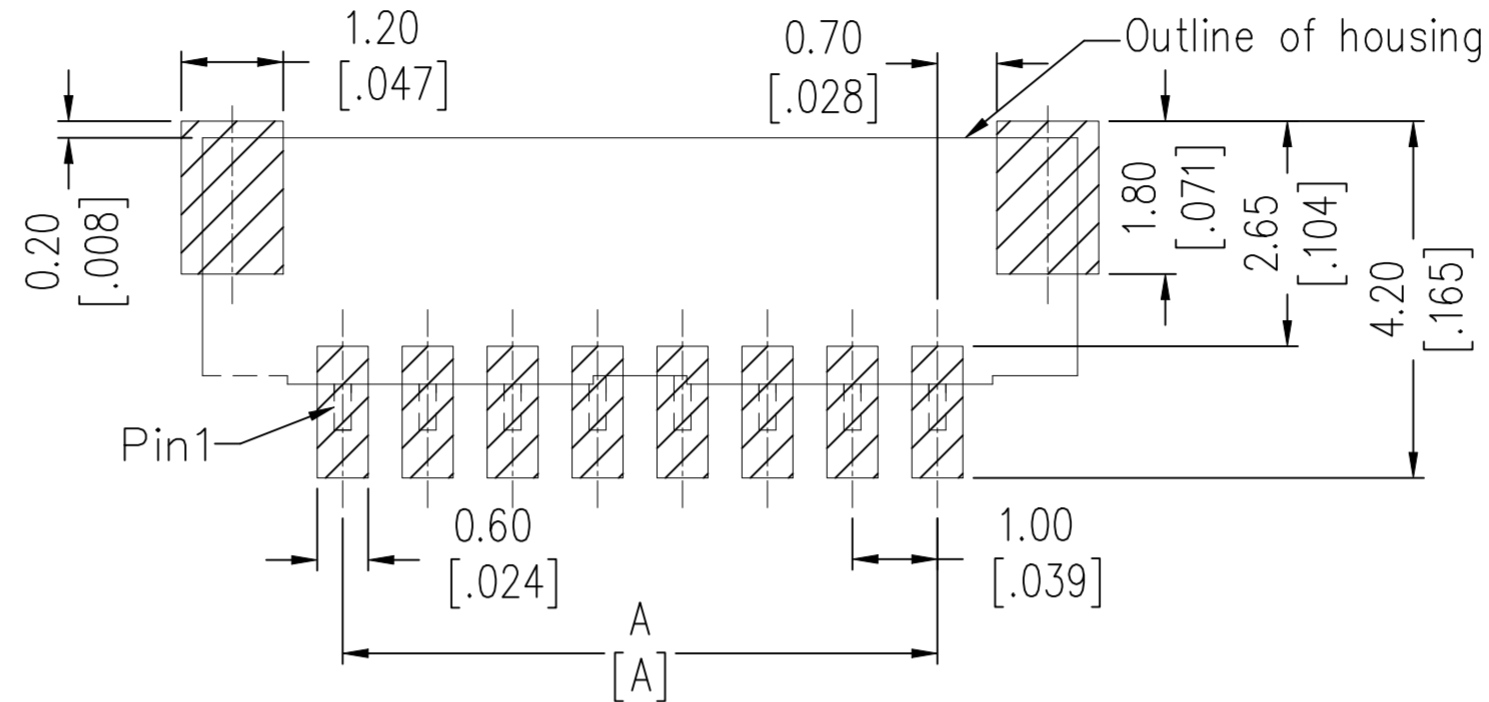

NOTES:

Rated Current:1.0A AC/DC(28#AWG)  
 Rated Voltage:50V AC/DC  
 Contact Resistance:20mΩ Max.  
 Withstand Voltage:500V AC/Minute  
 Insulation Resistance:100MΩ Min.  
 Operation Temperature:-25°C to +85°C

Housing Material:Thermoplastic (UL94V-0)  
 CAP Material:Thermoplastic (UL94V-0)  
 Contact Material:Brass,  
 80u"MIN. Matte tin over 30u"MIN. Nickel  
 Solder Tabs:Brass,  
 80u"MIN. Matte tin over 30u"MIN. Nickel  
 02-05P Without Slot "D"

Recommended process:  
 IR soldering,Peak temperature:260±5°C,5s

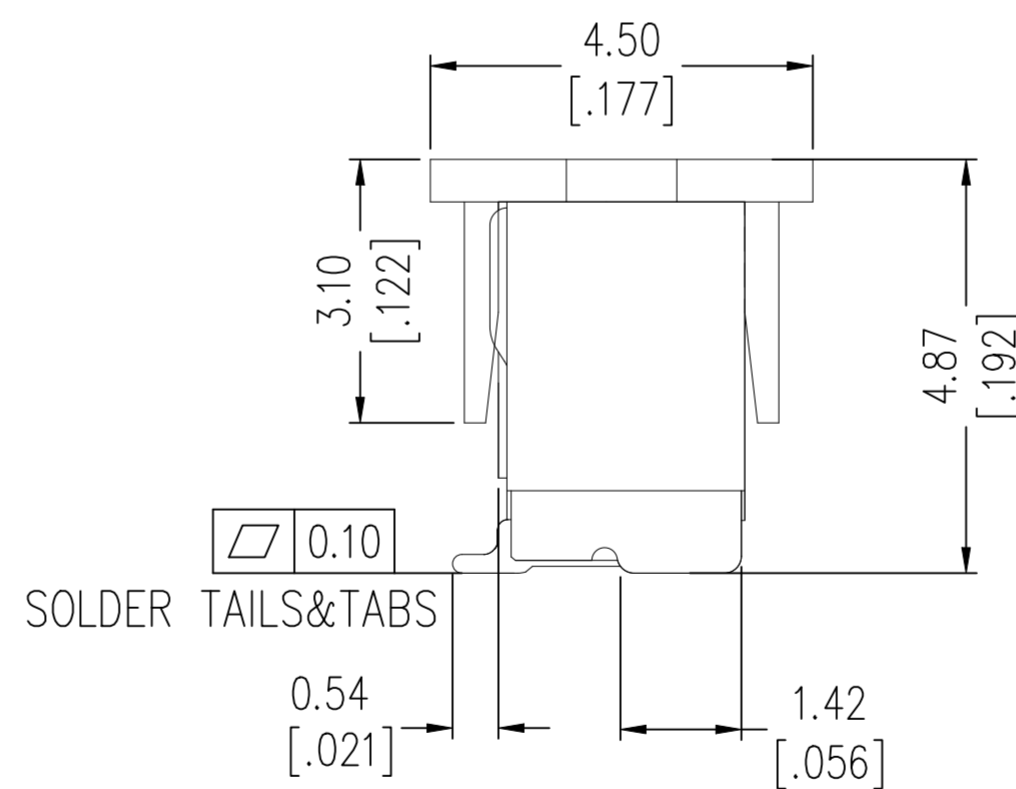
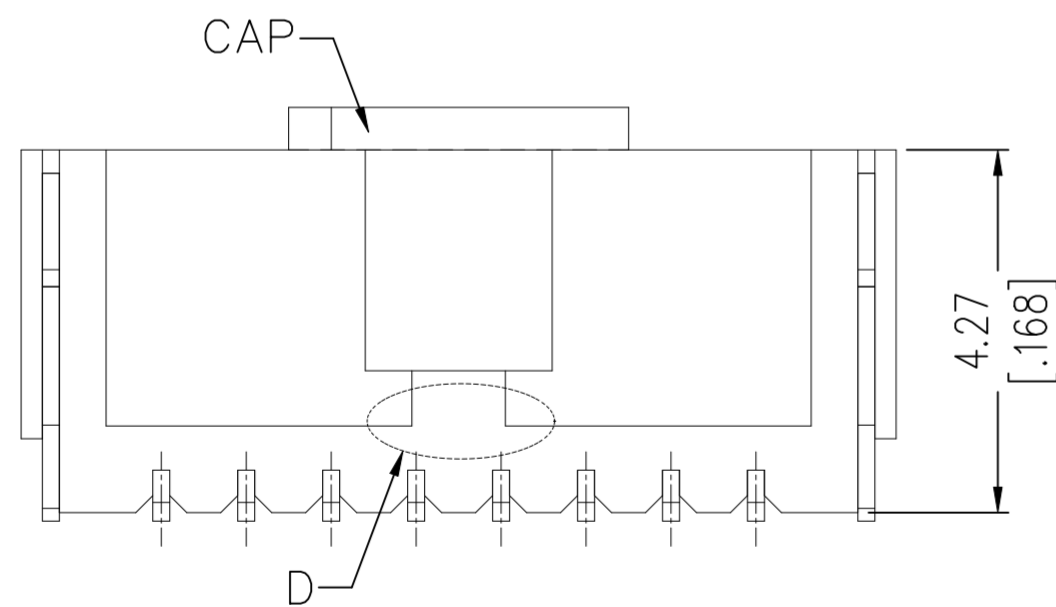

15	14.00	17.30	15.60	1-2473274-5
14	13.00	16.30	14.60	1-2473274-4
13	12.00	15.30	13.60	1-2473274-3
12	11.00	14.30	12.60	1-2473274-2
11	10.00	13.30	11.60	1-2473274-1
10	9.00	12.30	10.60	1-2473274-0
09	8.00	11.30	9.60	2473274-9
08	7.00	10.30	8.60	2473274-8
07	6.00	9.30	7.60	2473274-7
06	5.00	8.30	6.60	2473274-6
05	4.00	7.30	5.60	2473274-5
04	3.00	6.30	4.60	2473274-4
03	2.00	5.30	3.60	2473274-3
02	1.00	4.30	2.60	2473274-2
PINS	DIM A	DIM B	DIM C	PN

THIS DRAWING IS A CONTROLLED DOCUMENT.		DWN	18DEC23	<b>TE</b> TE Connectivity Ltd.	
		CHK	-		
DIMENSIONS:		TOLERANCES UNLESS OTHERWISE SPECIFIED:		NAME	
mm		0 PLC ± -		108-161192	
		1 PLC ± -		114-160811	
		2 PLC ± 0.25		SIZE	
		3 PLC ± 0.15		CAGE CODE	
		4 PLC ± -		DRAWING NO	
		ANGLES ± -		RESTRICTED TO	
MATERIAL		FINISH		SCALE	
				1:1	
				SHEET	
				1 of 2	
				REV	
				A2	

REVISIONS					
P	LTR	DESCRIPTION	DATE	DWN	APVD
-	-	SEE SHEET 1	-	-	-

# HSF

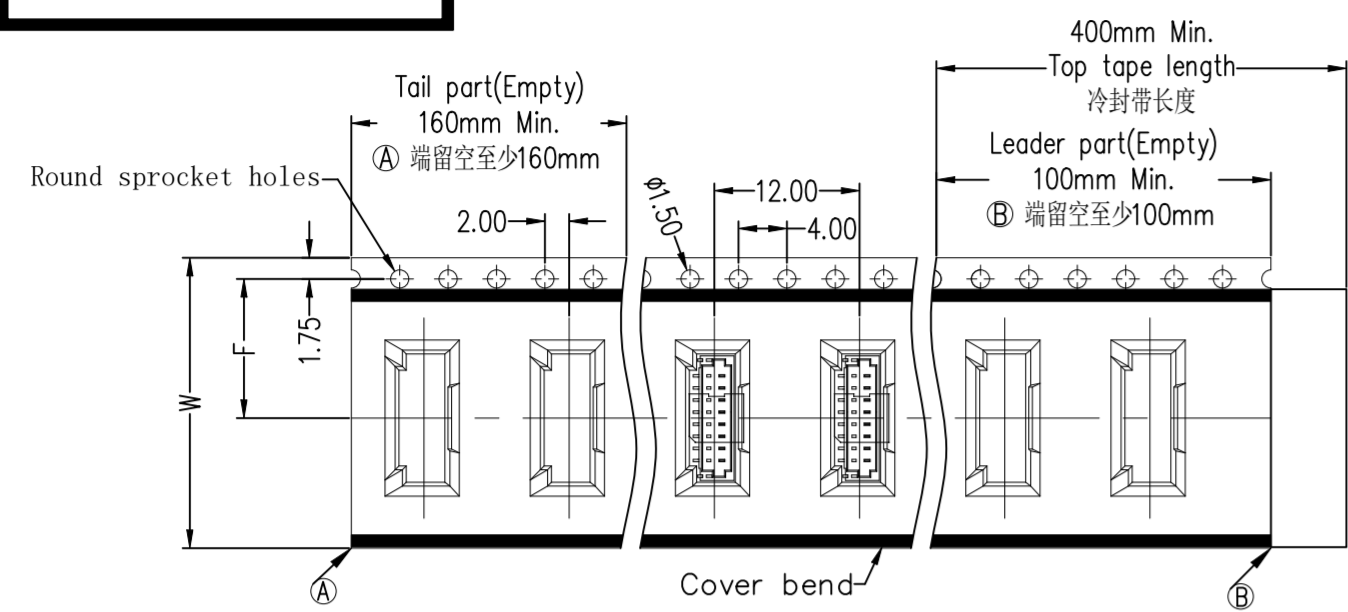

CARRIER FOR 2 TO 14 PIN

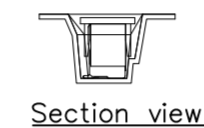

Section view

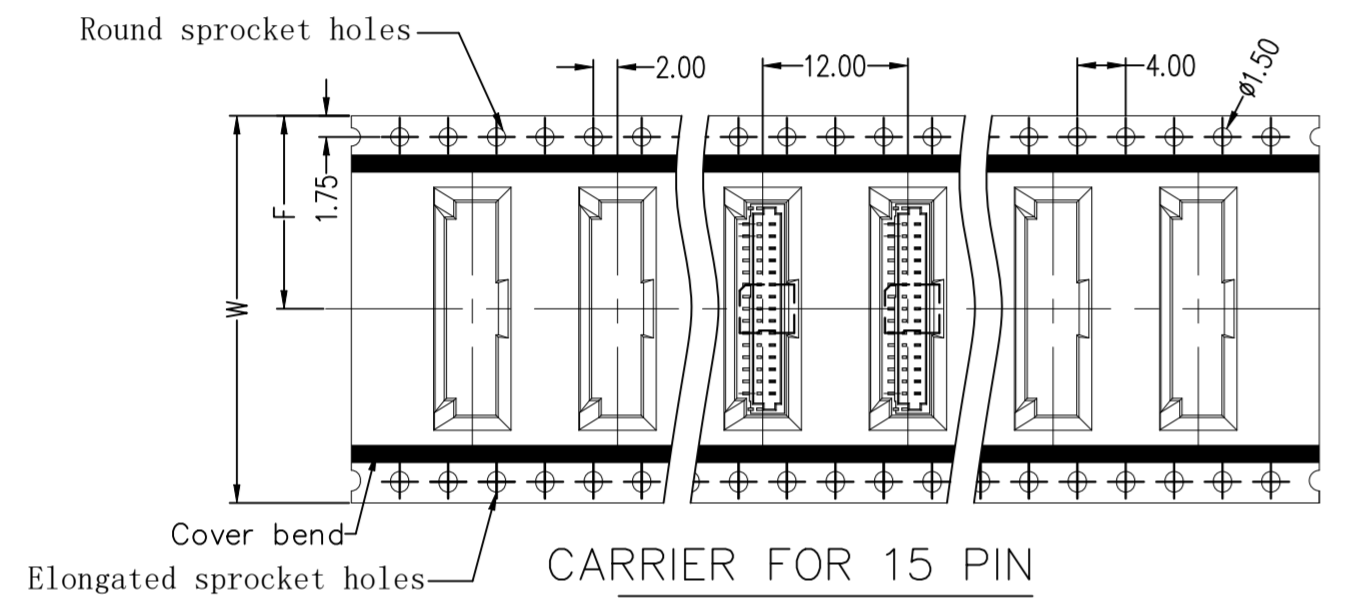

CARRIER FOR 15 PIN

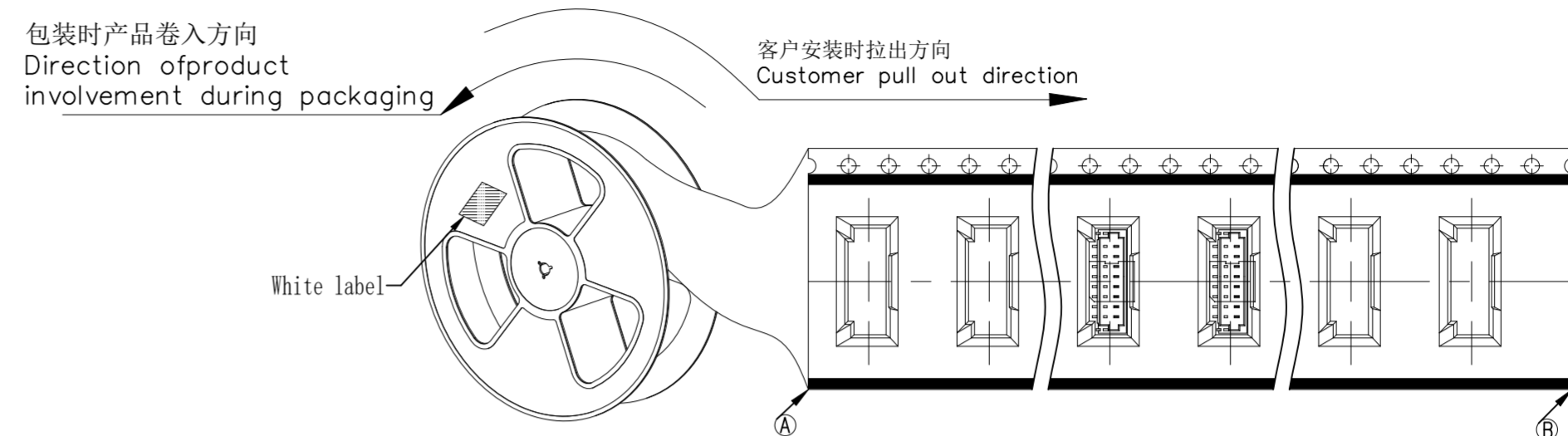

**No.1:**  
 Before package, pay attention to leave more than 160mm(min) empty, after put the products into the carrier groove, packing with the cover bend then,  
 Note: the tension between tape and cover bend is 10g~120g

TE P/N	PIN	W	F	PCS/Reel	PCS/Inner Box	PCS/Outer Box
2473274-2	2P	16.0±0.30	7.50±0.15	1000	4000	12000
2473274-3	3P					
2473274-4	4P					
2473274-5	5P					
2473274-6	6P					
2473274-7	7P	24.0±0.30	11.50±0.15	1000	3000	9000
2473274-8	8P					
2473274-9	9P					
1-2473274-0	10P					
1-2473274-1	11P					
1-2473274-2	12P	32.0±0.30	14.20±0.15	1000	2000	6000
1-2473274-3	13P					
1-2473274-4	14P					
1-2473274-5	15P					

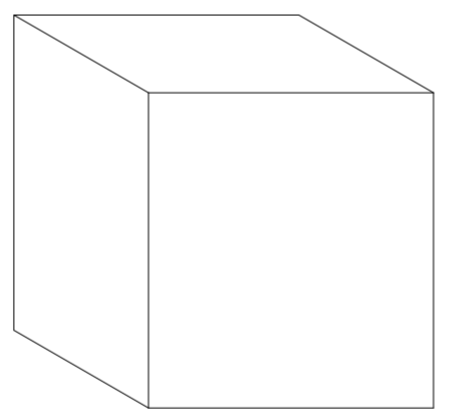

Outer box: CTN-18KTE

**No.4:**  
 Seal, pack, label.

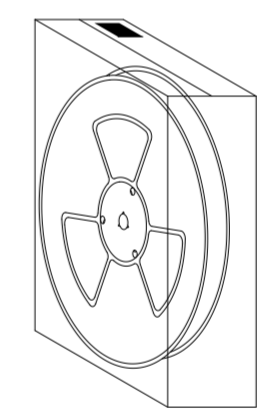
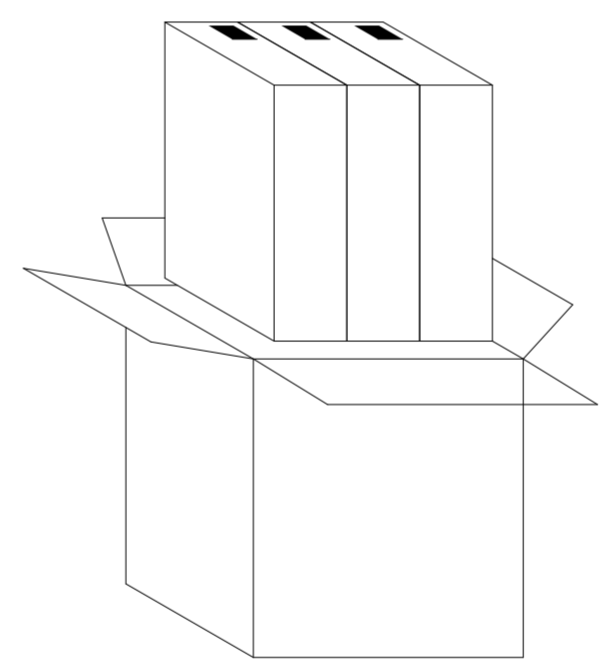

Inner box: CTN-18E

**No.3:**  
 Put inner box into outer box, (3pcs inner box/outer box) pay attention to the unified label direction.

**No.2:**  
 Pack the reel in the PE-33 waterproof bag packing, put lpcs drying agent, seal it with vacuum machine and put it into the inner box, seal it with sealing glue, with labels.

THIS DRAWING IS A CONTROLLED DOCUMENT.		DWN GOWTHAM 18DEC23	TE Connectivity Ltd.	
DIMENSIONS: mm		CHK CONNOR KANG		
TOLERANCES UNLESS OTHERWISE SPECIFIED:		APVD HOPE LU 18DEC23	NAME 1MM VERTICAL HPI HEADER, SMT.	
0 PLC ± -		PRODUCT SPEC	SIZE A2	
1 PLC ± -		APPLICATION SPEC	CAGE CODE 00779	
2 PLC ± 0.25			DRAWING NO C=2473274	
3 PLC ± 0.15			RESTRICTED TO	
4 PLC ± -			SCALE 1:1	
ANGLES ± -		WEIGHT 0	SHEET 2 of 2	
FINISH		CUSTOMER DRAWING	REV A2	