

Series-Connected Supercapacitor Module, 6.0V



ADCM-S06R0S

Request Samples



Check Inventory



Various Sizes

RoHS/RoHS II Compliant

MSL Level = 1

Features

- Assembled Type Supercapacitor
- Series connected 2-Cell configuration.
- No balancing required.
- High power density
- Minimal discharge rate, 72 hours @ discharge<20%
- Excellent cycle life
- Green, meet RoHS requirements.

Applications

- Power Assist Circuits
- Power Backup
- Micro Energy Storage
- IoT Energy Harvesting
- SSD applications
- DDR power back up
- RTC System power transfer to battery backup

Electrical Specifications

Part Number	Nominal Voltage (U _R)	Capacitance	Tol.	ESR (Max)	Nominal Current	Peak Current (Max)	Leakage Current (Max)	Stored Energy (Max)	Gravimetric Energy Density	Gravimetric Power Density
ADCM-S06R0S	DC(V)	Farads	±%	Ω	A	A	uA	mWh	Wh/kg	Wh/L
ADCM-S06R0SA104PB	6.0	0.1	0/+100	6.00	0.054	0.188	3	0.50	0.63	1.88
ADCM-S06R0SA224XB	6.0	0.22	0/+50	2.20	0.12	0.44	4	1.10	0.91	3.38
ADCM-S06R0SA334WB	6.0	0.33	0/+40	1.65	0.18	0.64	4	1.65	0.80	2.65
ADCM-S06R0SA474WB	6.0	0.47	0/+40	0.900	0.26	0.99	5	2.35	1.12	4.76
ADCM-S06R0SA105RB	6.0	1	0/+30	0.720	0.52	1.74	8	5.00	1.82	4.56
ADCM-S06R0SA155RB	6.0	1.5	0/+40	0.420	0.80	2.76	14	7.50	2.25	6.42
ADCM-S06R0SA205RB	6.0	2	0/+30	0.320	1.06	3.66	10	10.00	2.86	8.04
ADCM-S06R0SA305RB	6.0	3	0/+30	0.230	1.58	5.33	16	15.00	3.11	8.10
ADCM-S06R0SA505QB	6.0	5	-10/+20	0.180	2.54	7.89	30	25.00	4.19	8.39
ADCM-S06R0SA605RB	6.0	6	0/+30	0.140	3.08	9.78	36	30.00	4.13	8.85
ADCM-S06R0SA106RB	6.0	10	0/+30	0.090	5.08	15.79	60	50.00	4.10	8.20
ADCM-S06R0SA126RB	6.0	12	0/+30	0.090	5.92	17.31	80	60.00	3.85	6.41

Operating Temperature: -40°C to +65°C

Storage Temperature: -40°C to +65°C, RH<60%, Max. Humidity <85% RH

Test Conditions:

All parameters are measured according to the IEC 62391-1 standard.

Ambient Temperature: +25°C

Capacitance: measured with $I(mA) = 4(C * U_R)$.

ESR: Measured at 1KHz.

Nominal Current: 5 Seconds to discharge from U_R to 1/2U_R.

Peak Current (Max.): 1 second to discharge to U_R to 1/2U_R.

Leakage Current: Measured after 72h at U_R.

Life Cycles: 500,000 cycles with less than 30% change in capacitance.



5101 Hidden Creek Ln, Spicewood TX 78669
Phone: 512-371-6159 Fax: 512-351-8858
For terms and conditions of sales, please visit:
www.abracon.com

REVISION Initial Release :
9/25/2023

ABRACON IS
ISO9001-2015
CERTIFIED

Series-Connected Supercapacitor Module, 6.0V



ADCM-S06R0S

Request Samples



Check Inventory



Various Sizes

RoHS/RoHS II Compliant

MSL Level = 1

Mechanical Specifications

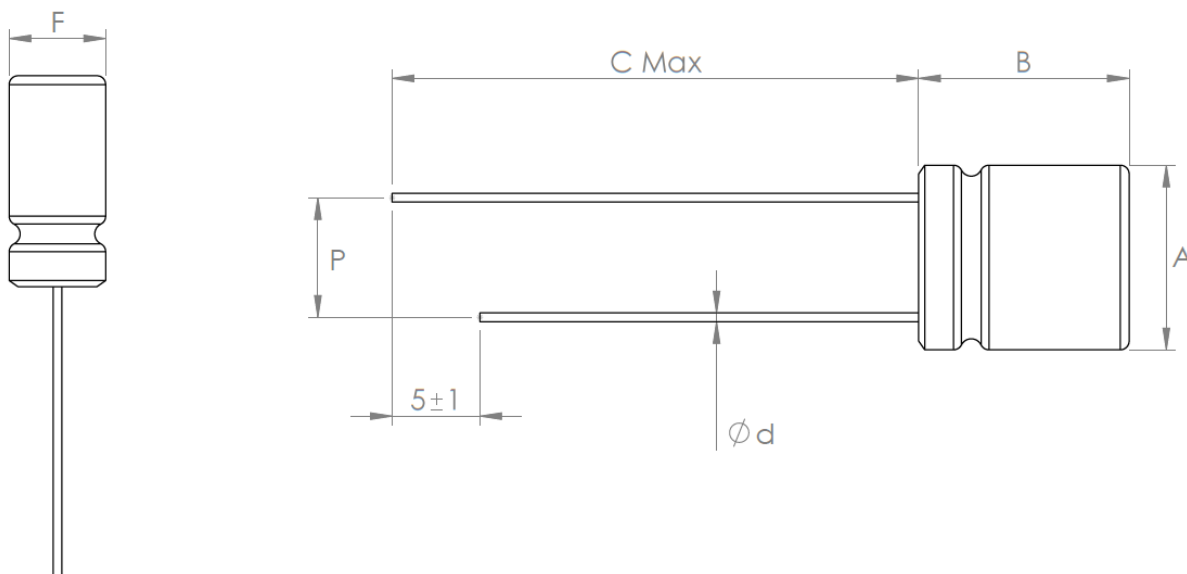

ABRACON PART#	SIZE (A x F x B) ±1	Pin Spacing P	Pin Length C (MAX)	Pin Diameter Ød
ADCM-S06R0SA104PB	10.5 x 5.5 x 12	6.8 ±0.5	30	0.5 ±0.05
ADCM-S06R0SA474WB	18.1 x 9.6 x 18	11.5 ±0.5	30	0.6 ±0.1
ADCM-S06R0SA105RB	16.5 x 8.5 x 15	12.0 ±0.5	30	0.6 ±0.1
ADCM-S06R0SA155RB	16.5 x 8.5 x 22	12.0 ±0.5	30	0.6 ±0.1
ADCM-S06R0SA205RB	20.5 x 10.5 x 19	15.3 ±0.5	30	0.6 ±0.1
ADCM-S06R0SA505QB	20.5 x 10.5 x 27	15.3 ±0.5	30	0.6 ±0.1
ADCM-S06R0SA605RB	20.5 x 10.5 x 33.5	15.3 ±0.5	30	0.6 ±0.1
ADCM-S06R0SA106RB	25.5 x 13 x 36	17.8 ±0.5	30	0.6 ±0.1
ADCM-S06R0SA224XB	13.5 x 7.5 x 15	9.0 ±0.5	30	0.5 ±0.05
ADCM-S06R0SA334WB	16.5 x 8.5 x 15	12.0 ±0.5	30	0.6 ±0.1
ADCM-S06R0SA305RB	20.5 x 10.5 x 22	15.3 ±0.5	30	0.6 ±0.1
ADCM-S06R0SA126RB	32.5 x 16.5 x 28	24.0 ±0.5	30	0.8 ±0.05

Dimensions: mm



5101 Hidden Creek Ln, Spicewood TX 78669
Phone: 512-371-6159 Fax: 512-351-8858
For terms and conditions of sales, please visit:
www.abracon.com

REVISION Initial Release :
9/25/2023

ABRACON IS
ISO9001-2015
CERTIFIED

Series-Connected Supercapacitor Module, 6.0V



ADCM-S06R0S

Request Samples



Check Inventory



Various Sizes

RoHS/RoHS II Compliant

MSL Level = 1

Part Number Identification

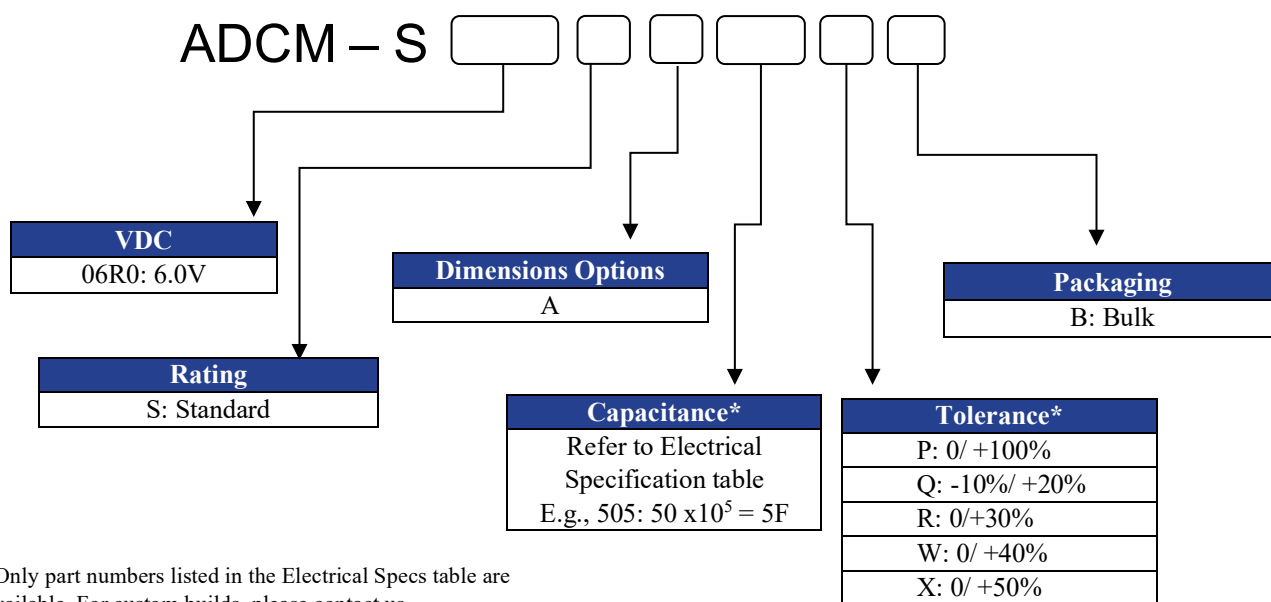

Part Marking



Example of the Marking of a 6.0V 1.0F Supercapacitor

Capacitance (F)

Rated Voltage (V)

Polarity (negative bar indicator on the sleeve to indicate the cathode).



5101 Hidden Creek Ln, Spicewood TX 78669
Phone: 512-371-6159 Fax: 512-351-8858
For terms and conditions of sales, please visit:
www.abracon.com

REVISION Initial Release :
9/25/2023

ABRACON IS
ISO9001-2015
CERTIFIED

Series-Connected Supercapacitor Module, 6.0V



ADCM-S06R0S

Request Samples



Check Inventory



Various Sizes

RoHS/RoHS II Compliant

MSL Level = 1

Reflow Profile

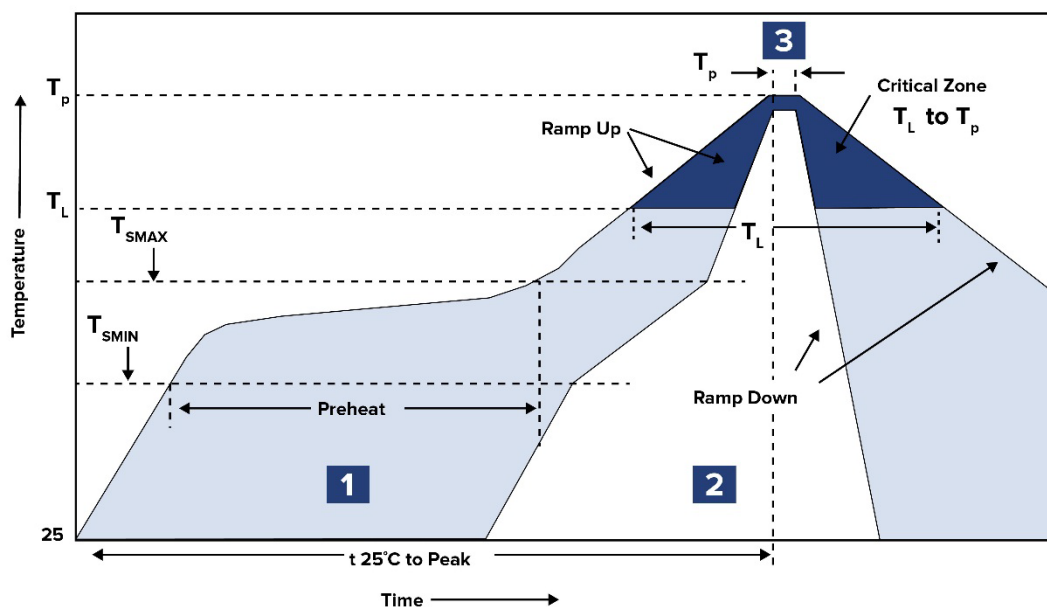

Zone	Description	Temperature	Times
1	Preheat	$T_{SMIN} \sim T_{SMAX}$ $100^\circ\text{C} \sim 150^\circ\text{C}$	60 ~ 120 sec.
2	Reflow	T_L 200°C	30 ~ 40 sec.
3	Peak heat	T_p $240^\circ\text{C} \pm 5^\circ\text{C}$	5 sec. MAX

Series-Connected Supercapacitor Module, 6.0V



ADCM-S06R0S

Request Samples



Check Inventory



Various Sizes

RoHS/RoHS II Compliant

MSL Level = 1

Packaging

Part Number	Pcs/Box	Pcs/Carton
ADCM-S06R0SA104PB	768	4608
ADCM-S06R0SA224XB	512	3072
ADCM-S06R0SA474WB	320	1920
ADCM-S06R0SA105RB	224	1344
ADCM-S06R0SA155RB	224	1344
ADCM-S06R0SA334WB	224	1344
ADCM-S06R0SA305RB	192	1152
ADCM-S06R0SA205RB	120	720
ADCM-S06R0SA505QB	120	720
ADCM-S06R0SA605RB	120	720
ADCM-S06R0SA106RB	80	480
ADCM-S06R0SA126RB	80	480

ATTENTION: Abracon LLC's products are COTS – Commercial-Off-The-Shelf products; suitable for Commercial, Industrial and, where designated, Automotive Applications. Abracon's products are not specifically designed for Military, Aviation, Aerospace, Life-dependent Medical applications or any application requiring high reliability where component failure could result in loss of life and/or property. For applications requiring high reliability and/or presenting an extreme operating environment, written consent and authorization from Abracon LLC is required. Please contact Abracon LLC for more information.



5101 Hidden Creek Ln, Spicewood TX 78669
Phone: 512-371-6159 Fax: 512-351-8858
For terms and conditions of sales, please visit:
www.abracon.com

REVISION Initial Release :
9/25/2023

ABRACON IS
ISO9001-2015
CERTIFIED