

D-Subminiature

500-008

Protective Cover, Panel Mount



500-008

This accessory fits D-Subminiature M24308 and Series 28 HiPer-D connectors.

Metal cover for panel-mounted connectors. 500-008 aluminum cover fits M24308 D-Subminiature and Series 28 HiPer-D connectors. Variable height cover completely shrouds connector and seats against panel. Optional EMI panel gasket. Supplied with standard 4 inch (102mm) attachment. Cover has silicone gasket to protect connector face. Cover is supplied with 4-40 male screwlocks to mate with M24308/26 female screwlocks on panel connector. Also available with female screwlocks for use with cable mounted connectors. Aluminum body, passivated SST screwlocks, and silicone gasket.

TABLE 1
SCREWLOCK OPTIONS

No Designator	A	H
Fillister Hd Male	Socket Hd Male	Hex Head Male
J	K	
Female	Slotted Knurled	

PART NUMBER

Sample PN→ 500-008 M 3 R3 G A T 01 -4

Base P/N 500-008

Finish

TZ Tin-Zinc
MN MegaNickel
JF Cadmium, Yel. Chromate
M Electroless Nickel
NF Olive Drab Cadmium
MT Nickel-PTFE
ZR Black Zinc-Nickel

Shell Size 1 2 3 4 5 6

Omit for front mounted connector.
 Omit for Female Screwlocks (Code J).

Rear Panel Mounted Connector

	Panel Thickness	Cover Height
Omit	N/A	.344 (8.7)
R1	.031 (0.8)	.187 (4.8)
R2	.047 (1.2)	.171 (4.3)
R3	.062 (1.6)	.156 (4.0)
R4	.093 (2.4)	.125 (3.2)
R5	.104 (2.6)	.114 (2.9)
R6	.125 (3.2)	.093 (2.4)
R7	.156 (4.0)	.062 (1.6)
R8	.138 (3.5)	.080 (2.0)

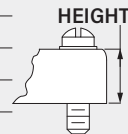
EMI Panel Gasket **G** Gasket Included *Omit if not required*

Screwlocks (Table 1)

Omit Fillister Head Male Screwlocks
A Socket Head Male Screwlocks
H Hex Head Male Screwlocks
J Female Screwlocks (fixed, non-rotating)
K Knurled Slotted Head

Protective cover is supplied with standard 4 inch attachment:
 SST wire rope with blue nylon jacket (Type F) and .182" diameter ring. Use the attachment codes below to modify or delete the attachment.

Attachment Type (Table 2)

Omit for standard attachment
L No Attachment
 See Table 2 for Attachment Types

Attachment Diameter

Omit for standard attachment. **Omit** for Attachment Type SK.

Code	Ring Diameter
01	.140 (3.6)
02	.182 (4.6)
04	.197 (5.0)
06	.125 (3.2)

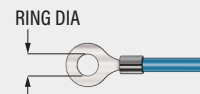

Attachment Length

Omit for standard attachment.
 Length in One Inch Increments (Example: **-5** for five inch length)

D-Subminiature

500-008

Protective Cover, Panel Mount

Height Code	Panel Thickness		Height	
	in	mm	in	mm
Omit	N/A	N/A	.344	8.7
R1	.031	0.8	.187	4.8
R2	.047	1.2	.171	4.3
R3	.062	1.6	.156	3.4
R4	.093	2.4	.125	3.2
R5	.104	2.6	.114	2.9
R6	.125	3.2	.093	2.4
R7	.156	4.0	.062	1.6
R8	.138	3.4	.080	2.0

COVER IS SUPPLIED WITH 4 INCH (61.0) SST WIRE ROPE WITH BLUE NYLON JACKET AND .182 (4.6) DIAMETER RING.

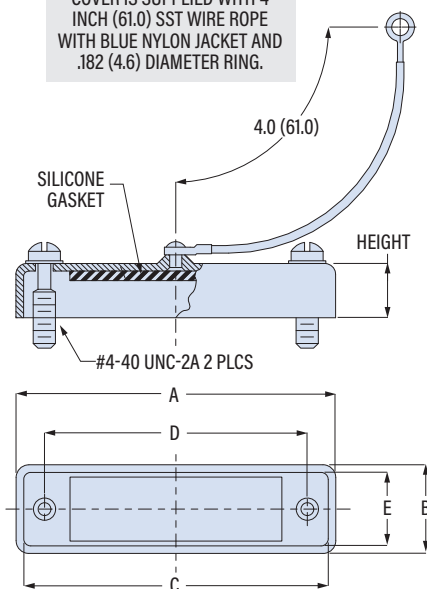
TABLE 2
ATTACHMENT TYPE
D**SST Bead Chain**

.125 (3.2) diameter, size 6, -65 to +200 °C

E**Wire Rope, Clear FEP Jacket**

Clear FEP jacket over SST rope, fair flexibility, good abrasion resistance, .100" diameter, -65 to +200 °C

F**Wire Rope, Blue Nylon Jacket**

6/6 nylon over stainless steel rope, fair flexibility, good abrasion resistance, -55 to +100 °C

G**Black Nylon Rope**

Very flexible, good abrasion and fuel resistance, .062 (1.6) diameter, -55 to +100 °C

S**Sash Chain**#8 sash chain, stainless steel. Length tolerance is \pm one link .280 (71)**SK****Nylon Rope with Slip Knot**

Very flexible, good abrasion and fuel resistance, .094 (2.4) diameter. Length includes .5" (13mm) dia. loop, -55 to +100 °C

T**SST Wire Rope, No Jacket**

Good flexibility, good abrasion resistance, .047 (1.2) diameter, passivated, -65 to +200 °C

U**SST Wire Rope, Black Polyurethane**

Black polyurethane coating, very flexible, excellent abrasion resistance, .080" (2mm) diameter, -55 to +125 °C

EMI PANEL GASKET

Install gasket on front side of panel. When cover is fastened to panel connector, the front edge of the cover seats onto gasket for aperture-free EMI protection.

OPTIONAL EMI GASKET

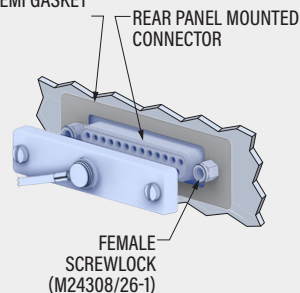

COVER SEATS ONTO EMI PANEL GASKET

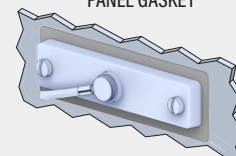
**EMI PANEL GASKET**

MATL: METLASTIC (ALUMINUM MESH EMBEDDED IN SILICONE) .020 (0.5) THICK

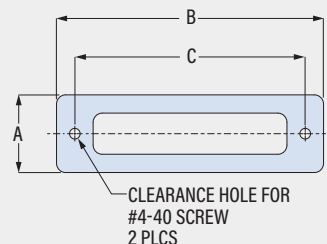

Shell Size	Gasket Part No.	A		B		C	
		in	mm	in	mm	in	mm
1	559-002-1	.740	18.8	1.500	38.1	.980	24.9
2	559-002-2	.740	18.8	1.810	46.0	1.310	33.3
3	559-002-3	.740	18.8	2.380	60.5	1.850	47.0
4	559-002-4	.740	18.8	3.010	76.5	2.500	63.5
5	559-002-5	.850	21.6	2.920	74.2	2.410	61.2
6	559-002-6	.925	23.5	3.010	76.5	2.500	63.5

Shell Size	A Max		B Max		C	D ± .005 (0.13)		E		
	in	mm	in	mm		in	mm	in	mm	
1	1.39	35.3	.51	13.0	1.23	31.2	.984	25.0	.41	10.4
2	1.72	43.7	.51	13.0	1.56	39.6	1.312	33.3	.41	10.4
3	2.26	57.4	.51	13.0	2.10	53.3	1.852	47.0	.41	10.4
4	2.90	73.7	.51	13.0	2.74	69.6	2.500	63.5	.41	10.4
5	2.81	71.4	.62	15.7	2.65	67.3	2.406	61.1	.52	13.2
6	2.90	73.7	.68	17.3	2.74	69.6	2.500	63.5	.58	14.7