

03

0314

Circular connectors with threaded joint M16 acc. to IEC 61076-2-106, IP40/IP68



Chassis plug acc. to IEC 61076-2-106, IP68, with threaded joint and solder terminals, for front mounting

03 0314

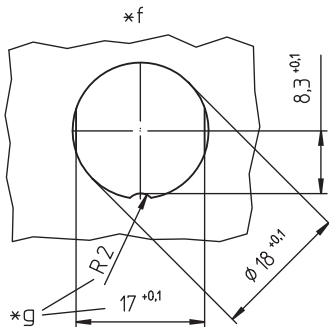
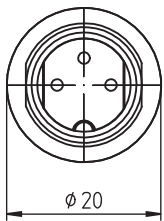
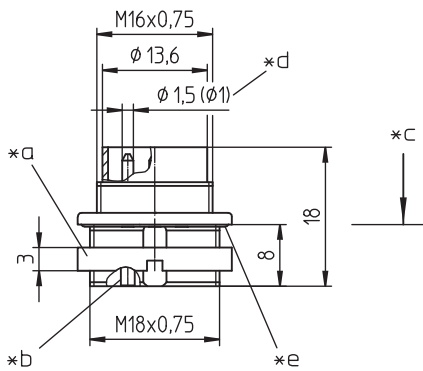
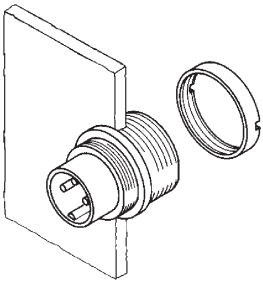

Environmental conditions

Temperature range -40 °C/+85 °C

Materials

Insulating body PA GF, V-0 according to UL94
 Contact pin CuZn, pre-nickel and silver-plated, passivated (3-8 poles)
 CuZn, pre-nickel and gold-plated (12-14 poles)
 Housing Zn diecast, pre-copper and nickel-plated
 Ring screw CuZn, nickel-plated
 Seal NBR

Mechanical data

Tightening torque connector 1-3 Nm
 Tightening torque nut 1-3 Nm
 Thickness of mounting plate 1-4 mm
 Protection class IP68¹

¹ according to IEC DIN EN 60529, only in locked condition with an appropriate counterpart; IPX8 requirements under agreement between manufacturer and user

Connectable conductors for solder area

Section ≤ 0,75 mm² (AWG 20) (3-8 poles)
 ≤ 0,25 mm² (AWG 24) (12-14 poles)

Electrical data (at T_{amb} 20 °C)

Rated current 5 A (T_{amb} 40 °C, 3-8 poles)
 3 A (T_{amb} 40 °C, 12-14 poles)
 Rated voltage with pollution degree 1:
 300 V (versions 03, 04, 05-1, 06, 07)
 100 V (versions 05, 07-1, 08, 08-1)
 160 V (versions 12, 14)
 with pollution degree 2:
 250 V (versions 03, 04)
 32 V (versions 05, 07-1, 08, 08-1)
 160 V (versions 05-1, 06, 07, 12, 14)
 Rated impulse voltage 1500 V (versions 03, 04, 05-1, 06, 07, 12, 14)
 500 V (versions 05, 07-1, 08, 08-1)
 Material group II (IEC)/1 (UL) (400 ≅ CTI < 600)
 Overvoltage category I
 Insulation resistance > 100 MΩ

03

0314

Pin configurations, solder side view

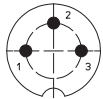

03-a
0314 03

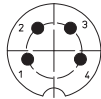

04-a
0314 04

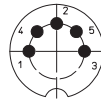

05-b
0314 05

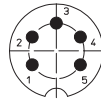

05-a
0314 05-1

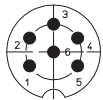

06-a
0314 06

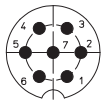

07-a
0314 07

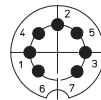

07-b
0314 07-1

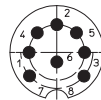

0314 08

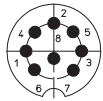

08-a
0314 08-1

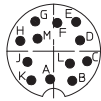

12-a
0314 12

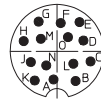

14-a
0314 14

- *a nut enclosed separately
- *b cup-shaped solder terminal
- *c mounting direction
- *d contact pin
Ø 1.5 mm (0314 03–0314 08-1)
Ø 1.0 mm (0314 12–0314 14)
- *e O-ring gasket
- *f port in mounting plate
- *g anti-rotation, alternative execution

Associated products

Counterparts

0321	0322	0322-1
032200	0360	036000

Accessories

0382	0383	038399
0384	0385	038899

Harnessing equipment

ZMS 20

03

0314

Designation	Pole Number	PU (Pieces)	MDQ (Pieces)
0314 03	3	50	100
0314 04	4	50	100
0314 05	5	50	100
0314 05-1	5	50	100
0314 06	6	50	100
0314 07	7	50	100
0314 07-1	7	50	100
0314 08	8	50	100
0314 08-1	8	50	100
0314 12	12	50	100
0314 14	14	50	100

Packaging:

in a cardboard box