

or part number or keyword[Search →](#)

Search Results (0)

[Search Options](#)

Select a product type to narrow your search:

[Mounting Device ▾](#)

Results with your selections: --

[Component Type ▾](#)[Component Feature ▾](#)[Fastening Type ▾](#)[Hole diameter \[mm\] ▾](#)[Bundle size \[mm\] ▾](#)[Stud Size ▾](#)[Conduit Size \[mm\] ▾](#)[Color ▾](#)[Clear](#)[Search →](#)

## Conduit Clamp, Conduit Size 19

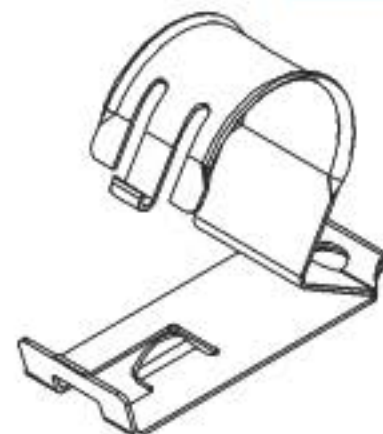
**Part #15495926**[Question about this product?](#)[Attributes](#)[Documents \(2\)](#)

<b>Part # :</b>	15495926
<b>Description :</b>	Conduit Clamp, Conduit Size 19
<b>Product Type :</b>	Mounting Device
<b>Status :</b>	✓ Active
<b>Component Type :</b>	Clamp
<b>Component Feature :</b>	Conduit
<b>Bundle size [mm] :</b>	19.00
<b>Stud size :</b>	M6
<b>Length [mm] :</b>	51.90
<b>Material :</b>	Low Carbon Steel
<b>Weight [g] :</b>	11.3
<b>ELV compliant :</b>	✓ Yes
<b>RoHs compliant :</b>	✓ Yes

Products listed on this website may be subject to restricted usage or distribution or may not be available. For additional information, please contact your local sales office.

Follow Us

[Print](#)

S

ever

hi's  
Heavy Duty  
ehicles.

nect

Award for  
olution"

eatures

That Any  
e to Build  
g Cars"

Us



P. All rights reserved.