

REVISIONS					
P	LTR	DESCRIPTION	DATE	DWN	APVD
	G2	PART OBSOLESCENCE	25JUN2024	RS	VG

POS.	L±0.3	PART NUMBER	
1	2.54	2	1
2	5.08	2	827730 2
3	7.62	3	3
4	10.16	2	4
5	12.70	2	5
6	15.24	3	6
7	17.78	2	7
8	20.32	3	8
9	22.86	3	9
10	25.40	1	0
11	27.94	2	1
12	30.48	2	2
13	33.02	3	3
14	35.56	2	4
15	38.10	3	5
16	40.64	3	6
17	43.18	3	7
18	45.72	2	8
19	48.26	2	9
20	50.80	2	0
21	53.34	2	1
22	55.88	2	2
23	58.42	3	3
24	60.96	3	4
25	63.50	2	5
26	66.04	3	6
27	68.58	3	7
28	71.12	2	8
29	73.66	3	9
30	76.20	3	0
31	78.74	3	1
32	81.28	3	2
33	83.82	3	3
34	86.36	3	4
35	88.90	3	5
36	91.44	3	6
37	93.98	3	7
38	96.52	2	8
39	99.06	3	9
40	101.60	2	0
41	104.14	3	1
42	106.68	3	2
43	109.22	3	3
44	111.76	3	4
45	114.30	3	5
46	116.84	3	6
47	119.38	3	7
48	121.92	2	8
49	124.46	3	9
50	127.00	5	827730 0

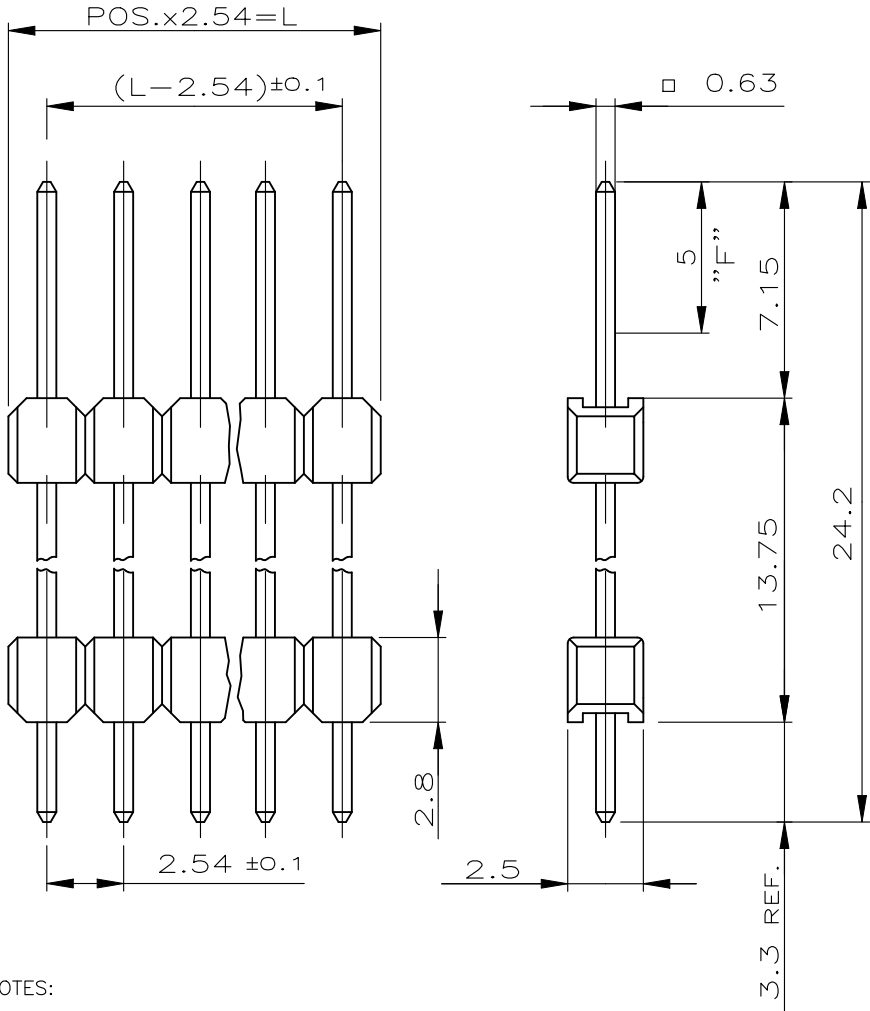

NOTES:

- 1 MATING SIDE: Min 0.76µm (PdNi + Au FLASH)IN ZONE "F" OVER Min 1.27µm Ni (Alternative plating - Min 0.76µm Au OVER Min 1.27µm Ni) SOLDER SIDE: MIN. 2.5µm TIN OVER Min 1.27µm NICKEL
- 2 OBSOLETE PARTS: OBSOLETE CIS STREAMLINING PER D.RENAUD/D.SINISI
- 3 OBSOLETE

CONTACT PIN	CuZn	1
PIN HOUSING	PBT	GREEN
DESCRIPTION	MATERIAL	FINISH
		COLOR

TE Connectivity. All Rights Reserved.



DIMENSIONS:		DWN	31AUG1989	MATERIAL	SEE TABLE	FINISH	SEE TABLE
mm		CHK	WRULICH	TE Connectivity			
TOLERANCES UNLESS OTHERWISE SPECIFIED:		APVD	SCHAAR.				
±0.2 mm		PRODUCT SPEC	108-18012				
0 PLC ± -		APPLICATION SPEC	—	NAME SPEC. AMPMODU II PIN HEADER SINGLE ROW			
1 PLC ± -		WEIGHT	—	SIZE	CAGE CODE	DRAWING NO	RESTRICTED TO
2 PLC ± -		CUSTOMER DRAWING		A4	00779	C-827730	—
3 PLC ± -				SCALE		SHEET	REV
4 PLC ± -				4:1		1 OF 1	G2
ANGLES ± -							