

Top View of Assembly

SECTION A-A  
End View of AssemblySECTION B-B  
Side View of Assembly

Top View Looking Inside Box

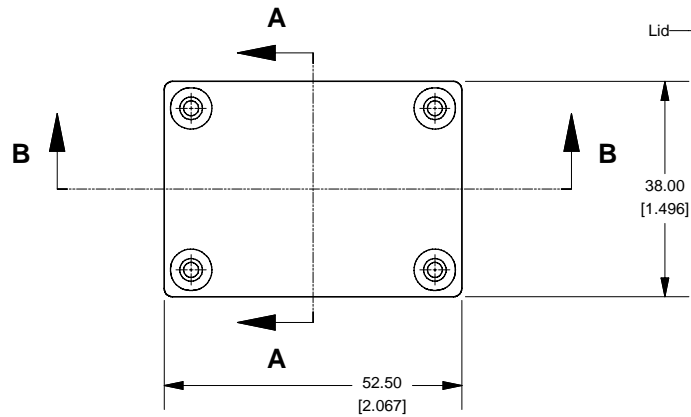
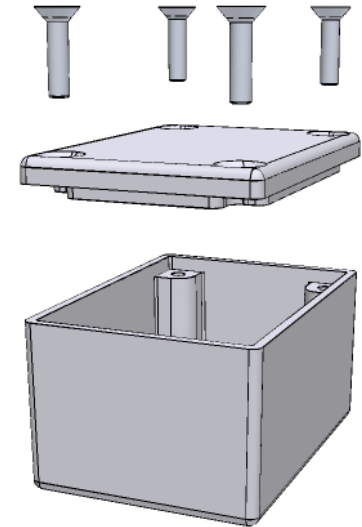
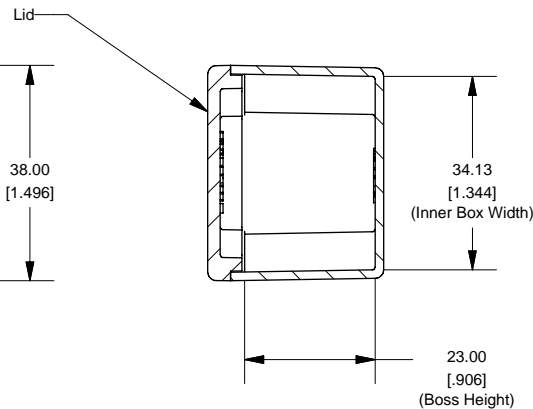
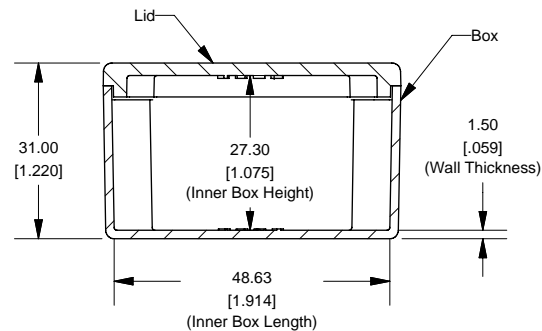
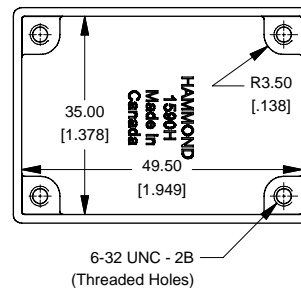

Enclosures can be Factory Modified ( Milling, Drilling, Printing etc.)  
Contact Factory mjm@hammondmgf.com for quotes  
Solid models of this enclosure available in STEP or IGES.

**NOTE**

Purchased assembly includes box, lid and 4 cover screws.  
Box and lid are made from Diecast Aluminum Alloy (alloy type 380).  
Silicone Gasket Loctite #5950

**PART NUMBERS****1590H Enclosure**

Unfinished	1590H
Grey Textured Polyester Powder Paint - RAL 7038	1590HGY
Black Textured Polyester Powder Paint - RAL 9011	1590HBK
<b>1590H Liquid Resistant Enclosure (Silicon Factory Installed Gasket)</b>	
Unfinished	1590WH
Black Textured Powder Paint	1590WHBK

**ACCESSORIES****Recommended Torque: 75 ozf.in / 55 cN.m**

Black Textured Cover Screws (Pkg 50) [6-32 x 1/2" SS Type 304]	1590WMS100BK
Unfinished Cover Screws (Pkg 100) [6-32 x 1/2" Nickel Plated Screws]	1590WMS100
<b>Standard Cover Screws</b>	
Unfinished Cover Screws (Pkg 100) [6-32 x 1/2" Nickel Plated Screws]	1590MS100
Black Textured Cover Screws (Pkg 50) [6-32 x 1/2" SS Type 304]	1590MS100BK

