

NOTES:

1. MATERIALS AND FINISHES:
BODY - BRASS, NICKEL PLATING
LOCKWASHER - PHOSPHOR BRONZE, NICKEL PLATING
HEX NUT - BRASS, NICKEL PLATING
CONTACT - BERYLLIUM COPPER, GOLD PLATING
INSULATOR - PTFE
O-RING - SILICONE RUBBER
2. ELECTRICAL:
A. IMPEDANCE: 50 OHM
B. FREQUENCY RANGE: DC - 4 GHz
C. VSWR: 1.3 FROM DC TO 4 GHz
3. ENVIRONMENTAL:
A. IP-67 SEALED IN UNMATED CONDITION
4. PACKAGING:
A. QUANTITY: SINGLE PACK
B. MARKING: BAG TO BE MARKED
"AMPHENOL RF, 901-10384, AND DATE CODE"

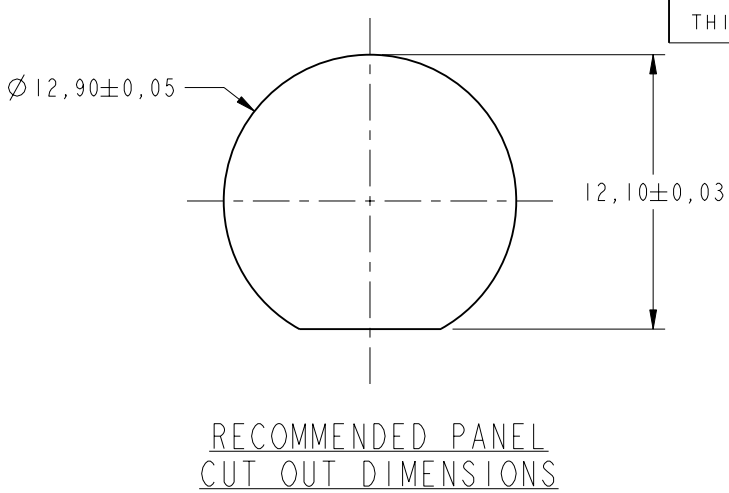

REVISIONS				
REV	DESCRIPTION	DATE	ECO	APPR
A	RELEASE TO MFG.	05-Sep-12	49148	RM
B	ADD ARC LOGO TO BODY\RD-DM13082201J8	30-Aug-13	49619	RLB

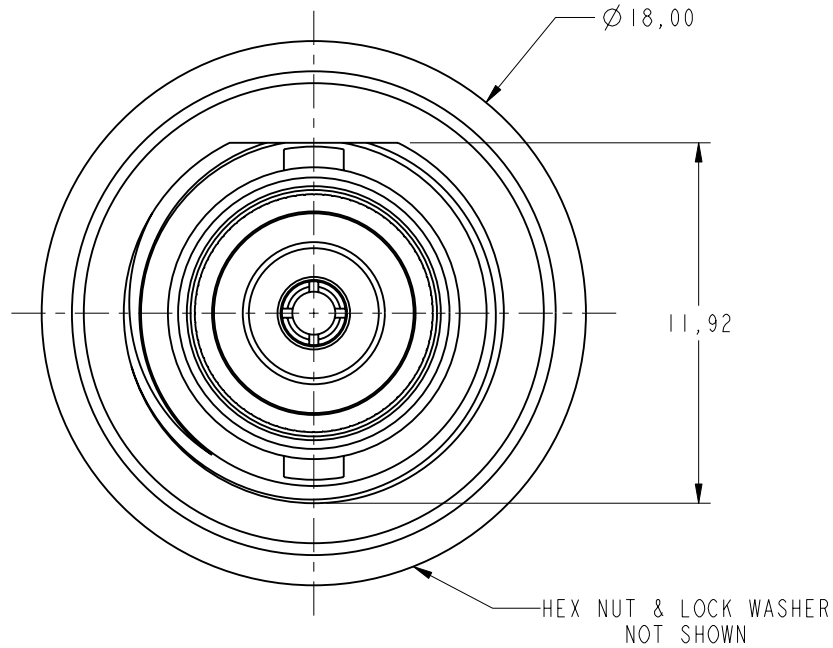
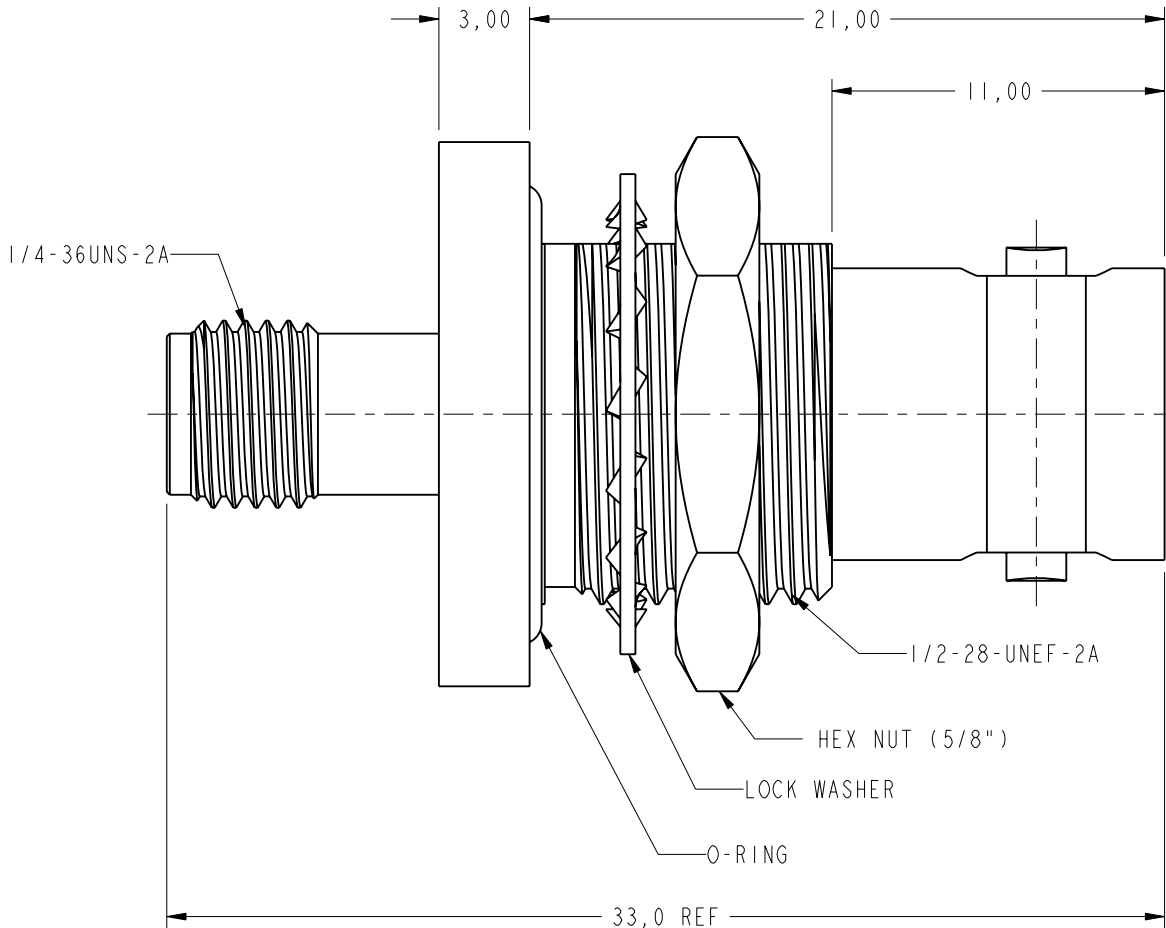
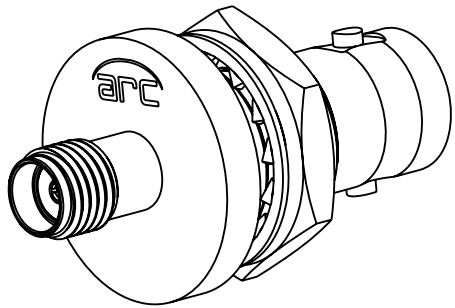

CUSTOMER OUTLINE DRAWING

ALL OTHER SHEETS ARE FOR INTERNAL USE ONLY

UNLESS OTHERWISE SPECIFIED, DIMENSIONS ARE IN METRIC AND TOLERANCES ARE: <0.5mm ± 0.05mm 0.5 - 6mm ± 0.1mm 6 - 30mm ± 0.2mm 30 - 120mm ± 0.3mm ANGLES ± 1°	MATERIAL	DRAWN J.CHEN	DATE 30-Aug-13	TITLE SMA JACK TO BNC BHD JACK IP-67 ADAPTOR		Amphenol RF www.amphenolrf.com	
NOTICE - These drawings, specifications, or other data (1) are, and remain the property of Amphenol corp. (2) must be returned upon request; and (3) are confidential and not to be disclosed to any person other than those to whom they are given by Amphenol Corp. the furnishing of these drawings, specifications, or other data by Amphenol Corp., or to any other person to anyone for any purpose is not to be regarded by implication or otherwise in any manner licensing, granting rights to permitting such holder or any other person to manufacture, use or sell any product, process or design, patented or otherwise, that may in any way be related to or disclosed by said drawings, specifications, or other data.	REFERENCE EAR 3558 AND CONFIGURATION LEVEL: <input type="checkbox"/> <input type="checkbox"/> <input type="checkbox"/>	ENGINEER D.DAVE	DATE 17-JAN-12	SCALE: 4.0:1.0 SHEET 2 OF 2		DRAWING NO.901-10384	
						ITEM NO. 901-10384	
						PART NO. 901-10384	
	FINISH	APPROVED S.HSIEH	DATE 05-Sep-13	DWG SIZE B		REV B	