

MICRO SWITCH
a Honeywell Division

FED. MFG. CODE 91929

SWITCH - BASIC

CATALOG LISTING

V3L-3296

CQ-X2787

V3L-3296

CATALOG LISTING

M

ISSUE
3

REPLACES

RELEASE NO. PR-16061

CHECK

REVISIONS

A	PR-16061
MAM	10 DEC 87
B	CO-76298
JAK	11 NOV 93

CHECK

12 DEC 87

GLH

CHECK

10 DEC 87

MAM

DDM/CAD
DRAWN

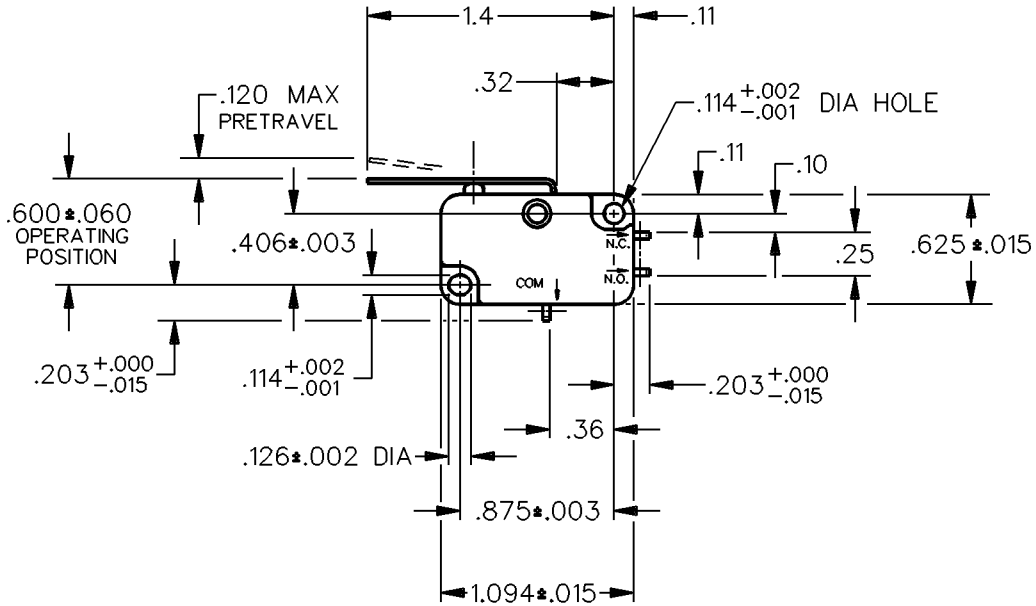
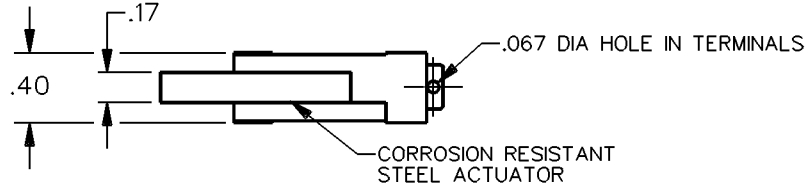

THIS DRAWING COVERS A PROPRIETARY ITEM AND IS THE PROPERTY OF MICRO SWITCH, A DIVISION OF HONEYWELL. THIS DRAWING IS NOT TO BE COPIED OR USED WITHOUT THE APPROVAL OF MICRO SWITCH.

THIRD ANGLE PROJECTION

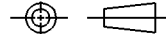

CHARACTERISTICS

OPERATING FORCE — — —	88 GRAM MAX
RELEASE FORCE — — —	6 GRAM MIN
DIFFERENTIAL TRAVEL — — —	.032 MAX
OVERTRAVEL — — —	.090 MIN
RELEASE TRAVEL — — —	.017 MIN

ELECTRICAL DATA

CONTACT ARRANGEMENT
S P D T

15.1A 1/2HP 125, 250 VAC
1/2A 125 VDC, 1/4A 250 VDC
5A 125 VAC "L"

L83



SCALE FULL

DO NOT SCALE PRINT

UNLESS OTHERWISE SPECIFIED TOLERANCES ARE

ONE PLACE (.0)	± .030
TWO PLACE (.00)	± .015
THREE PLACE (.000)	± .005
ANGLES	±

WEIGHT