

ORDERING CODE: **MRJR - 54 X X - X C**

SERIES RUGGED RJ

RJ 45 RECEPTACLE,
VERTICAL PCB TAIL

NUMBER OF CONTACTS

8= 8 CONTACTS
A= 10 CONTACTS

LED OPTION

0 = NONE
1 = LEFT GREEN, RIGHT YELLOW
4 = LEFT YELLOW, RIGHT GREEN
5 = LEFT GREEN, RIGHT GREEN
A = BI-COLOUR GREEN/YELLOW LEFT
BI-COLOUR GREEN/YELLOW RIGHT
D = GREEN LEFT
BI-COLOUR GREEN/YELLOW RIGHT

TAIL LENGTH & MOUNTING HOLE

THREAD OPTION

0 = "A" 2.54 [.100], #4-40 UNC
B = "A" 3.81 [.150], #4-40 UNC
M = "A" 2.54 [.100], M3 x 0.5
P = "A" 3.81 [.150], M3 x 0.5

SINGLE PORT, EXTRA CLEARANCE
NEAR SHELL MOUNTING HOLES

SPECIAL CONNECTORS
MANY UNIQUE FEATURES ARE READILY
AVAILABLE TO SUIT CUSTOMER REQUIREMENTS.
CONSULT WITH AMPHENOL CANADA FOR DETAILS.

NOTES:

- MATERIAL:**
ALL MATERIALS ARE RoHS COMPLIANT PER EU DIRECTIVE 2011/65/EU AND AMENDMENTS
 - SHELL - DIECAST ZINC, NICKEL PLATED
 - CONTACTS - PHOSPHOR BRONZE WITH 1.27µm [50µ"] MIN. GOLD OVER 1.27µm [50µ"] MIN. NICKEL ON THE MATING AREA AND MATTE TIN OVER NICKEL ON THE CONTACT TAILS.
 - INSERTS - ENGINEERING THERMOPLASTIC, UL94V-0 FLAMMABILITY RATING, REAR INSERTS: BLACK NYLON, FRONT INSERT: CLEAR POLYCARBONATE.
 - GASKET: SILICONE RUBBER, CONDUCTIVE, BLACK.
 - LED'S - EPOXY LENS, STEEL TAILS WITH TIN PLATING.
- ENVIRONMENTAL PERFORMANCE PER IEC 60529 CODE IP67 FOR SEAL BETWEEN MATING AREA AND PCB SIDE OF CONNECTOR. GASKET PROVIDES SEAL TO INSIDE FACE OF PANEL.
- CURRENT RATING: 1.5 AMPERES.
- CONTACT RESISTANCE: 30 MILLIOHMS MAXIMUM.
- OPERATING TEMPERATURE: -40 °C TO +105 °C.
- LED CHARACTERISTICS: FORWARD DC CURRENT 25 mA MAX., FORWARD VOLTAGE 2.5V MAX. @ 2 mA.
- RECOMMENDED TORQUE FOR PANEL MOUNT SCREWS: 0.45 TO 0.65 N-m (4.0 TO 5.75 IN-LBS) FOR STEEL SCREWS WITH 3.00 (.118) THREAD ENGAGEMENT.
- CUSTOMER TO VERIFY THAT ALL PROCESS CLEANERS ARE COMPATIBLE WITH POLYCARBONATE MATERIAL.
- AVAILABLE MATING AREA COVERS PROVIDE ADDED PROTECTION. CONSULT WITH AMPHENOL CANADA FOR DETAILS.
- COMPARED TO DRAWING P-MRJR-54XX-XF, PARTS ON THIS DRAWING HAVE EXTRA CLEARANCE NEAR THE SHELL MOUNTING HOLES (2 PLCS).

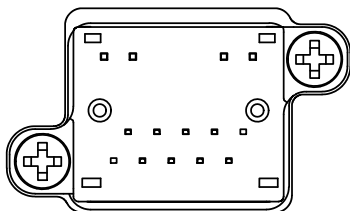
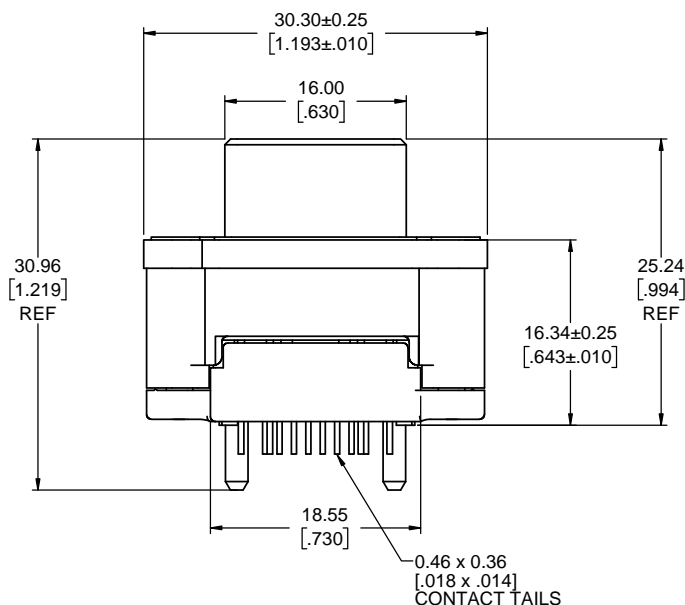

UNLESS SPECIFIED OTHERWISE	DRAWN I. FOUK ALADEH	SEP13/17
PRIMARY UNITS MILLIMETERS	CHECKED K. LAMBIE	SEP19/17
SECONDARY INCHES	M.E. APP'D	
REFERENCE IN PARENTHESES	Q.A. APP'D	
GENERAL TOLERANCES	DWG APPR.	
1 DECIMAL PLACE	ENG. REL. NO.	EAR 14605
2 DECIMAL PLACES ±0.15	REF.	
3 DECIMAL PLACES	THIRD ANGLE PROJECTION	
ANGULAR DEGREES	DO NOT SCALE DRAWING	

Amphenol Canada Corp. www.amphenolcanada.com		
MRJR SERIES RUGGED MODULAR JACK, 8 OR 10 CONTACTS, VERTICAL, LED, THREAD & TAIL LENGTH OPTIONS, EXTRA SHELL CLEARANCE, RoHS COMPLIANT		
DWG. NO.	P-MRJR-54XX-XC	
CODE ID NO. 03554	DWG SIZE: X	SCALE: 3:1
SHEET 1 OF 2	REV A	

RECOMMENDED PCB LAYOUT COMPONENT SIDE OF BOARD

REVISIONS			
REV	DESCRIPTION, ECN, EAR NO.	DATE	APP'D
A	PRODUCT DRAWING (EAR 14605)	SEP19/17	K.L.

8 POSITION VIEW

LOCATE HOLES
 $\varnothing 0.13 (.005)$ DIA
 POSITION DIMENSIONS
 ARE BASIC.

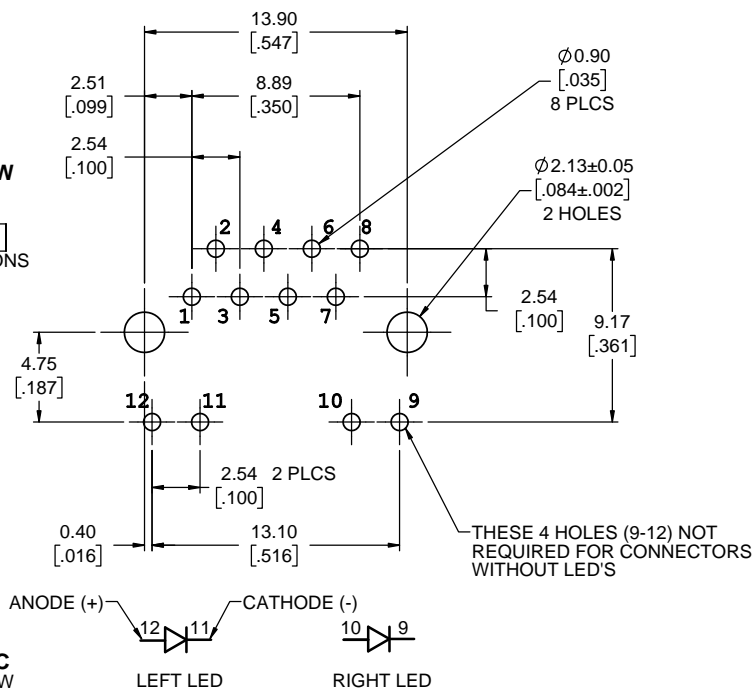

8 POSITION LED SCHEMATIC GREEN OR YELLOW

BI-COLOUR LED SCHEMATIC LEFT OR RIGHT SIDE, 8 OR 10 POSITION

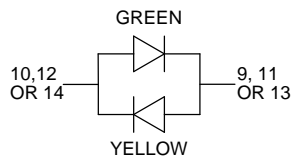

10 POSITION VIEW

LOCATE HOLES
 $\varnothing 0.13 (.005)$ DIA
 POSITION DIMENSIONS
 ARE BASIC.

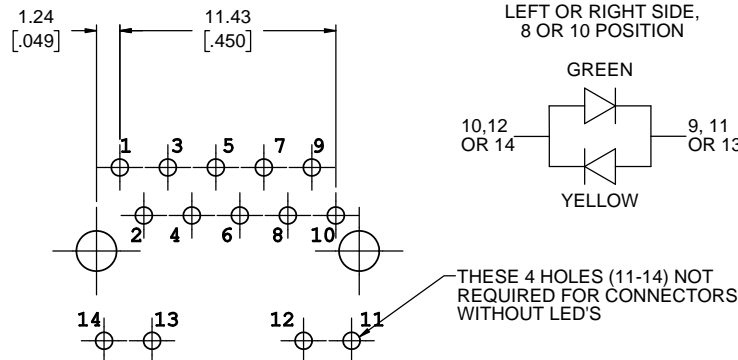

10 POSITION LED SCHEMATIC GREEN OR YELLOW

RECOMMENDED PANEL CUTOUT OUTSIDE PANEL VIEW

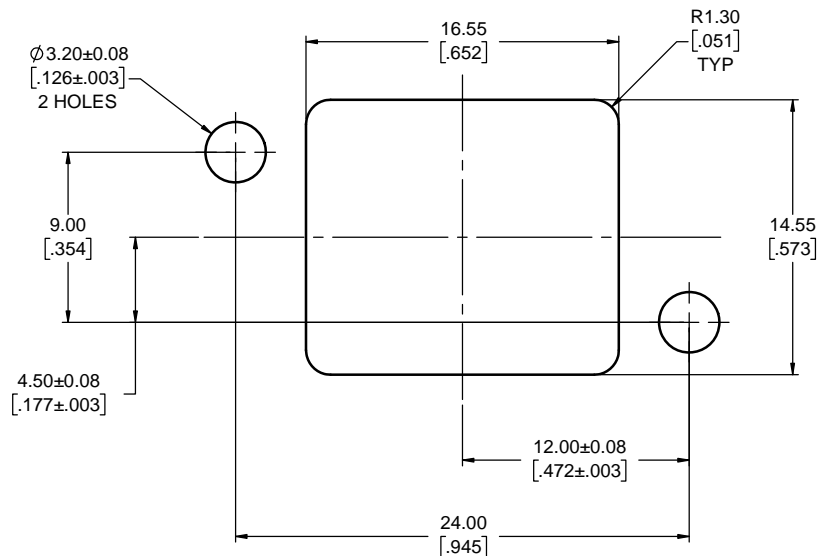

UNLESS SPECIFIED OTHERWISE	DRAWN I. FOUK ALADEH	SEP13/17
PRIMARY UNITS MILLIMETERS	CHECKED K.LAMBIE	SEP19/17
SECONDARY INCHES	M.E. APP'D	
REFERENCE IN PARENTHESES	Q.A. APP'D	
GENERAL TOLERANCES	DWG APPR.	
1 DECIMAL PLACE	ENG. REL. NO.	EAR 14605
2 DECIMAL PLACES ± 0.15	REF.	
3 DECIMAL PLACES	THIRD ANGLE PROJECTION	
ANGULAR DEGREES	DO NOT SCALE DRAWING	

Amphenol Canada Corp. www.amphenolcanada.com		
MRJR SERIES RUGGED MODULAR JACK, 8 OR 10 CONTACTS, VERTICAL, LED, THREAD & TAIL LENGTH OPTIONS, EXTRA SHELL CLEARANCE, RoHS COMPLIANT		
DWG. NO.	P-MRJR-54XX-XC	REV A
CODE ID NO. 03554	DWG SIZE: X	SCALE: 5:1
SHEET 2 OF 2		